



RUTHERFORD PLACE

1601 RUTHERFORD LN, AUSTIN, TX 78754

STEPHEN DEPIZZO

Executive Vice President
T 512.391.0718 x22 | C 614.570.1260
sdepizzo@stcroixca.com

JEREMY PETERSON

Associate
T 512.391.0718 x33 | C 413.949.0390
jpeterson@stcroixca.com



OFFERING SUMMARY

Lease Rate: \$15.00 - 18.00 SF/yr (NNN)

PROPERTY OVERVIEW

Flex Space for Lease
100% HVAC office / warehouse
Grade level loading
3 phase power
Parking Ratio: 5.50 / 1,000 SF

AVAILABILITY

- Suite A - 1,200 SF
- Suite B - 6,352 SF (New Open Floorplan)
- Suite C - 3,540 SF

Suite B - 6,352 SF

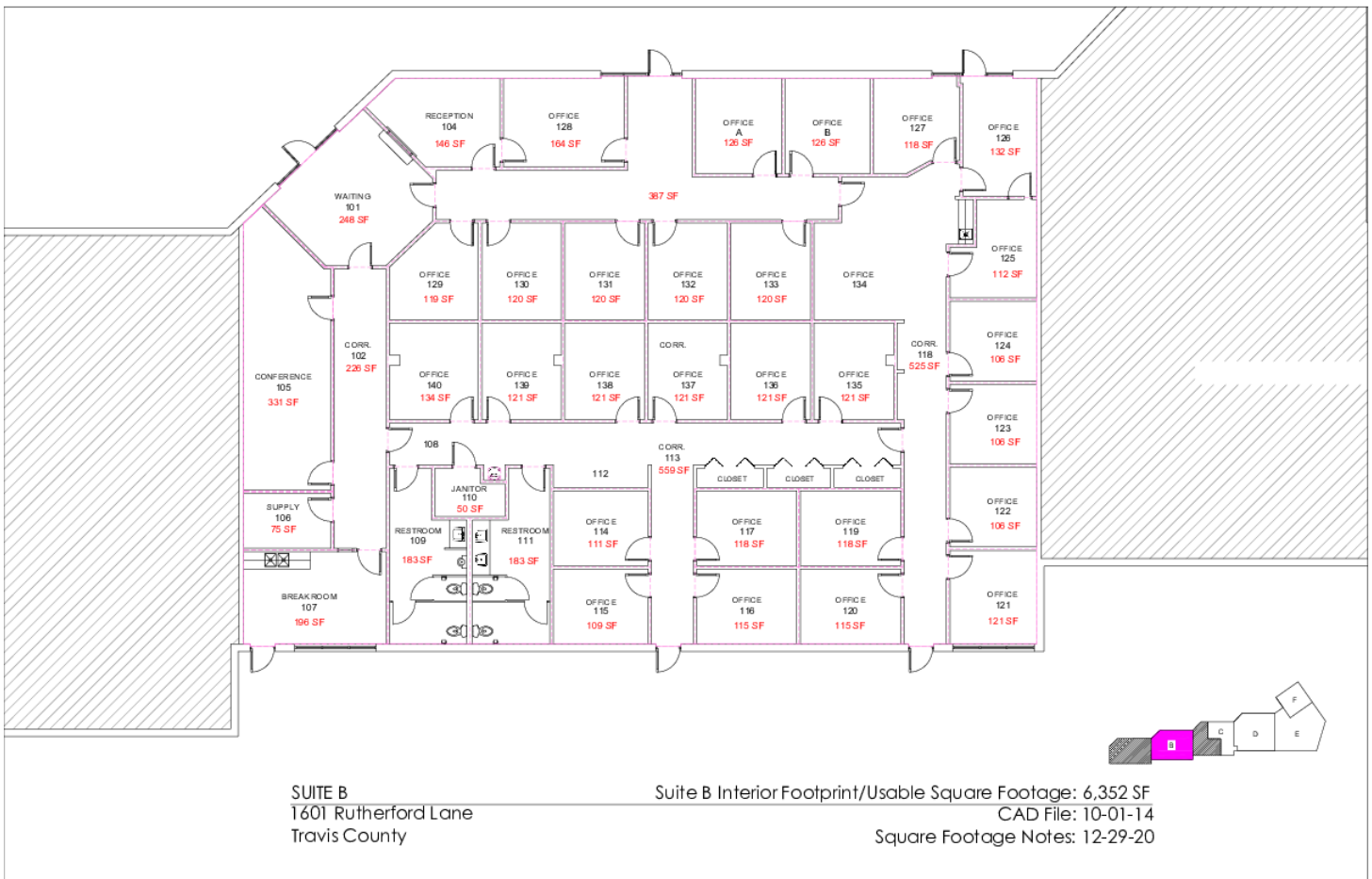

STEPHEN DEPIZZO

Executive Vice President
T 512.391.0718 x22 | C 614.570.1260
sdepizzo@stcroixca.com

JEREMY PETERSON

Associate
T 512.391.0718 x33 | C 413.949.0390
jpeterson@stcroixca.com

FOR LEASE | RUTHERFORD PLACE

1601 RUTHERFORD LN, AUSTIN, TX 78754

Suite C - 3,540 SF

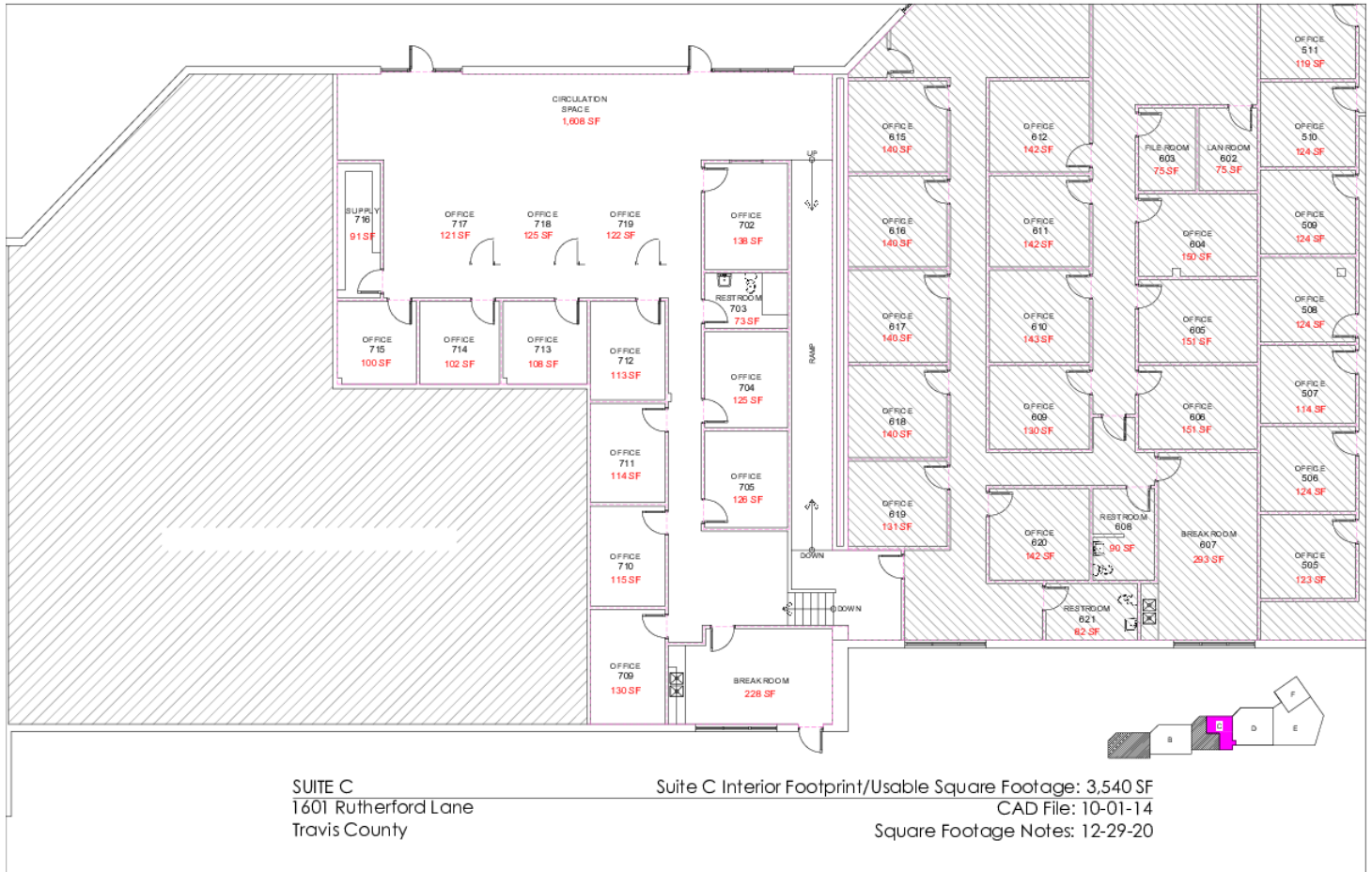

STEPHEN DEPIZZO

Executive Vice President
 T 512.391.0718 x22 | C 614.570.1260
 sdepizzo@stcroixca.com

JEREMY PETERSON

Associate
 T 512.391.0718 x33 | C 413.949.0390
 jpeterson@stcroixca.com



www.stcroixcra.com

FOR LEASE | RUTHERFORD PLACE

1601 RUTHERFORD LN, AUSTIN, TX 78754

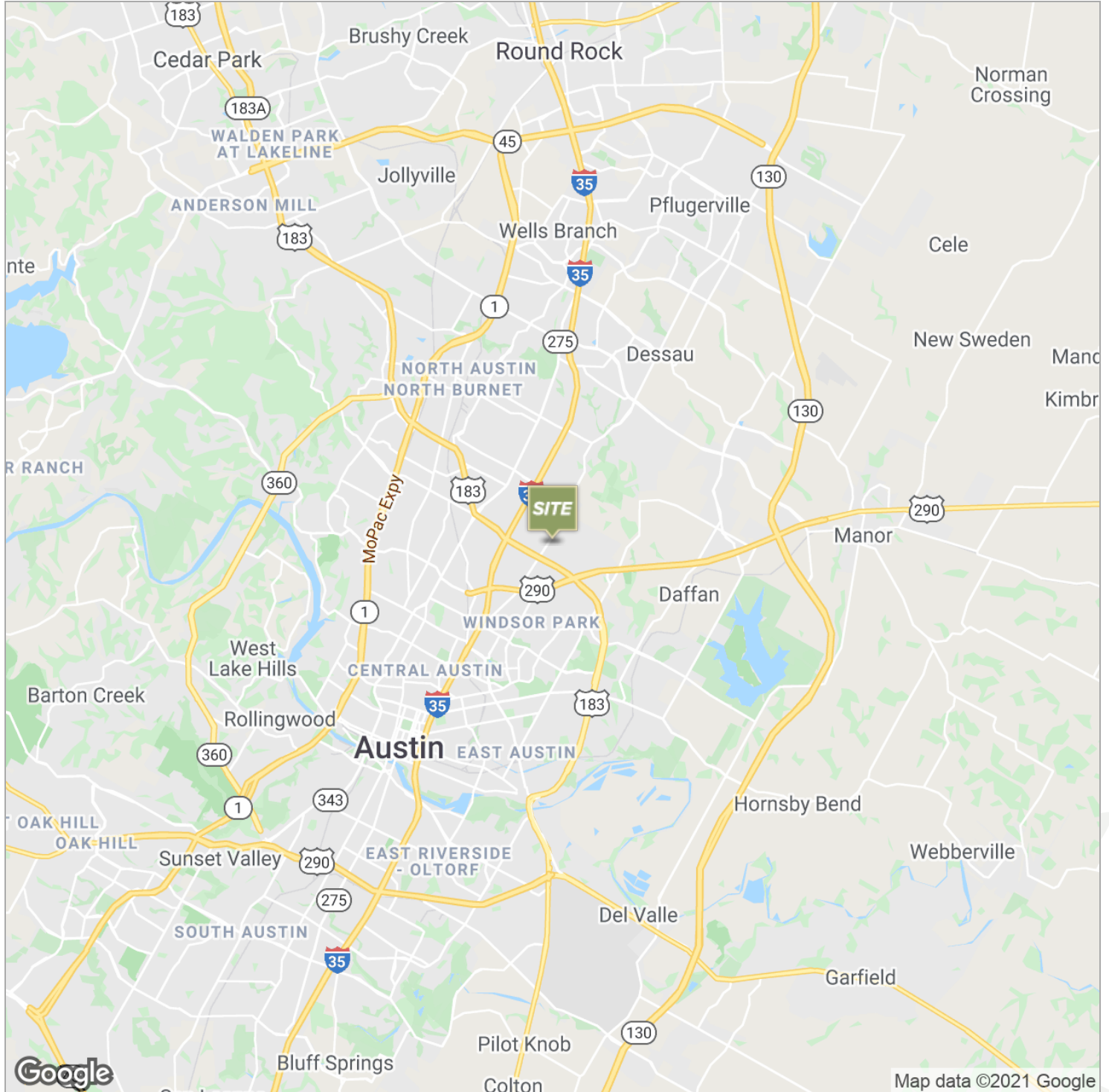

STEPHEN DEPIZZO

Executive Vice President
T 512.391.0718 x22 | C 614.570.1260
sdepizzo@stcroixca.com

JEREMY PETERSON

Associate
T 512.391.0718 x33 | C 413.949.0390
jpeterson@stcroixca.com



www.stcroixcra.com

FOR LEASE | RUTHERFORD PLACE

1601 RUTHERFORD LN, AUSTIN, TX 78754

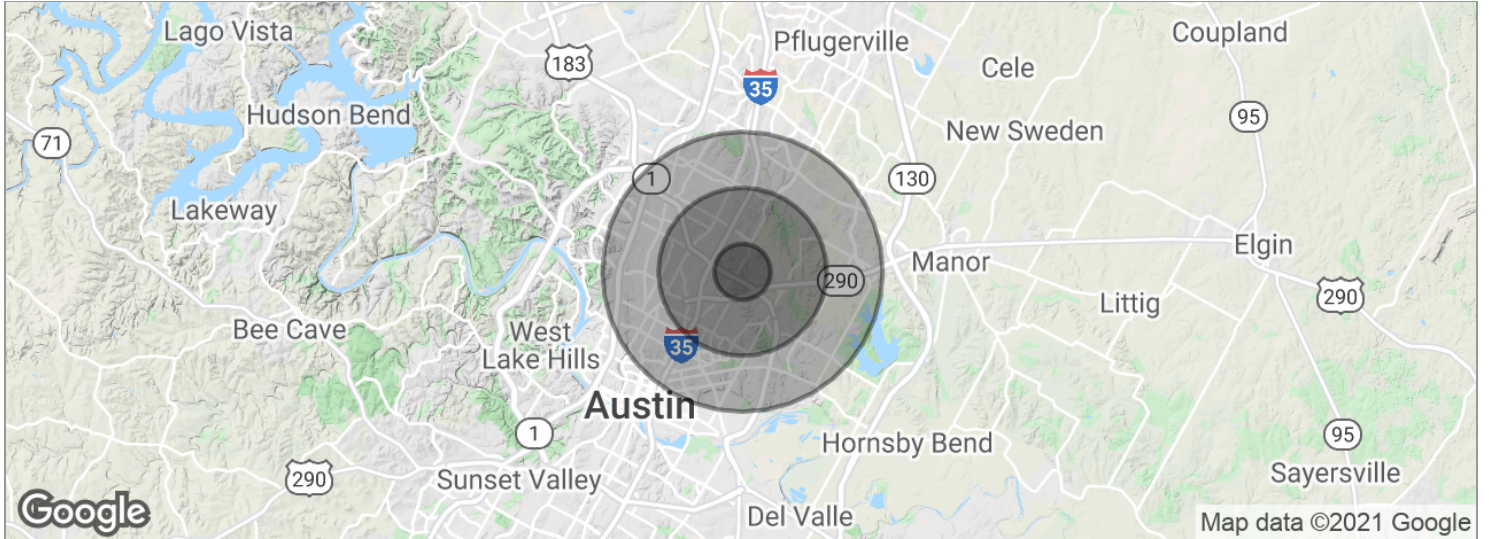

POPULATION

	1 MILE	3 MILES	5 MILES
Total population	11,847	117,713	268,025
Median age	29.4	29.4	30.3
Median age (Male)	29.4	28.6	29.9
Median age (Female)	28.9	31.0	31.3

HOUSEHOLDS & INCOME

	1 MILE	3 MILES	5 MILES
Total households	4,505	43,995	108,504
# of persons per HH	2.6	2.7	2.5
Average HH income	\$47,346	\$47,772	\$53,241
Average house value	\$139,537	\$160,933	\$196,322

* Demographic data derived from 2010 US Census

STEPHEN DEPIZZO

Executive Vice President
T 512.391.0718 x22 | C 614.570.1260
sdepizzo@stcroixca.com

JEREMY PETERSON

Associate
T 512.391.0718 x33 | C 413.949.0390
jpeterson@stcroixca.com



www.stcroixcra.com