

2.4 Acres Vacant Land for Sale

TBD (Part of 6202 N Himes Ave.), Tampa, FL 33614

EXECUTIVE SUMMARY

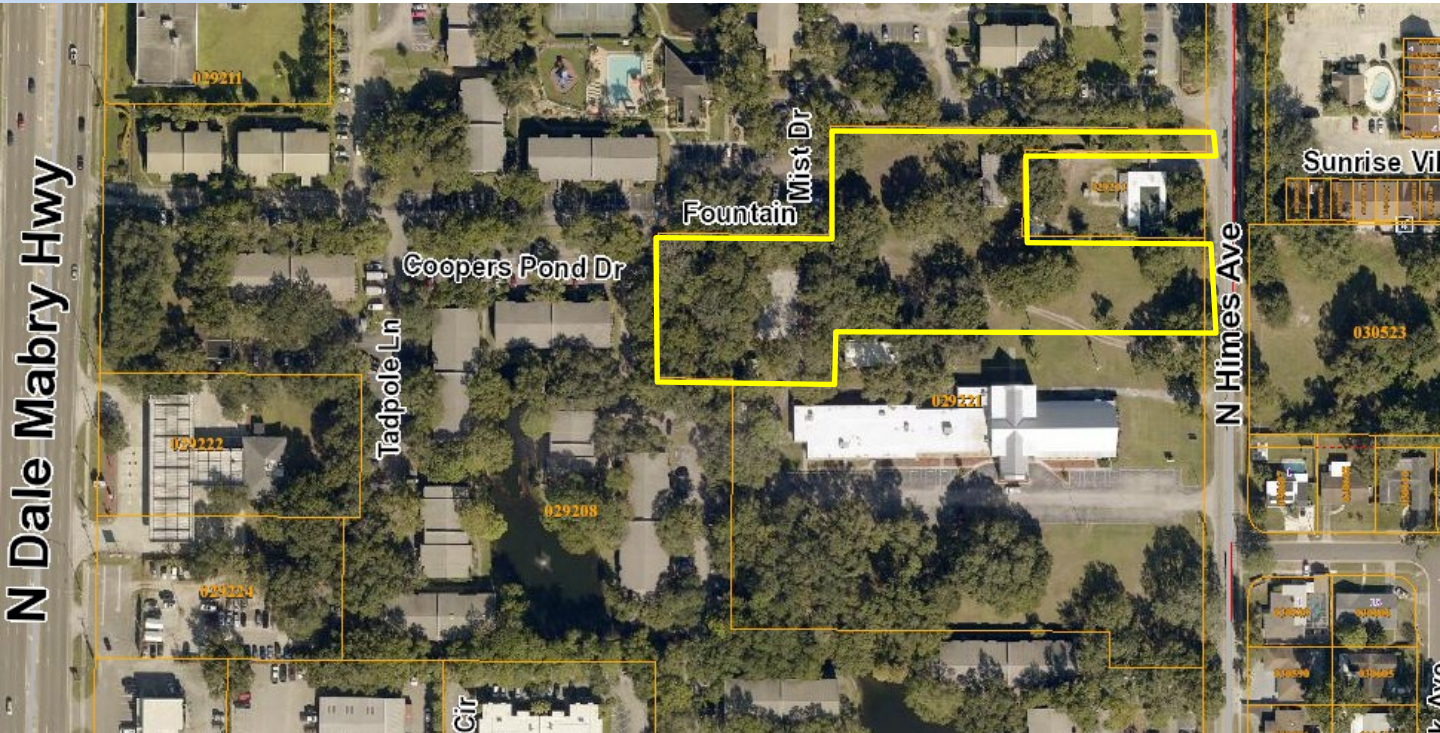

Summary:

Price:	\$1,499,900
Land Size:	2.43 +/- acres (north end of 6202 N Himes Ave, Tampa, FL 33614)
Current Zoning:	RMC-20 (Res. Multifamily Conv.20 units/acre)
Potential Uses:	Multi Family, Residential
Future Land Use:	RESIDENTIAL-20 (.35 FAR)
Folio Number:	TBD – Part of # 029221-0000
Market:	Egypt Lake Area
Property Taxes:	To Be Determined
Utilities:	Water/Sewer Hillsborough County Electric: Tampa Electric
Traffic Counts:	2,700 vehicles/day

Overview:

This is an excellent opportunity to purchase a 2.43-acre developmental parcel in the South Carrollwood/Egypt Lake submarket of Tampa Florida. The Future Land Use of Residential-20 (.35 FAR) allows for a number of potential residential uses. The attached site plan analysis proposes some potential uses that include 48 residential units (subject to Hillsborough County approval).

The Egypt Lake neighborhood is centrally located just off of Dale Mabry and Hillsborough Avenue. The location is just a short drive away from Interstate 275 with excellent access to Tampa Bay, Pinellas County and Orlando to the east. This area is home to many businesses, restaurants, offices and multiple apartment complexes. This opportunity is perfect for a developer looking for a residential development project in the heart of thriving Tampa, Florida.

Bill Besselieu, CCIM
 Mobile/Direct: 813-263-5854
besselieu@gmail.com

Greg Andretta, SIOR
 813-263-4833
greg@andrettaproperties.com

Andretta Properties
 Licensed Real Estate Broker
 550 N. Reo St. #300 Tampa, FL 33609
 Office: 813-889-0889
www.andrettaproperties.com



2.4 Acres Vacant Land for Sale

TBD (Part of 6202 N Himes Ave.), Tampa, FL 33614

POTENTIAL SITE PLAN STUDY OVERVIEW AND ZOOMED IN

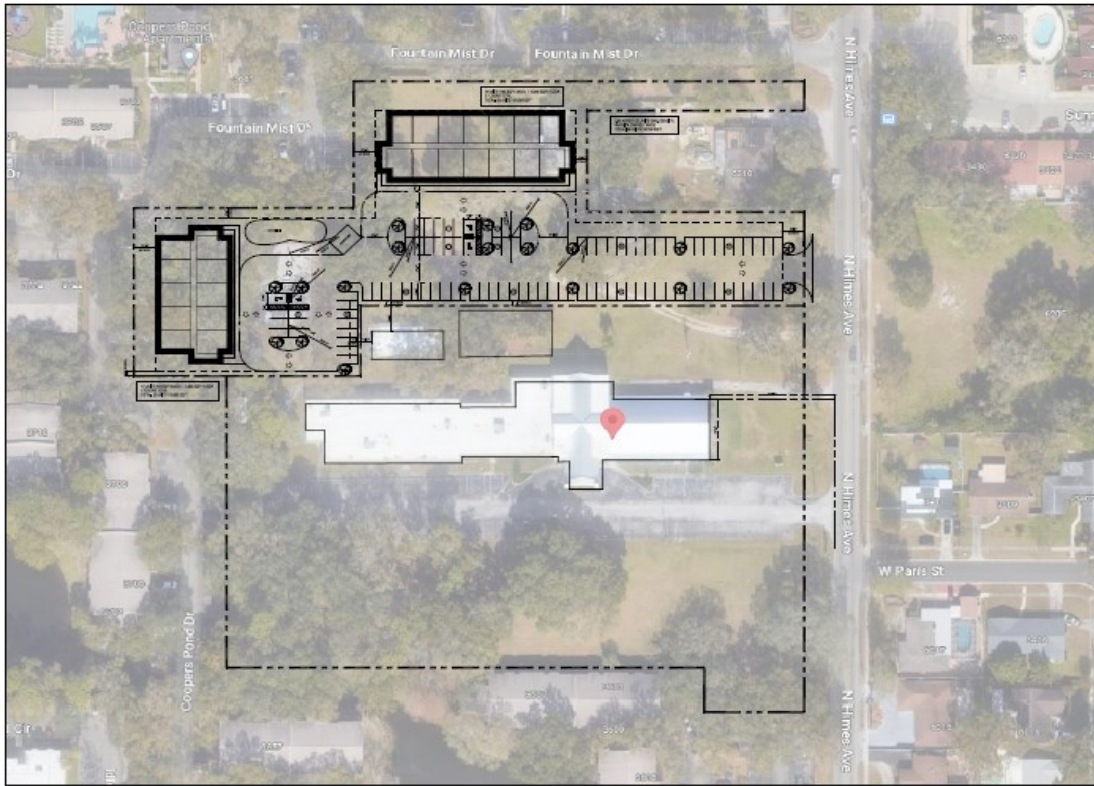

1 ARCHITECTURAL SITE PLAN SCHEMATIC 1
SCALE: 1"=80'

GENERAL NOTES	
1.	SEE ALL NOTES ON ALL SHEETS.
2.	THIS SITE PLAN IS A PRELIMINARY DESIGN AND IS SUBJECT TO CHANGE WITHOUT NOTICE.
3.	THE DESIGNER HAS CONDUCTED VISUAL SURVEYS AND HAS BEEN ADVISED BY THE CLIENT THAT THE PROPERTY IS VACANT.
4.	THE DESIGNER HAS CONDUCTED VISUAL SURVEYS AND HAS BEEN ADVISED BY THE CLIENT THAT THE PROPERTY IS VACANT.
5.	THE DESIGNER HAS CONDUCTED VISUAL SURVEYS AND HAS BEEN ADVISED BY THE CLIENT THAT THE PROPERTY IS VACANT.
6.	THE DESIGNER HAS CONDUCTED VISUAL SURVEYS AND HAS BEEN ADVISED BY THE CLIENT THAT THE PROPERTY IS VACANT.
7.	THE DESIGNER HAS CONDUCTED VISUAL SURVEYS AND HAS BEEN ADVISED BY THE CLIENT THAT THE PROPERTY IS VACANT.
8.	THE DESIGNER HAS CONDUCTED VISUAL SURVEYS AND HAS BEEN ADVISED BY THE CLIENT THAT THE PROPERTY IS VACANT.
9.	THE DESIGNER HAS CONDUCTED VISUAL SURVEYS AND HAS BEEN ADVISED BY THE CLIENT THAT THE PROPERTY IS VACANT.
10.	THE DESIGNER HAS CONDUCTED VISUAL SURVEYS AND HAS BEEN ADVISED BY THE CLIENT THAT THE PROPERTY IS VACANT.
11.	THE DESIGNER HAS CONDUCTED VISUAL SURVEYS AND HAS BEEN ADVISED BY THE CLIENT THAT THE PROPERTY IS VACANT.
12.	THE DESIGNER HAS CONDUCTED VISUAL SURVEYS AND HAS BEEN ADVISED BY THE CLIENT THAT THE PROPERTY IS VACANT.
13.	THE DESIGNER HAS CONDUCTED VISUAL SURVEYS AND HAS BEEN ADVISED BY THE CLIENT THAT THE PROPERTY IS VACANT.
14.	THE DESIGNER HAS CONDUCTED VISUAL SURVEYS AND HAS BEEN ADVISED BY THE CLIENT THAT THE PROPERTY IS VACANT.
15.	THE DESIGNER HAS CONDUCTED VISUAL SURVEYS AND HAS BEEN ADVISED BY THE CLIENT THAT THE PROPERTY IS VACANT.
16.	THE DESIGNER HAS CONDUCTED VISUAL SURVEYS AND HAS BEEN ADVISED BY THE CLIENT THAT THE PROPERTY IS VACANT.
17.	THE DESIGNER HAS CONDUCTED VISUAL SURVEYS AND HAS BEEN ADVISED BY THE CLIENT THAT THE PROPERTY IS VACANT.
18.	THE DESIGNER HAS CONDUCTED VISUAL SURVEYS AND HAS BEEN ADVISED BY THE CLIENT THAT THE PROPERTY IS VACANT.
19.	THE DESIGNER HAS CONDUCTED VISUAL SURVEYS AND HAS BEEN ADVISED BY THE CLIENT THAT THE PROPERTY IS VACANT.
20.	THE DESIGNER HAS CONDUCTED VISUAL SURVEYS AND HAS BEEN ADVISED BY THE CLIENT THAT THE PROPERTY IS VACANT.
21.	THE DESIGNER HAS CONDUCTED VISUAL SURVEYS AND HAS BEEN ADVISED BY THE CLIENT THAT THE PROPERTY IS VACANT.
22.	THE DESIGNER HAS CONDUCTED VISUAL SURVEYS AND HAS BEEN ADVISED BY THE CLIENT THAT THE PROPERTY IS VACANT.
23.	THE DESIGNER HAS CONDUCTED VISUAL SURVEYS AND HAS BEEN ADVISED BY THE CLIENT THAT THE PROPERTY IS VACANT.
24.	THE DESIGNER HAS CONDUCTED VISUAL SURVEYS AND HAS BEEN ADVISED BY THE CLIENT THAT THE PROPERTY IS VACANT.
25.	THE DESIGNER HAS CONDUCTED VISUAL SURVEYS AND HAS BEEN ADVISED BY THE CLIENT THAT THE PROPERTY IS VACANT.
26.	THE DESIGNER HAS CONDUCTED VISUAL SURVEYS AND HAS BEEN ADVISED BY THE CLIENT THAT THE PROPERTY IS VACANT.
27.	THE DESIGNER HAS CONDUCTED VISUAL SURVEYS AND HAS BEEN ADVISED BY THE CLIENT THAT THE PROPERTY IS VACANT.
28.	THE DESIGNER HAS CONDUCTED VISUAL SURVEYS AND HAS BEEN ADVISED BY THE CLIENT THAT THE PROPERTY IS VACANT.
29.	THE DESIGNER HAS CONDUCTED VISUAL SURVEYS AND HAS BEEN ADVISED BY THE CLIENT THAT THE PROPERTY IS VACANT.
30.	THE DESIGNER HAS CONDUCTED VISUAL SURVEYS AND HAS BEEN ADVISED BY THE CLIENT THAT THE PROPERTY IS VACANT.
31.	THE DESIGNER HAS CONDUCTED VISUAL SURVEYS AND HAS BEEN ADVISED BY THE CLIENT THAT THE PROPERTY IS VACANT.
32.	THE DESIGNER HAS CONDUCTED VISUAL SURVEYS AND HAS BEEN ADVISED BY THE CLIENT THAT THE PROPERTY IS VACANT.
33.	THE DESIGNER HAS CONDUCTED VISUAL SURVEYS AND HAS BEEN ADVISED BY THE CLIENT THAT THE PROPERTY IS VACANT.
34.	THE DESIGNER HAS CONDUCTED VISUAL SURVEYS AND HAS BEEN ADVISED BY THE CLIENT THAT THE PROPERTY IS VACANT.
35.	THE DESIGNER HAS CONDUCTED VISUAL SURVEYS AND HAS BEEN ADVISED BY THE CLIENT THAT THE PROPERTY IS VACANT.
36.	THE DESIGNER HAS CONDUCTED VISUAL SURVEYS AND HAS BEEN ADVISED BY THE CLIENT THAT THE PROPERTY IS VACANT.
37.	THE DESIGNER HAS CONDUCTED VISUAL SURVEYS AND HAS BEEN ADVISED BY THE CLIENT THAT THE PROPERTY IS VACANT.
38.	THE DESIGNER HAS CONDUCTED VISUAL SURVEYS AND HAS BEEN ADVISED BY THE CLIENT THAT THE PROPERTY IS VACANT.
39.	THE DESIGNER HAS CONDUCTED VISUAL SURVEYS AND HAS BEEN ADVISED BY THE CLIENT THAT THE PROPERTY IS VACANT.
40.	THE DESIGNER HAS CONDUCTED VISUAL SURVEYS AND HAS BEEN ADVISED BY THE CLIENT THAT THE PROPERTY IS VACANT.
41.	THE DESIGNER HAS CONDUCTED VISUAL SURVEYS AND HAS BEEN ADVISED BY THE CLIENT THAT THE PROPERTY IS VACANT.
42.	THE DESIGNER HAS CONDUCTED VISUAL SURVEYS AND HAS BEEN ADVISED BY THE CLIENT THAT THE PROPERTY IS VACANT.
43.	THE DESIGNER HAS CONDUCTED VISUAL SURVEYS AND HAS BEEN ADVISED BY THE CLIENT THAT THE PROPERTY IS VACANT.
44.	THE DESIGNER HAS CONDUCTED VISUAL SURVEYS AND HAS BEEN ADVISED BY THE CLIENT THAT THE PROPERTY IS VACANT.
45.	THE DESIGNER HAS CONDUCTED VISUAL SURVEYS AND HAS BEEN ADVISED BY THE CLIENT THAT THE PROPERTY IS VACANT.
46.	THE DESIGNER HAS CONDUCTED VISUAL SURVEYS AND HAS BEEN ADVISED BY THE CLIENT THAT THE PROPERTY IS VACANT.
47.	THE DESIGNER HAS CONDUCTED VISUAL SURVEYS AND HAS BEEN ADVISED BY THE CLIENT THAT THE PROPERTY IS VACANT.
48.	THE DESIGNER HAS CONDUCTED VISUAL SURVEYS AND HAS BEEN ADVISED BY THE CLIENT THAT THE PROPERTY IS VACANT.
49.	THE DESIGNER HAS CONDUCTED VISUAL SURVEYS AND HAS BEEN ADVISED BY THE CLIENT THAT THE PROPERTY IS VACANT.
50.	THE DESIGNER HAS CONDUCTED VISUAL SURVEYS AND HAS BEEN ADVISED BY THE CLIENT THAT THE PROPERTY IS VACANT.

Andretta Properties
Site Plan Study
 Christ Central Presbyterian Church
 6202 N Himes Ave
 Tampa, FL 33614



Bill Besselieu, CCIM
 Mobile/Direct: 813-263-5854
besselieu@gmail.com

Greg Andretta, SIOR
 813-263-4833
greg@andrettaproperties.com

Andretta Properties
 Licensed Real Estate Broker
 550 N. Reo St. #300 Tampa, FL 33609
 Office: 813-889-0889
www.andrettaproperties.com

All information furnished regarding property for sale, rental, financing or projections of income & expenses is from sources deemed reliable. No warranty or representation is made as to the accuracy thereof, and it is subject to errors, omissions, change of price, rental or other conditions prior to sale, financing, or withdrawal without notice. Neither the Owner or Andretta Properties, nor any of their respective directors, officers, Affiliates or representatives make any representation or warranty, expressed or implied, as to the accuracy or completeness of this Memorandum or any of its contents, and no legal commitment or obligation shall arise by reason of your receipt of this Memorandum or use of its contents; and you are to rely solely on your investigations and inspections of the Property in evaluating a possible purchase of the real property.

2.4 Acres Vacant Land for Sale

TBD (Part of 6202 N Himes Ave.), Tampa, FL 33614

LOCATION AND PICTOMETRY MAP

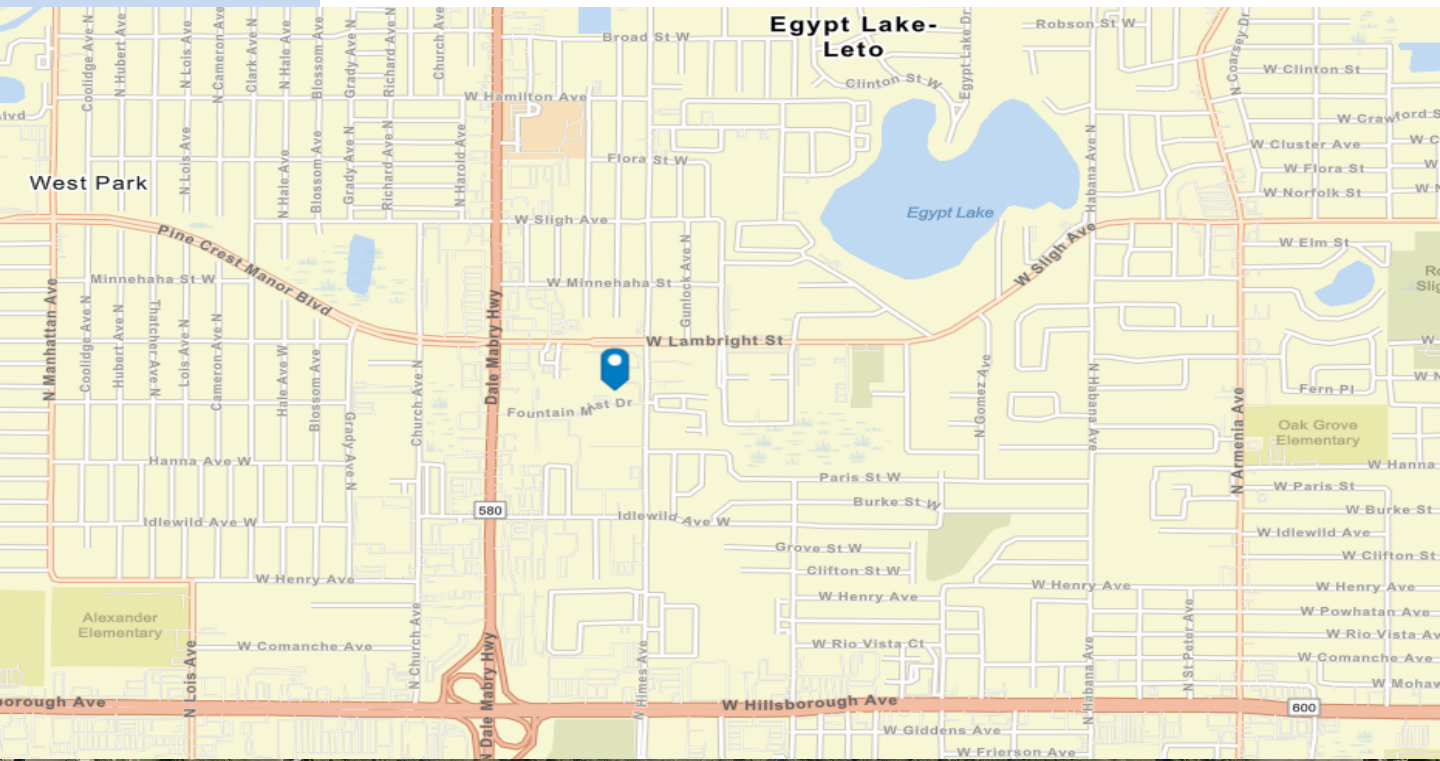

Bill Besselieu, CCIM
 Mobile/Direct: 813-263-5854
besselieu@gmail.com

Greg Andretta, SIOR
 813-263-4833
greg@andrettaproperties.com

Andretta Properties
 Licensed Real Estate Broker
 550 N. Reo St. #300 Tampa, FL 33609
 Office: 813-889-0889
www.andrettaproperties.com

All information furnished regarding property for sale, rental, financing or projections of income & expenses is from sources deemed reliable. No warranty or representation is made as to the accuracy thereof, and it is subject to errors, omissions, change of price, rental or other conditions prior to sale, financing, or withdrawal without notice. Neither the Owner or Andretta Properties, nor any of their respective directors, officers, Affiliates or representatives make any representation or warranty, expressed or implied, as to the accuracy or completeness of this Memorandum or any of its contents, and no legal commitment or obligation shall arise by reason of your receipt of this Memorandum or use of its contents; and you are to rely solely on your investigations and inspections of the Property in evaluating a possible purchase of the real property.

2.4 Acres Vacant Land for Sale

TBD (Part of 6202 N Himes Ave.), Tampa, FL 33614

SURROUNDING RETAIL MAP

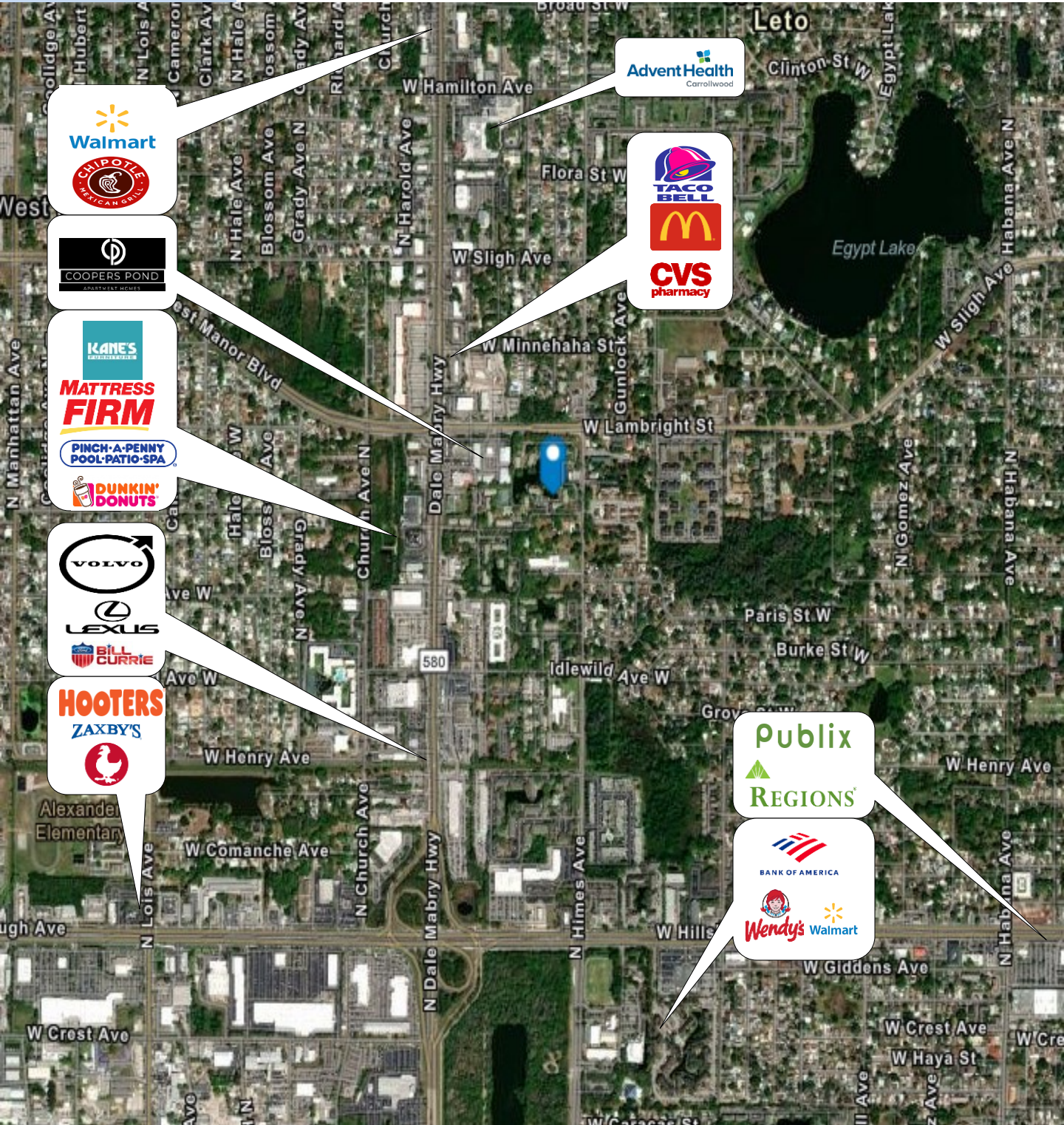

Bill Besselieu, CCIM
 Mobile/Direct: 813-263-5854
besselieu@gmail.com

Greg Andretta, SIOR
 813-263-4833
greg@andrettaproperties.com

Andretta Properties
 Licensed Real Estate Broker
 550 N. Reo St. #300 Tampa, FL 33609
 Office: 813-889-0889
www.andrettaproperties.com

All information furnished regarding property for sale, rental, financing or projections of income & expenses is from sources deemed reliable. No warranty or representation is made as to the accuracy thereof, and it is subject to errors, omissions, change of price, rental or other conditions prior to sale, financing, or withdrawal without notice. Neither the Owner or Andretta Properties, nor any of their respective directors, officers, Affiliates or representatives make any representation or warranty, expressed or implied, as to the accuracy or completeness of this Memorandum or any of its contents, and no legal commitment or obligation shall arise by reason of your receipt of this Memorandum or use of its contents; and you are to rely solely on your investigations and inspections of the Property in evaluating a possible purchase of the real property.

2.4 Acres Vacant Land for Sale

TBD (Part of 6202 N Himes Ave.), Tampa, FL 33614

DEMOGRAPHICS



Housing market characteristics

6202 N Himes Ave, Tampa, Florida, 33614
Drive time of 5 minutes

\$272,447 ↓
Median Home Value
21% lower than Florida which is \$330,683

76
Housing Affordability Index

33.4%
Percent of Income for Mortgage

130
Percent of Income for Mortgage (Index)

Age <18 **6,085** Age 18-64 **19,188** Age 65+ **4,689** Total Pop **29,962** Pop Growth **-0.25%** Average HH Size **2.56** Median Net Worth **\$38,319**

Home value

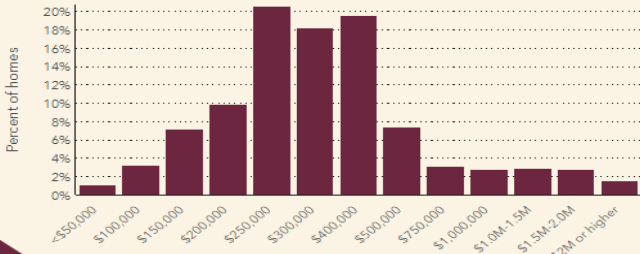

Household income

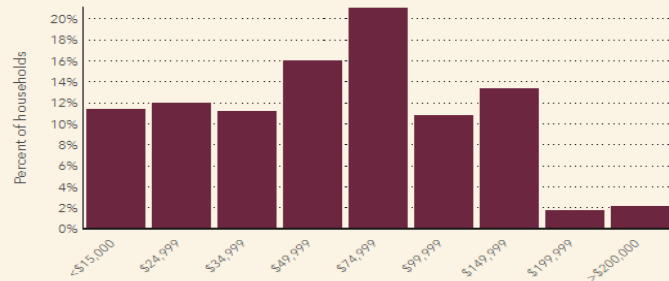

Mortgage as % salary

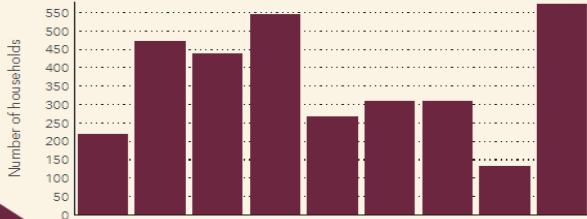

Year property built

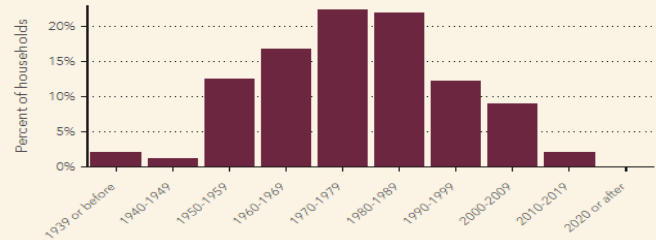

2010 Census housing by size

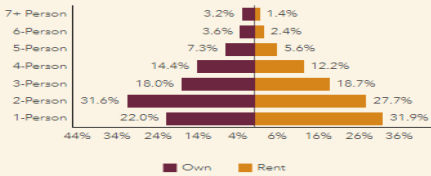

Home ownership

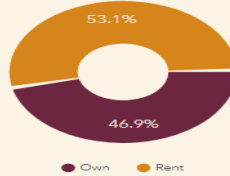

Hispanic home ownership

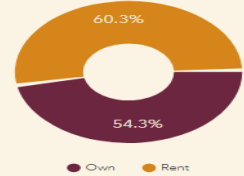

2010 Housing by race of householder

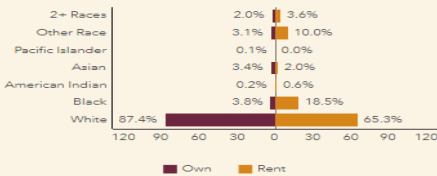

Housing by age of householder

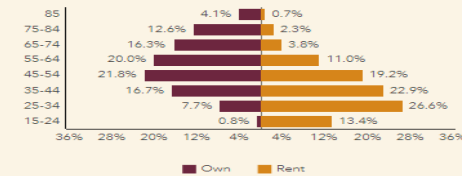

Year householder moved in

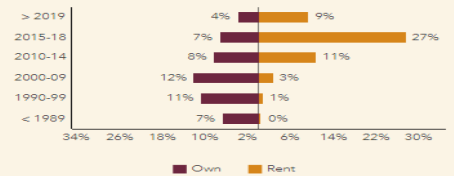

Vacant housing units (Total 650)

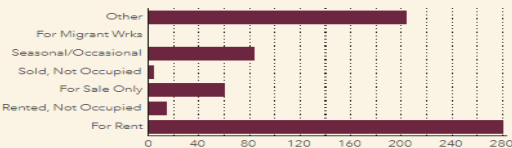

Gross rent

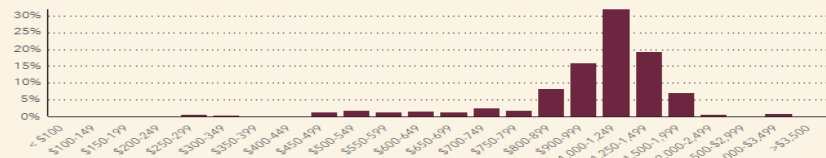

Source: The data in this infographic comes from Esri, ACS, U.S. Census: 2023, 2017-2021, 2010.

Bill Besselieu, CCIM
Mobile/Direct: 813-263-5854
besselieu@gmail.com

Greg Andretta, SIOR
813-263-4833
greg@andrettaproperties.com

Andretta Properties
Licensed Real Estate Broker
550 N. Reo St. #300 Tampa, FL 33609
Office: 813-889-0889
www.andrettaproperties.com

All information furnished regarding property for sale, rental, financing or projections of income & expenses is from sources deemed reliable. No warranty or representation is made as to the accuracy thereof, and it is subject to errors, omissions, change of price, rental or other conditions prior to sale, financing, or withdrawal without notice. Neither the Owner or Andretta Properties, nor any of their respective directors, officers, affiliates or representatives make any representation or warranty, expressed or implied, as to the accuracy or completeness of this Memorandum or any of its contents, and no legal commitment or obligation shall arise by reason of your receipt of this Memorandum or use of its contents; and you are to rely solely on your investigations and inspections of the Property in evaluating a possible purchase of the real property.