



## 2321 Energy Drive

Louisville, Ohio 44641

TOTAL SQ FT	85,075
MINIMUM AVAILABLE	Single Office
MAXIMUM AVAILABLE	50,000 SF
* LEASE RATE	\$9.00/SF (Full Service)
FLOORS	5
ACRES	5.97
ZONING	I2
YEAR BUILT	2013
PARKING	340+ spaces
ELEVATOR	2

\*Rate is based on leasing a minimum of one floor.

### Dan Spring, SIOR

P 330 497 6249  
dan@naispring.com

### Property Features

- Full service lease includes utilities (gas & electric). Best deal in Stark County.
- 58 perimeter offices per floor with large windows built in desks and cabinetry. Turnkey space just bring your chair.
- Amenities include access to large training room that seats over 250 people, conference room, gym, high-speed fiber and 24/7 secured access.
- Owners will consider leasing single office, partial floor or multiple floors. Floor plates are 17,000 SF

### Kelly Sober

P 330 497 9837  
kelly@naispring.com

# Photos



# First Floor



- Offices
- Conference Room
- Utility/Storage Closets
- Elevators/Stairs
- Training/Meeting

# 2nd - 5th Floor

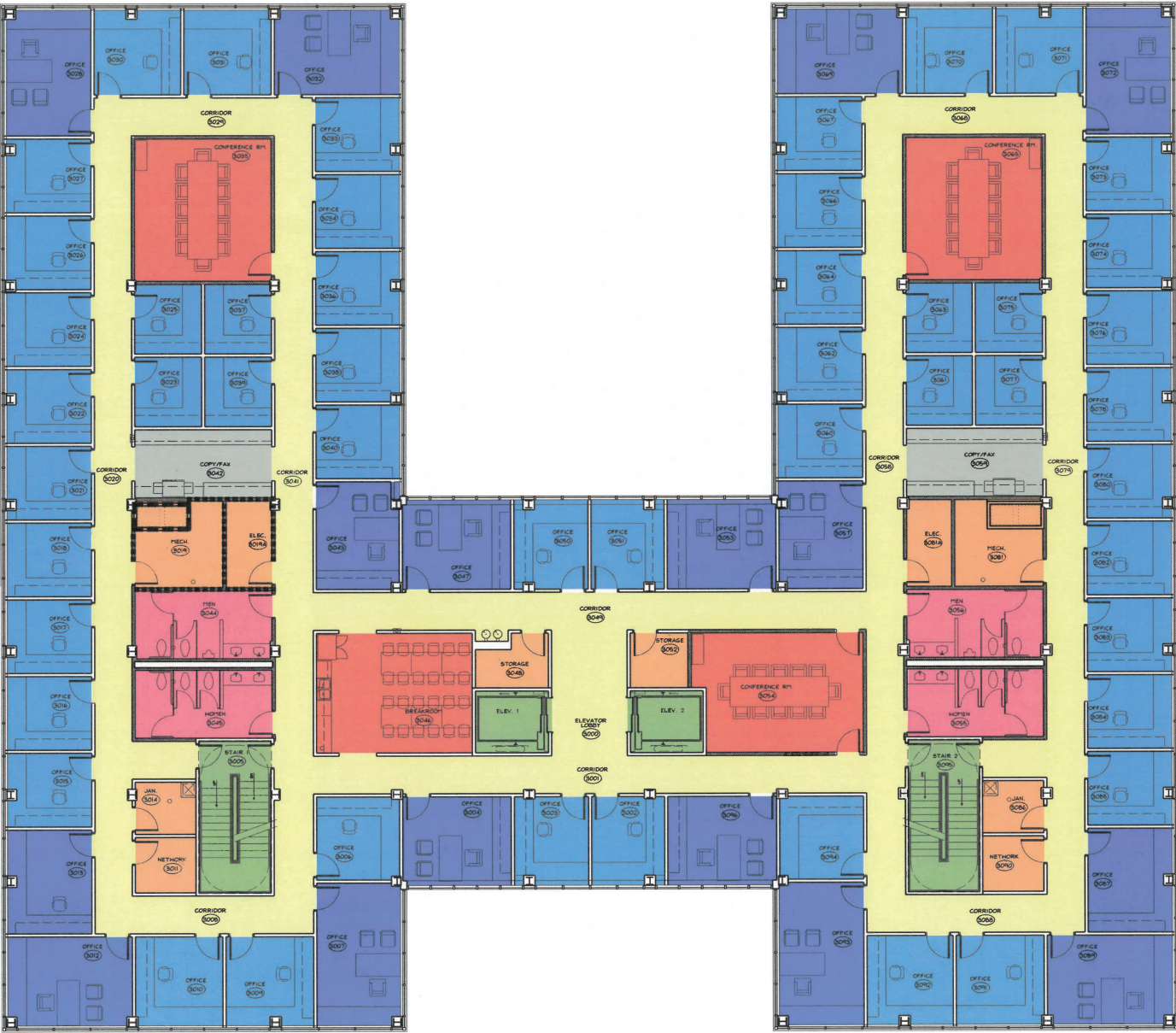

- Offices
- Conference/Break room
- Utility/Storage Closets
- Elevators/Stairs
- Restrooms

# Location Map

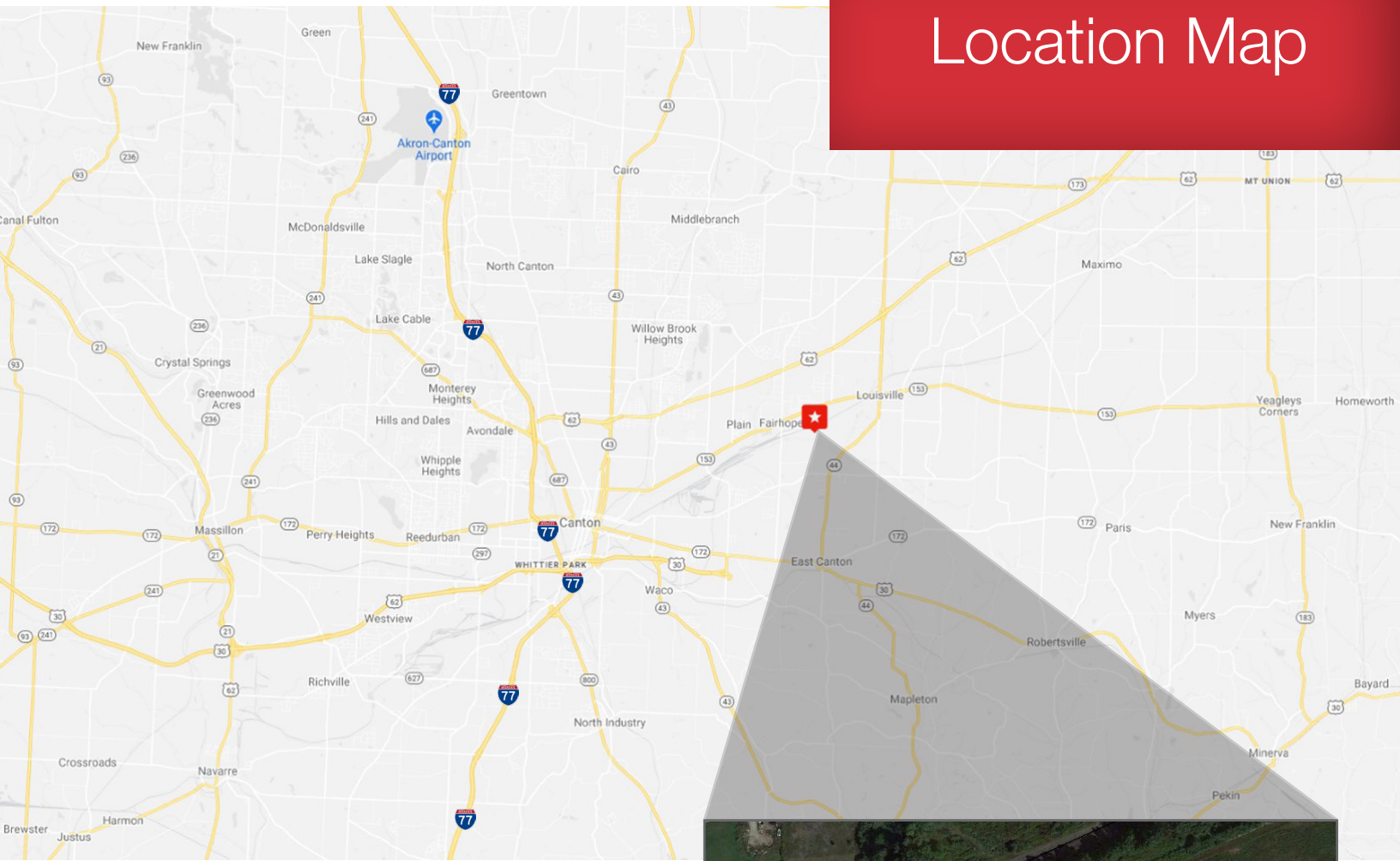

Within minutes of Interstate 77 and US Routes 62, 30, and State Route 44.

- SR 44 - Direct access
- US 30 - 2 miles
- US 62 - 2 miles
- I-77 - 7 miles

