



# 7,500 SF AVAILABLE NOW

2132 James Jackson Parkway NW  
Atlanta, GA 30318

OWNED & MANAGED BY:



## FOR LEASE



FRONTAGE ALONG JAMES JACKSON  
PERFECT FOR SHOWROOM USER WITH IN TOWN EXPOSURE

### PROPERTY INFORMATION

- Total Size:** 7,500 SF
- Office:** 1,800 SF
- Warehouse:** 5,700 SF
- Loading:** One (1) Drive-In Door
- HVAC:** Full HVAC Throughout Warehouse
- Clear Height:** 16'
- Available:** Immediately
- Location:** +/- 1.5 miles from I-285  
+/- 4 miles from I-75  
+/- 4.5 miles from I-20  
+/- 17 miles from Atlanta Airport

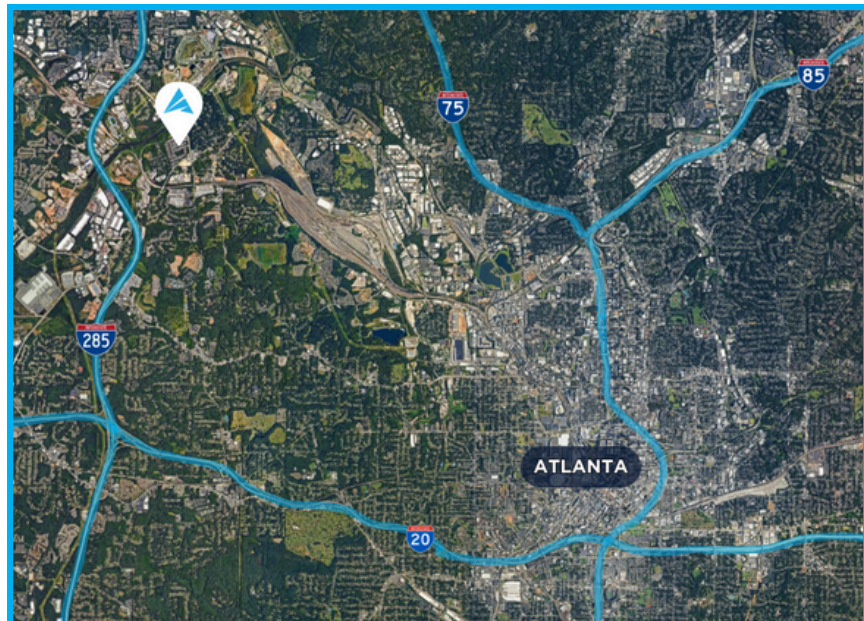

**APEX INDUSTRIAL**  
REAL ESTATE ADVISORS

3500 Lenox Road, Suite 1275 | Atlanta, GA 30326 | [apexindustrialre.com](http://apexindustrialre.com)

For more information, please contact:

#### TREY WEGHORST

Office: (770) 264-9420  
Cell: (404) 276-9314  
[tweghorst@apexindustrialre.com](mailto:tweghorst@apexindustrialre.com)

#### ANDY HEAD

Office: (404) 595-1466  
Cell: (404) 713-4601  
[ahead@apexindustrialre.com](mailto:ahead@apexindustrialre.com)

Although the information contained therein was provided from sources believed to be reliable, Apex Industrial makes no representation, expressed or implied, as to its accuracy and said information is subject to errors, omissions or changes.



**7,500 SF AVAILABLE NOW**

2132 James Jackson Parkway NW  
Atlanta, GA 30318

OWNED & MANAGED BY:



# FLOOR PLAN

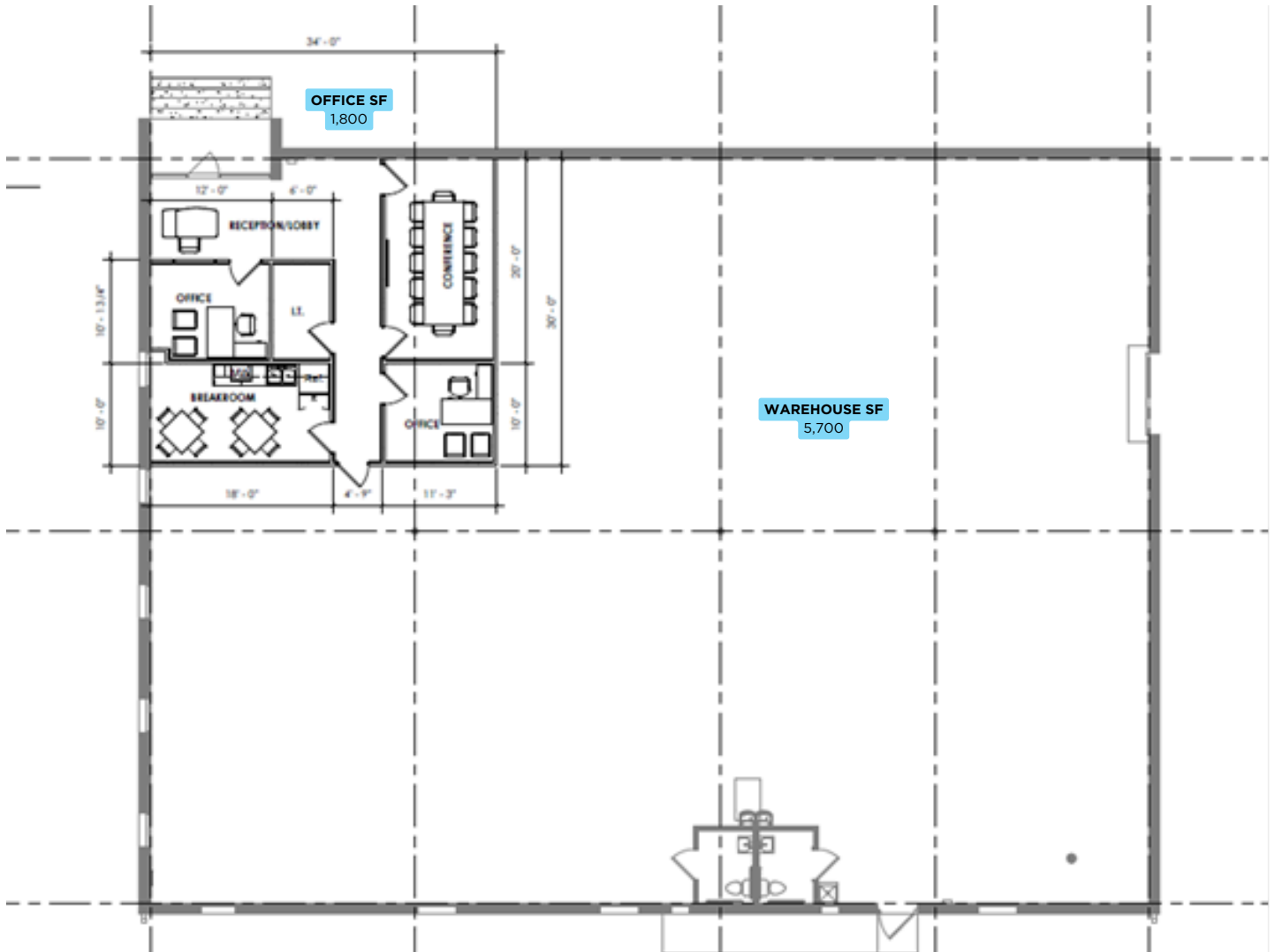

**APEX INDUSTRIAL**  
REAL ESTATE ADVISORS

3500 Lenox Road, Suite 1275 | Atlanta, GA 30326 | [apexindustrialre.com](http://apexindustrialre.com)

For more information, please contact:

**TREY WEGHORST**

Office: (770) 264-9420  
Cell: (404) 276-9314  
[tweghorst@apexindustrialre.com](mailto:tweghorst@apexindustrialre.com)

**ANDY HEAD**

Office: (404) 595-1466  
Cell: (404) 713-4601  
[ahead@apexindustrialre.com](mailto:ahead@apexindustrialre.com)

Although the information contained therein was provided from sources believed to be reliable, Apex Industrial makes no representation, expressed or implied, as to its accuracy and said information is subject to errors, omissions or changes.