

# EIGHT MILE ROAD

*Free-Standing Building*



OnQ  
COMMERCIAL  
REAL ESTATE

12800 E 8 Mile Road  
Detroit, MI 48205

**SALE PRICE**  
\$549,000



**3,348 ± SF** on 0.36 Acres

**FOR SALE**

## Description

Prime free-standing building available for sale along 8 Mile Road in Detroit, MI. This highly visible property offers strong frontage on one of the city's most traveled corridors, ideal for maximizing brand exposure. The site provides excellent accessibility, ample parking, and a versatile layout suited for wide range of retail, office, or service users.

## Address

12800 E 8 Mile Road  
Detroit, MI 48205

## Key Features

- 18 Parking Spaces
- Densely Populated
- Excellent Road Visibility
- Ideal for Owner User or Investor
- B4 Zoning - General Business District

## Asking Price

\$549,000

## Traffic Counts

8 Mile Rd - 37,714+ cpd  
Groesbeck Hwy - 17,446+ cpd  
Schoenherr Rd - 13,106+ cpd

## Demographics

	1 MILE	3 MILES	5 MILES
POPULATION:	14,808	139,088	389,238
HOUSEHOLDS:	5,219	51,985	148,499
AVG. HOUSEHOLD INCOME:	\$59,364	\$64,439	\$71,935
DAYTIME POPULATION:	9,340	93,013	254,791



# MICRO AERIAL

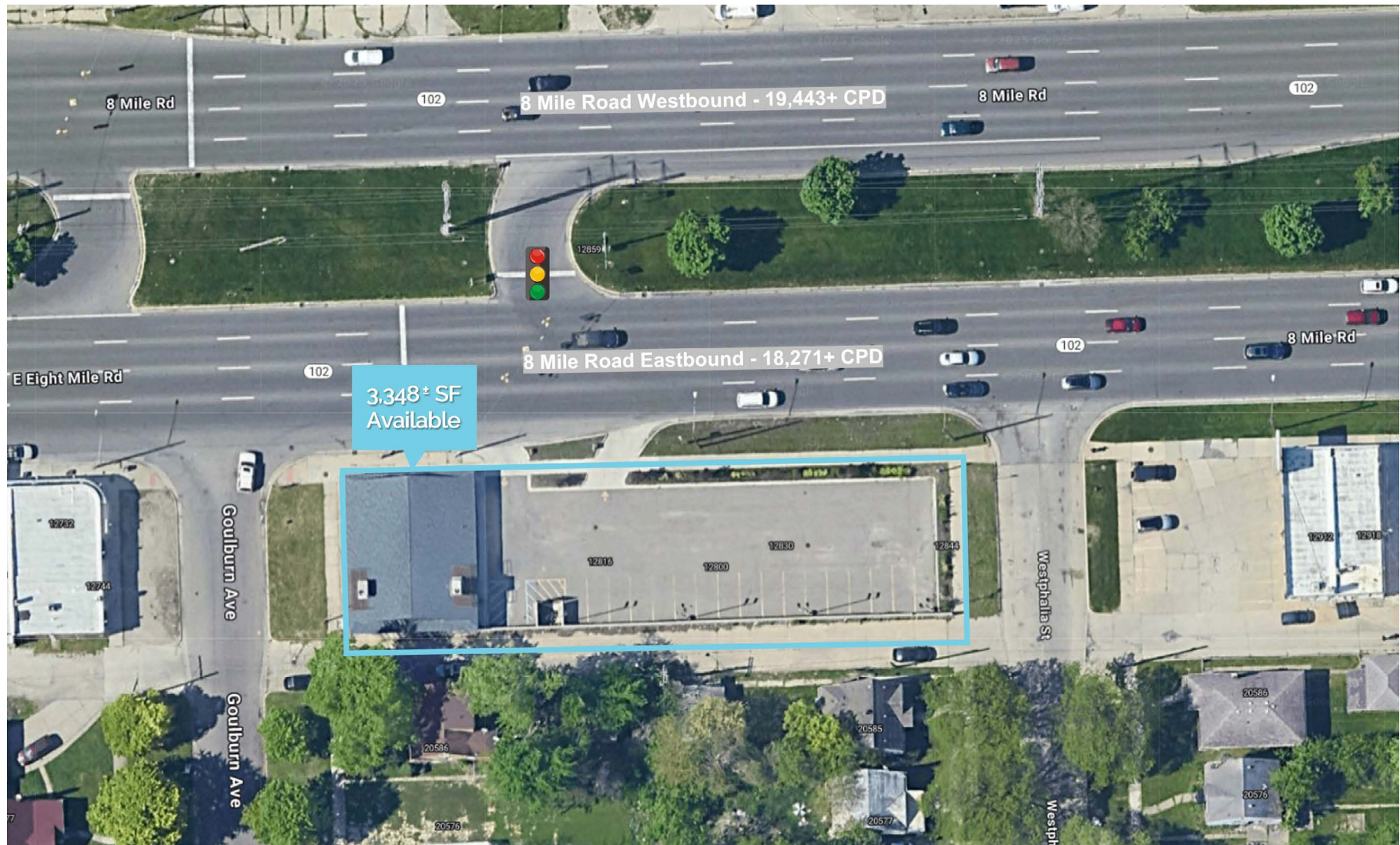

The information contained herein has been obtained through sources deemed reliable by On Q Commercial Real Estate but cannot be guaranteed for its accuracy. We recommend to the buyer or lessee that any information, which is of special interest, should be obtained through independent verification. ALL MEASUREMENTS ARE APPROXIMATE.



# MACRO AERIAL

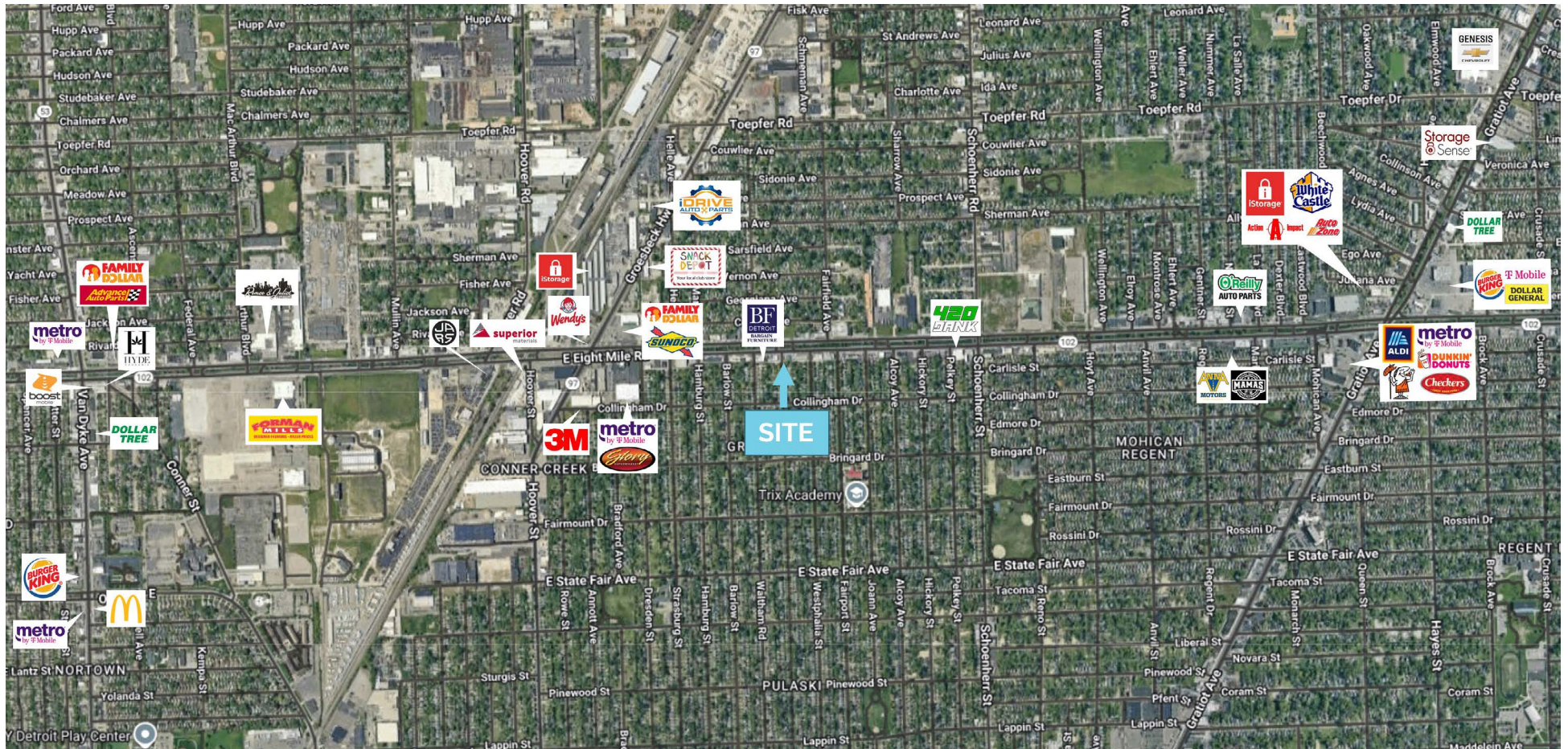

The information contained herein has been obtained through sources deemed reliable by On Q Commercial Real Estate but cannot be guaranteed for its accuracy. We recommend to the buyer or lessee that any information, which is of special interest, should be obtained through independent verification. ALL MEASUREMENTS ARE APPROXIMATE.



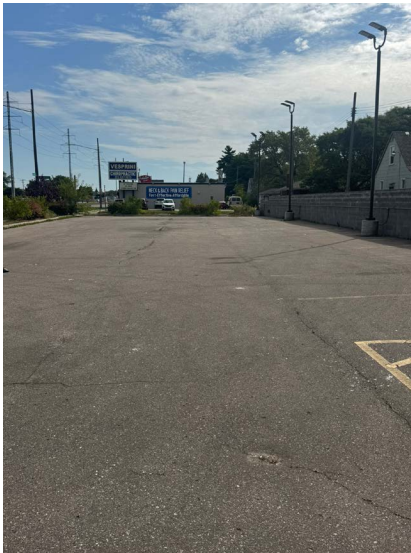

The information contained herein has been obtained through sources deemed reliable by On Q Commercial Real Estate but cannot be guaranteed for its accuracy. We recommend to the buyer or lessee that any information, which is of special interest, should be obtained through independent verification. ALL MEASUREMENTS ARE APPROXIMATE.



INTERIOR PHOTOS  
**EIGHT MILE ROAD**



The information contained herein has been obtained through sources deemed reliable by On Q Commercial Real Estate but cannot be guaranteed for its accuracy. We recommend to the buyer or lessee that any information, which is of special interest, should be obtained through independent verification. ALL MEASUREMENTS ARE APPROXIMATE.



OnQ  
COMMERCIAL  
REAL ESTATE

**JOE QONJA**

Principal Broker

C: (248) 977-7799

O: (248) 712-3300

E: [joe@onqcre.com](mailto:joe@onqcre.com)

**LEO ALLUS**

Associate

C: (248) 321-3325

O: (248) 712-3300

E: [leo@onqcre.com](mailto:leo@onqcre.com)

100 W. Long Lake Rd. Suite 122 Bloomfield Hills, MI 48304

**[www.onqcre.com](http://www.onqcre.com)**

The information contained herein has been obtained through sources deemed reliable by On Q Commercial Real Estate but cannot be guaranteed for its accuracy. We recommend to the buyer or lessee that any information, which is of special interest, should be obtained through independent verification. ALL MEASUREMENTS ARE APPROXIMATE.