



2425 W
L
S

100K+ RSF OF FULLY
FURNISHED, MOVE-IN
READY SPACE

WELCOME TO 2425 WEST LOOP SOUTH

An Iconic West Loop Address Designed by I.M. Pei

Elevate your presence in Houston's most premier submarket. With unparalleled visibility, this building is the perfect foundation for headquarters-style expression

- Up to 284,000 RSF contiguous availability
- Over 100,000 RSF move-in ready space outfitted with high-end Herman Miller furniture and CAT 6 cabling
- On-building and garage signage available — visible by thousands on a daily basis
- World-renowned I.M. Pei design featuring a dramatic 10,000 RSF lobby that signals prestige
- Strategically positioned with unmatched access to Loop 610, I-69, and Westpark Tollway — leveraging visibility and convenience

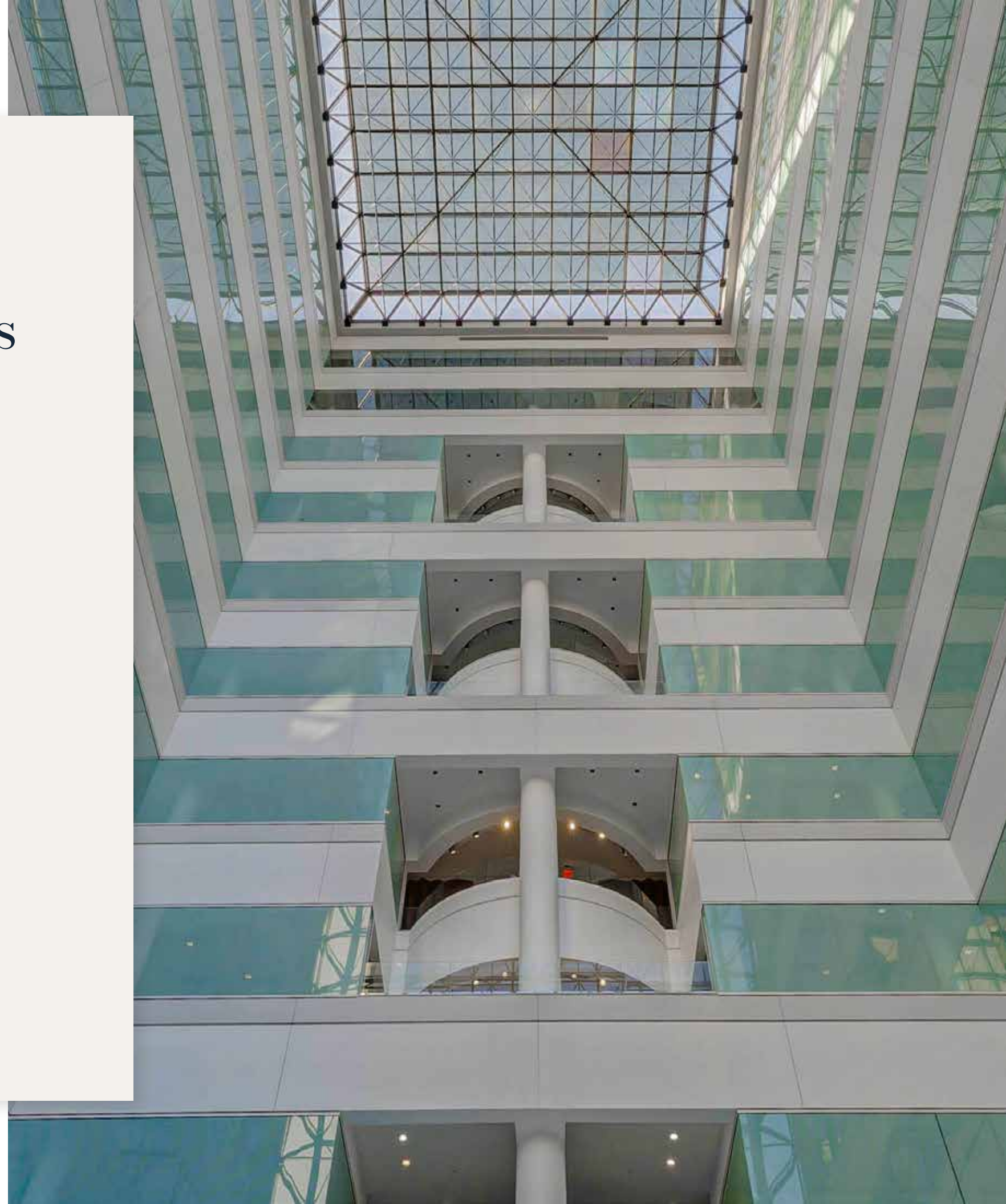



A Building Reflects The Caliber of Your Business

BUILDING FEATURES

- Building conference center, tenant lounge, and fitness center with locker rooms
- Impressive 10,000 SF atrium lobby surrounded by glass and filled with natural light
- Class-A lobby finishes, updated security desk, and comfortable seating areas
- Efficient 27,000 RSF floor plates with continuous window lines and skyline views
- Connected multi-level parking garage with covered walkway to building
- Outdoor patio and seating area
- A building that's not just maintained, but future-proofed. 2025 capital upgrades include a new roof, cooling tower, lighting, and garage paint



OUTDOOR PATIO SEATING



CONFERENCE CENTER



Everything you need, exactly where you need it

Amenities that attract and retain top talent, impress partners, and position your brand — all backed by on-site management and 24-hour security

FITNESS CENTER WITH LOCKER ROOMS

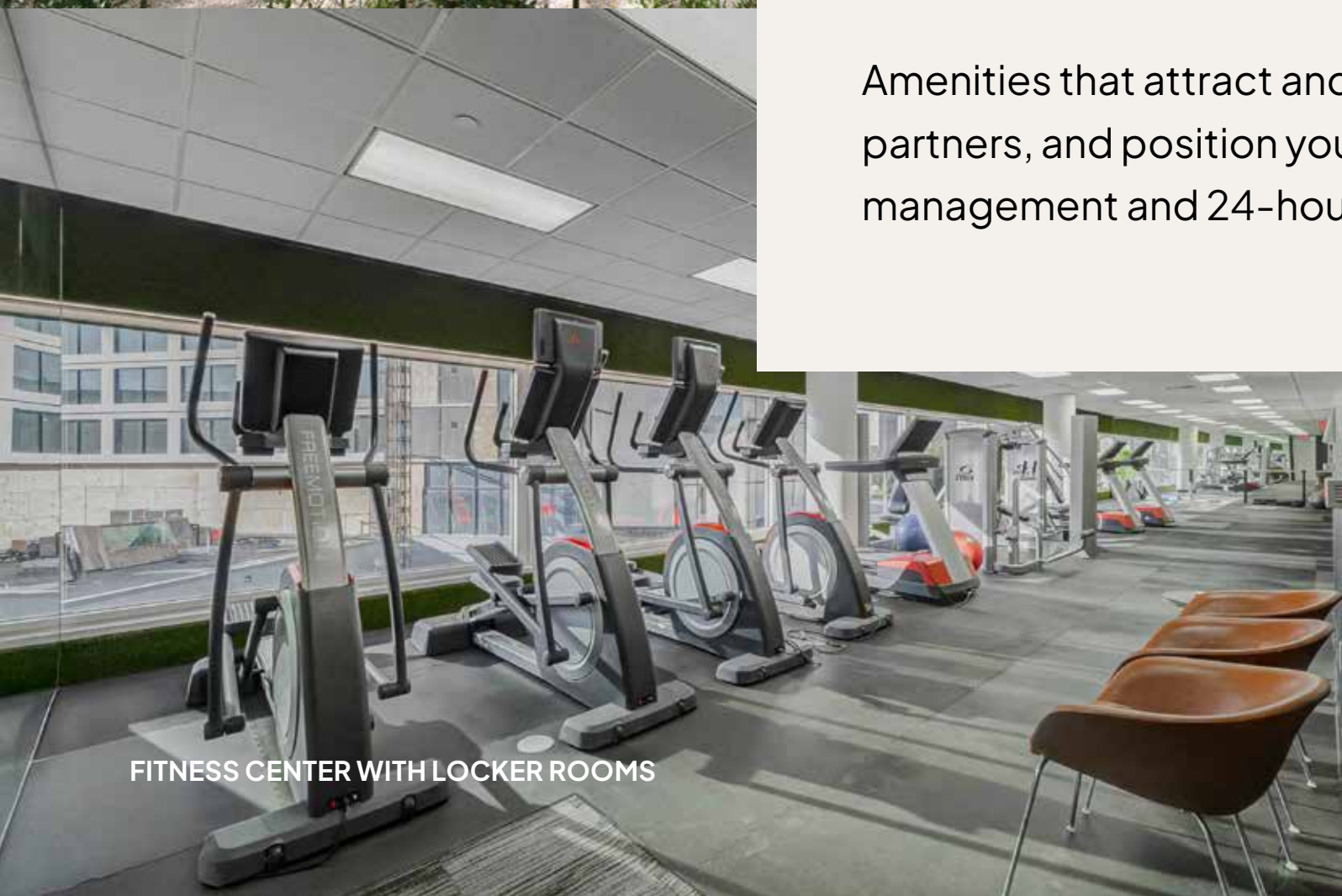

TENANT LOUNGE ON FIRST FLOOR

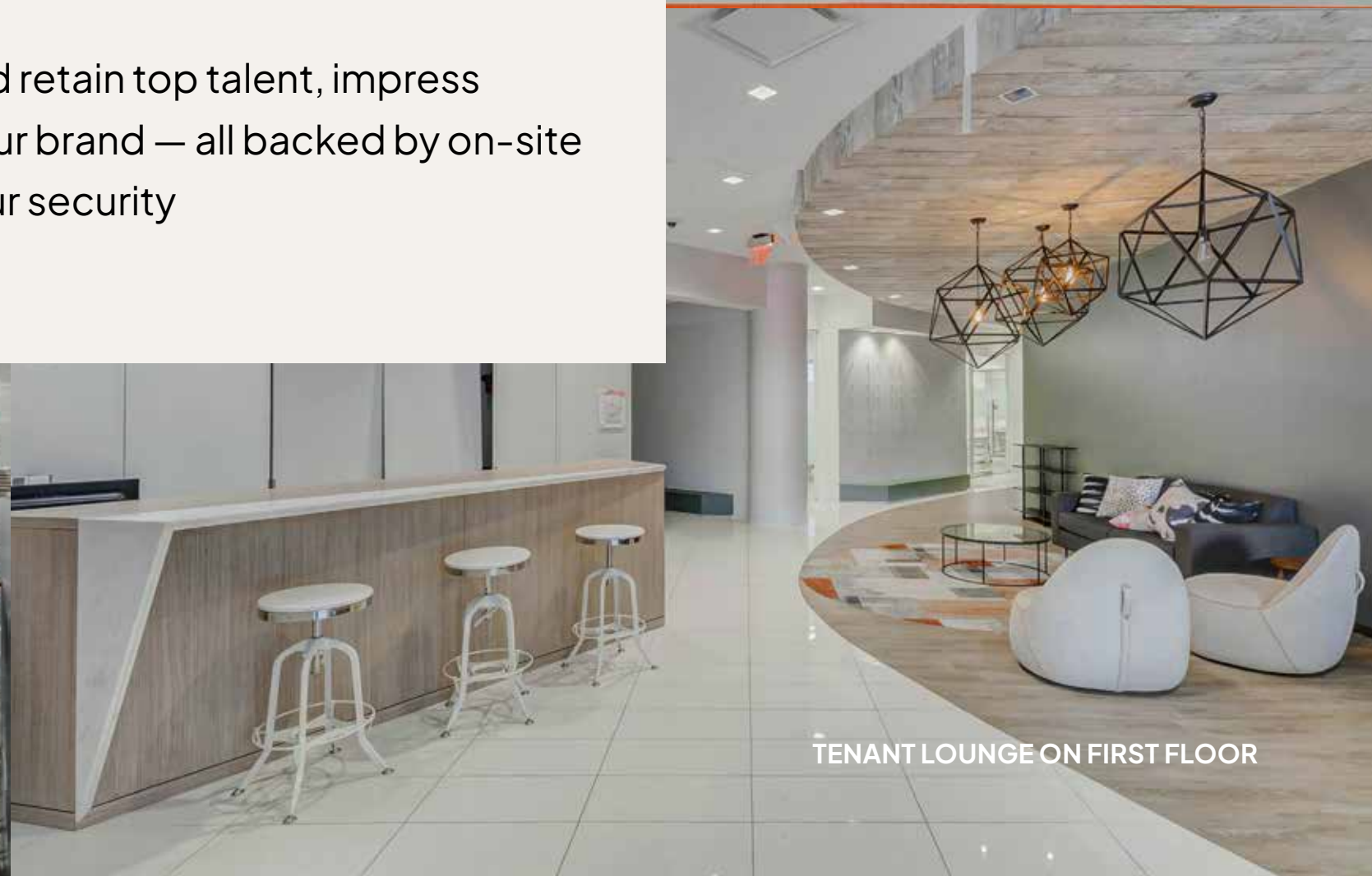

284K+RSF Contiguous Block Available

■ FULLY BUILT OUT AND FURNISHED:

- Efficient 27K RSF+: floor plates ideal for open or closed layouts
- Expansive windows and open balconies over looking the atrium lobby
- Interconnecting stairwell between levels 10 & 11
- High-end Herman Miller furniture available

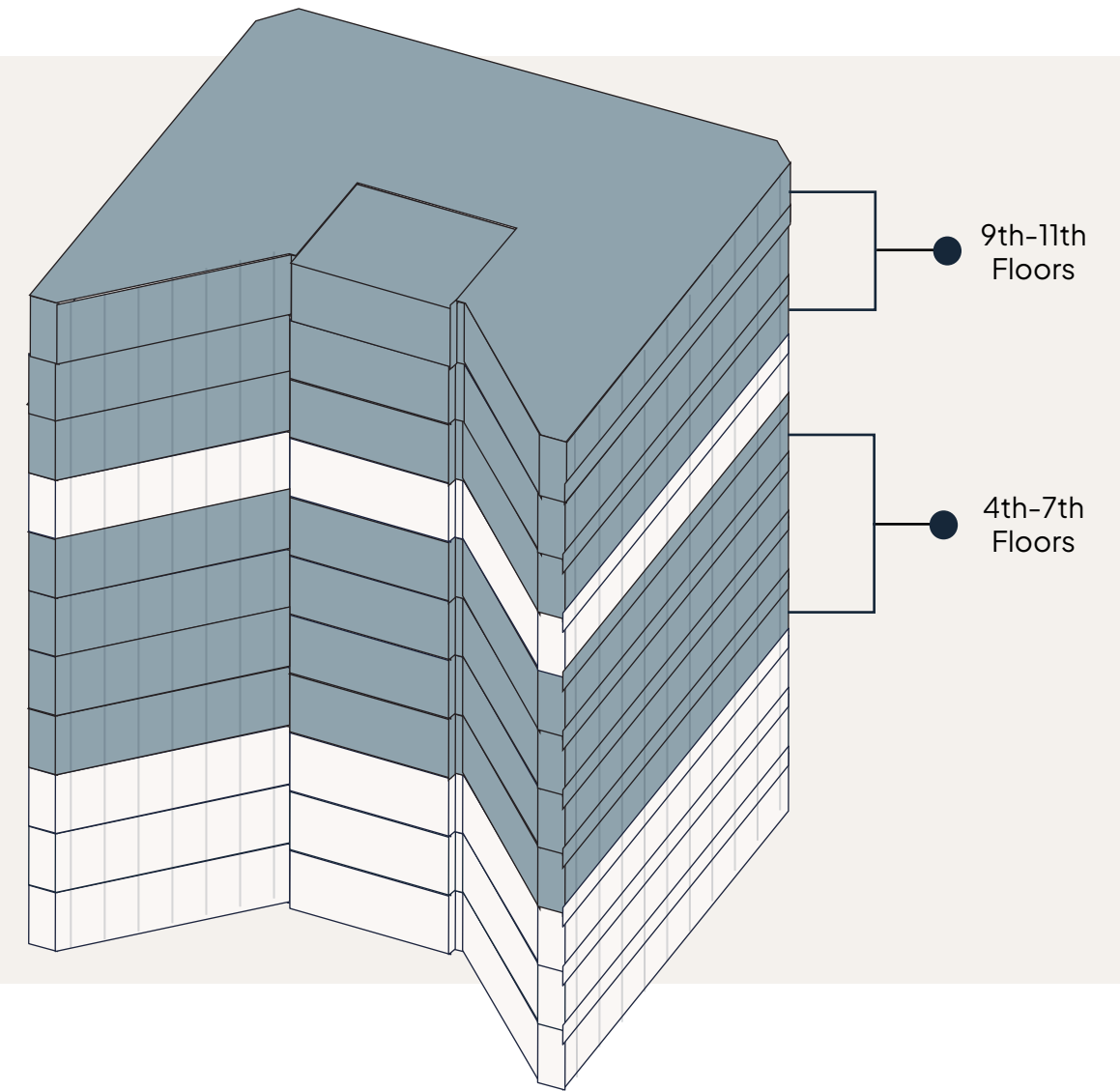

Typical Floor Plan

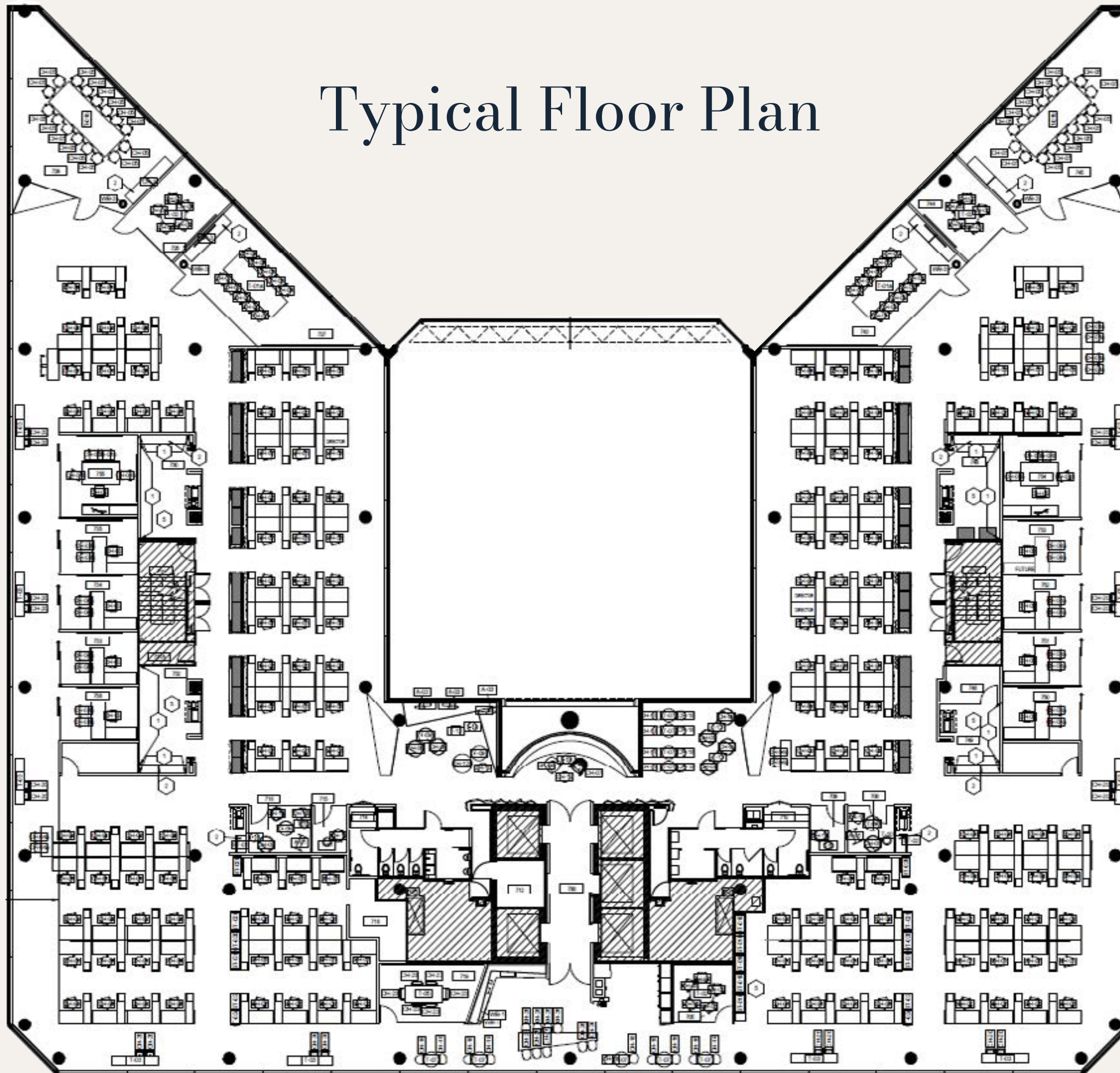

151 Workstations

11 Offices

10 Conference/Huddles

Your brand, in lights, visible to thousands

Anchor tenant signage that
elevates your brand — from skyline
visibility to garage exposure

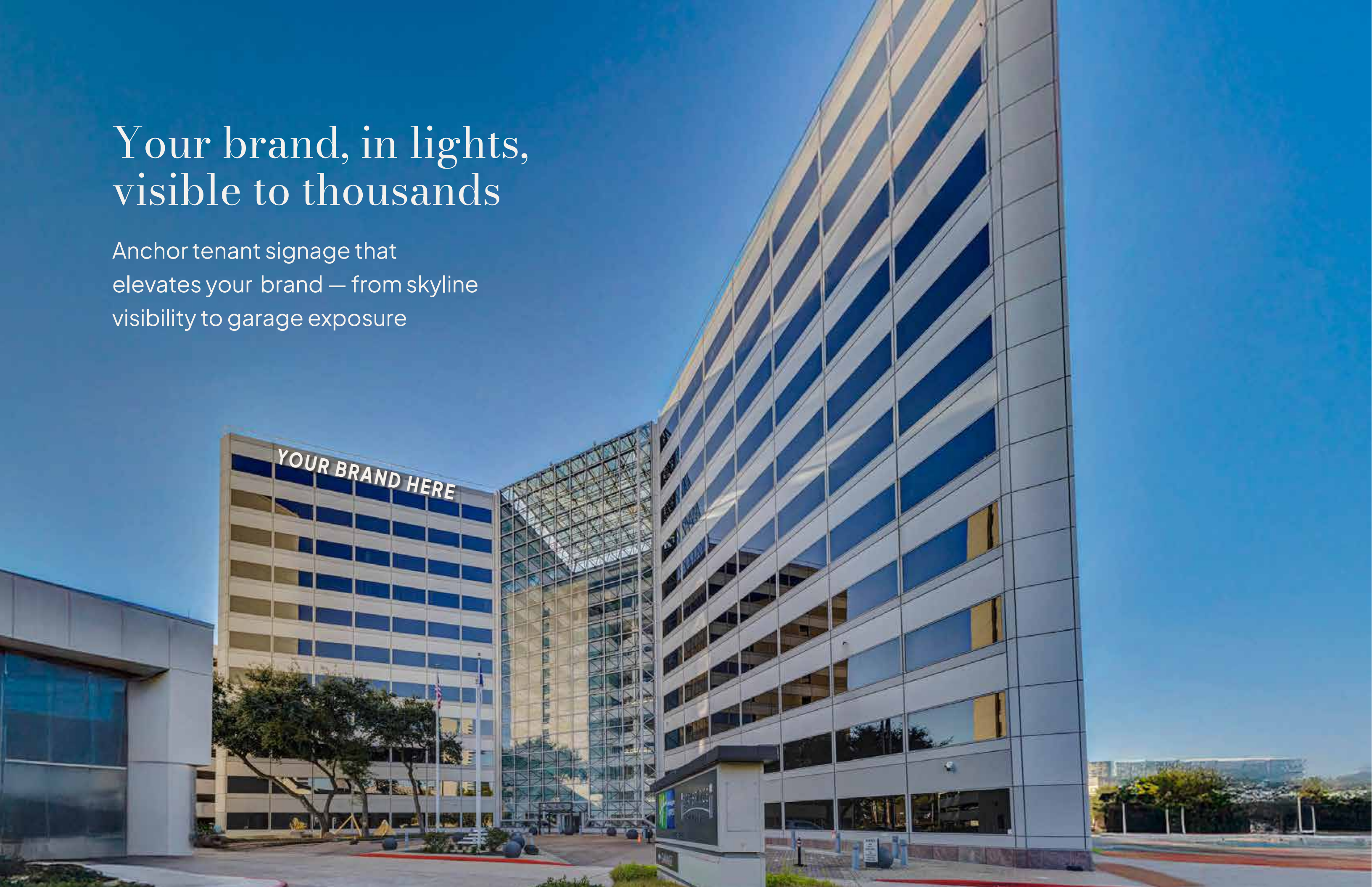

Strategically positioned in the heart of the Galleria

2425 West Loop South offers unmatched accessibility and visibility. Tenants benefit from immediate access to Loop 610, I-10, I-69 and Westpark Tollway, and walkable to Houston's premier West Loop retail, dining, River Oaks District, The Greenleigh Hotel and hospitality options





2425 WLS

For Leasing
Information Contact

Jack Scharnberg

713.407.8717

Jack.Scharnberg@transwestern.com

Kelli Gault

713.270.3349

Kelli.Gault@transwestern.com

Doug Little

713.272.1284

Doug.Little@transwestern.com

 **TRANSWESTERN**

SLS 
Properties