

# GLENNWOOD COMMONS

## RETAIL AND OUTPARCELS FOR LEASE

820-870 & 880-1000 SUNBURY ROAD, DELAWARE, OH.



**JESSE SHKOLNIK** ADVISOR

MOBILE 614.208.5360 | DIRECT 614.334.7818  
JSHKOLNIK@EQUITY.NET



**MATT COOPER** SENIOR VICE PRESIDENT

MOBILE 614.403.4732 | DIRECT 614.334.7731  
MCOOPER@EQUITY.NET



# PROPERTY HIGHLIGHTS

## GLENNWOOD COMMONS

RETAIL AND OUTPARCELS FOR LEASE  
820-870 & 880-1000 SUNBURY ROAD, DELAWARE, OHIO

- 1,403 SF to 6,600 SF contiguous inline space available
- Three outparcels available:
  - Lot 3: +/- 1.642 acres for lease/BTS
  - Lot 10: +/- 2.360 acres for lease/BTS
  - Lot 11: +/- 0.700 acres for lease/BTS
- Strong co-tenancy with Kohl's, Meijer, Dollar Tree, and Discount Fashion Warehouse
- Multiple signalized entrances and ample parking
- 28,008 vehicles per day on Route 36/37
- Delaware County is the 21st fastest growing county in the United States (22.9% population increase from 2010 to 2020)



# AERIAL



# TENANTS: 820-870

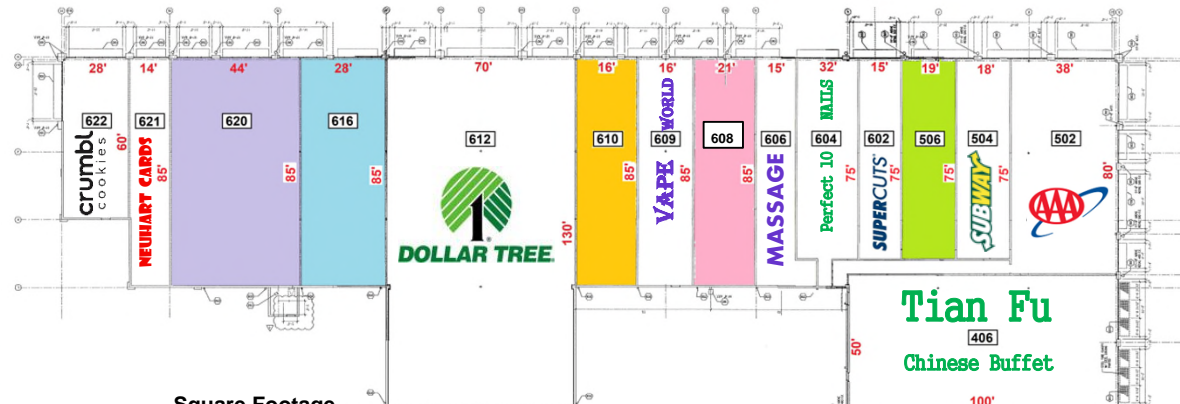

Suite	Tenant	Square Footage
202	Veterans Admin. Medical Center	6,000
210	Veterans Admin. Medical Center	4,800
212	Sally Beauty Supply	1,600
300	Pet Supplies Plus	8,000
402	La Matraca Restaurant	5,000
406	Tian Fu Chinese Buffet	5,000
502	AAA	3,300
504	Subway	1,500
506	AVAILABLE	1,488
602	Super Cuts	1,190
604	Perfect 10 Nails	2,604
606	Massage	1,437
608	AVAILABLE	1,870
609	Vape World	1,428
610	AVAILABLE	1,403
612	Dollar Tree	9,100
616	AVAILABLE	2,600
620	AVAILABLE	4,000
621	Neuhart Cards	1,280
622	Crumbl Cookies	1,700

\*Dimensions Are Approximate



## Glennwood Commons Shadow Anchors, Co-Tenancy, and Outparcels

Meijer	Kohl's	Aspen Dental
Pearle Vision	Acloche' Staffing	Verizon
Mattress Firm	Discount	Tropical Smoothie
Raising Cane's	Fashion	Nova Care
Sheetz	Warehouse	Walk-In Urgent Care
McDonald's	America's Best	
	Contacts &	
	Eyeglasses	

# TENANTS: 880-1000

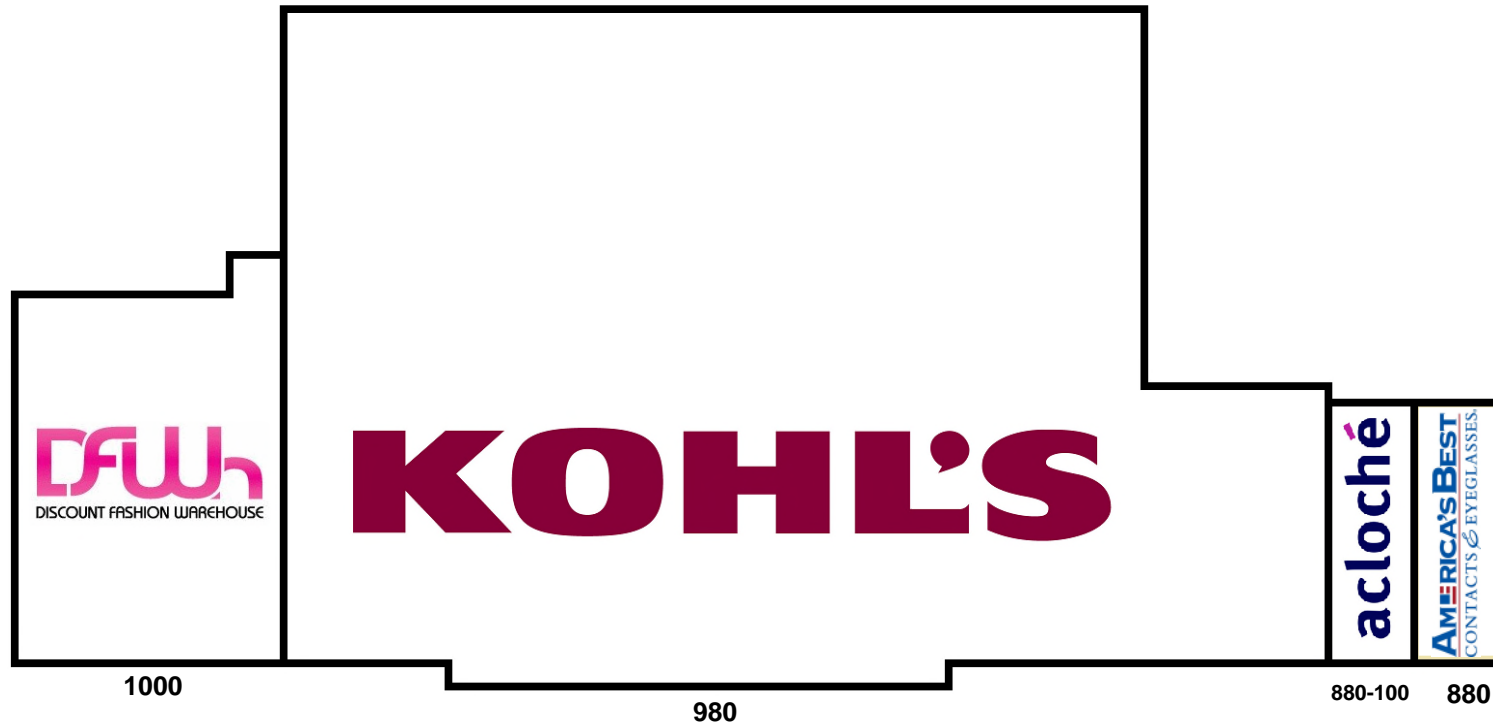

# TENANTS: 1100 (outparcel)

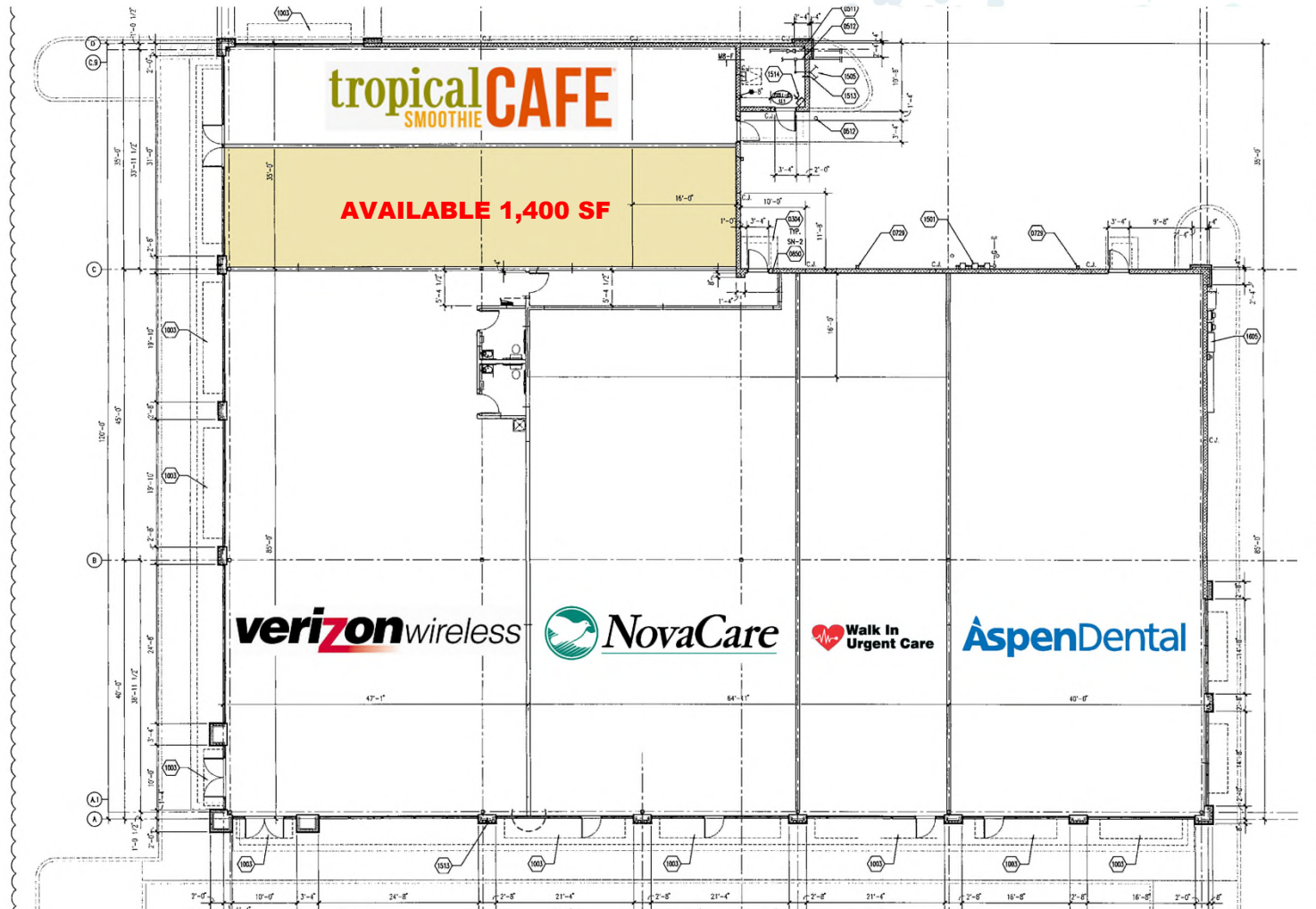

# PHOTOS



# PHOTOS





# AVAILABLE STOREFRONTS



# AVAILABLE STOREFRONT



# 1-MILE RADIUS DEMOS

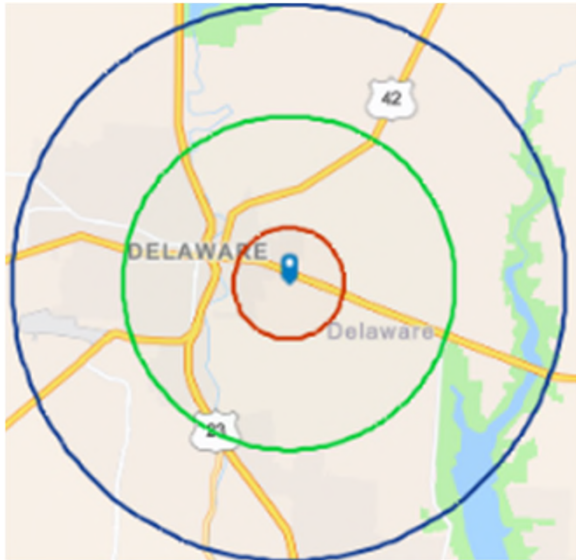

## KEY FACTS

**4,168**  
Population

**2.5**  
Average  
Household Size

**35.8**  
Median Age

**\$80,945**  
Median Household Income

## BUSINESS

**117**

Total Businesses

**1,638**

Total Employees

## EDUCATION

**3%**  
No High School  
Diploma

**31%**  
High School  
Graduate

**33%**  
Some  
College

**33%**  
Bachelor's/Grad/Prof  
Degree

## INCOME

**\$38,813**  
Per Capita  
Income

**80,945**  
Median  
Household  
Income

**\$100,527**  
Average  
Household  
Income

## EMPLOYMENT

**65.3**  
White  
Collar %

**18.5**  
Blue  
Collar %

**16.1**  
Services  
%

**equity** | brokerage

The information contained herein has been obtained from the property owner or other sources that we deem reliable. Although we have no reason to doubt its accuracy, no representation or warranty is made regarding the information, and the property is offered "as is." The submission may be modified or withdrawn at any time by the property owner.

# 3-MILE RADIUS DEMOS

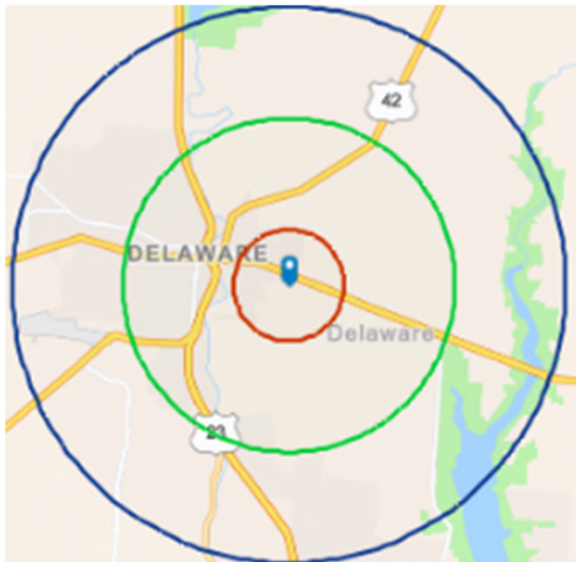

## KEY FACTS

**26,006**  
Population

**2.5**  
Average  
Household Size

**36.0**  
Median Age

**\$77,083**  
Median Household Income

## BUSINESS

**957**

Total Businesses

**11,548**

Total Employees

## EDUCATION

**5%**

No High School  
Diploma

**28%**

High School  
Graduate

**28%**

Some  
College

**40%**

Bachelor's/Grad/Prof  
Degree

## INCOME



**\$38,267**  
Per Capita  
Income



**\$77,083**  
Median  
Household  
Income



**\$98,285**  
Average  
Household  
Income

## EMPLOYMENT

**65.8**  
White  
Collar %

**19.1**  
Blue  
Collar %

**15.1**  
Services  
%

**equity** | brokerage

The information contained herein has been obtained from the property owner or other sources that we deem reliable. Although we have no reason to doubt its accuracy, no representation or warranty is made regarding the information, and the property is offered "as is." The submission may be modified or withdrawn at any time by the property owner.

# 5-MILE RADIUS DEMOS

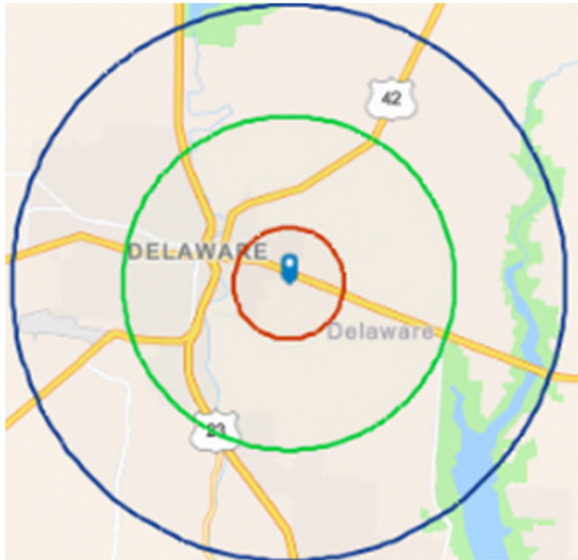

## KEY FACTS

**54,721**  
Population

**2.6**  
Average  
Household Size

**36.9**  
Median Age

**\$87,292**  
Median Household Income

## BUSINESS

**1,441**

Total Businesses

**17,841**

Total Employees

## EDUCATION

**4%**

No High School  
Diploma

**24%**

High School  
Graduate

**26%**

Some  
College

**46%**

Bachelor's/Grad/Prof  
Degree

## INCOME



**\$42,352**  
Per Capita  
Income



**\$87,292**  
Median  
Household  
Income



**\$112,591**  
Average  
Household  
Income

## EMPLOYMENT

**68.8**  
White  
Collar %

**16.4**  
Blue  
Collar %

**14.8**  
Services  
%

**equity** | brokerage

The information contained herein has been obtained from the property owner or other sources that we deem reliable. Although we have no reason to doubt its accuracy, no representation or warranty is made regarding the information, and the property is offered "as is." The submission may be modified or withdrawn at any time by the property owner.