

# ZONING FEASIBILITY REPORT



Address(es)	Folio Number(s)
S Allapattah Rd, 33170 0640, Unincorporated County, FL, 33170	3060180000640
SW 224th St, 33170 0650, Unincorporated County, FL, 33170	3060180000650
S Allapattah Rd, 33170 0633, Unincorporated County, FL, 33170	3060180000633

Report Date: 1/11/2025

Folio Number	<b>Multiple</b>	Lot Area	<b>23496 sqft</b>	Remax 360
Address	<b>Multiple</b>	Zoning Code		4217 Ponce de Leon blvd
City	<b>Unincorporated County</b>	Parcel Zoning	<b>BU-1A</b>	Coral Gables, FL

## ZONING ALLOWANCES

Property Location .....	1
Allowed Uses .....	2
Maximum Lot Capacity .....	4
Illustrations .....	5

# ZONING ALLOWANCES

## Property Location

Folio Number	Multiple	Lot Area	23496 sqft	Remax 360
Address	Multiple	Zoning Code		4217 Ponce de Leon blvd
City	Unincorporated County	Parcel Zoning	BU-1A	Coral Gables, FL
	Miami Dade County Unincorporated, FL Zoning Regulations (September 2016)			



AERIAL

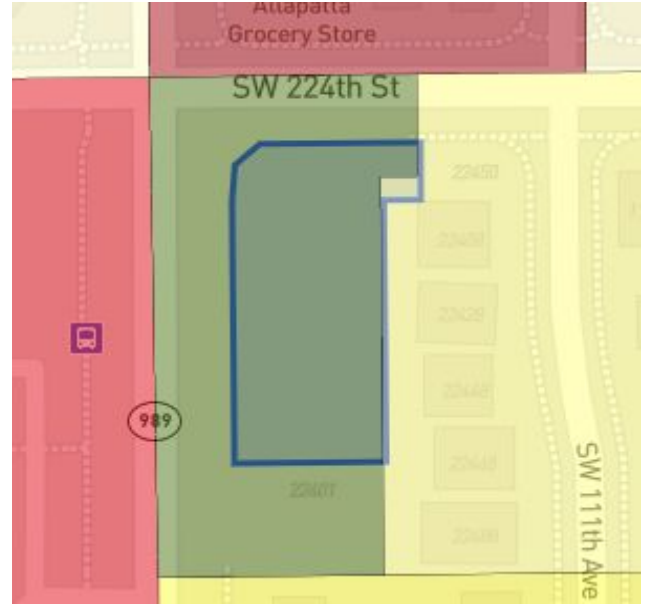

ZONING

BU-1A

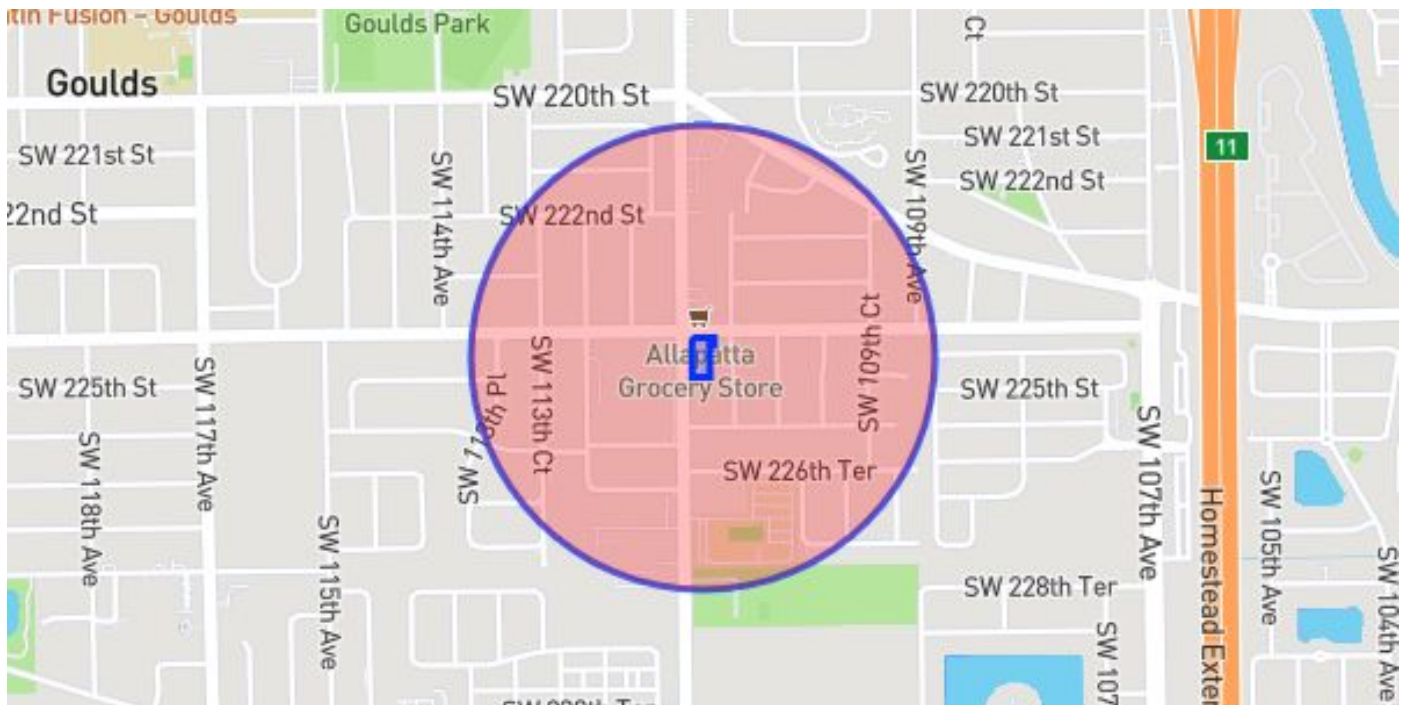

MAP

1/4 mile radius

Folio Number	Multiple	Lot Area	23496 sqft	Remax 360
Address	Multiple	Zoning Code		4217 Ponce de Leon blvd
	Miami Dade County Unincorporated, FL Zoning Regulations (September 2016)			Coral Gables, FL
City	Unincorporated County	Parcel Zoning	BU-1A	

<b>RESIDENTIAL</b>		<b>COMMERCIAL (CONT.)</b>		<b>COMMERCIAL (CONT.)</b>	
Group Residential home	C	Boats carrying passengers on excursion, sightseeing, pleasure or fishing	P	Food and drink stores with outside walk-up window service, no outside stools, tables or chairs	P
Workforce housing	C	Bowling alleys	C	Furniture stores, new, retail only	P
<b>OFFICE</b>		Brew Pubs (restaurant only)	C	Grocery stores	P
Banks with drive-thru facilities	P	Brew Pubs (restaurant, pub or bar with brewery, distillery or winery)	C	Grocery stores, fruit stores, health food stores, delicatessen, meat/fish markets <4000sf	P
Banks without drive-thru facilities	P	Computer, video, video game and DVD stores, related, sales and rental	P	Handcrafted products shop	P
Office building	P	Confectionery, ice cream store and dairy store	P	Hardware stores	P
<b>COMMERCIAL</b>		Conservatories and music and dance schools	C	Health and exercise clubs incl. bath/massage parlor	P
Antique shop (and second hand)	P	Dancing halls / academies in air conditioned building, no intoxicating beverages	C	Home improvement center	C
Apparel store, new and used	P	Dog and pet hospitals in air conditioned buildings	P	Information booth, gate house, security station	P
Art goods stores, artist studios, photography studios, shops and galleries	P	Donated goods centers	C	Interior design shops, office and display only	P
Attended, nonmotorized donation collection vehicle	P	Drug stores	P	Jewelry loan centers	P
Bait and tackle shops	P	Dry cleaning establishments <4000sf	P	Jewelry stores including incidental sales of used jewelry	P
Bakery - retail with baking on premises	P	Electrical appliance and fixtures stores with repair	P	Junior department stores	P
Barber shop	P	Employment agencies	P	Leather goods and luggage shops	P
Beauty parlor	P	Florist shops	P	Mail order offices without storage or products sold	P
Bicycle sales, rental and repair	P				
Billiard room and pool rooms	P				

**P** Permitted by Right    
**C** Conditional    
**SE** by Special Exception    
**N** Not Allowed

Folio Number	Multiple	Lot Area	23496 sqft	Remax 360
Address	Multiple	Zoning Code		4217 Ponce de Leon blvd
City	Unincorporated County	Parcel Zoning	BU-1A	Coral Gables, FL

COMMERCIAL (CONT.)		COMMERCIAL (CONT.)		INDUSTRIAL	
Medical allied training facility	P	Telephone answering service/Telephone exchange	P	Automobile and light truck sales agency or rental	C
Medical observation dormitory	C	Theaters for live stage production and motion pictures	P	Automobile gas stations with mini mart	C
Mortuaries or funeral homes	P	Tobacco shops	P	Automobile new parts and equipment sales only	C
Newsstand	P	Variety stores	P	Automobile storage within a building	P
Optical stores	P			Automobile tires, batteries and accessories	P
Paint and wallpaper stores	P	<b>CIVIC</b>		Automobile washing	P
Pet shops, pet care centers and dog beauty parlors	P	Open-air theaters	P	Dispensing facilities for Low-THC or medical cannabis	P
Pottery shops	P	Public museum	P	Lawnmowers, retail, sales and service	P
Printing shops	P	Religious facilities	C	Motorcycle sales and repairs	P
Pubs and bars	C			Propagating and growing plants for sale. Fertilizer, manure, compost and soil	C
Restaurant with outdoor dining	C	<b>CIVIC SUPPORT</b>			
Restaurants and coffee houses	P	Adult day care center	P		
Restaurants with accessory children's outdoor playground	C	Amusement center	P		
Restaurants with accessory cocktail lounge-bar	P	Auditorium	P		
Self-service mini-warehouse storage facility	C	Convention halls	P		
Shoe stores and shoe repair shops	P	Natatoriums	P		
Skating rinks	C	Post office stations and branches with service to the public	P		
Sporting goods stores	P	Post offices, self service post offices, stations and branches, mail processing centers	P		
Supermarkets	P	Private club, lodge, fraternity or sorority	P		
Tailor shops	P				
Tailor shops <4000 sf	P	<b>EDUCATIONAL</b>			
Telegraph stations	P	Schools (K-12)	C		

**P** Permitted by Right    
**C** Conditional    
**SE** by Special Exception    
**N** Not Allowed

# ZONING ALLOWANCES

## Maximum Lot Capacity

Folio Number	Multiple	Lot Area	23496 sqft	Remax 360
Address	Multiple	Zoning Code	Miami Dade County Unincorporated, FL Zoning Regulations (September 2016)	4217 Ponce de Leon blvd
City	Unincorporated County	Parcel Zoning	BU-1A	Coral Gables, FL

### BUILDING INTENSITY

FAR	0.73
Maximum Built Area	17,152 ft <sup>2</sup>
Building Coverage	40 %
Maximum Building Footprint	9,397 ft <sup>2</sup>
Dwelling Units Allowed	16 units
Maximum Commercial Area	17,152 ft <sup>2</sup>
Maximum Office Area	17,152 ft <sup>2</sup>
Minimum Open Space	18 %

### HEIGHT LIMITATIONS (LEVELS)

Total Building Height	4 Levels
Principal Building Max. Level (Podium)	4 Levels



Main Building  
 Lot  
 Building Setback limit

Folio Number	Multiple	Lot Area	23496 sqft	Remax 360
Address	Multiple	Zoning Code		4217 Ponce de Leon blvd
City	Unincorporated County	Parcel Zoning	BU-1A	Coral Gables, FL
	Miami Dade County Unincorporated, FL Zoning Regulations (September 2016)			

**NORTH ELEVATION**

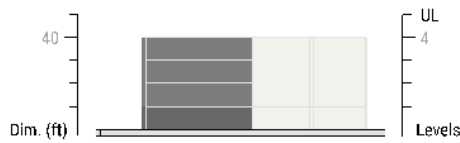

Lot
  Main Building
  Building Setback limit

**EAST ELEVATION**



Lot
  Main Building
  Building Setback limit

## DETAILED INFORMATION

Folio Number	<b>Multiple</b>	Lot Area	<b>23496 sqft</b>	Remax 360
Address	<b>Multiple</b>	Zoning Code		4217 Ponce de Leon blvd
		<b>Miami Dade County Unincorporated, FL Zoning Regulations (September 2016)</b>		Coral Gables, FL
City	<b>Unincorporated County</b>	Parcel Zoning	<b>BU-1A</b>	

### PROPERTY INFORMATION

Lot Area (Property Records)	<b>22,738 sqft</b> - Lot area value derived from publicly available data. To determine the accurate lot area a survey must be performed.
Average Slope	<b>0 %</b>
Overlay	
Additional Information	
Available Waivers	<b>Non-Conformity</b>

### EXISTING BUILDING INFORMATION

Building Area	<b>- sqft</b>
Height	<b>- ft</b>
Levels	<b>- Levels</b>



The contents of these Results are provided for reference purposes only and any determinations the Miami Dade County Unincorporated, FL makes related to the property included in these Results may differ from the Results shown. Any use of these Results is therefore expressly conditioned on the acknowledgement that the Miami Dade County Unincorporated, FL does not guarantee the accuracy, adequacy, completeness or usefulness of any information included in the Results. While every effort has been made to ensure the content, sequence, accuracy, timeliness or completeness of materials presented within the Results, Gridics LLC and the Miami Dade County Unincorporated, FL assume no responsibility for errors or omissions, and explicitly disclaim any representations and warranties, including, without limitation, the implied warranties of merchantability and fitness for a particular purpose. Under no circumstances shall the Results be used for final design or development purposes or be considered to provide any form of approval or permitting for any project. Results are based on basic general calculations that are rounded and are not intended to be legal representations of the depicted data. Furthermore, although the Results are intended to be site specific, they are based on general assumptions, such as development distances, heights and areas. They do not take into account variations such as, but not limited to, easements, topography, or existing built elements. All Results must be independently verified before being relied upon for any particular site design or development.



# SITE PLAN

Folio Number	Multiple	Lot Area	23496 sqft	Remax 360
Address	Multiple	Zoning Code		4217 Ponce de Leon blvd
				Coral Gables, FL
		Miami Dade County Unincorporated, FL Zoning Regulations (September 2016)		
City	Unincorporated County	Parcel Zoning	BU-1A	

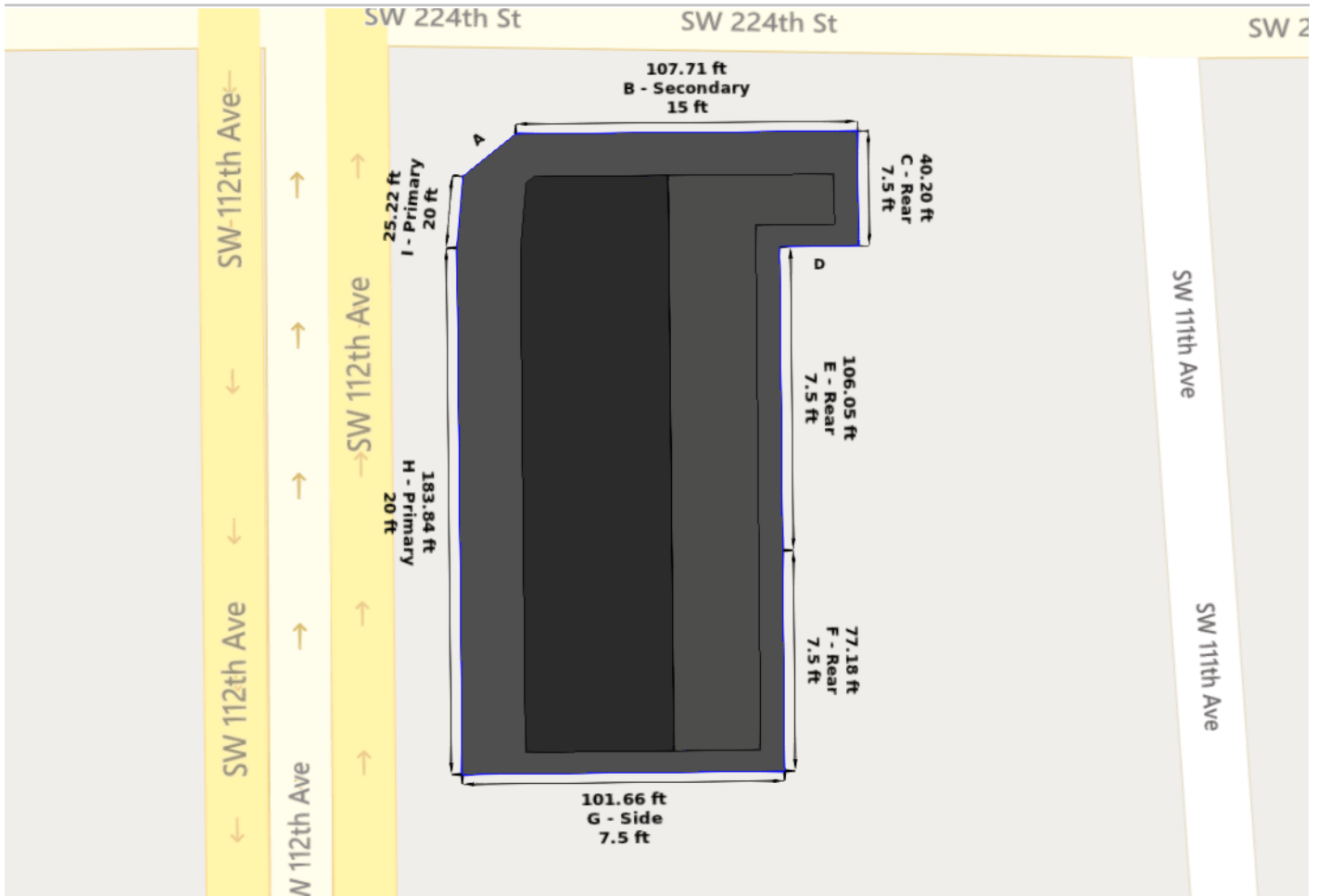

<b>Frontage A</b>	Frontage Type: Secondary	Length: 22.32 ft
Type	Podium	-
Height	1-4 Levels	-
Setback	15 ft Min	-
<hr/>		
<b>Frontage B</b>	Frontage Type: Secondary	Length: 107.71 ft
Type	Podium	-
Height	1-4 Levels	-
Setback	15 ft Min	-

# SITE PLAN

Folio Number	<b>Multiple</b>	Lot Area	<b>23496 sqft</b>	Remax 360
Address	<b>Multiple</b>	Zoning Code		4217 Ponce de Leon blvd
		<b>Miami Dade County Unincorporated, FL Zoning Regulations (September 2016)</b>		Coral Gables, FL
City	<b>Unincorporated County</b>	Parcel Zoning	<b>BU-1A</b>	

<b>Frontage C</b>	Frontage Type: Rear	Length: 40.2 ft
Type	Podium	-
Height	1-4 Levels	-
Setback	7.5 ft Min	-
<b>Frontage D</b>	Frontage Type: Side	Length: 24.83 ft
Type	Podium	-
Height	1-4 Levels	-
Setback	7.5 ft Min	-
<b>Frontage E</b>	Frontage Type: Rear	Length: 106.05 ft
Type	Podium	-
Height	1-4 Levels	-
Setback	7.5 ft Min	-
<b>Frontage F</b>	Frontage Type: Rear	Length: 77.18 ft
Type	Podium	-
Height	1-4 Levels	-
Setback	7.5 ft Min	-
<b>Frontage G</b>	Frontage Type: Side	Length: 101.66 ft
Type	Podium	-
Height	1-4 Levels	-
Setback	7.5 ft Min	-
<b>Frontage H</b>	Frontage Type: Primary	Length: 183.84 ft
Type	Podium	-
Height	1-4 Levels	-
Setback	20 ft Min	-



The contents of these Results are provided for reference purposes only and any determinations the Miami Dade County Unincorporated, FL makes related to the property included in these Results may differ from the Results shown. Any use of these Results is therefore expressly conditioned on the acknowledgement that the Miami Dade County Unincorporated, FL does not guarantee the accuracy, adequacy, completeness or usefulness of any information included in the Results. While every effort has been made to ensure the content, sequence, accuracy, timeliness or completeness of materials presented within the Results, Gridics LLC and the Miami Dade County Unincorporated, FL assume no responsibility for errors or omissions, and explicitly disclaim any representations and warranties, including, without limitation, the implied warranties of merchantability and fitness for a particular purpose. Under no circumstances shall the Results be used for final design or development purposes or be considered to provide any form of approval or permitting for any project. Results are based on basic general calculations that are rounded and are not intended to be legal representations of the depicted data. Furthermore, although the Results are intended to be site specific, they are based on general assumptions, such as development distances, heights and areas. They do not take into account variations such as, but not limited to, easements, topography, or existing built elements. All Results must be independently verified before being relied upon for any particular site design or development.

# SITE PLAN

Folio Number	<b>Multiple</b>	Lot Area	<b>23496 sqft</b>	Remax 360
Address	<b>Multiple</b>	Zoning Code		4217 Ponce de Leon blvd
		<b>Miami Dade County Unincorporated, FL Zoning Regulations (September 2016)</b>		Coral Gables, FL
City	<b>Unincorporated County</b>	Parcel Zoning		
			<b>BU-1A</b>	

<b>Frontage I</b>	Frontage Type: Primary	Length: 25.22 ft
Type	Podium	- - - -
Height	1-4 Levels	- - - -
Setback	20 ft Min	- - - -