

3500 SCOTTS LANE

Philadelphia, PA 19129

 FOR LEASE

 INDUSTRIAL

 10,000 SF



PROPERTY DESCRIPTION

- 10,000 SF available for lease in 175,000 SF industrial building
- Ceiling height: 19' clear
- Loading: 1 tailgate loading platform
- Power: 2000 amp/3 phase 277/480 volt
- 100% conditioned space
- Zoned ICMX - Industrial Commercial Mixed Use
- Property manager on site
- Located in an Opportunity Zone

FOR MORE INFORMATION

Jeffrey Licht, SIOR

 215.396.2900 x101

 jeff.licht@naimertz.com

Jared Licht

 215.396.2900 x105

 jared.licht@naimertz.com

NAI MERTZ DISCLAIMER: NO WARRANTY OR REPRESENTATION, EXPRESS OR IMPLIED, IS MADE AS TO THE ACCURACY OF THE INFORMATION CONTAINED HEREIN, AND THE SAME IS SUBMITTED SUBJECT TO ERRORS, OMISSIONS, CHANGE OF PRICE, RENTAL OR OTHER CONDITIONS, PRIOR SALE, LEASE OR FINANCING, OR WITHDRAWAL WITHOUT NOTICE, AND OF ANY SPECIAL LISTING CONDITIONS IMPOSED BY OUR PRINCIPALS NO WARRANTIES OR REPRESENTATIONS ARE MADE AS TO THE CONDITION OF THE PROPERTY OR ANY HAZARDS CONTAINED THEREIN ARE ANY TO BE IMPLIED. OUTLINES ARE APPROXIMATE AND SHOWN ONLY TO IDENTIFY THE PARCEL IN CONSIDERATION.

NAIMertz

 **NAI Mertz** | 210 E. Street Road, Suite 3B
Feasterville-Trevose, PA 19053
215-396-2900 | naimertz.com



3500 SCOTTS LANE

Philadelphia, PA 19129

 FOR LEASE
 INDUSTRIAL
 10,000 SF

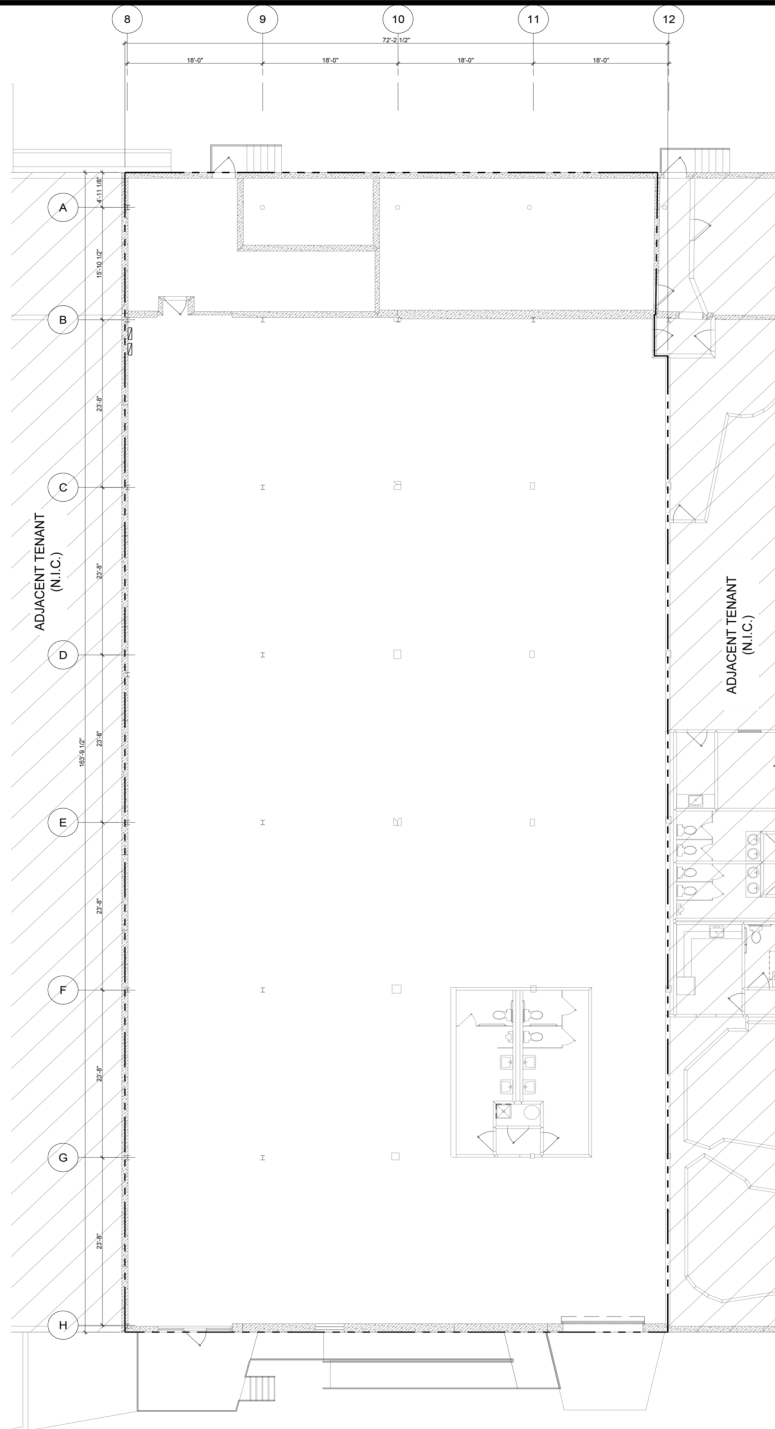

FOR MORE INFORMATION

Jeffrey Licht, SIOR

 215.396.2900 x101

 jeff.licht@naimertz.com

Jared Licht

 215.396.2900 x105

 jared.licht@naimertz.com

NAIMertz

 **NAI Mertz** | 210 E. Street Road, Suite 3B
Feasterville-Trevose, PA 19053
215-396-2900 | naimertz.com

NAI MERTZ DISCLAIMER: NO WARRANTY OR REPRESENTATION, EXPRESS OR IMPLIED, IS MADE AS TO THE ACCURACY OF THE INFORMATION CONTAINED HEREIN, AND THE SAME IS SUBMITTED SUBJECT TO ERRORS, OMISSIONS, CHANGE OF PRICE, RENTAL OR OTHER CONDITIONS, PRIOR SALE, LEASE OR FINANCING, OR WITHDRAWAL WITHOUT NOTICE, AND OF ANY SPECIAL LISTING CONDITIONS IMPOSED BY OUR PRINCIPALS NO WARRANTIES OR REPRESENTATIONS ARE MADE AS TO THE CONDITION OF THE PROPERTY OR ANY HAZARDS CONTAINED THEREIN ARE ANY TO BE IMPLIED. OUTLINES ARE APPROXIMATE AND SHOWN ONLY TO IDENTIFY THE PARCEL IN CONSIDERATION.



3500 SCOTTS LANE

Philadelphia, PA 19129

 FOR LEASE

 INDUSTRIAL

 11,787 SF

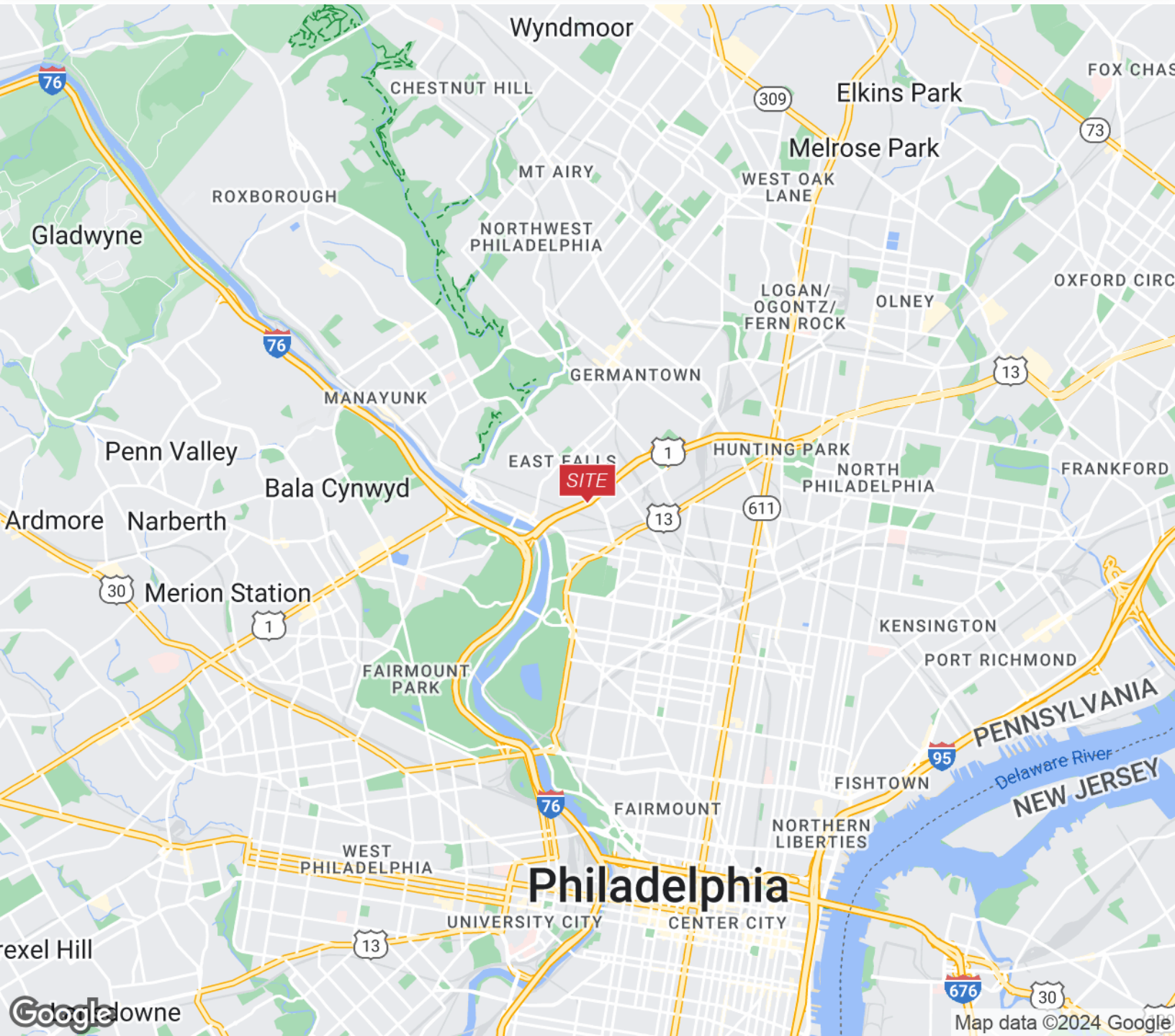

FOR MORE INFORMATION

Jeffrey Licht, SIOR

 215.396.2900 x101

 jeff.licht@naimertz.com

Jared Licht

 215.396.2900 x105

 jared.licht@naimertz.com

NAIMertz

 NAI Mertz | 210 E. Street Road, Suite 3B

Feasterville-Treose, PA 19053

215-396-2900 | naimertz.com

NAI MERTZ DISCLAIMER: NO WARRANTY OR REPRESENTATION, EXPRESS OR IMPLIED, IS MADE AS TO THE ACCURACY OF THE INFORMATION CONTAINED HEREIN, AND THE SAME IS SUBMITTED SUBJECT TO ERRORS, OMISSIONS, CHANGE OF PRICE, RENTAL OR OTHER CONDITIONS, PRIOR SALE, LEASE OR FINANCING, OR WITHDRAWAL WITHOUT NOTICE, AND OF ANY SPECIAL LISTING CONDITIONS IMPOSED BY OUR PRINCIPALS. NO WARRANTIES OR REPRESENTATIONS ARE MADE AS TO THE CONDITION OF THE PROPERTY OR ANY HAZARDS CONTAINED THEREIN ARE ANY TO BE IMPLIED. OUTLINES ARE APPROXIMATE AND SHOWN ONLY TO IDENTIFY THE PARCEL IN CONSIDERATION.

