

# World Trade Center at City Creek

60 E. SOUTH TEMPLE  
SALT LAKE CITY, UT 84111

## For Sublease

14th Floor Sublease

16,387 RSF

Sublease expiration date:  
March 30, 2031

### Property Highlights

- Rental rate available upon request
- Cool, creative space
- Plug and play – FFE available
- Strong credit sublessor
- Possession arranged
- Parking available
- On-site property management
- Adjacent to City Creek Center which has over 100 national stores and restaurants
- Easy walking distance to bus stations, TRAX and FrontRunner stations



*For information, please contact:*

#### Trigger Reital

*Executive Managing Director*  
t 801-578-5507  
treital@newmarkmw.com

#### Jeff Rossi

*Executive Managing Director*  
t 801-578-5508  
jrossi@newmarkmw.com

#### Din Huremovic

*Brokerage Services Specialist*  
t 801-578-5506  
dhuremovic@newmarkmw.com

376 E. 400 S.  
Suite 120  
Salt Lake City, UT 84111

## NEWMARK



The information contained herein has been obtained from sources deemed reliable but has not been verified and no guarantee, warranty or representation, either express or implied, is made with respect to such information. Terms of sale or lease and availability are subject to change or withdrawal without notice.



## WORLD TRADE CENTER AT CITY CREEK

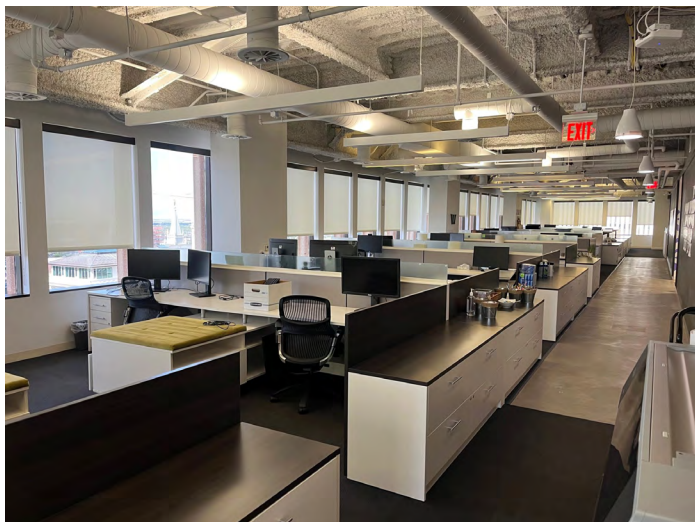

## WORLD TRADE CENTER AT CITY CREEK

### FLOOR 14 16,387 SF Available

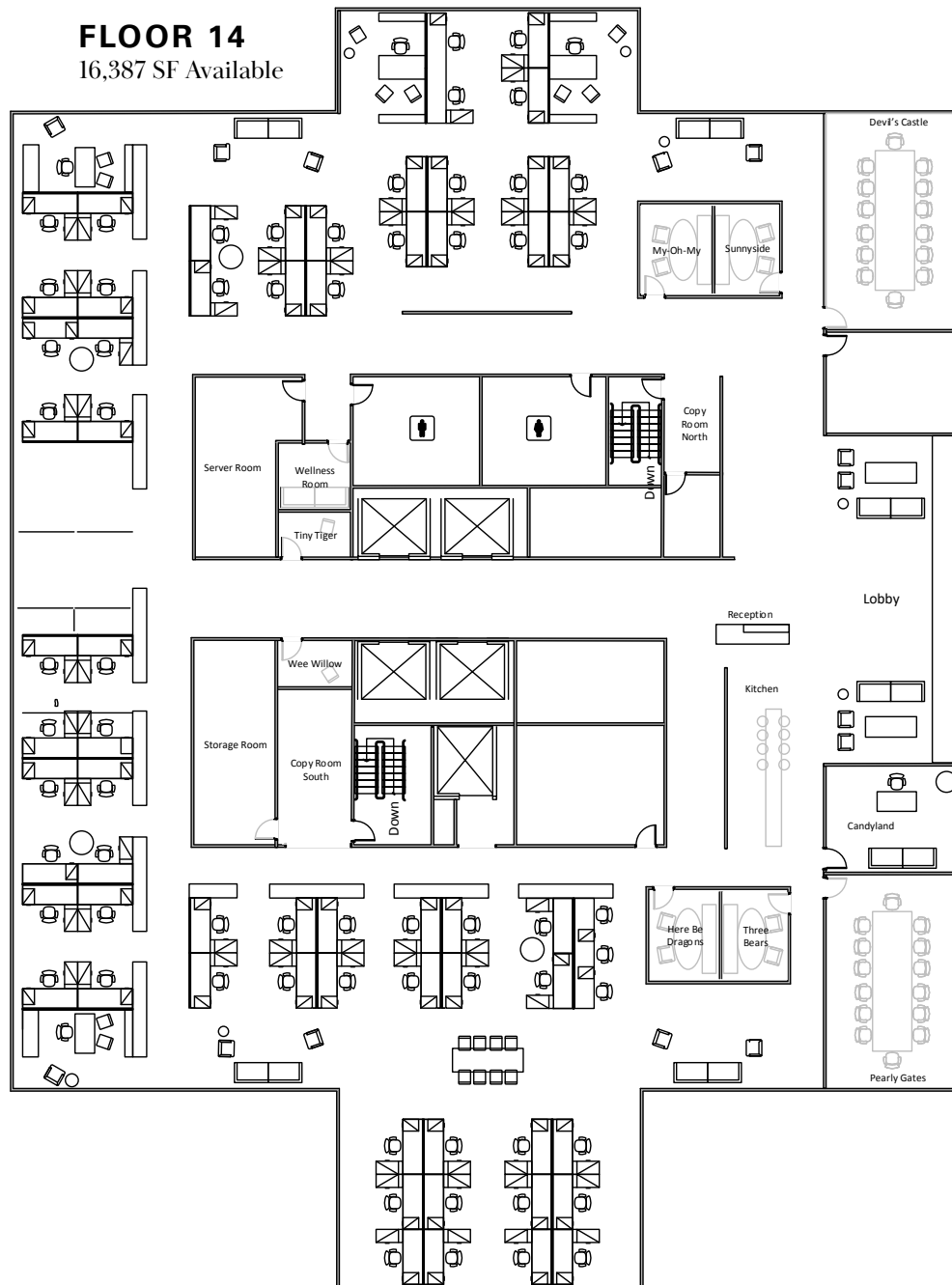

- 70 seats
- Two larger conference rooms that are set up to seat eight at the table with video capability
- Four smaller back to back conference rooms that are set up to set 4-5 max with bench seating
- One (north side) conference room that could also be used as an office
- One (south side) office that could be used as a conference room
- Two phone rooms in elevator hallway

**NEWMARK**

 **MOUNTAIN WEST**



