



2901-2925 N 29th Dr
Phoenix

For Lease
±269,539 SF Industrial Building

Bay
11

Bay
20

Accelerating success.

2901-2925 N 29th Dr. Phoenix, AZ | For Lease

Property Profile

- ½ Mile from I-17 & Grand Ave/US-60
- 14'-20' Clear Height
- Shared Dock High & Grade Level Loading
 - Thirteen (13) Dock High Doors
 - Two (2) Grade-Level Doors
- Zoning: A-2, City of Phoenix
- Minimal Office Space
- Common Area Restrooms
- Sprinklers: Wet
- Rental Structure: Industrial Gross
 - Includes Water, Trash, and Sprinklers
- 5% Fee to procuring Broker



Contact

Keri Scott, SIOR
Senior Vice President
C +1 602 386 7153
keri.scott@colliers.com

Chris Reese
Associate Vice President
C +1 480 748 1834
chris.reese@colliers.com

Alex Kas-Marogi
Associate
C +1 248 881 6376
alex.kas-marogi@colliers.com

Colliers
2390 East Camelback Rd
Suite 100
Phoenix, AZ 85016
colliers.com/arizona



2901-2925 N 29th Dr. Phoenix, AZ | For Lease

Suite 11

±15,395 SF

Rent/SF + CAM/SF

\$0.75 + \$0.05

*36 month requirement
4% Annual Bumps

VIEW THE SPACE WITH OUR VIRTUAL TOUR [CLICK HERE](#)



Contact

Keri Scott, SIOR
Senior Vice President
C +1 602 386 7153
keri.scott@colliers.com

Chris Reese
Associate Vice President
C +1 480 748 1834
chris.reese@colliers.com

Alex Kas-Marogi
Associate
C +1 248 881 6376
alex.kas-marogi@colliers.com

Colliers
2390 East Camelback Rd
Suite 100
Phoenix, AZ 85016
colliers.com/arizona



2901-2925 N 29th Dr. Phoenix, AZ | For Lease

Suite 20

±2,245 SF

Rent/SF + CAM/SF

\$0.85 + \$0.05

*36 month requirement
4% Annual Bumps



VIEW THE SPACE WITH OUR VIRTUAL TOUR [CLICK HERE](#)



Contact

Keri Scott, SIOR
Senior Vice President
C +1 602 386 7153
keri.scott@colliers.com

Chris Reese
Associate Vice President
C +1 480 748 1834
chris.reese@colliers.com

Alex Kas-Marogi
Associate
C +1 248 881 6376
alex.kas-marogi@colliers.com

Colliers
2390 East Camelback Rd
Suite 100
Phoenix, AZ 85016
colliers.com/arizona



2901-2925 N 29th Dr. Phoenix, AZ | For Lease

Common Area

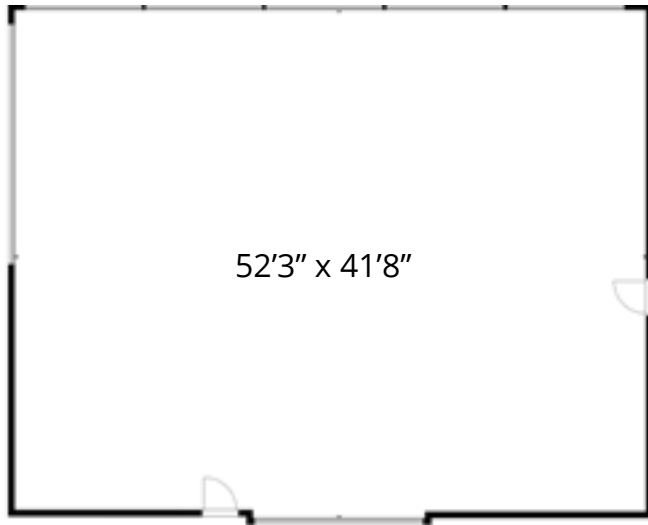

Contact

Keri Scott, SIOR
Senior Vice President
C +1 602 386 7153
keri.scott@colliers.com

Chris Reese
Associate Vice President
C +1 480 748 1834
chris.reese@colliers.com

Alex Kas-Marogi
Associate
C +1 248 881 6376
alex.kas-marogi@colliers.com

Colliers
2390 East Camelback Rd
Suite 100
Phoenix, AZ 85016
colliers.com/arizona



2901-2925 N 29th Dr. Phoenix, AZ | For Lease

Location & Access

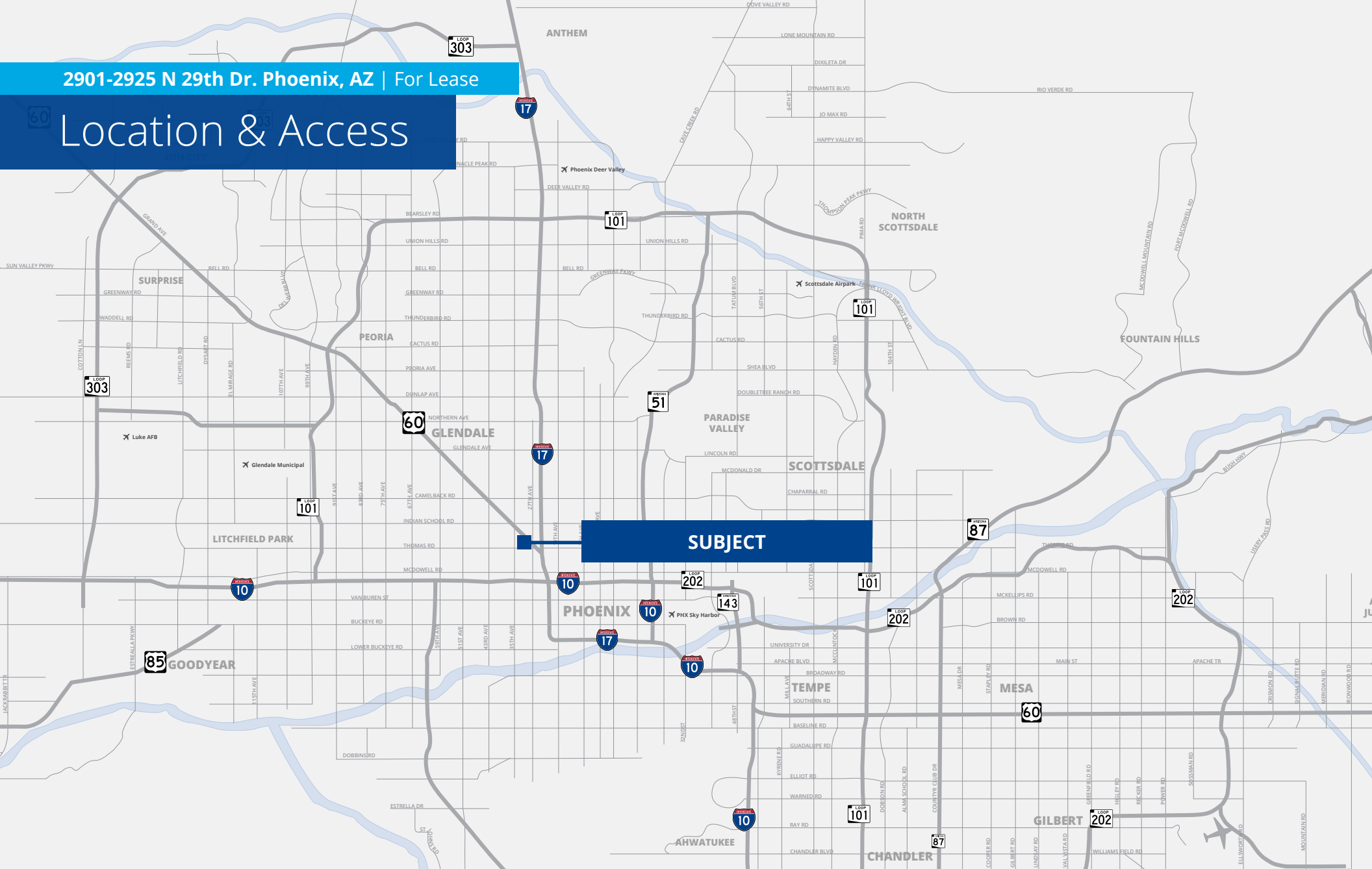

Contact

Keri Scott, SIOR
Senior Vice President
C +1 602 386 7153
keri.scott@colliers.com

Chris Reese
Associate Vice President
C +1 480 748 1834
chris.reese@colliers.com

Alex Kas-Marogi
Associate
C +1 248 881 6376
alex.kas-marogi@colliers.com

Colliers
2390 East Camelback Rd
Suite 100
Phoenix, AZ 85016
colliers.com/arizona

