



**FOR  
LEASE**

**PARK 370 CENTER 1**  
1601 PARK 370 PLACE  
HAZELWOOD, MO 63042

## 110,075 SF CLASS-A INDUSTRIAL WITH TRAILER PARKING

### Property Highlights

Total Building Area:	344,765 SF
Total Available Area:	110,075 SF
Office Area:	1,800 SF
Clear Height:	30'
Loading:	16 (9'x10') Docks (9 Future) 1 (12'x14') Drive-In
Car Parking:	38 Spaces
Trailer Parking:	15 Stalls
Column Spacing:	50' x 40'
Speed Bays:	50' x 50'
Building Depth:	210'
Building Type:	Concrete Tilt Up
Power:	400 Amps, 480/277 Volt, 3 Phase 4 Wire
Fire Suppression:	ESFR
Lighting:	LED (Motion Sensors)
Lease Rate:	<b>\$4.50/SF NNN</b>

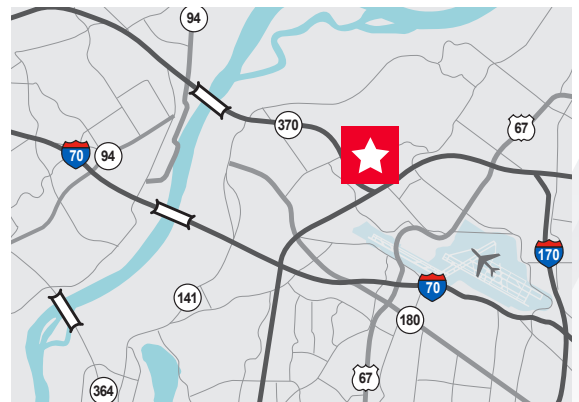

### Contact

MATT EASTIN, SIOR, CCIM  
+1 314 746 0350  
matt.eastin@cushwake.com

ED LAMPITT, SIOR, CCIM  
+1 314 746 0383  
ed.lampitt@cushwake.com



**FOR LEASE**  
**1601 Park 370 Place**  
Hazelwood, MO 63042



**AERIAL**



**FLOOR PLAN**

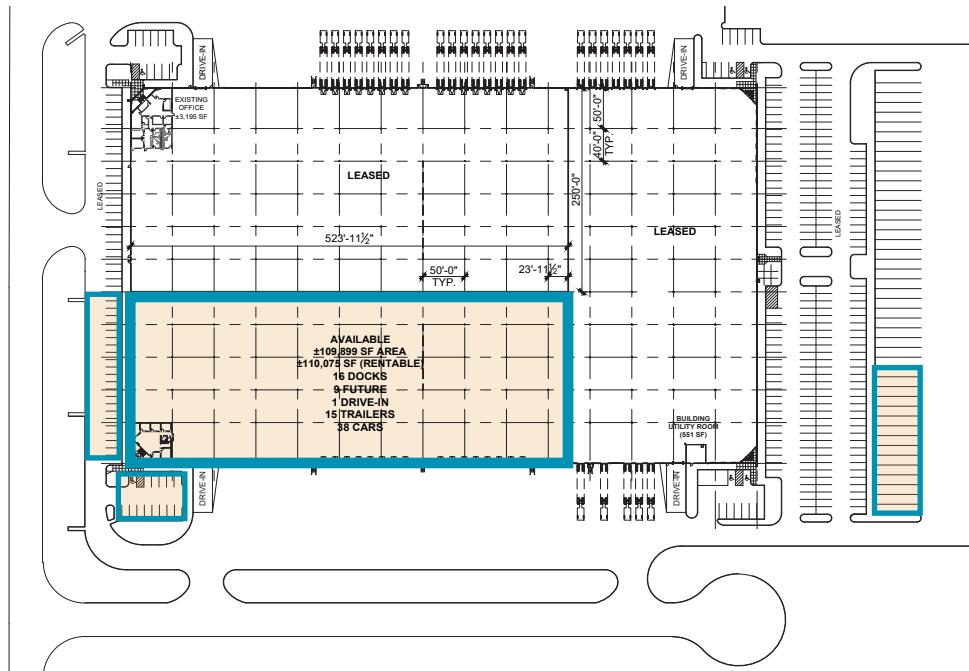

©2024 Cushman & Wakefield. All rights reserved. The information contained in this communication is strictly confidential. This information has been obtained from sources believed to be reliable but has not been verified. NO WARRANTY OR REPRESENTATION, EXPRESS OR IMPLIED, IS MADE AS TO THE CONDITION OF THE PROPERTY (OR PROPERTIES) REFERENCED HEREIN OR AS TO THE ACCURACY OR COMPLETENESS OF THE INFORMATION CONTAINED HEREIN, AND SAME IS SUBMITTED SUBJECT TO ERRORS, OMISSIONS, CHANGE OF PRICE, RENTAL OR OTHER CONDITIONS, WITHDRAWAL WITHOUT NOTICE, AND TO ANY SPECIAL LISTING CONDITIONS IMPOSED BY THE PROPERTY OWNER(S). ANY PROJECTIONS, OPINIONS OR ESTIMATES ARE SUBJECT TO UNCERTAINTY AND DO NOT SIGNIFY CURRENT OR FUTURE PROPERTY PERFORMANCE.