

FOR SALE

ALIGN
COMPLETE REAL ESTATE SERVICES

2827 S 2300 E, Millcreek, UT



Property Details

- Retail/Showroom with Warehouse
- Square Feet: 11,000
- Sale Price: \$2,750,000.00
- Zoning: C1 (Commercial)
- Acreage: .63
- Close Proximity to I-80 Westbound On-Ramp
- Ample Parking

Jonah Hornsby, CCIM

Managing Partner | Commercial Agent

801-580-4945

Jonah@acresutah.com

1075 E Hollywood Avenue | Salt Lake City, UTAH 84105

FOR SALE

ALIGN
COMPLETE REAL ESTATE SERVICES

2827 S 2300 E, Millcreek, UT

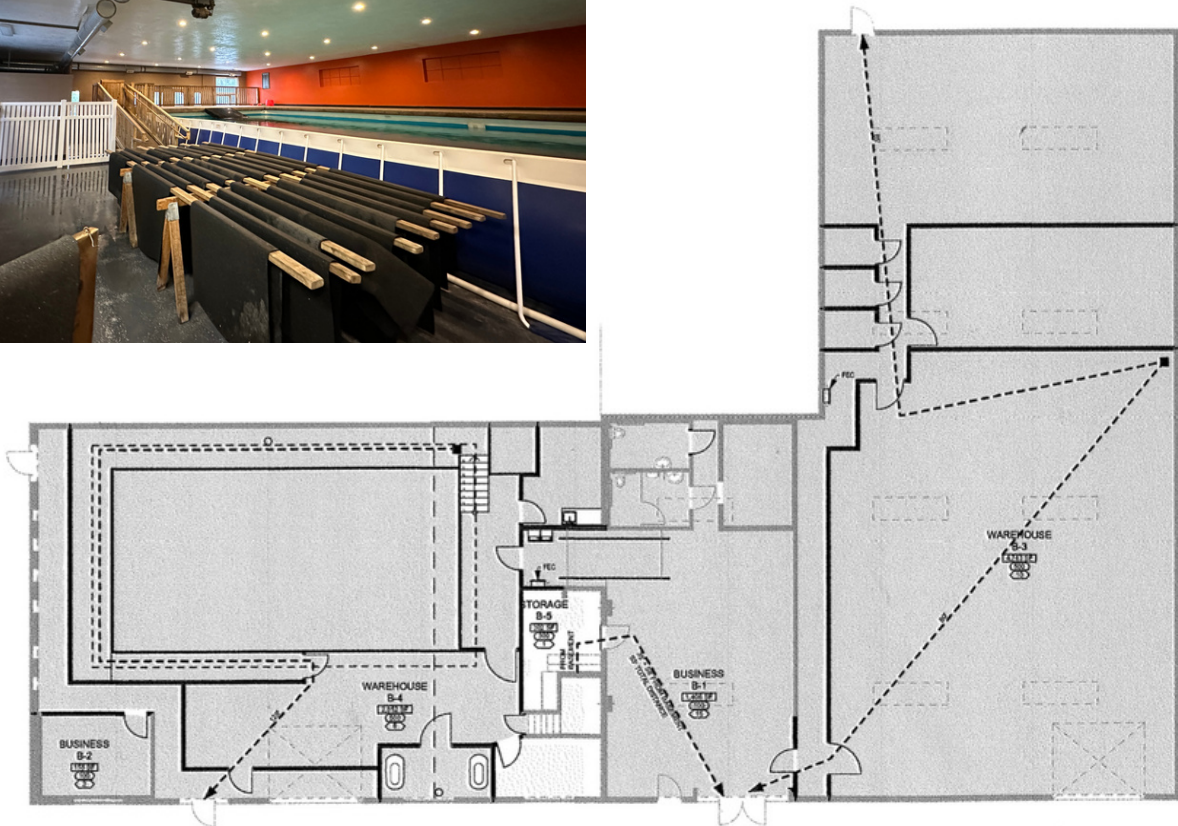

1075 E Hollywood Avenue | Salt Lake City, UTAH 84105