

35 HERRON AVENUE, EMSWORTH, PA 15202



Colliers

FOR LEASE
5,340 - 10,680 SF
Subdividable

**FOR
LEASE**

Flexible Riverfront Office-to-Warehouse

Opportunity Overview

Offering **5,340–10,680 SF on a 0.4-acre lot**, this versatile industrial/flex property features **(2) drive-in doors** (on the 1st floor) **and (1) dock door** with direct 2nd-floor access. The 2nd floor provides adaptable office-to-warehouse configurations, allowing users to tailor the space to their operational needs. Ideal for a variety of light industrial or flex uses in a convenient Emsworth location.

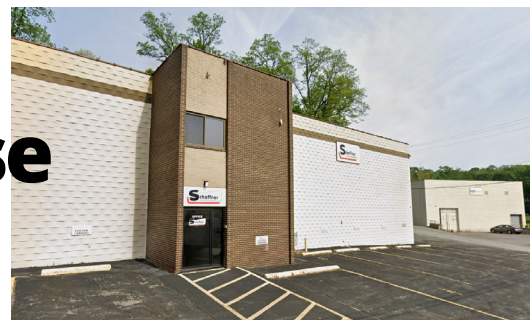

Broker Contacts:

John Bilyak, SIOR, CCIM
Market Leader | Pittsburgh
Industrial Brokerage
P: 412 515 8522 **E:** john.bilyak@colliers.com

Cody Hunt
Senior Associate | Pittsburgh
Industrial Brokerage
P: 814 602 0822 **E:** cody.hunt@colliers.com

FEATURES



(2) Drive-In's



(1) Dock



(20) Spaces

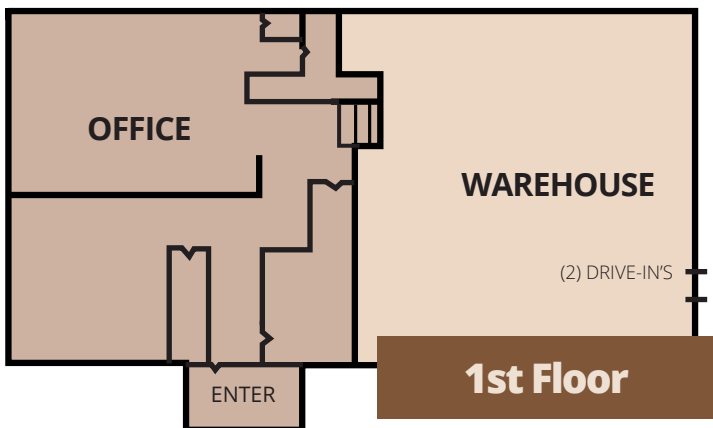
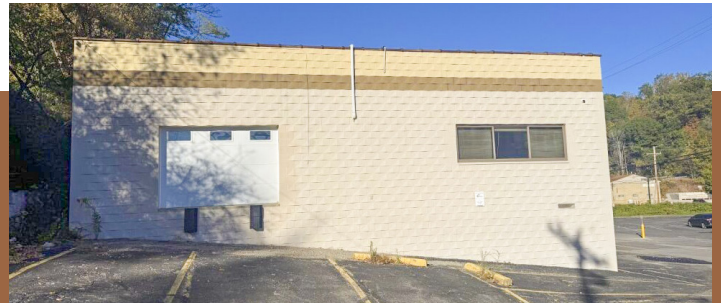

This document/email has been prepared by Colliers for advertising and general information only. Colliers makes no guarantees, representations or warranties of any kind, expressed or implied, regarding the information including, but not limited to, warranties of content, accuracy and reliability. Any interested party should undertake their own inquiries as to the accuracy of the information. Colliers excludes unequivocally all inferred or implied terms, conditions and warranties arising out of this document and excludes all liability for loss and damages arising there from. This publication is the copyrighted property of Colliers and /or its licensor(s). © 2025. All rights reserved. This communication is not intended to cause or induce breach of an existing listing agreement. Colliers Pittsburgh.