

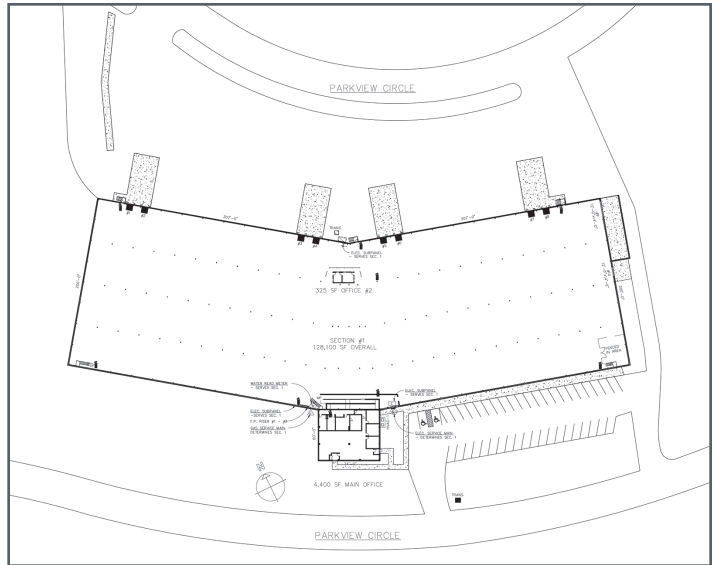

950 South Park View Circle | Mosinee, Wisconsin

FOR LEASE: 132,500 SF



Property Features

Total Building	132,500 SF
Space Available:	132,500 SF
Date Available:	7/1/2025
Loading:	(8) 8'x 9'
Clear Height:	22'-9" eave, 26'-11" peak
Power:	1200 amp
Fire Protection:	.28/3,000
Column Spacing:	25' x 50'
Year Built:	1995



Ability to be converted to cooler.



950 South Park View Circle | Mosinee, Wisconsin

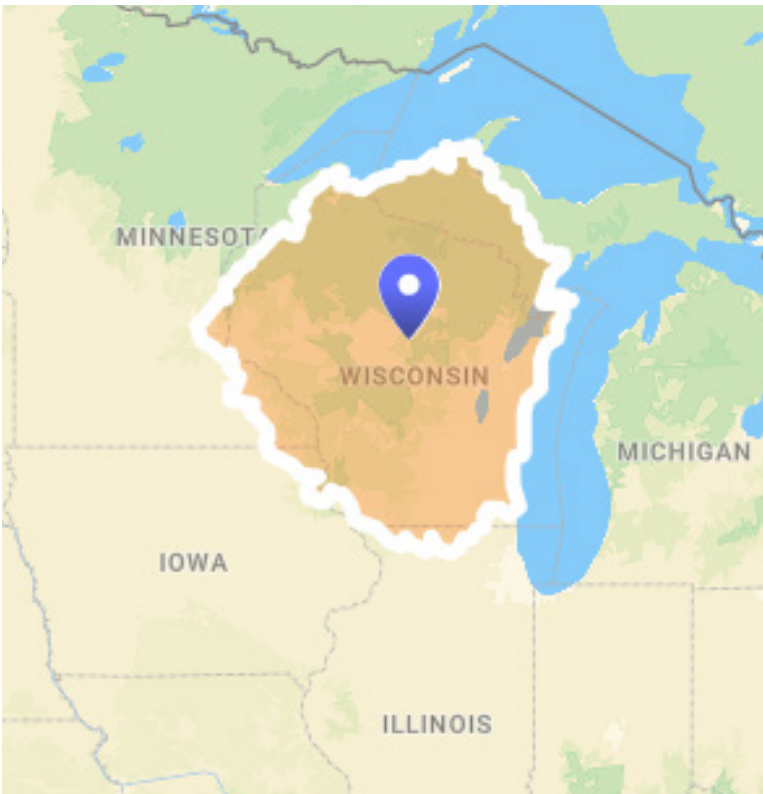

Highlighted portion of the map represents 200 mile commute from facility.

Area Summary

Population

City of Mosinee: 4,554

Marathon County: 138,078

Workforce (County)

67% of individuals over age 16

Median Household Income (County)

\$73,248

Drive Time Guide

Location	Miles	Time
Wausau	15	19 mins
Green Bay	103	1hr 35m
Madison	129	2hr 12m
La Crosse	132	2hr 22m
Milwaukee	175	2hr 52m
Minneapolis	189	2hr 58m
Rochester	199	3hr 32m

Contact

Jamie Sager | Real Estate & Account Manager

 JamieSa@wowlogistics.com

 920.415.3745

wowlogistics.com

