

FOR SALE
2221 W. DEER VALLEY
PHOENIX, ARIZONA



FEATURES

- ±3.1 Acres
- ±150' of Frontage on Deer Valley Road
- Access via Deer Valley Road, 23rd Ave & Melinda Lane
- Parcels
 - 209-06-012: ±0.95 Acres
 - 209-06-008A & 008B: ±2.15 Acres
- Fully Fenced and Lit Yard
- 4,000 SF of Structures
- Zoned C-3, Phoenix
- ±32,000 Vehicles Per Day
- **1/8 Mile to I-17 Freeway Access**

Matt Hobaica, SIOR
mhobaica@leearizona.com
D 602.954.3755

Ryan Hingst
rhingst@leearizona.com
D 602.954.3772

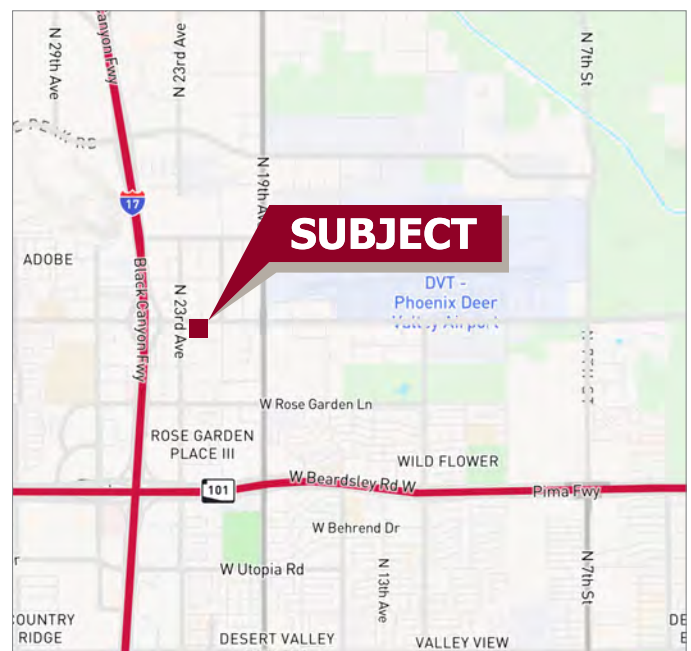

All information furnished regarding property for sale, rental or financing is from sources deemed reliable, but no warranty or representation is made to the accuracy thereof and same is submitted to errors, omissions, change of price, rental or other conditions prior to sale, lease or financing or withdrawal without notice. No liability of any kind is to be imposed on the broker herein.

FOR SALE
2221 W. DEER VALLEY
PHOENIX, ARIZONA



FOR SALE
2221 W. DEER VALLEY
PHOENIX, ARIZONA



Matt Hobaica, SIOR
mhobaica@leearizona.com
D 602.954.3755

Ryan Hingst
rhingst@leearizona.com
D 602.954.3772

All information furnished regarding property for sale, rental or financing is from sources deemed reliable, but no warranty or representation is made to the accuracy thereof and same is submitted to errors, omissions, change of price, rental or other conditions prior to sale, lease or financing or withdrawal without notice. No liability of any kind is to be imposed on the broker herein.