



COMPASS

2525 WALLINGWOOD DRIVE, #802, AUSTIN, TX 78746

Prime Austin location! Timberline Office Park Situated with easy access to MoPac and is just moments to downtown, Zilker Park and Barton Springs. Building 8 sits on the edge of a park like setting and Suite 802 offers multiple views as well as a private deck overlooking the greenspace. The suite has a private entrance from outside, up to 4 private offices as well as kitchen and break area and other workspaces. The suite is move-in ready with recent paint and updates. Don't miss this opportunity to have a one-of-a-kind space in one of Austin's most desirable areas.



LEASE

OFFICE

MATTHEW AMES, BROKER ASSOCIATE, REALTOR®
512-771-7441 | MATTHEWAMES@REALTYAUSTIN.COM



2525 WALLINGWOOD DRIVE, #802,
AUSTIN, TX 78746

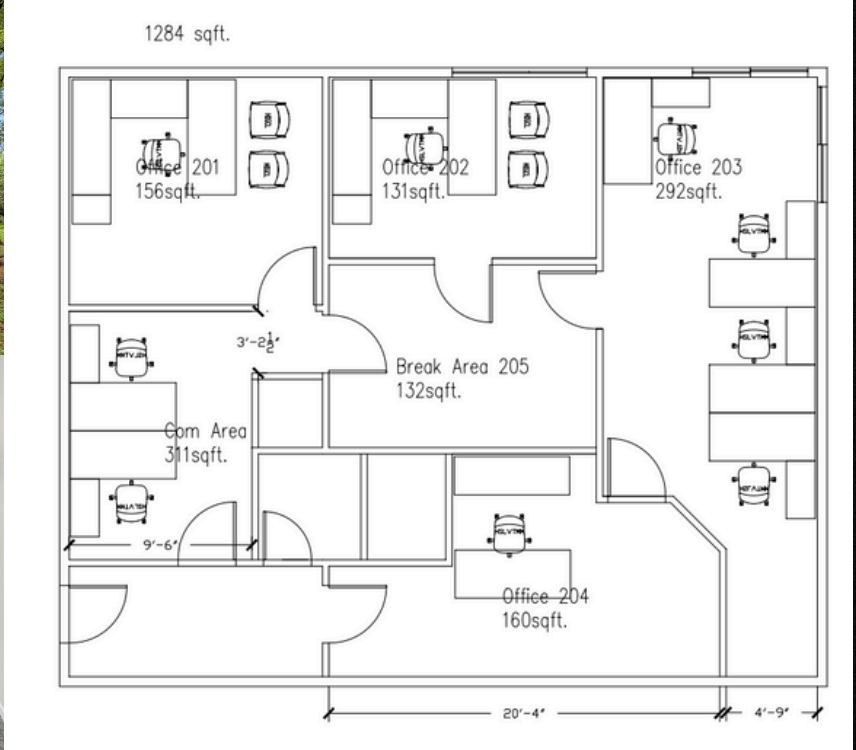

Features

- Convenient access to MoPac expressway, downtown, Zilker Park, Barton Springs
- Building 8 is surrounded by park-like landscaping
- Multiple views of green space and a private outdoor deck overlooking green space
- Private exterior entrance to the suite
- Includes kitchen and break room
- Recently refreshed with new paint and upgrades, ready to occupy

LEASE	OFFICE	MATTHEW AMES, BROKER ASSOCIATE, REALTOR® 512-771-7441 MATTHEWAMES@REALTYAUSTIN.COM