

KAEMPFER

CROWELL



View Drone Video

TRAVIS HANSEN, SIOR, CCIM
SENIOR VICE PRESIDENT
775.351.5578 **CELL**
thansen@dicksoncg.com
S.170076

DOWNTOWN
OFFICE
SUBLEASE

50 West Liberty
SUITE 1100

Reno, NV 89501

\$4.50 PSF - 1 Year Lease

SPACES AVAILABLE

277 SF - 1,025 SF

50



CORFAC
INTERNATIONAL

CONTACT **JOSH D. CORRELLI** AT **775.852.3900** OR **JCORRELLI@KCNVLAW.COM** FOR MORE INFORMATION!

PROPERTY HIGHLIGHTS

- Cross Lease with 1 year term.
- Lease rate: \$4.50/ sf.
- Lease includes parking, limited use of receptionist, copy/printing machines, shredding services, use of kitchen, and use of conference room.
- Tenant is responsible for their own phone and internet (IT will work with tenant to set up), Postage, & Additional records/file storage.



FLOOR PLAN



ACCESS TO COMMON AREA

AVAILABLE



FLOOR PLAN

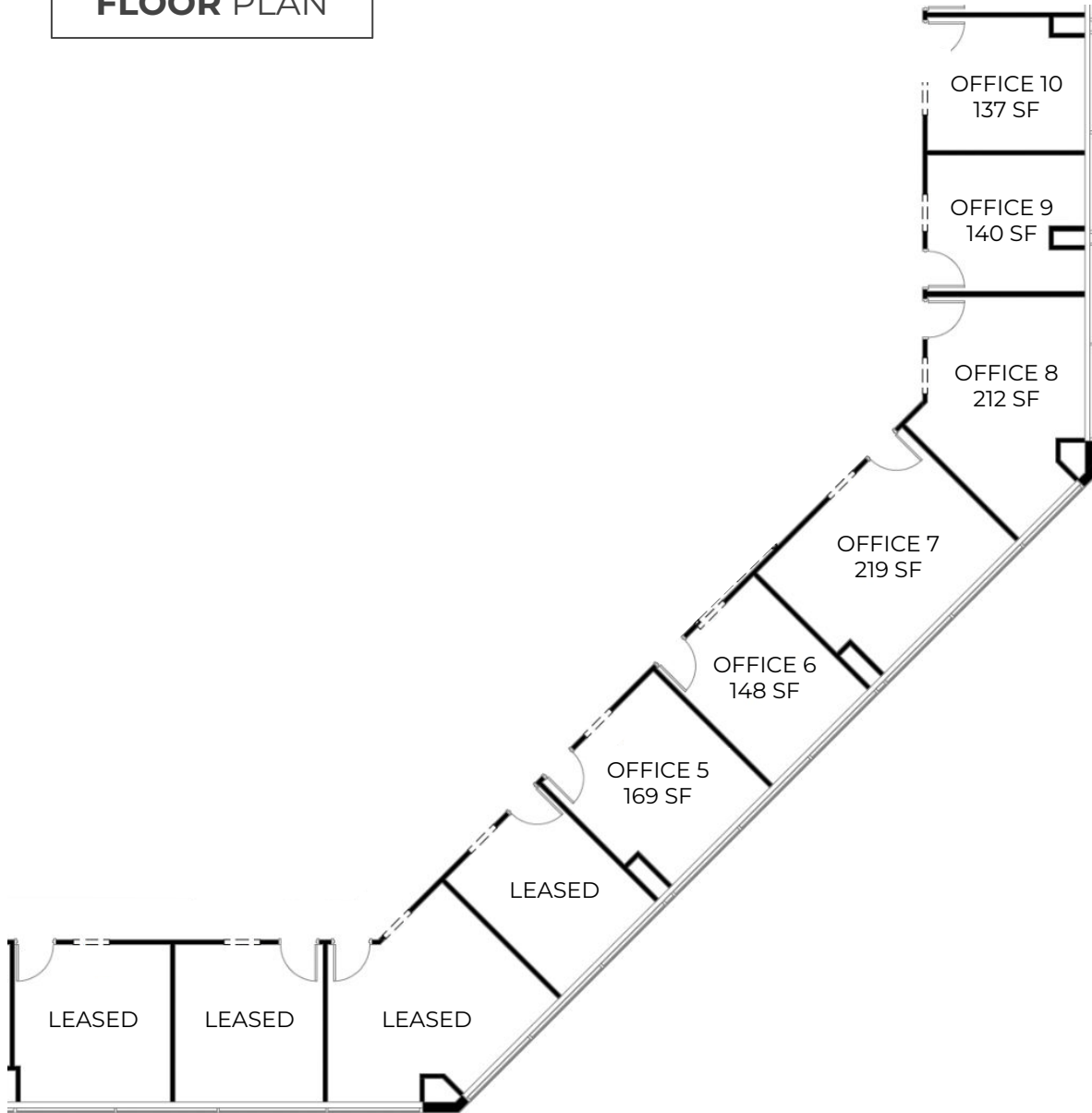

AVAILABLE SPACES

5	169 SF	\$760.50
6	148 SF	\$666
7	219 SF	\$985.50
8	212 SF	\$954
9	140 SF	\$630
10	137 SF	\$616.50







LAKE ST



E SECOND ST



DOWNTOWN AREA MAP

- Reno Aces Ballpark
- Starbucks
- Pine State Biscuits
- Sizzle Pie
- Patagonia
- La Famiglia
- Pioneer Center for Performing Arts
- Renaissance Reno
- Downtown Hotel by Marriott
- Old Granite Street Eatery
- Nevada Museum of Art
- The Depot
- Bertha Miranda's
- Mellow Fellow Gastropub





