

FOR LEASE



PROPERTY DETAILS

3995 Quinn's Dr., Park City, UT 84060

- Lease rates starting at \$45.00/SF NNN
- Proposed delivery in Fall 2025
- Signalized corner across from Intermountain Health Park City Hospital
- Exclusive new mixed-use development in Summit County (approximately 300,000+ SF)
- Within 10-minute drive to Main Street Park City
- Easy access, 35 minutes from Salt Lake City International Airport
- Prime location at Park City's east entrance offering unparalleled access to world class ski resorts, boutique shopping and vibrant dining

2025 DEMOS



EST. POPULATION

3 MILE » 11,221
5 MILE » 24,199



EST. HOUSEHOLDS

3 MILE » 4,608
5 MILE » 9,920



EST. AVERAGE HH INCOME

3 MILE » \$252,237
5 MILE » \$256,516

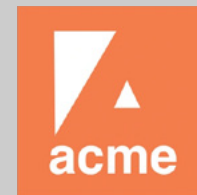

TIM ANKER

tanker@acme-cre.com
direct 435.655.5661

2750 Rasmussen Road Suite H-100
Park City, UT 84098

NEWMARK



MOUNTAIN WEST

MICHELLE DOONG, CCIM, MRED

mdoong@newmarkmw.com
direct 801.746.4742
[View Profile](#)

FULL SERVICE COMMERCIAL REAL ESTATE

312 East South Temple
Salt Lake City, Utah 84111
Office 801.456.8800

www.newmarkmw.com

STUDIO CROSSING AT QUINN'S JUNCTION

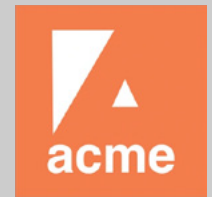

TIM ANKER

tanker@acme-cre.com
direct 435.655.5661

2750 Rasmussen Road Suite H-100
Park City, UT 84098

NEWMARK



MICHELLE DOONG, CCIM, MRED

mdoong@newmarkmw.com
direct 801.746.4742
[View Profile](#)

FULL SERVICE COMMERCIAL REAL ESTATE

312 East South Temple
Salt Lake City, Utah 84111
Office 801.456.8800
www.newmarkmw.com

STUDIO CROSSING AT QUINN'S JUNCTION

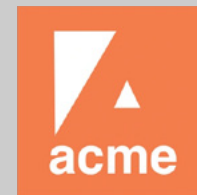
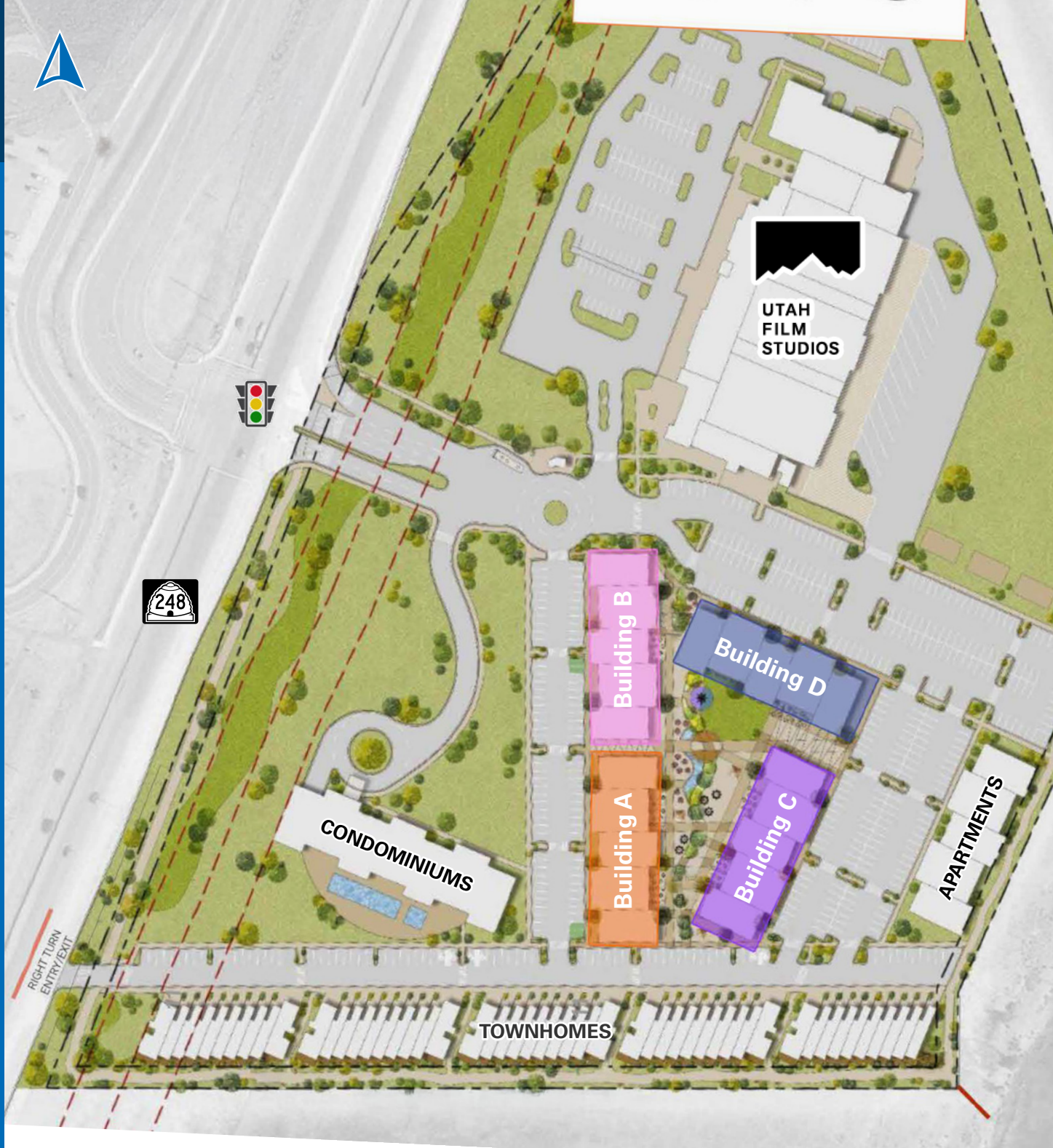

TIM ANKER

tanker@acme-cre.com
direct 435.655.5661

2750 Rasmussen Road Suite H-100
Park City, UT 84098

NEWMARK

MOUNTAIN WEST

MICHELLE DOONG,
CCIM, MRED

mdoong@newmarkmw.com
direct 801.746.4742
[View Profile](#)

**FULL SERVICE
COMMERCIAL REAL ESTATE**

312 East South Temple
Salt Lake City, Utah 84111
Office 801.456.8800

www.newmarkmw.com

BUILDING A

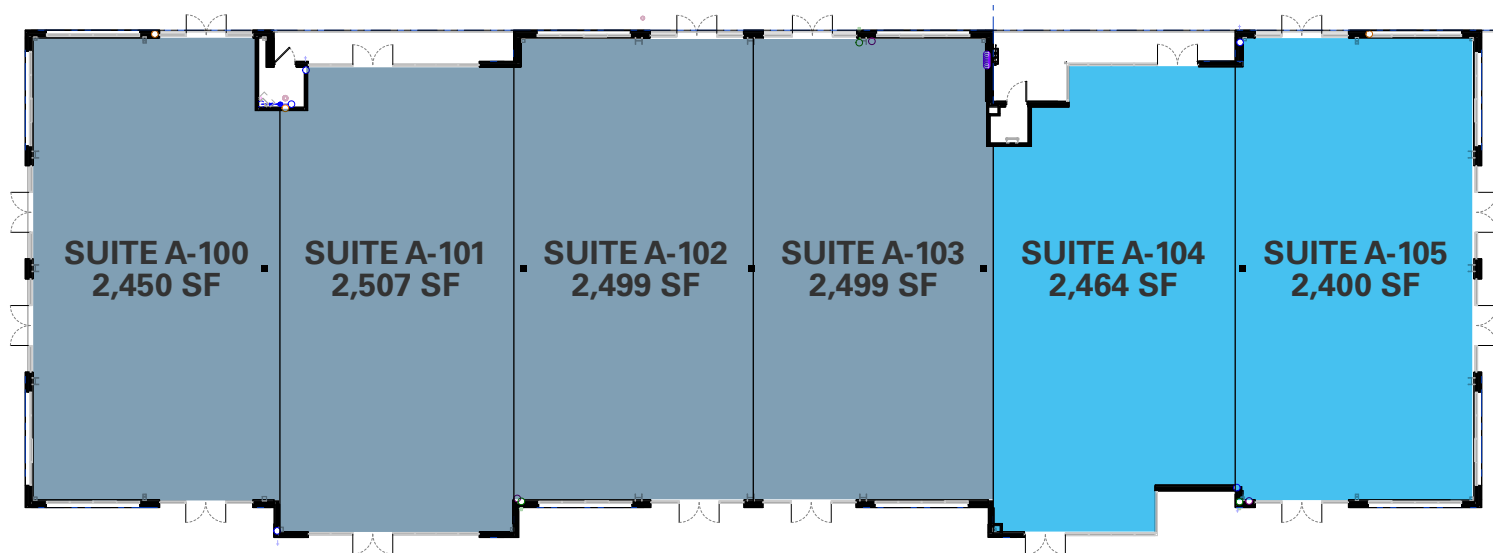

BUILDING B

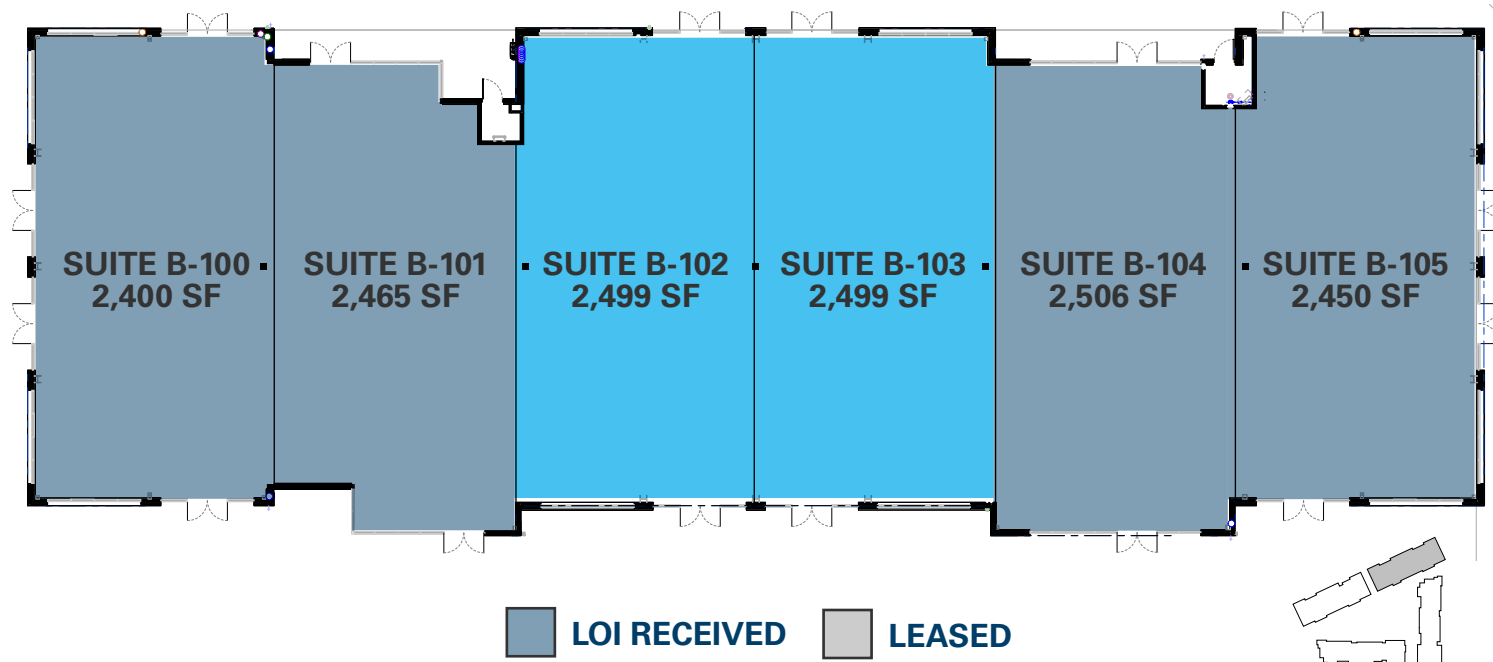

TIM ANKER

tanker@acme-cre.com
 direct 435.655.5661

2750 Rasmussen Road Suite H-100
 Park City, UT 84098

NEWMARK



MICHELLE DOONG, CCIM, MRED

mdoong@newmarkmw.com
 direct 801.746.4742
[View Profile](#)

FULL SERVICE COMMERCIAL REAL ESTATE

312 East South Temple
 Salt Lake City, Utah 84111
 Office 801.456.8800
www.newmarkmw.com

BUILDING C

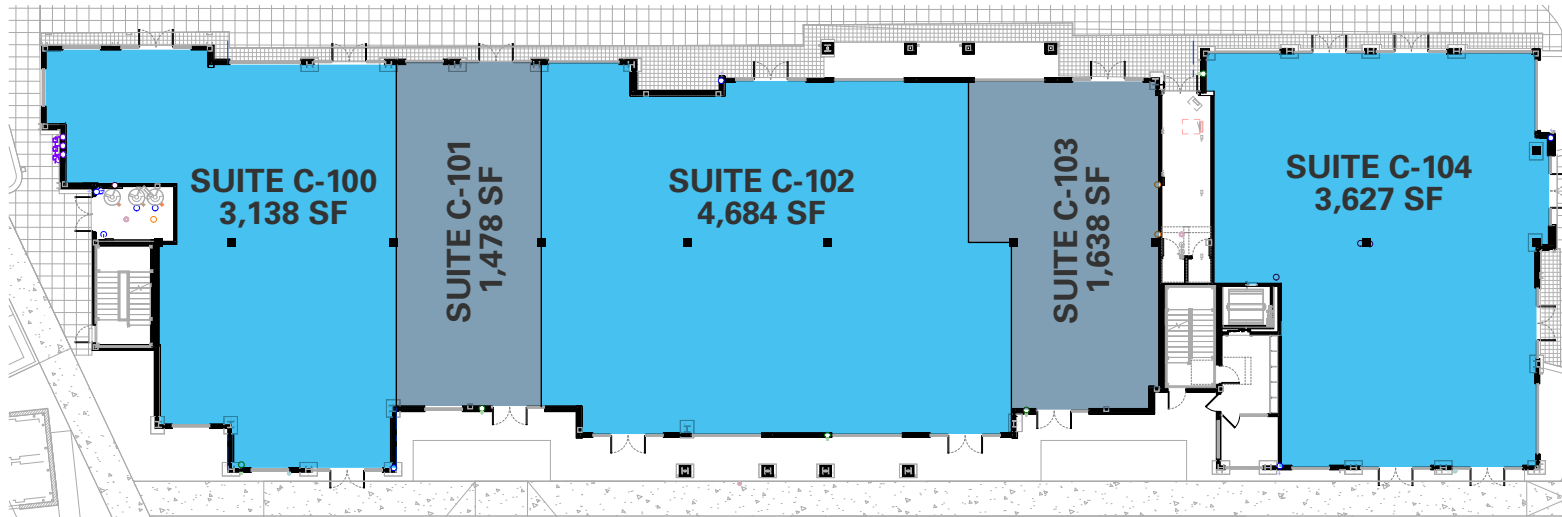

BUILDING D

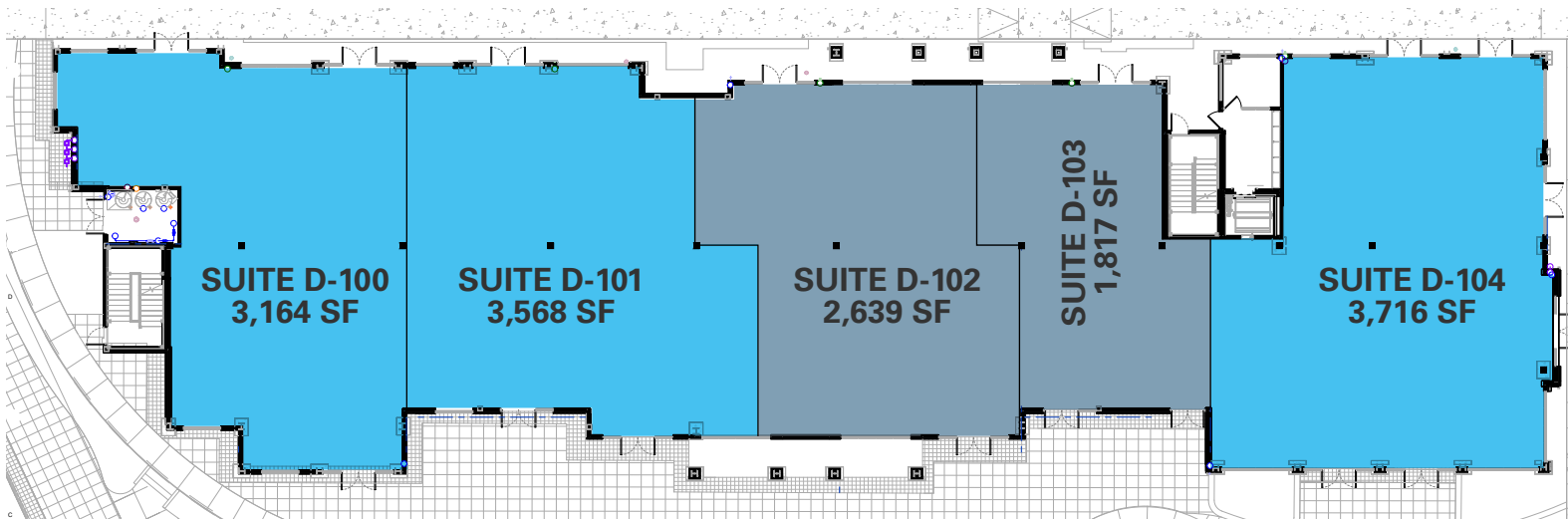

 **LOI RECEIVED**  **LEASED**



TIM ANKER
 tanker@acme-cre.com
 direct 435.655.5661

2750 Rasmussen Road Suite H-100
 Park City, UT 84098

NEWMARK

 **MOUNTAIN WEST**

MICHELLE DOONG,
 CCIM, MRED
 mdoong@newmarkmw.com
 direct 801.746.4742
[View Profile](#)

**FULL SERVICE
 COMMERCIAL REAL ESTATE**
 312 East South Temple
 Salt Lake City, Utah 84111
 Office 801.456.8800
www.newmarkmw.com

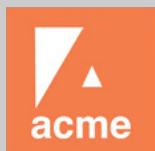

TIM ANKER
tanker@acme-cre.com
direct 435.655.5661

2750 Rasmussen Road
Suite H-100
Park City, UT 84098



MICHELLE DOONG, CCIM, MRED
mdoong@newmarkmw.com
direct 801.746.4742
[View Profile](#)

**FULL SERVICE
COMMERCIAL REAL ESTATE**
312 East South Temple
Salt Lake City, Utah 84111
Office 801.456.8800
www.newmarkmw.com

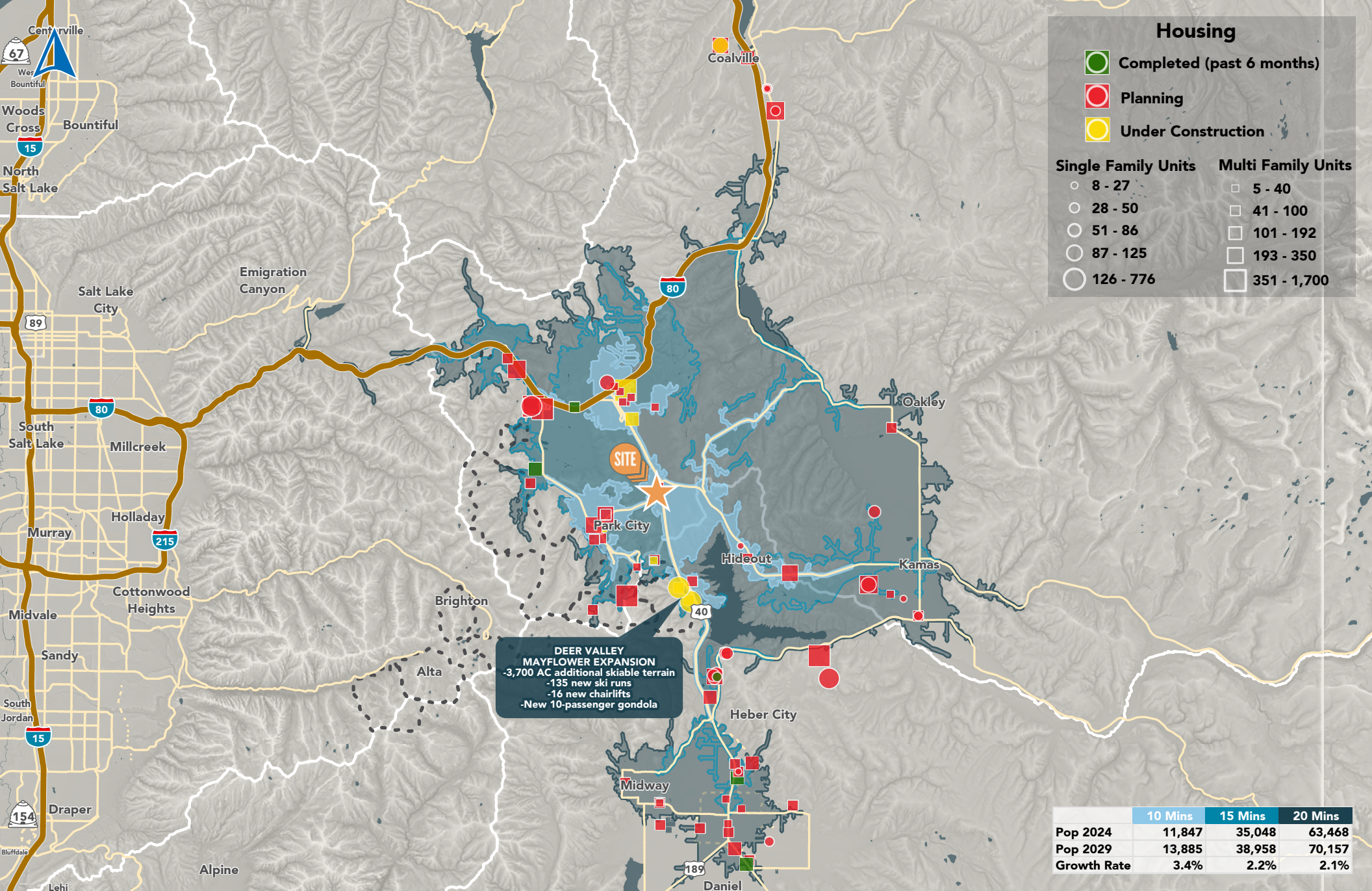

Housing

● Completed (past 6 months)

● Planning

● Under Construction

Single Family Units	Multi Family Units
○ 8 - 27	□ 5 - 40
○ 28 - 50	□ 41 - 100
○ 51 - 86	□ 101 - 192
○ 87 - 125	□ 193 - 350
○ 126 - 776	□ 351 - 1,700

**DEER VALLEY
MAYFLOWER EXPANSION**
-3,700 AC additional skiable terrain
-135 new ski runs
-16 new chairlifts
-New 10-passenger gondola

	10 Mins	15 Mins	20 Mins
Pop 2024	11,847	35,048	63,468
Pop 2029	13,885	38,958	70,157
Growth Rate	3.4%	2.2%	2.1%

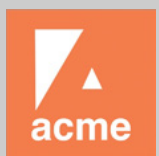

TIM ANKER
tanker@acme-cre.com
direct 435.655.5661

2750 Rasmussen Road
Suite H-100
Park City, UT 84098



MICHELLE DOONG, CCIM, MRED
mdoong@newmarkmw.com
direct 801.746.4742
[View Profile](#)

**FULL SERVICE
COMMERCIAL REAL ESTATE**
312 East South Temple
Salt Lake City, Utah 84111
Office 801.456.8800
www.newmarkmw.com

WHY PARK CITY

SKIER
DAYS

6.5M

Utah 2024-25 Ski Season
3rd Busiest in Utah's History

SKIER/SNOWBOARDER
SPENDING

\$157

Average 2022-23 Retail/Restaurant
Spend per Day per Skier/Snowboarder

Park City, Utah, isn't just a place to live—it's a place to thrive. Nestled in the Wasatch Mountains, this vibrant community offers more than breathtaking views. With a growing population drawn by top-notch schools and a welcoming atmosphere, Park City's economy is flourishing. The town's blend of outdoor adventure and cultural richness creates a unique quality of life, attracting families and professionals alike. If you're looking for a place where opportunity meets serenity, Park City is calling.

ECONOMIC
STRENGTH

#2

Heber City μSA, UT
(includes Park City)

Policom Corp.

μSA Economic Strength Ratings

6.6%

Summit County Taxable Service
Sales Growth 2022-2023

2025 EST.
POPULATION

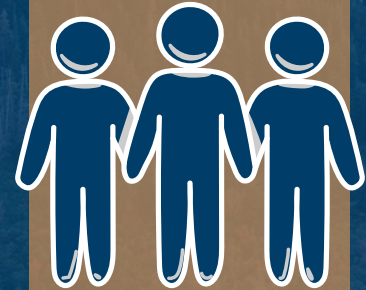

10,476

Park City, UT

43,249

Summit County, UT

81,229

Heber City, UT μSA



ANNUAL POPULATION
GROWTH (2020-2025)

3.7%

Park City, UT

0.4%

Summit County, UT

1.1%

Heber City, UT μSA

MEDIAN HOUSEHOLD
INCOME (2025)

\$153K

Park City, UT

\$145K

Summit County, UT

\$134K

Heber City, UT μSA

HOUSEHOLDS

4,411

Park City, UT

16,679

Summit County, UT

29,344

Heber City, UT μSA

EMPLOYEES

10,365

Park City, UT

31,399

Summit County, UT

40,689

Heber City, UT μSA

MONTHLY RETAIL
EXPENDITURES (2025)

\$5,485

Park City, UT

\$5,672

Summit County, UT

\$5,539

Heber City, UT μSA