

# Ground Floor Retail Space

1,116 SF Available

200 State Street  
Boston, Massachusetts



Floor Plan

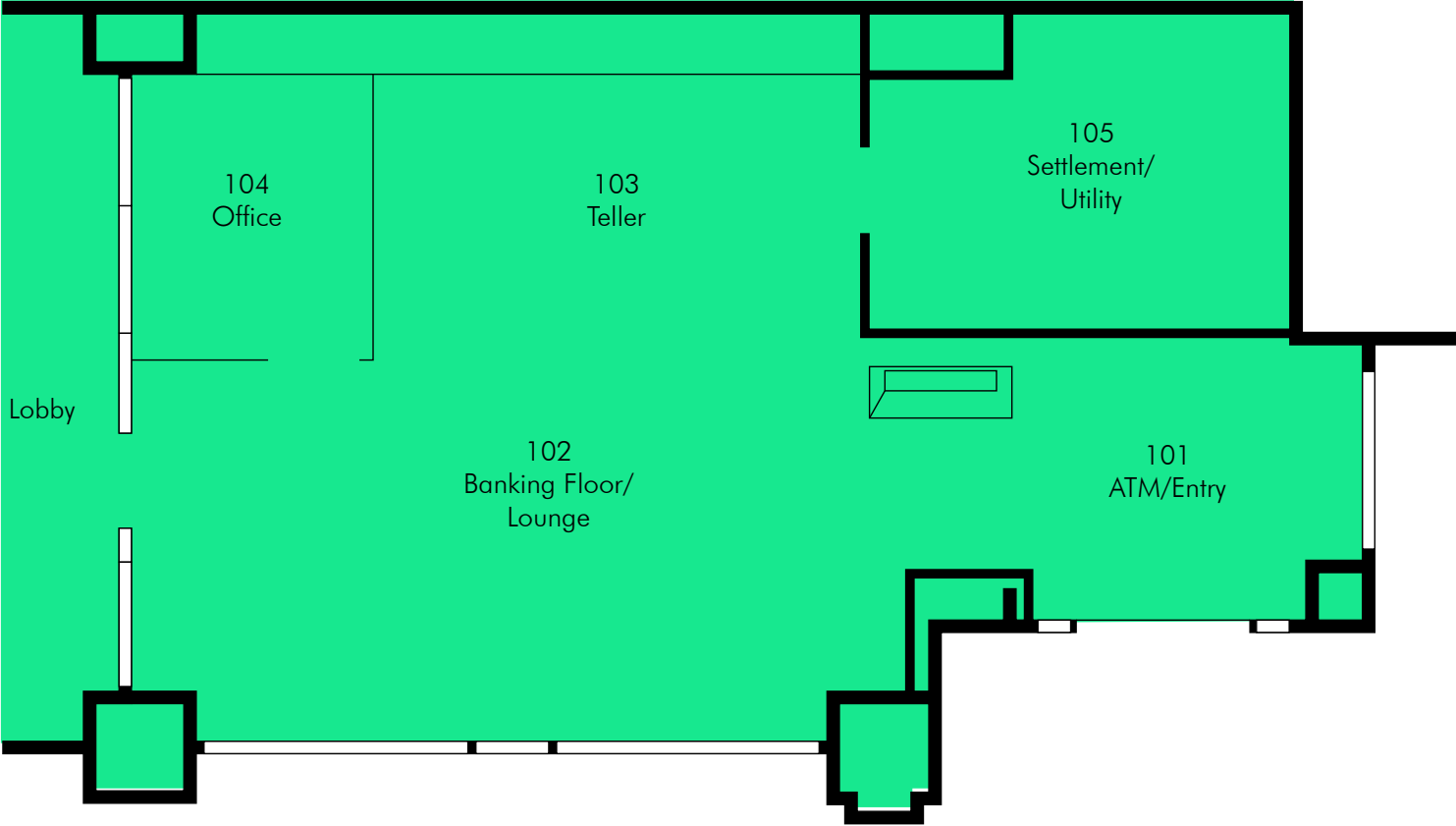

Retail Opportunity

- + 1,116 square foot endcap retail space facing the intersection of State Street and the Rose Kennedy Greenway
- + Direct access to the space from State Street or through the 200 State Street lobby
- + Located on the ground floor of a 300,000 square foot office building
- + Available for sublease with term through 10/31/2026
- + Adjacent to Faneuil Hall Marketplace and Quincy Market, two of Boston's most recognizable shopping and eating destinations with more than 20 million annual visitors

| 2021 Demographics                  | 0.25 Miles | 0.5 Miles | 0.75 Miles | 1 Mile    |
|------------------------------------|------------|-----------|------------|-----------|
| Estimated Population               | 2,771      | 15,798    | 34,149     | 58,186    |
| Estimated Households               | 1,464      | 8,755     | 18,811     | 30,080    |
| Estimated Average Household Income | \$182,492  | \$170,857 | \$168,932  | \$162,275 |
| Estimated Daytime Population       | 21,113     | 73,808    | 121,404    | 169,768   |



## Ground Floor Retail Space

200 State Street | Boston, Massachusetts

For Lease



## Contact Us

**Josh Kulak**

Senior Associate

+1 617 912 6835

josh.kulak@cbre.com

© 2022 CBRE, Inc. All rights reserved. This information has been obtained from sources believed reliable, but has not been verified for accuracy or completeness. You should conduct a careful, independent investigation of the property and verify all information. Any reliance on this information is solely at your own risk. CBRE and the CBRE logo are service marks of CBRE, Inc. All other marks displayed on this document are the property of their respective owners, and the use of such logos does not imply any affiliation with or endorsement of CBRE. Photos herein are the property of their respective owners. Use of these images without the express written consent of the owner is prohibited.

[www.cbre.com](http://www.cbre.com)

**CBRE**