



# 15,360 SF AVAILABLE FOR LEASE

PREMIER DOCK HIGH WAREHOUSE DISTRIBUTION FACILITY

10736 Bloomfield Avenue | Santa Fe Springs, CA



### **WAREHOUSE DISTRIBUTION FACILITY**

- 15,360 SF Dock High Industrial Unit
- 910 SF of Office Space
- 2 Dock High Positions  
1 Ground Level Door
- 24' Clearance
- .33/3000 Sprinklers
- 400 Amps of Power
- 26 Car Parking Spaces
- Major Street Frontage
- Excellent Access to (5), (605) & (105) Freeways
- High Image Business Park Environment

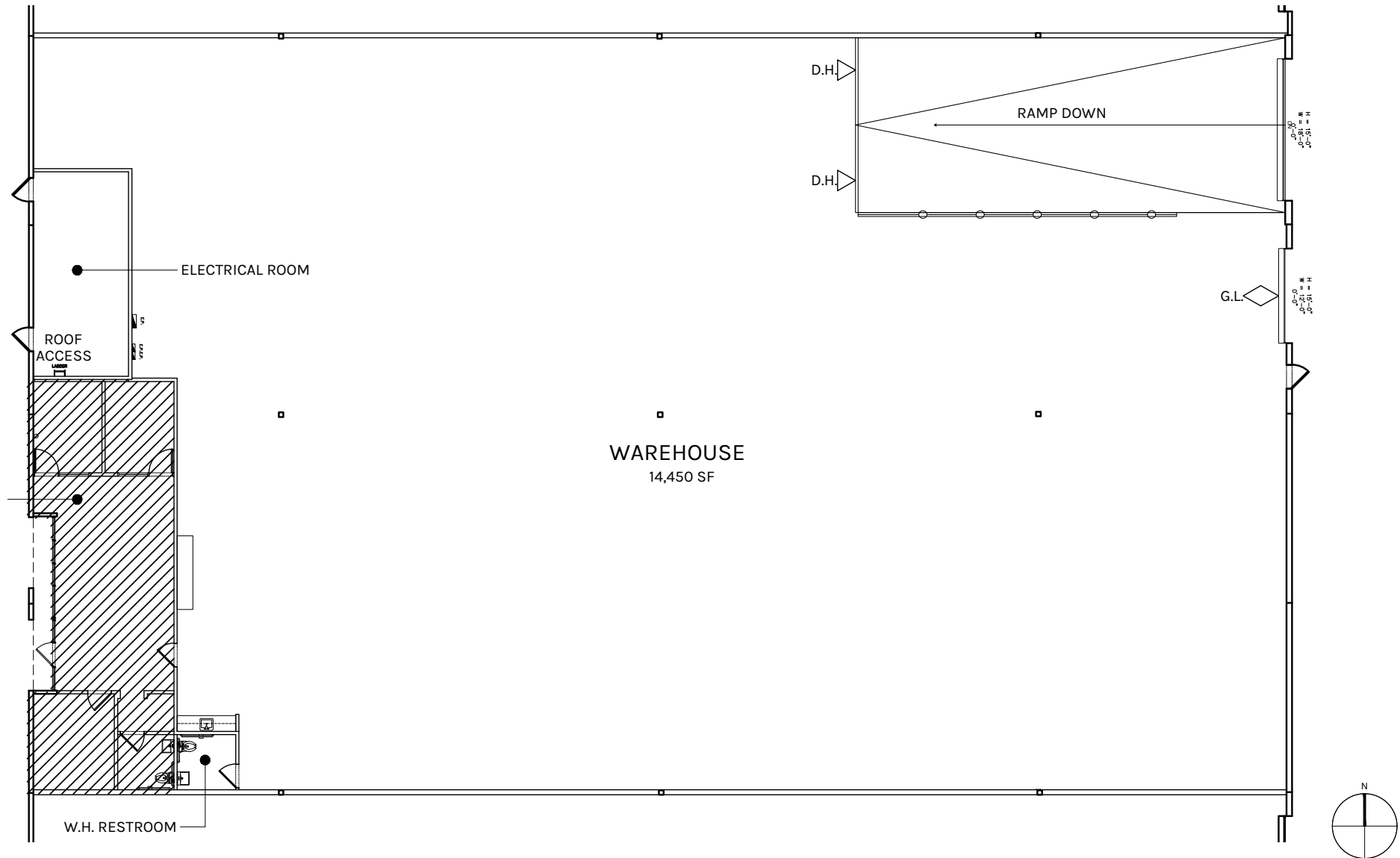

**WAREHOUSE**  
14,450 SF

**OFFICE**  
910 SF

**TOTAL**  
15,360 SF

PLAN LAYOUT SUBJECT TO FIELD CONDITIONS AND MAY DIFFER FROM PLAN AS SHOWN. ALL INFORMATION PRESENTED ON THIS DRAWING IS PRESUMED TO BE ACCURATE, HOWEVER TENANT SHOULD VERIFY PERTINENT INFORMATION PRIOR TO COMMITTING TO A LEASE. ANY FURNITURE OR APPLIANCES SHOWN ON PLAN ARE FOR CONCEPT ONLY AND WILL BE TENANT PROVIDED.

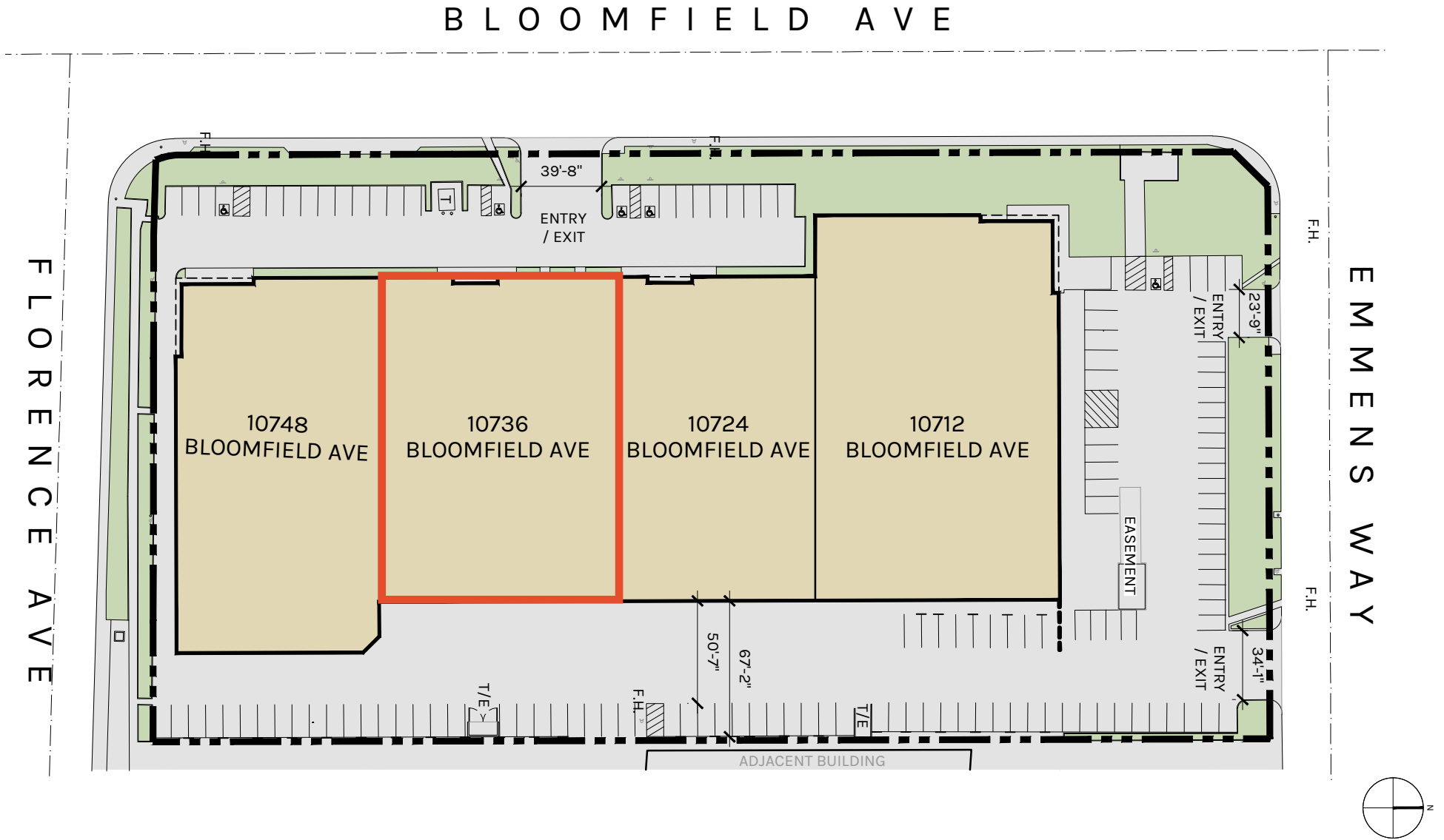

**WAREHOUSE**  
14,450 SF

**OFFICE**  
910 SF

**TOTAL**  
15,360 SF

PLAN LAYOUT SUBJECT TO FIELD CONDITIONS AND MAY DIFFER FROM PLAN AS SHOWN. ALL INFORMATION PRESENTED ON THIS DRAWING IS PRESUMED TO BE ACCURATE, HOWEVER TENANT SHOULD VERIFY PERTINENT INFORMATION PRIOR TO COMMITTING TO A LEASE. ANY FURNITURE OR APPLIANCES SHOWN ON PLAN ARE FOR CONCEPT ONLY AND WILL BE TENANT PROVIDED.

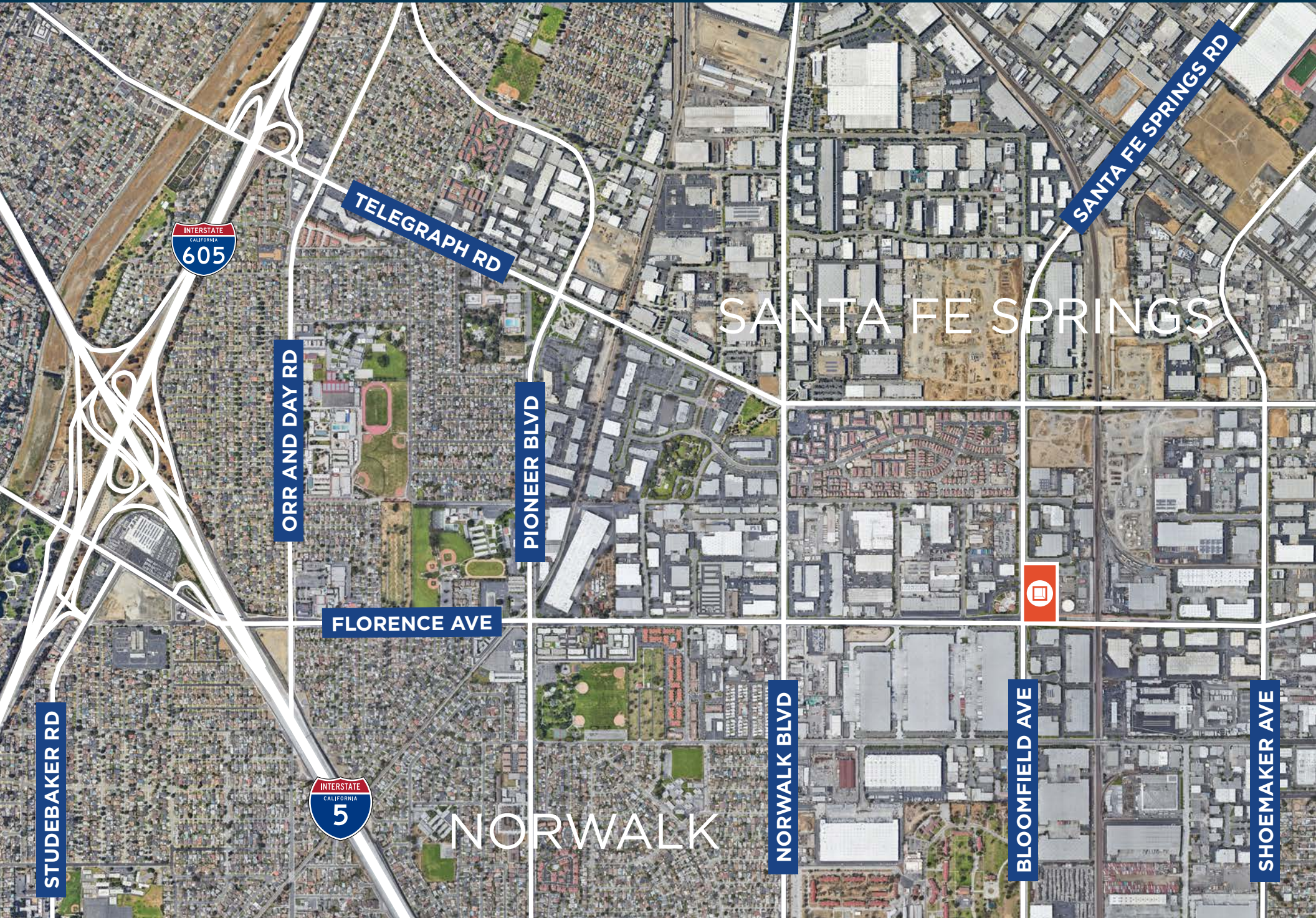

TELEGRAPH RD

SANTA FE SPRINGS RD

SANTA FE SPRINGS

ORR AND DAY RD

PIONEER BLVD

FLORENCE AVE



STUDEBAKER RD



NORWALK

NORWALK BLVD

BLOOMFIELD AVE

SHOEMAKER AVE



|  |   |
|--|---|
| <b>1.7 Miles</b><br>to (5) Freeway         | <b>2.0 Miles</b><br>to (605) Freeway                    |
| <b>14 Miles</b><br>to Downtown Los Angeles | <b>22 Miles</b><br>to Los Angeles International Airport |
| <b>20 Miles</b><br>to Port of Long Beach   | <b>22 Miles</b><br>to Port of Los Angeles               |



**Rexford  
Industrial**

## Leasing Contacts

**JOHN MCMILLAN**

Vice Chairman

t 310-491-2048

john.mcmillan@nmrk.com

CA RE License #01103292

**CONNOR REEVES**

Senior Managing Director

t 310-491-2088

connor.reeves@nmrk.com

CA RE License #01983477

**ANDREW CONROY**

Transaction Manager

t 310-491-2085

andrew.conroy@nmrk.com

CA RE License #02143325

## NEWMARK

**Newmark**

2301 Rosecrans Ave

Suite 4100

El Segundo, CA 90245

t 310-491-2000

nmrk.com

Corporate License #01355491

The information contained herein has been obtained from sources deemed reliable but has not been verified and no guarantee, warranty or representation, either express or implied, is made with respect to such information. Terms of sale or lease and availability are subject to change or withdrawal without notice.