

**Broker Bonus - \$1.00/SF**  
**Inspection Bonus - \$50.00 Gift Card**



 **JLL** SEE A BRIGHTER WAY

**For sublease**

23,000 SF office space

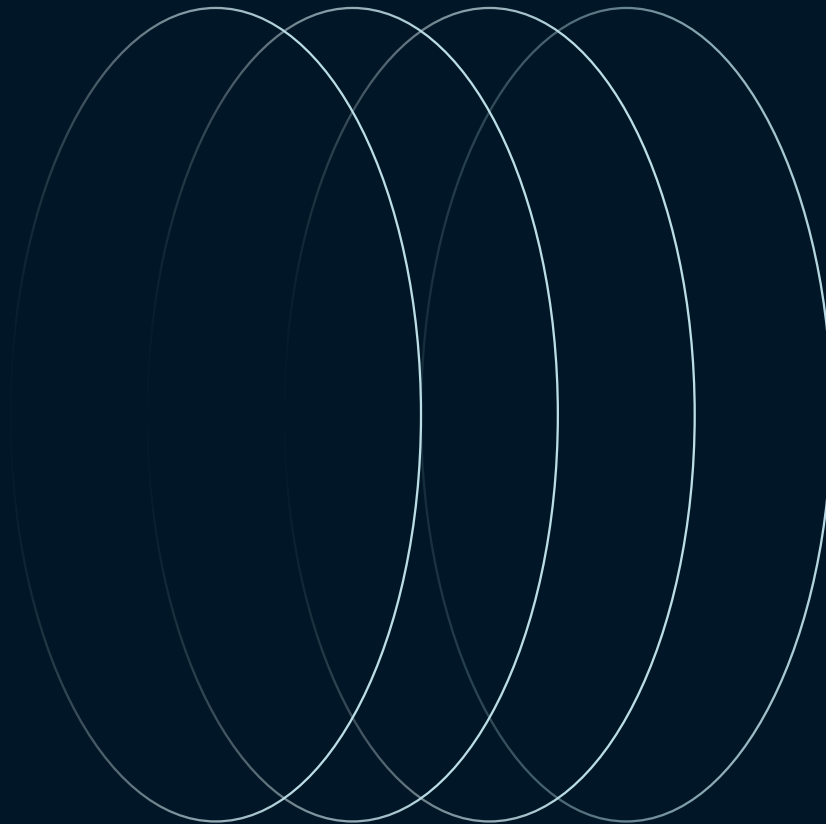

## Property specifications

- Fully furnished and wired
- Brand new fit out
- High end finishes throughout
- Lease expiration date: 4/30/2032

# 300 Willowbrook Lane West Chester, PA

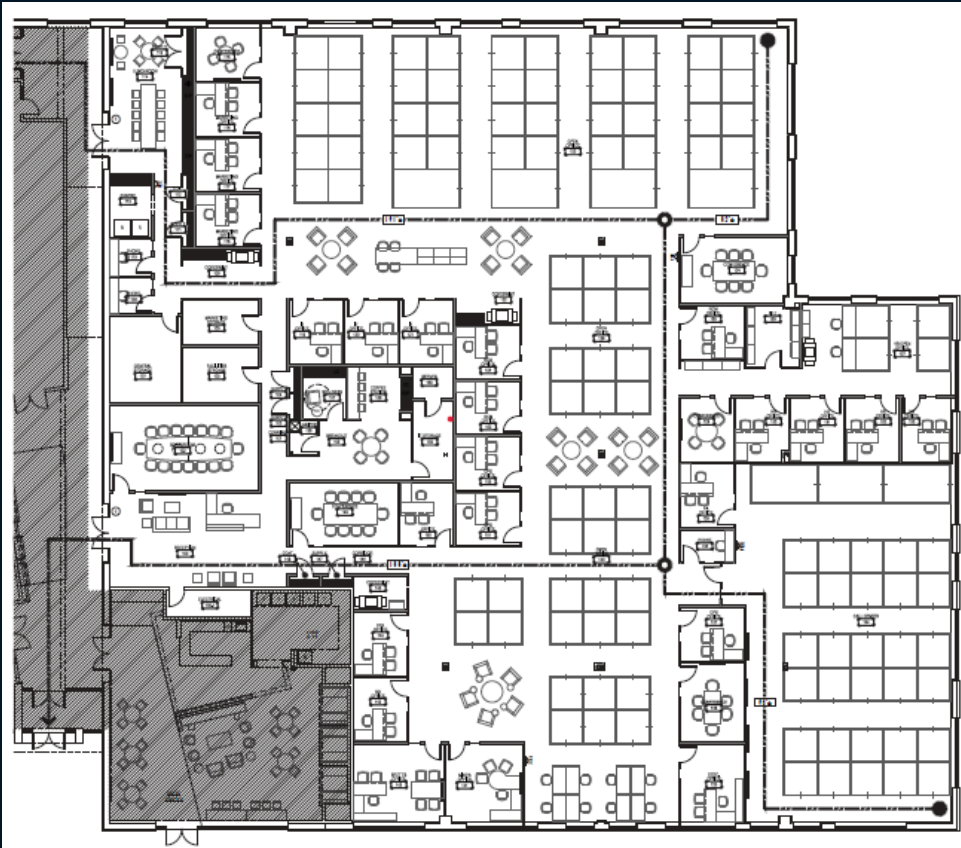

**Eric Wahlers**  
Senior Managing Director  
eric.wahlers@jll.com  
+1 610 585 7114

**Chris Werner**  
Executive Vice President  
chris.werner@jll.com  
+1 610 710 1612

**Jones Lang LaSalle Brokerage, Inc.**  
550 E. Swedesford Road, Suite 260  
Wayne, PA 19087  
+1 610 249 2255

[jll.com](http://jll.com)

Although information has been obtained from sources deemed reliable, neither Owner nor JLL makes any guarantees, warranties or representations, express or implied, as to the completeness or accuracy as to the information contained herein. Any projections, opinions, assumptions or estimates used are for example only. There may be differences between projected and actual results, and those differences may be material. The Property may be withdrawn without notice. Neither Owner nor JLL accepts any liability for any loss or damage suffered by any party resulting from reliance on this information. If the recipient of this information has signed a confidentiality agreement regarding this matter, this information is subject to the terms of that agreement. ©2023. Jones Lang LaSalle IP, Inc. All rights reserved.