

For Sale

2240-2246 Fair Park Ave Los Angeles | CA



Presented By:

Ron Rohrer
818.309.0628

ron@pacwestonline.com
DRE#01918399

Christopher Rohrer
818.624.1180

chris@pacwestonline.com
DRE#02018754

Scott Cox
818.244.3000

scott@pacwestonline.com
DRE#01070703

Randy Rohrer
818.244.3000

randy@pacwestonline.com
DRE#00672287



Property Information

Building SF: 3,240 SF
Land SF: 5,859 SF
Asking Price: \$1,750,000.00
Price Per SF: \$540.00
Power: 200 A; 240V; 1 Ph
Zoning: C4
Built: 1946

- › Bow Truss Creative Studio
- › Great Eagle Rock Location
- › Gated Parking
- › Full HVAC
- › 480 SF Bonus Storage
- › Exposed Brick Construction
- › 840 SF Storage Bays in Parking Lot

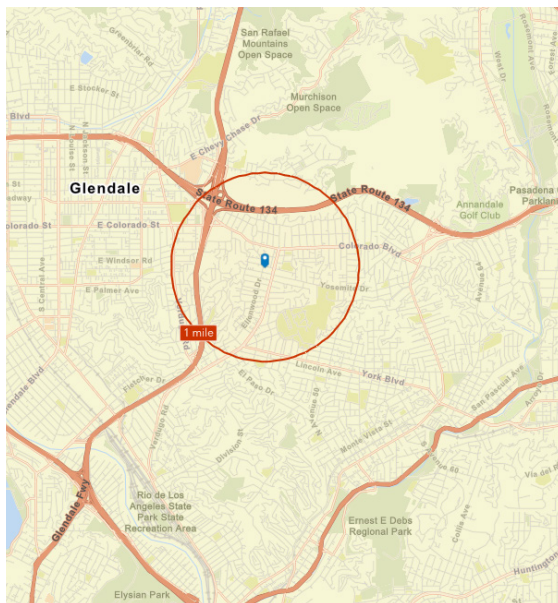

26,224

Population



Average Household Size

41.4

Median Age

\$115,940

Median Household Income

6.8%

No High School Diploma



14.4%

High School Graduate



24.1%

Some College/
Associate's Degree



54.6%

Bachelor's/Grad/
Prof Degree

BUSINESS



940

Total Businesses



6,021

Total Employees

EMPLOYMENT



White Collar



9.5%

Blue Collar



15.5%

Services

4.7%

Unemployment Rate

The facts contained herein, while not guaranteed as to accuracy, are accurate to the best of our knowledge and belief.

Floor Plan

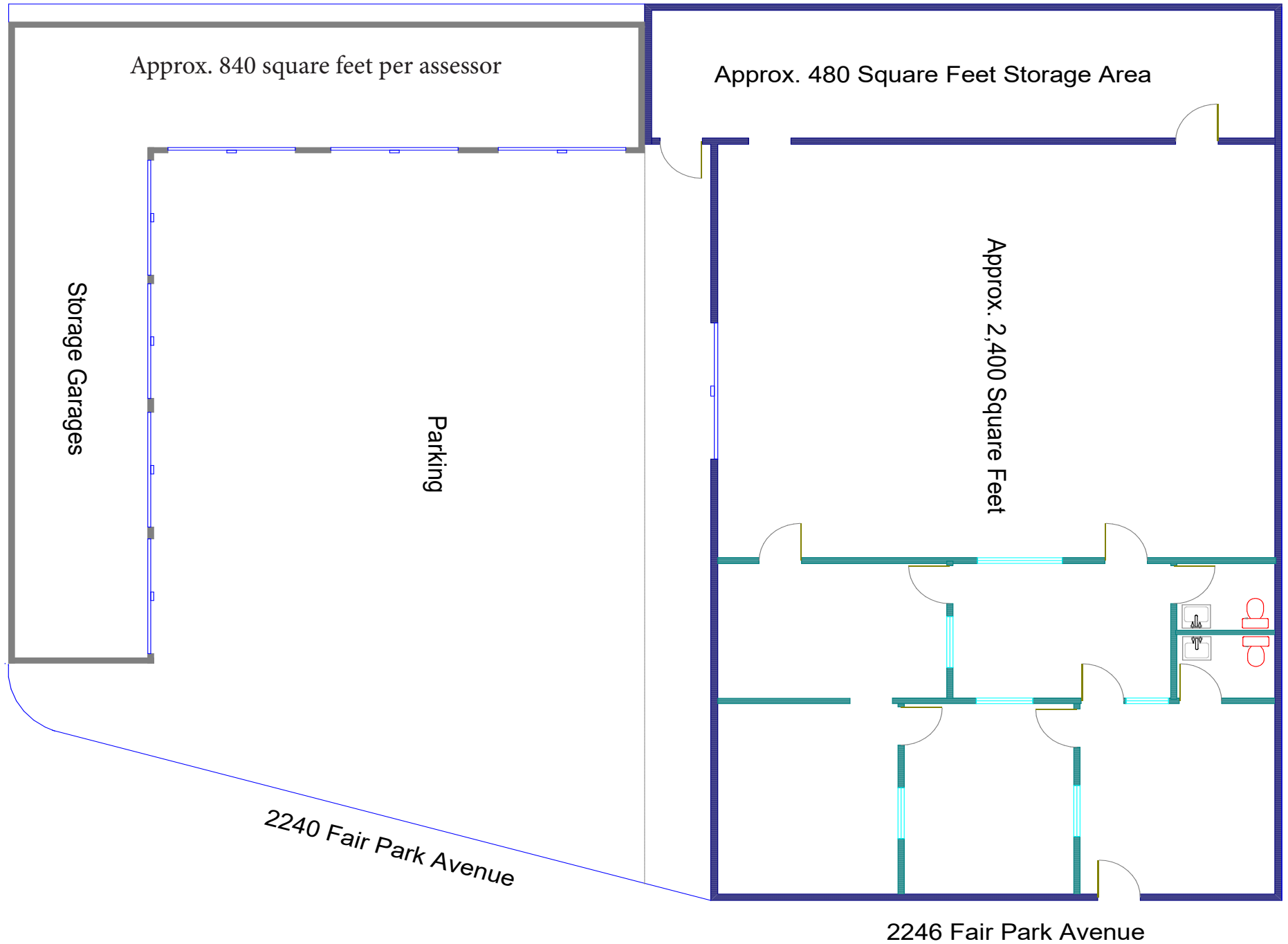

Map Location



2246 Fair Park Ave

Pacific West Business Properties, Inc.

6624 San Fernando Road Glendale, CA 91201 | 818-244-3000

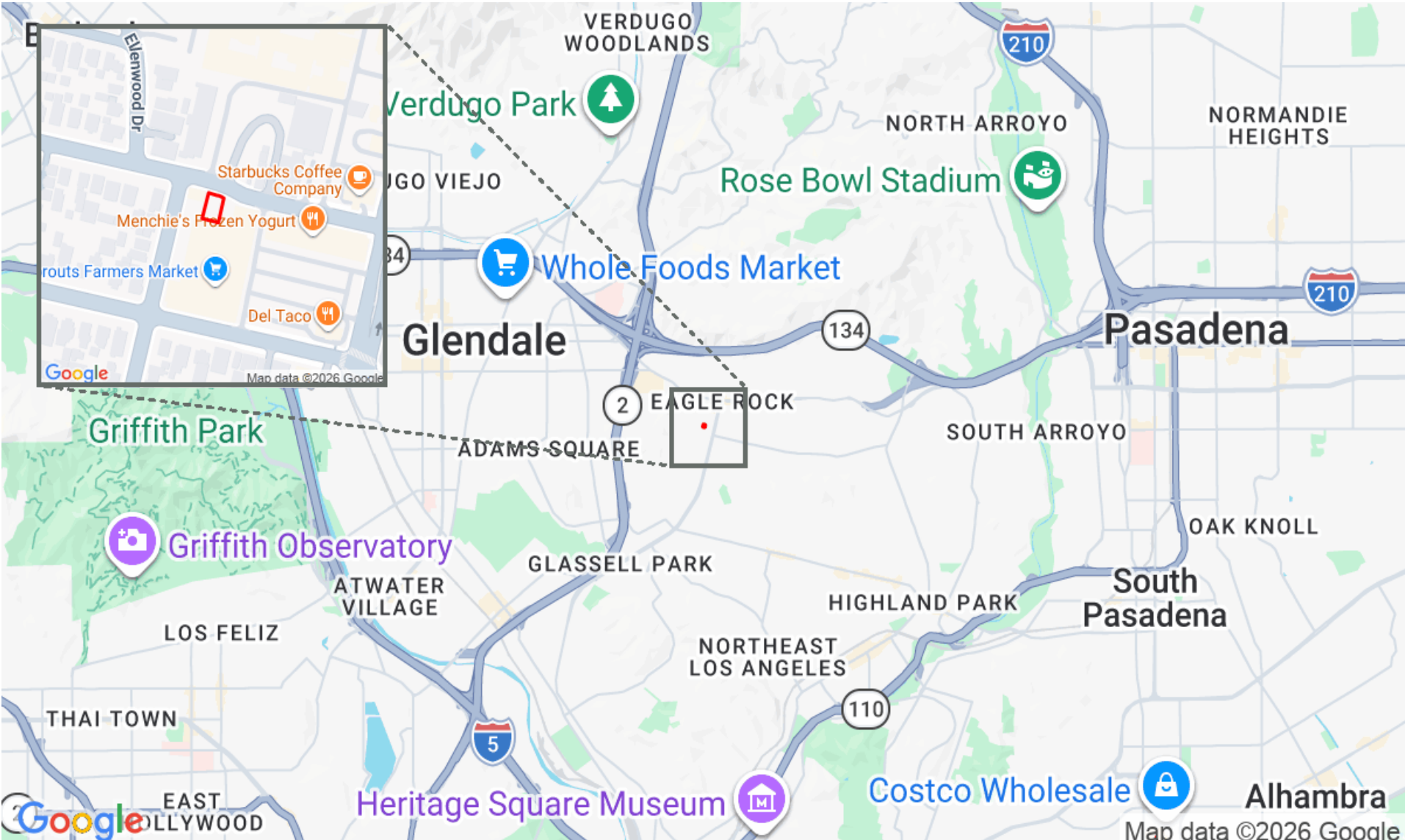

Photos



Photos

