

236 TROUTMAN STREET
BUSHWICK

**COMMERCIAL
LEASE**



236 TROUTMAN STREET
BUSHWICK



JUSTIN LOSH

(347) 388-4649

JUSTIN@COUNTRYNY.COM



OFFICE

250 MOORE ST, #302

BROOKLYN, NY 11206



PROPERTY DETAILS



INQUIRE FOR RENT



2,400 SF



NEGOTIABLE LEASE LENGTH

SINGLE STORY

EXPOSED BRICK

LIQUOR LICENSE

HVAC INSTALLED

ELECTRIC COOKING KITCHEN

VIRTUAL TOUR **HERE**

236 TROUTMAN STREET
BUSHWICK



JUSTIN LOSH

(347) 388-4649

JUSTIN@COUNTRYNY.COM



OFFICE

250 MOORE ST, #302

BROOKLYN, NY 11206



236 TROUTMAN STREET BUSHWICK



JUSTIN LOSH

(347) 388-4649

JUSTIN@COUNTRYNY.COM



OFFICE

250 MOORE ST, #302

BROOKLYN, NY 11206

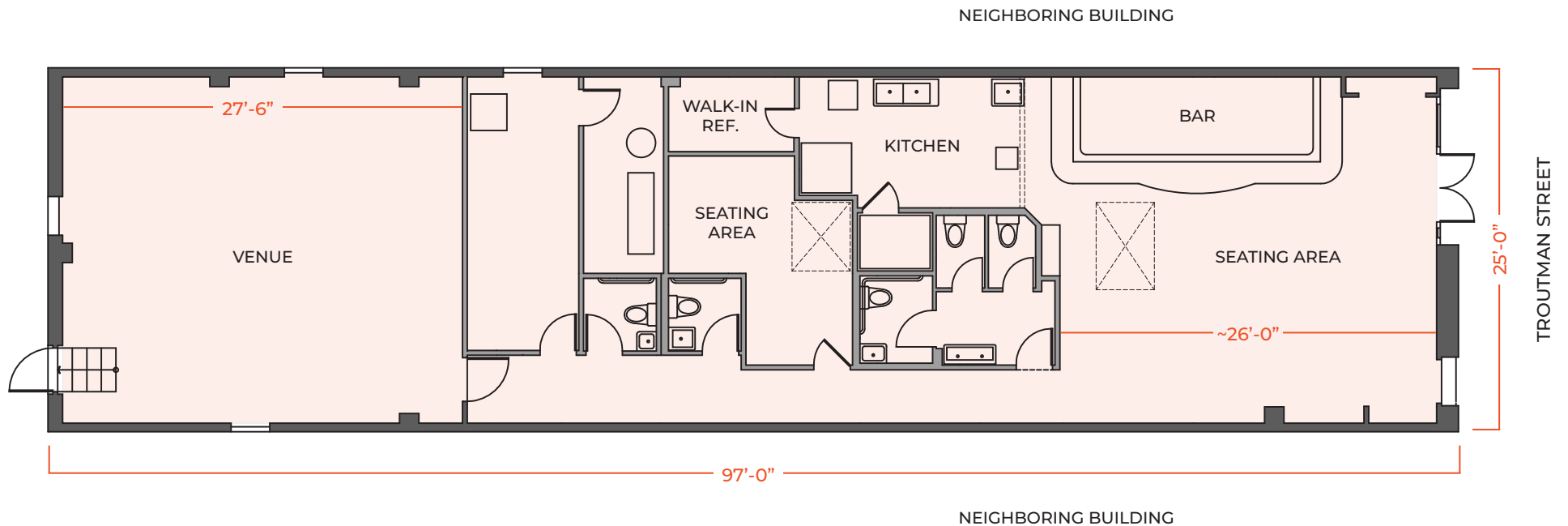

Disclaimer: Please note this floor plan is for marketing purposes and is only to be used as a guide. All efforts have been made to ensure its accuracy at time of print. Approximate measurements listed in this floor plan are reflective of the interior space dimensions only.

236 TROUTMAN STREET BUSHWICK



JUSTIN LOSH

(347) 388-4649

JUSTIN@COUNTRYNY.COM



OFFICE

250 MOORE ST, #302

BROOKLYN, NY 11206

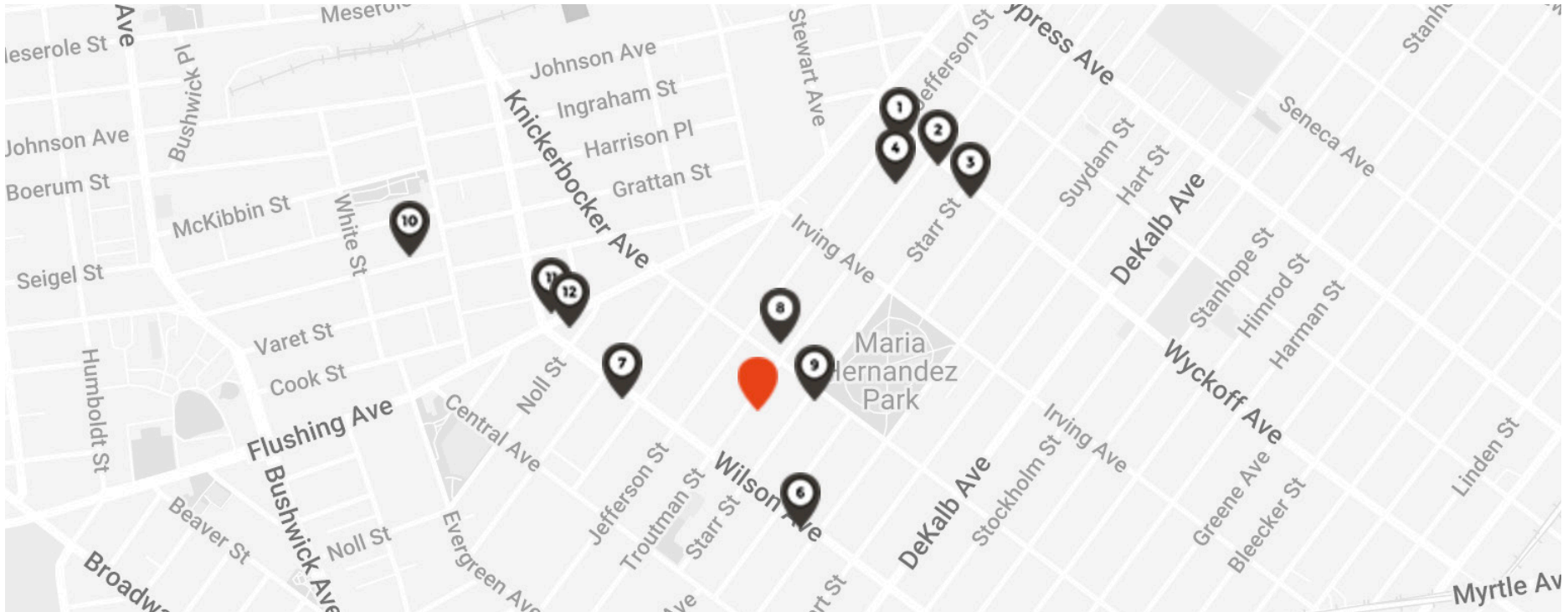

NEIGHBORS

1 - HOUSE OF YES

2 - ARTICHOKE BASILLE'S PIZZA

3 - CAROUSEL

4 - KINGS COUNTY BREWERS COLLECTIVE

5 - THE TEN BELLS

6 - ALPHAVILLE

7 - GOLD SOUNDS BAR

8 - THREE DIAMOND DOOR

9 - AYAT BUSHWICK

10 - ROBERTA'S PIZZA

11 - FOREVER THAI

12 - TABARÉ BUSHWICK

DEMOGRAPHICS

(1MI/3MI)

POPULATION - 135,769 / 1,067,049

AVERAGE AGE - 34.4 / 35.7

AVERAGE HH INCOME -

\$52,434 - \$54,808

TRANSPORT

L: JEFFERSON AVE

AVERAGE DAILY RIDERS

WEEKDAY - 10,098

WEEKEND - 11,054