

ONLY ONE SUITE **REMAINING**

29-33 NEWBURY STREET

Boston, Massachusetts

825 RSF Available



29-33 NEWBURY STREET

Boston, Massachusetts

BUILDING SPECIFICATIONS

- BUILDING SIZE:** 22,500 RSF
- AVAILABLE RSF:** Floor 3: 825 RSF
- YEAR BUILT:** 1890
- STORIES:** 5
- TERM:** Flexible
- PARKING:** Neighboring parking garages.
- NOTES:** High end build-out with mix of private offices and meeting rooms formerly occupied by a venture capital firm.



FLOOR PLANS

PROPOSED THIRD FLOOR

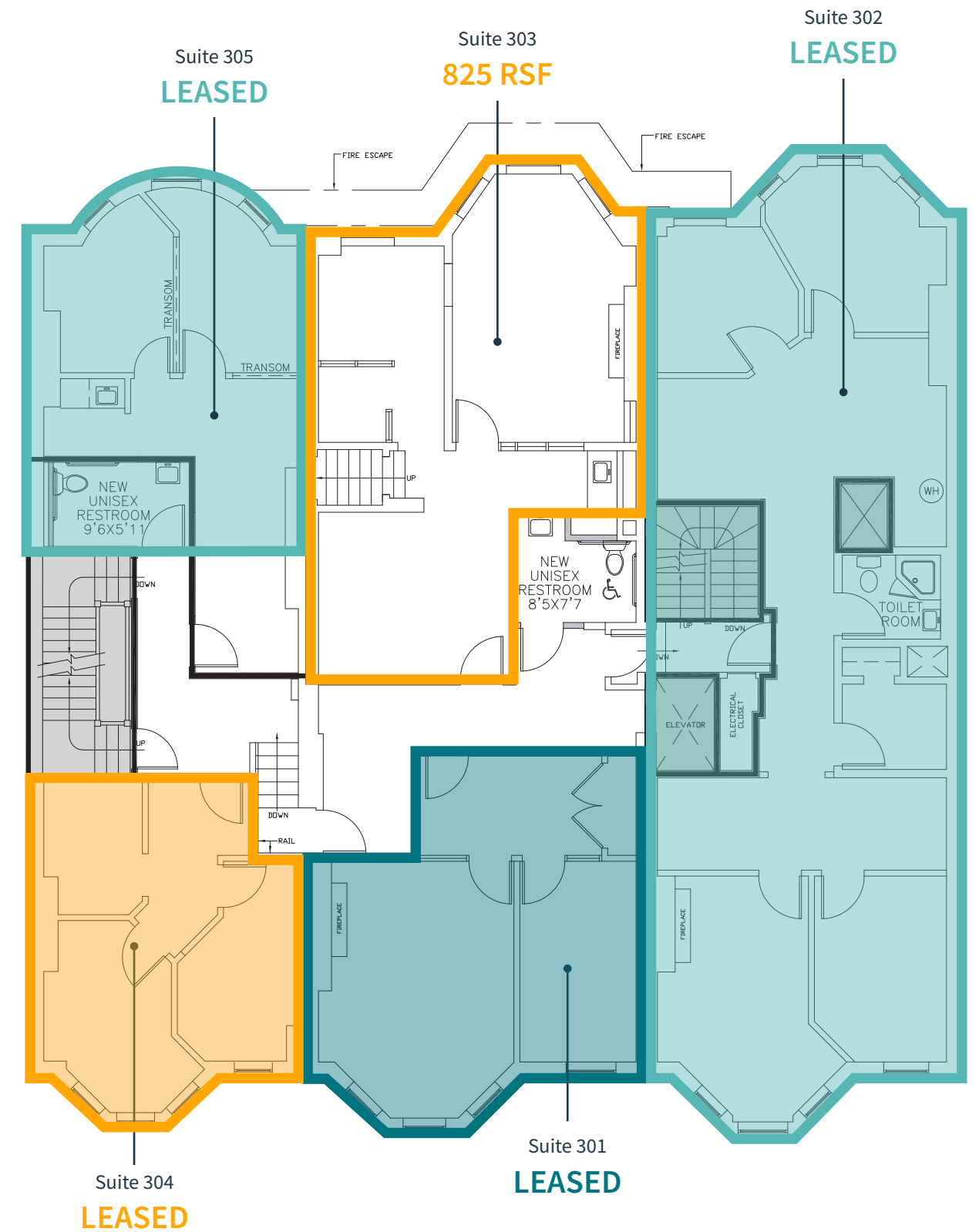

NEWBURY STREET



29-33 NEWBURY STREET

Boston, Massachusetts



< 1 MILE



< 1 MILE



3 MIN. WALK
ARLINGTON STATION
(Green Line)



10 MIN. WALK
BACK BAY STATION MBTA
(Commuter Rail, Orange Line,
Amtrak, Acela)



DOG FRIENDLY





ONLY ONE SUITE **REMAINING**

29-33 NEWBURY STREET

Boston, Massachusetts

CONTACT US TO ARRANGE A TOUR

PETER BEAN

781.771.7715

pbean@hunnemanre.com

 **HUNNEMAN** It means more to us.

303 Congress Street, Boston, MA 02210 617.457.3400 www.hunnemanre.com

@2026 Hunneman. All rights reserved. All information has been obtained from sources believed reliable but no warranty or representation is verified for accuracy or completeness. Caution and independent investigation of property and information should be verified. Reliance on this information is at your own risk.