



AVAILABLE: FOR LEASE

4647 W. 38th Street

Indianapolis, IN 46254



10,860 sf one story retail building on 0.80 acres

- SWC 38th Street and Lafayette Road
- Adjacent to McDonald's
- Existing lease is month to month

FOR LEASE: \$ 12.00 PSF NNN

Property Highlights: High Traffic location
 Excellent visibility with pole sign availability
 International Marketplace Zone designation

Tim Christensen
317.590.8254 cell
tim@obsidiandev.com

This information has been obtained from sources deemed reliable but no representation or warranty, express or implied, is made as to the accuracy of the information. It is the responsibility of the Buyer/Lessee to verify the information and to bear all risk for any inaccuracies.

PROPERTY DESCRIPTION

Location: 4647 W 38th Street / Indianapolis, IN 46254

Built: 1979
Zoning: C3
RSF: 10,860 rsf
Lot Size: 0.80 acres
Parking: Asphalt / 53 spaces
Construction: Block on concrete slab / Wood Framing
Roof: Part Rubber Membrane and part Gravel Roof
Dock / Drive ins: One dock / no drive-ins
HVAC: Gas furnace (tenant responsibility)
Utilities: Municipal
Access: Directly from 38th Street / additionally accessible from Lafayette Rd
Signage: Tenant has the right to use space on the pole sign. (4647 owns the land under the sign; IMSA owns and maintains the pole sign)

Traffic: 69,000+ VPD
Parcel #: 9046909



FINANCIAL ANALYSIS:

Pro Forma

Annual Rent: \$130,320 \$12.000 psf NNN

NNN Expenses:

RE Taxes	\$ 11,663
Insurance	\$ 3,558
CAM	\$ 500
Total	\$ 15,721

4647 W 38th Street, Indianapolis, IN 46254

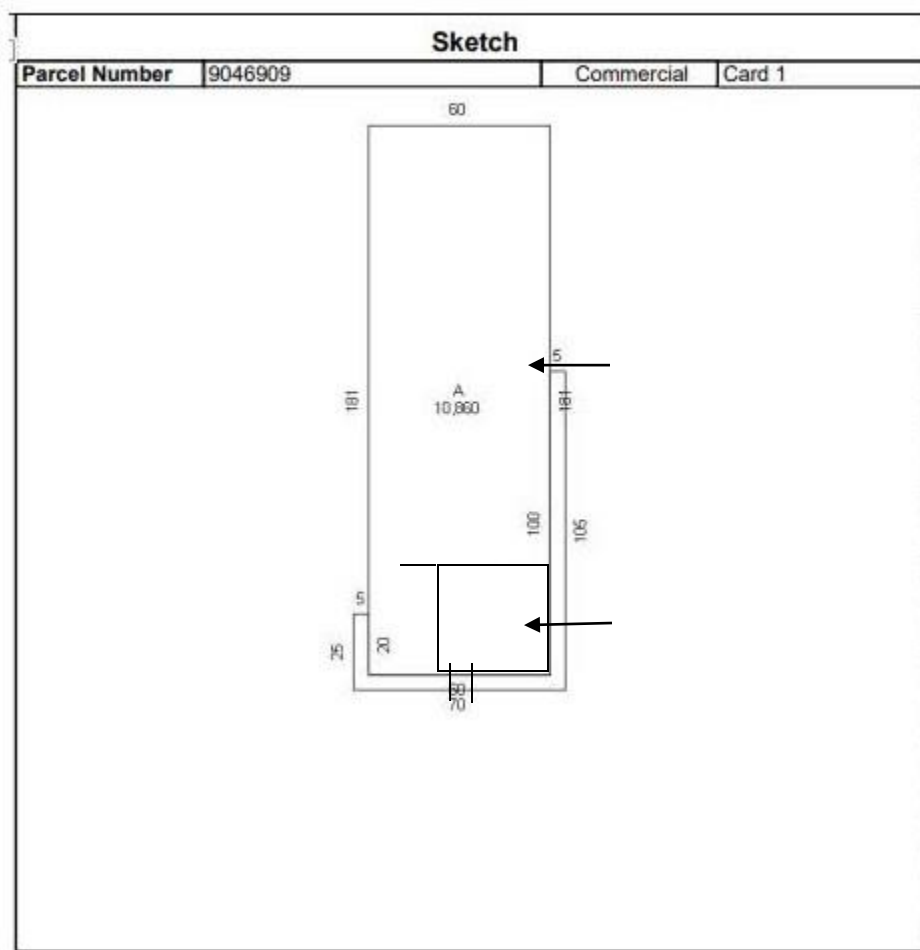

Building size: 60' x 181' +/-
Warehouse: approx. 40' x 40'
Arrows mark RR locations

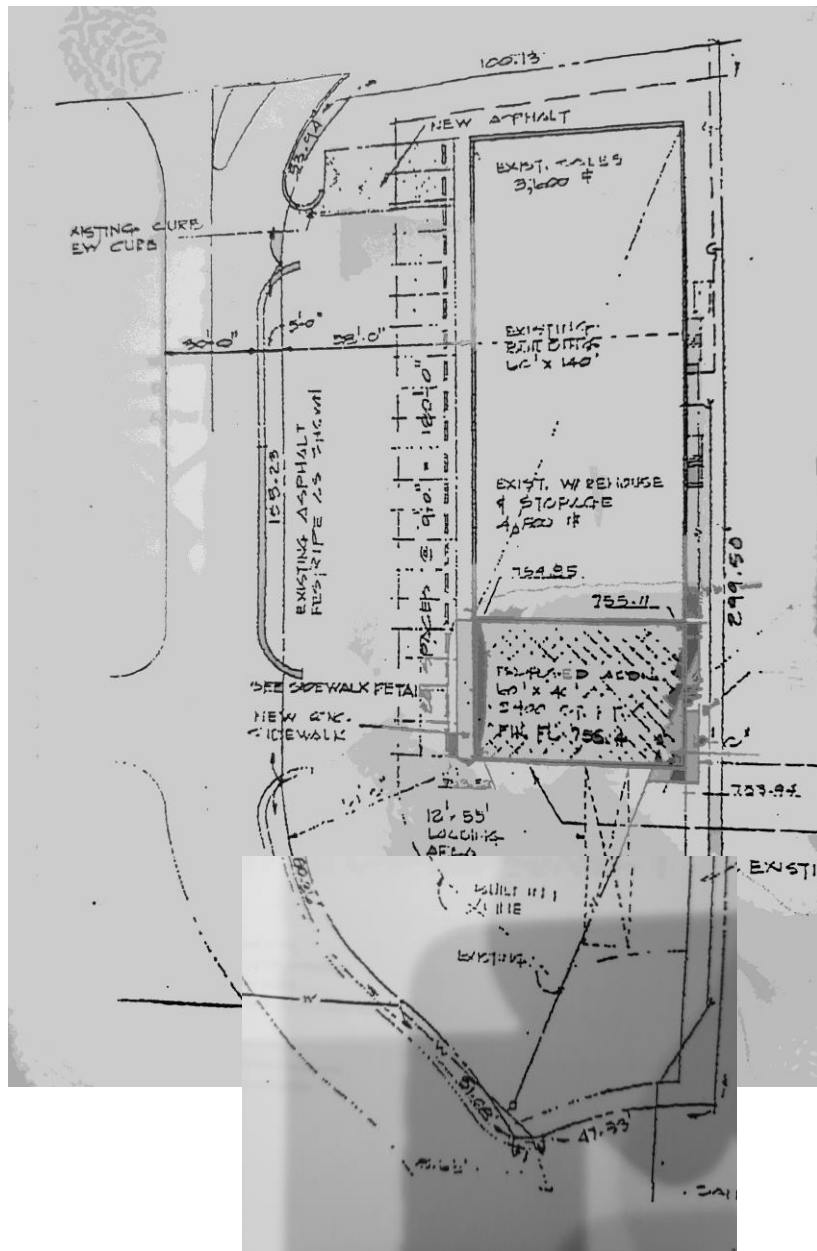

LOCAL MAPS

