

AVAILABLE

COMMERCE CROSSING BUSINESS CENTER

737 WALTZ MILL ROAD, SEWICKLEY TOWNSHIP, PA 15679

250,200 SF AVAILABLE

NEW CLASS A INDUSTRIAL WAREHOUSE



FOR MORE INFORMATION:

RICH GASPERINI
rgasperini@genforrealestate.com
D 412.564.0752 | C 412.651.6888

MATEO VILLA
mvilla@genforrealestate.com
D 412.564.0754 | C 412.715.3454

GENFOR
REAL ESTATE

MERUS

AVAILABLE

COMMERCE CROSSING BUSINESS CENTER

737 WALTZ MILL ROAD, SEWICKLEY TOWNSHIP, PA 15679

BUILDING SPECS

250,200 SF MODERN WAREHOUSE

NEW CONSTRUCTION

BUILDING SF	250,200 SF
CONSTRUCTION	Pre-cast concrete panels
SITE SIZE	26.3 acres
TRUCK COURT	135'
ZONING	M-T Manufacturing - Technology

BUILDING SPECS

AVAILABLE SF	250,200 SF
BUILDING DIMENSIONS	834'w x 300'd flexible design
MINIMUM SUBDIVISION	66,300 SF
OFFICE SPACE	Build-to-suit (BTS)
PARKING (CARS)	119 spots
TRAILER PARKING	Up to 26 trailer spaces
COLUMN SPACING	56' x 60'
CLEAR HEIGHT	32'
DOCK DOORS	Twenty-five (25) 9' x 10' dock high doors; plus twenty-five (25) future dock positions
DOCK EQUIPMENT	30,000 lb mechanical levelers; shelters, bumpers, and track guards in place
DRIVE-IN DOORS	Two (2) 12' x 14' grade level doors
SPRINKLER	ESFR with K-17 heads
WAREHOUSE HVAC	Gas-fired heating units
LIGHTING	LED
FLOOR SLAB	6" concrete floor; 3,500 PSI
ROOF	TPO roof system



LOCATION HIGHLIGHTS

- Excellent interstate access to I-70 and I-76/PA Turnpike
- Strong area for industrial development in Westmoreland County
- In close proximity to numerous freight and trucking facilities

AVAILABLE

COMMERCE CROSSING BUSINESS CENTER

737 WALTZ MILL ROAD, SEWICKLEY TOWNSHIP, PA 15679

SITE PLAN

250,200 SF AVAILABLE SPACE

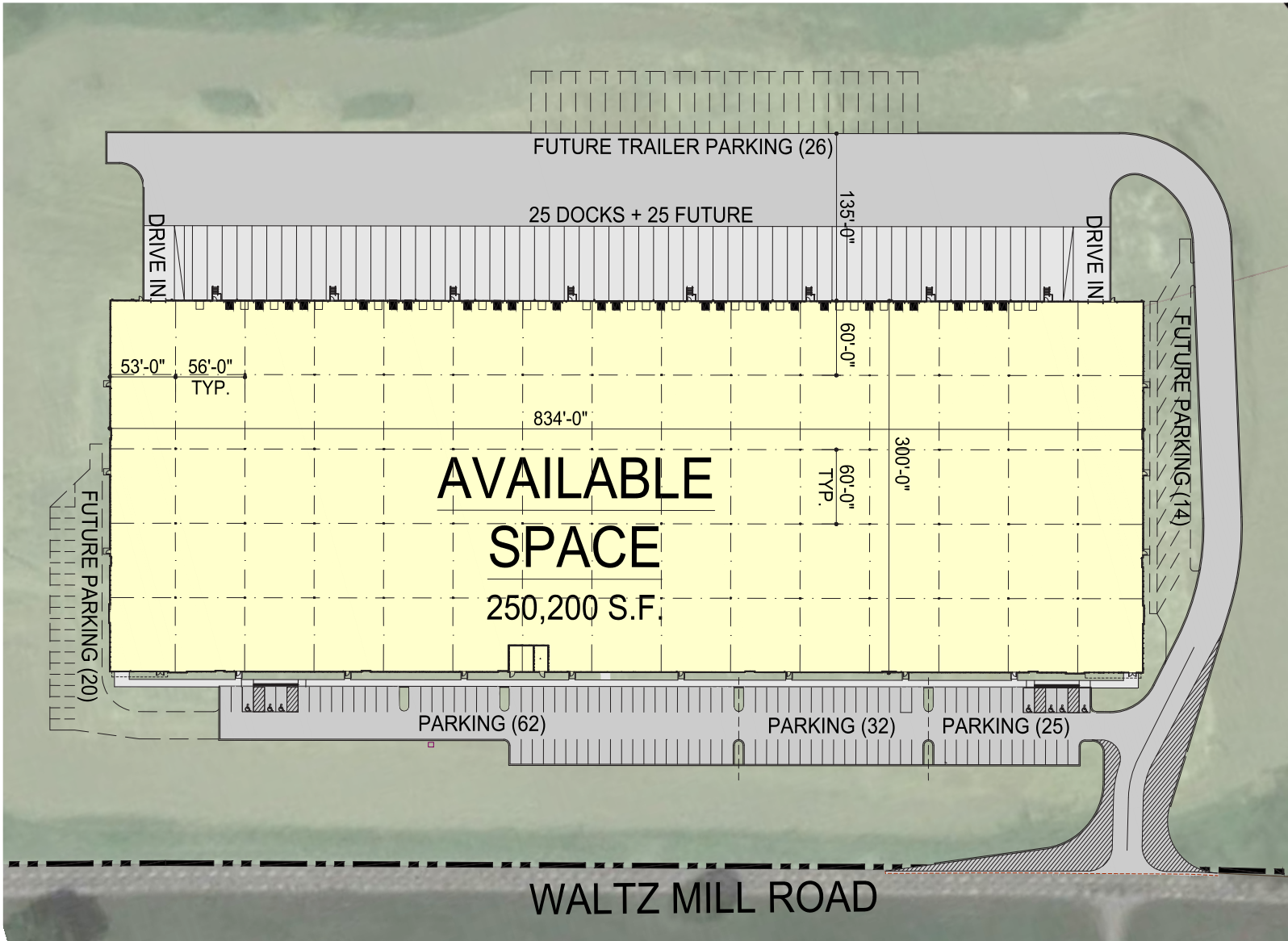

AVAILABLE

COMMERCE CROSSING BUSINESS CENTER

737 WALTZ MILL ROAD, SEWICKLEY TOWNSHIP, PA 15679

LOCATION / LOGISTICAL AMENITIES

EXCELLENT INTERSTATE ACCESS



COMMERCE CROSSING
737 WALTZ MILL RD

KEY HIGHWAY DISTANCES

- Immediate access to I-70
- Less than 4 miles to PA Turnpike / I-76

AVAILABLE

COMMERCE CROSSING BUSINESS CENTER

737 WALTZ MILL ROAD, SEWICKLEY TOWNSHIP, PA 15679



Please contact the leasing team for more information:

RICH GASPERINI
rgasperini@genforrealestate.com
D 412.564.0752 | C 412.651.6888

MATEO VILLA
mvilla@genforrealestate.com
D 412.564.0754 | C 412.715.3454

GENFOR REAL ESTATE
One Altoona Place, Suite 2A
Pittsburgh, PA 15228
Office: 412.564.0750
www.genforrealestate.com

CONNOR JANGRO
cjangro@genforrealestate.com
D 412.564.0776 | C 412.805.7064

All information contained herein has been obtained from sources deemed reliable and Genfor, LLC does not doubt its accuracy; however, Genfor, LLC makes no guarantee, representation or warranty of any kind or nature, either express or limited, with respect to the accuracy or completeness of all or any portion of the information contained herein. Terms of availability of this property are subject to change and this property may be withdrawn without notice.

LEASING BY:

GENFOR
REAL ESTATE

DEVELOPED BY:

MERUS