

FOR LEASE

# CENTER CITY LAND LEASES AVAILABLE

Providence, RI



## DEVELOPMENT OPPORTUNITIES

- 6 Parcels available for office, residential, and/or mixed-use development
- Located in the heart of Downtown Providence with immediate access to the Central Business District, Brown University, RI School of Design, and Johnson & Wales University
- Short walk to world-acclaimed restaurants, shopping & culture
- Near Northeast Corridor Rail Service (Amtrak/MBTA)
  - 55 minutes to Boston; 3 hours to NYC
- Parcels range in size from  $\pm 0.51$  to  $\pm 1.06$  acres, contiguous up to  $\pm 1.86$  acres



# INCREDIBLE CITY CENTER

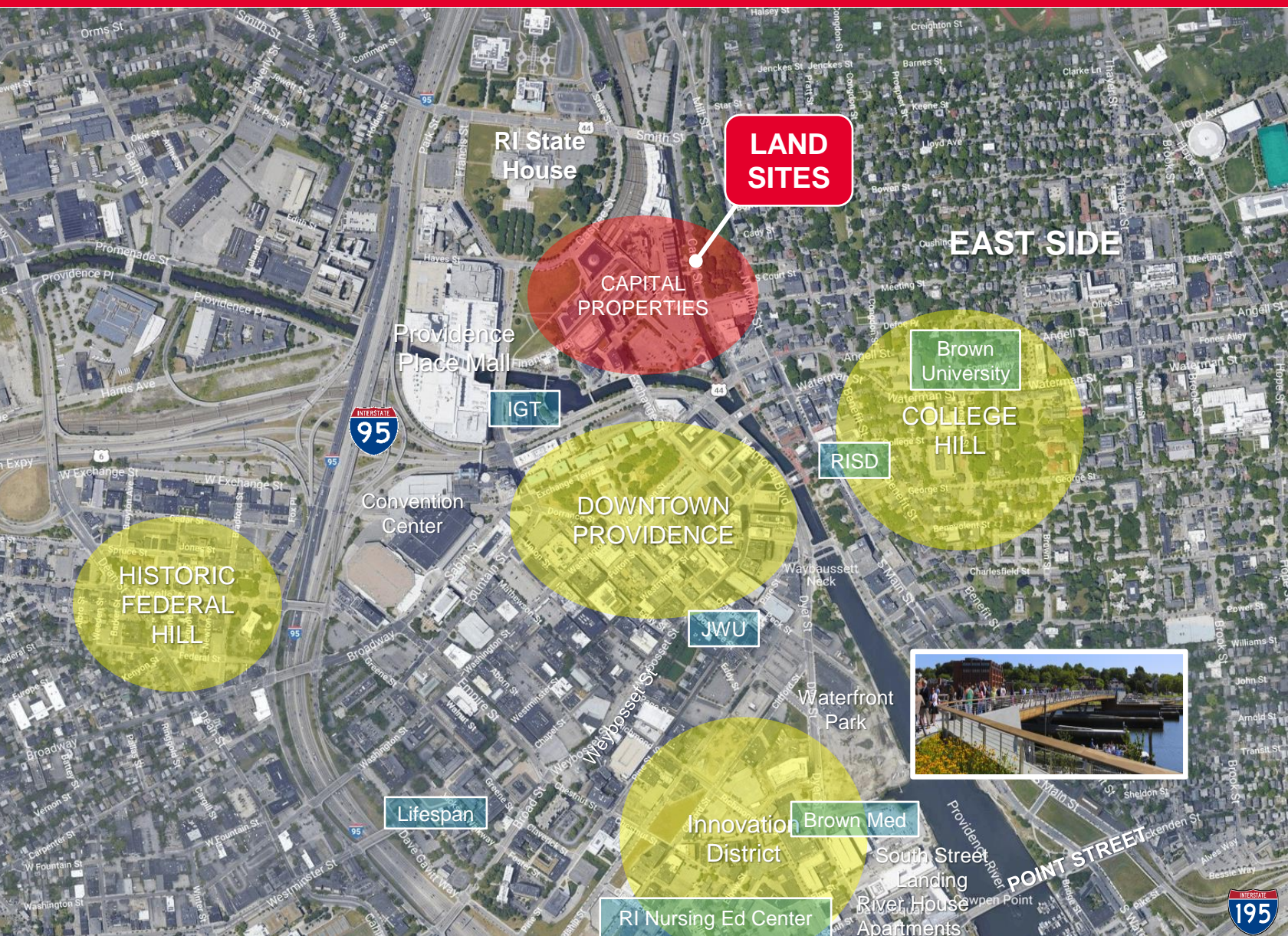

**3 miles**

**5 miles**

**10 miles**

**232,931** PEOPLE

**141,832** DAYTIME POP.

**\$71,899** AVG.HH \$

**430,845** PEOPLE

**224,705** DAYTIME POP.

**\$74,931** AVG.HH \$

**722,138** PEOPLE

**359,378** DAYTIME POP.

**\$86,291** AVG.HH \$

## Drive Times

T.F. GREEN AIRPORT	19 MINUTES
BOSTON	55 MINUTES
HARTFORD	1H, 33 MINUTES
NYC	3 HOURS

## Transit Distance

AMTRAK	0.4 MILES
RIPTA	0.4 MILES
T.F. GREEN AIRPORT	10.7 MILES
NYC	180 MILES



# LAND LEASES AVAILABLE

**LAND SITES**

**60 MILE RADIUS TO PROVIDENCE BY COUNTY - JOBSEQ**

**55 min. Drive-time Boston**

**1 hour, 33mins. Drive-time Hartford**

**±3 hours Drive-time New York City**

# LAND LEASES AVAILABLE

**LAND SITES**

**60 MILE RADIUS TO PROVIDENCE BY COUNTY - JOBSEQ**

**55 min. Drive-time Boston**

**1 hour, 33mins. Drive-time Hartford**

**±3 hours Drive-time New York City**

[illegible]

# LAND LEASES AVAILABLE

**LAND SITES**

**60 MILE RADIUS TO PROVIDENCE BY COUNTY - JOBSEQ**

**55 min. Drive-time Boston**

**1 hour, 33mins. Drive-time Hartford**

**±3 hours Drive-time New York City**

[illegible]

# LAND LEASES AVAILABLE

**LAND SITES**

**60 MILE RADIUS TO PROVIDENCE BY COUNTY - JOBSEQ**

**55 min. Drive-time Boston**

**1 hour, 33mins. Drive-time Hartford**

**±3 hours Drive-time New York City**

# Park Row West / Moshassuck Court

Property	10 Park Row West
Parcel	4E
Land Area	0.51 acres
Property	1 Park Row West
Parcel	4W
Land Area	1.06
Property	6 Moshassuck Ct.
Parcel	3E
Land Area	0.55
Property	5 Moshassuck Ct.
Parcel	3W
Land Area	0.80

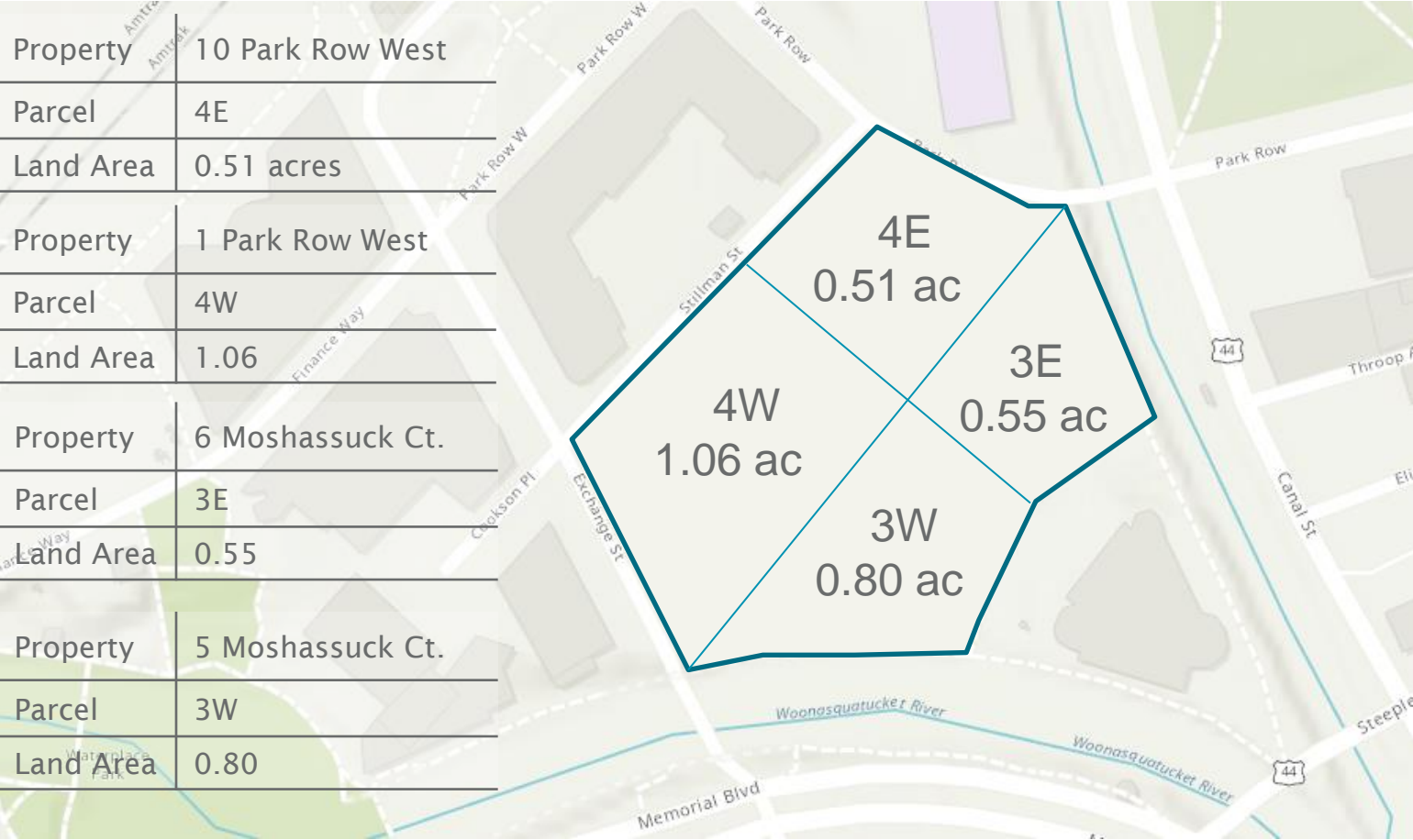

# Canal Street



Property	129 Canal Street
Parcel	20
Land Area	0.61 acres



Park Row West

Property	25 Park Row West
Parcel	6C
Land Area	1.48 acres

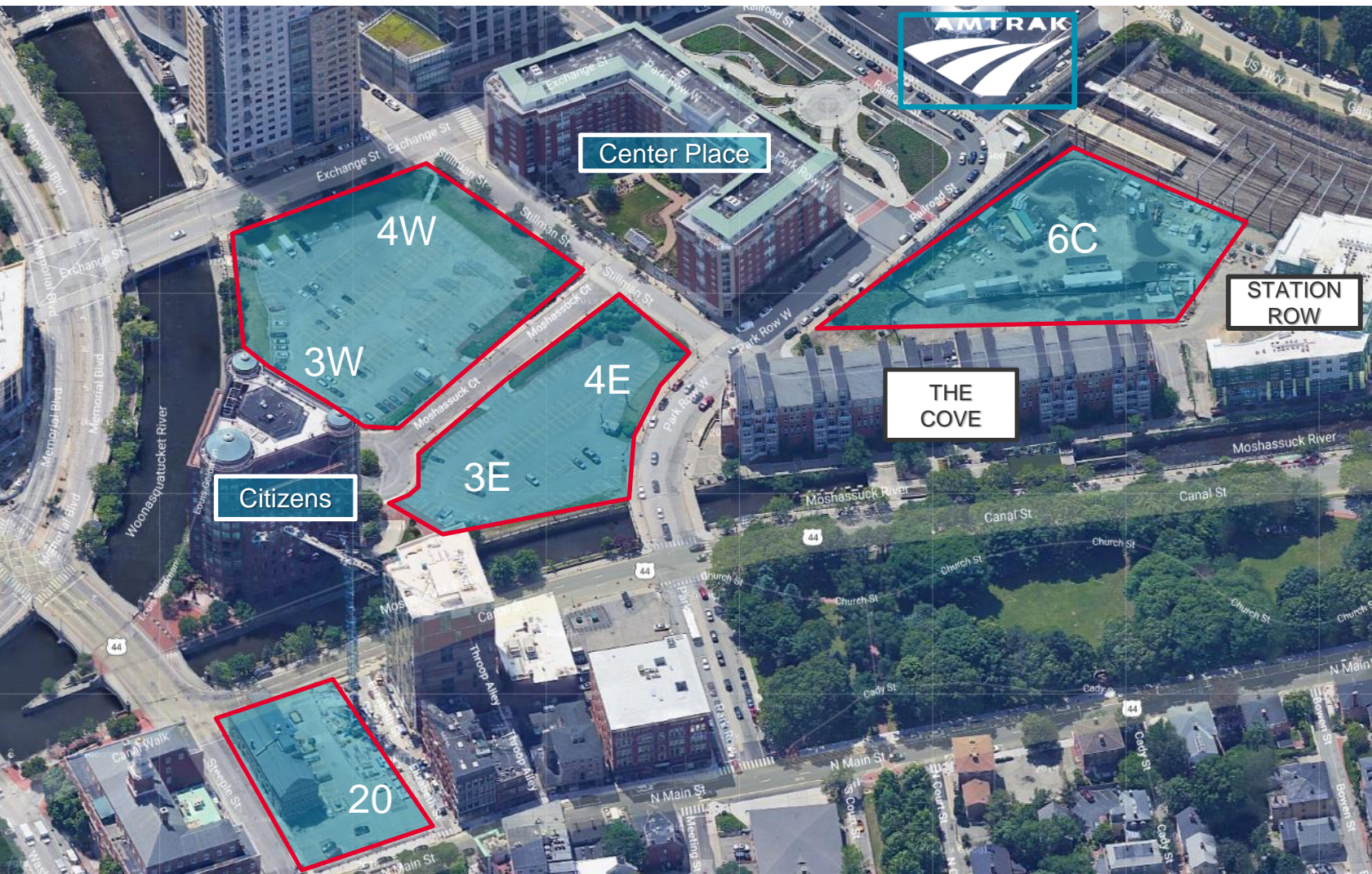





# Rhode Island



## OPTIMAL LOCATION

- Ideal location in Northeast
- All the benefits of major commercial centers
- Easy access to top companies
- All manner of transportation; air, land, sea
- World-class universities



## POPULATION

- 1.06 million (2020)
- Consistent population growth over the past several years
- The population of Rhode Island is on a trajectory of continued growth



## EMPLOYMENT

- A workforce of 4.7 million people within a 1-hour commute of Providence
- Over 98.9% of firms in RI are small businesses that employ 53.5% of the workforce (2017 SBA Profile)



## HIGHER EDUCATION

- Brown University
- RI School of Design
- Johnson & Wales University
- University of Rhode Island
- Bryant University
- Roger Williams University
- Rhode Island College
- Providence College
- New England Institute of Technology
- Salve Regina





A STRONG PRESENCE OF FORTUNE 500 & FORTUNE 1000 COMPANIES LEND LONG-TERM STABILITY AND GROWTH TO RHODE ISLAND

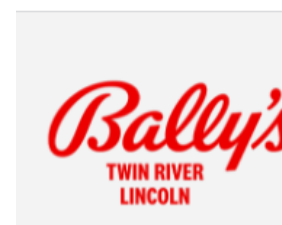



**CUSHMAN &  
WAKEFIELD**

**HAYES & SHERRY**  
REAL ESTATE SERVICES

---

## CONTACT

**Derek Brazeau**  
**Multifamily Broker**

401.273.2052

[dbrazeau@hayessherry.com](mailto:dbrazeau@hayessherry.com)

**Pete Hayes**  
**Partner**

401.273.7426

[phayes@hayessherry.com](mailto:phayes@hayessherry.com)

146 Westminster Street, 2<sup>nd</sup> floor  
Providence, RI 02903  
phone: 401.273.1980  
[hayessherry.com](http://hayessherry.com)

Cushman & Wakefield Copyright 2022. No warranty or representation, express or implied, is made to the accuracy or completeness of the information contained herein, and same is submitted subject to errors, omissions, change of price, rental or other conditions, withdrawal without notice, and to any special listing conditions imposed by the property owner(s). As applicable, we make no representation as to the condition of the property (or properties) in question.