

155-157 EAST DRIVE

BRAMPTON, ON

FOR SALE
USER/INVESTOR
OPPORTUNITY



**CUSHMAN &
WAKEFIELD**



// PROPERTY DETAILS



BUILDING SIZE: 14,144 SF



SHIPPING: 18 DRIVE-IN DOORS



NOI: \$375,000 (2025)



LOT SIZE: 1.40 ACRES



CEILING HEIGHT: 18' CLEAR



NUMBER OF UNITS: 5







REALTY TAX: \$34,198 (2025)

2 Multi-tenant industrial/automotive buildings, currently 100% occupied by
5 Tenants, ideal for user/investor or condominium conversion. Clean ESA available.

[Click here for NDA](#)

// SUMMARY OF TENANTS

TENANT	BUILDING NUMBER / UNIT	SIZE	LEASE EXPIRY	LANDLORD RIGHTS TO TERMINATE
 FLASHTECH AUTOMOTIVE	155	4,751	May 31st, 2030	90 Days
 SANTA MARIA RESTAURANT	157A	2,000	March 31st, 2030	90 Days
 ADANAC AUTOMOTIVE	157B	3,200	March 31st, 2030	90 Days
 FLASHTECH AUTOMOTIVE	157C	2,355	March 31st, 2030	90 Days
 JEET AUTO ZONE INC	157D	2,000	March 31st, 2030	90 Days

// PROPERTY PHOTOS

155 & 157C - FLASHTECH AUTOMOTIVE



157A - SANTA MARIA RESTAURANT



// PROPERTY PHOTOS

157B - ADANAC AUTOMOTIVE



157D - JEET AUTO ZONE INC



// FLOOR PLANS

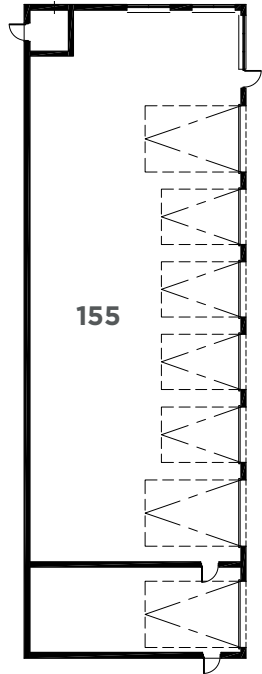

BUILDING	RENTABLE AREA
155	4,751 SF
157	9,393 SF
TOTAL	14,144 SF

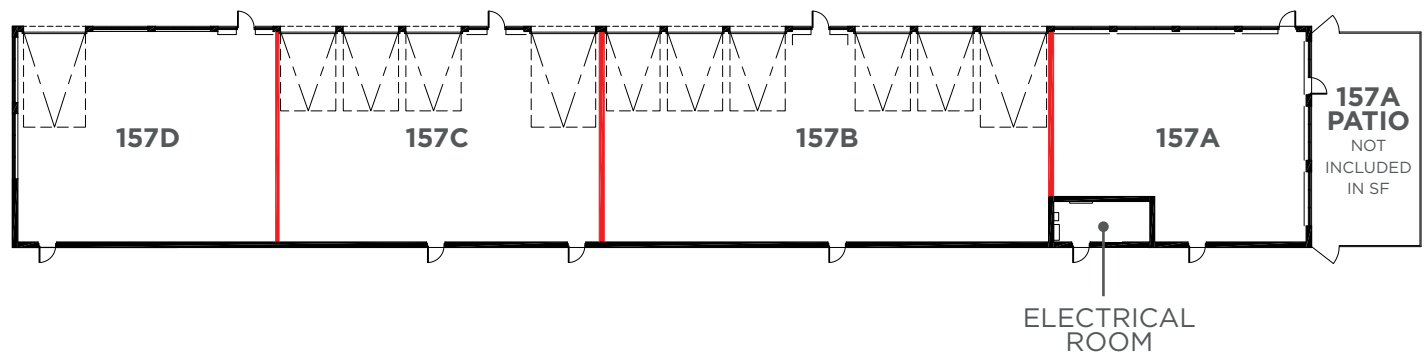
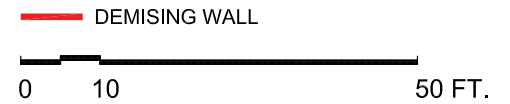

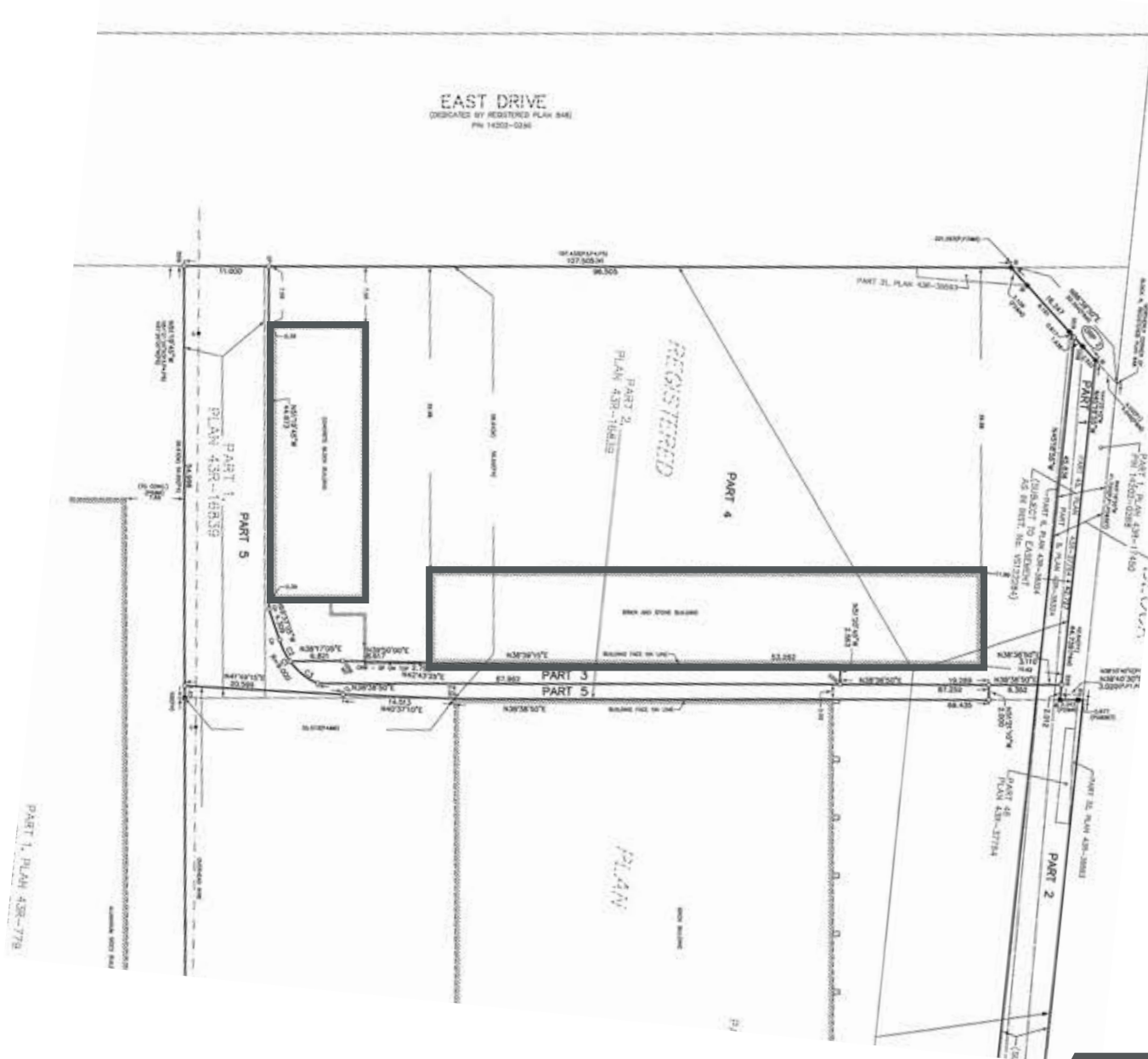

// ZONING MAP



M2 INDUSTRIAL ZONING

[Click the link for Permitted Uses](#)

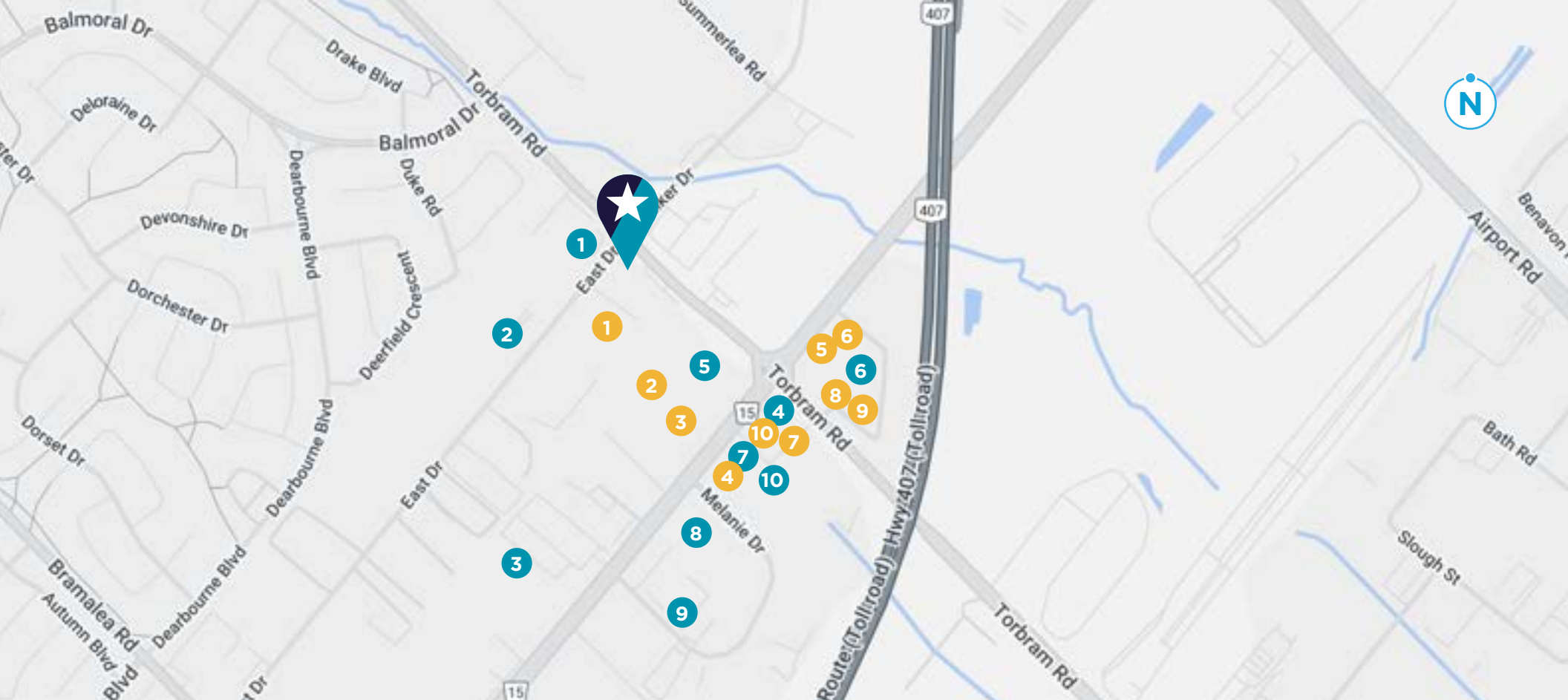

// AMENITIES MAP

RESTAURANTS

- | | |
|----------------------------------|------------------------------|
| 1. Street Chataka | 6. Sanjhi Rasoi |
| 2. BDS Food Service | 7. Tim Hortons |
| 3. Kwality Sweets and Restaurant | 8. Pannu's Dining & Desserts |
| 4. Tandoori Style Restaurant | 9. Taza Tasate |
| 5. MoMos 'N Wok | 10. McDonald's |

SHOPS

- | | |
|----------------------------------------|-----------------------------|
| 1. U-Haul Moving & Storage of Bramalea | 6. Sacha Souda Plaza |
| 2. Transcontinental Brampton | 7. Majha Malwa Doaba |
| 3. AAR Plumbing & Heating Supply | 8. India Sajawat & Puja Hut |
| 4. Circle K | 9. Tire World |
| 5. Hardwood Giant | 10. Robin's Autoparts |

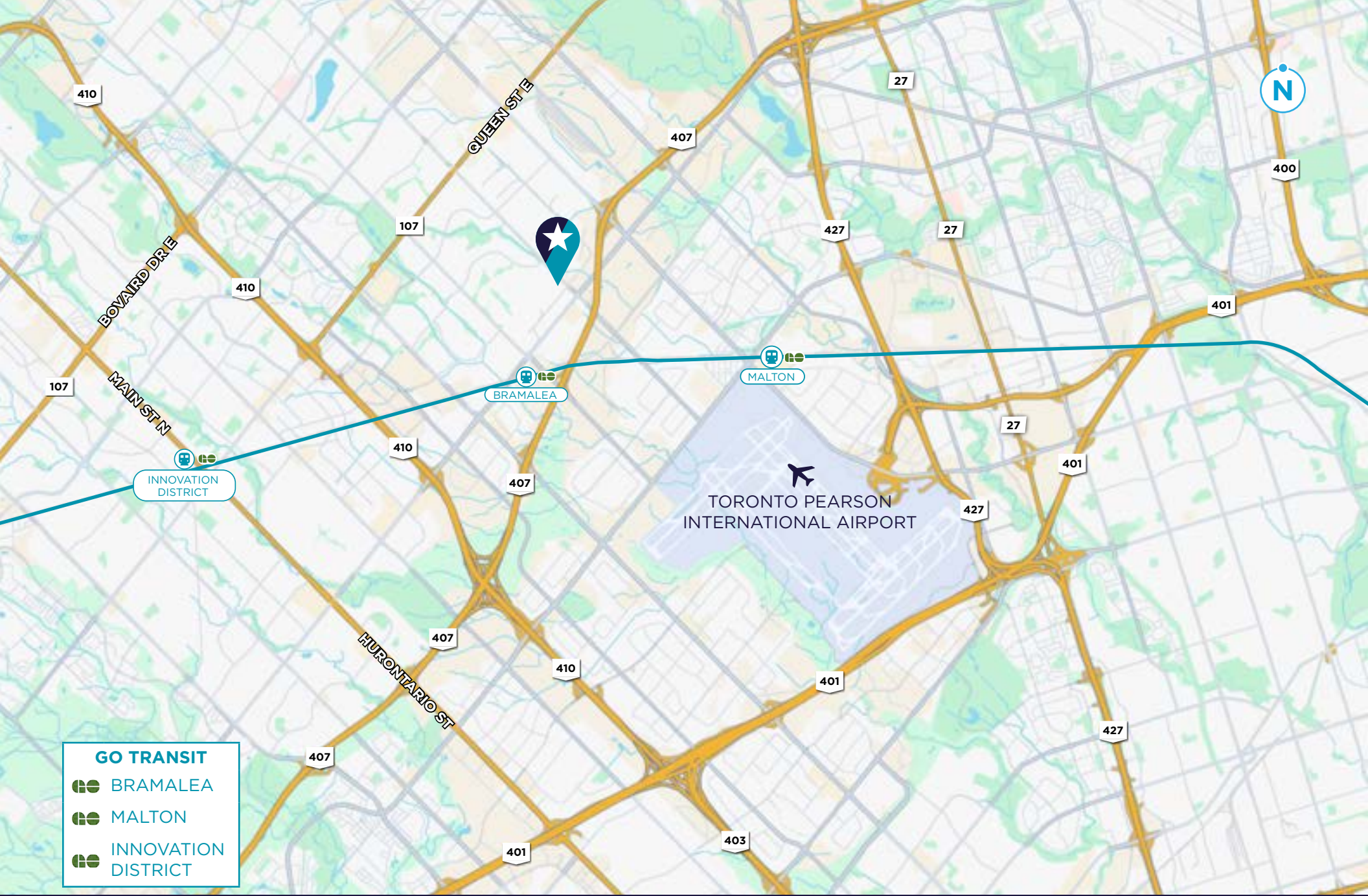

// TRANSPORTATION MAP

155-157 EAST DRIVE

BRAMPTON, ON



FOR MORE INFORMATION, PLEASE CONTACT:

GORAN BRELIH, B.SC.ENG.,SIOR

Executive Vice President, Broker

Direct: +1 416 756 5456

Mobile: +1 416 458 4264

goran.brelih@cushwake.com

DIANA MCKENNON

Sales Representative

Direct: +1 416 642 5356

Mobile: +1 647 400 9801

diana.mckennon@cushwake.com

1500 Don Mills Road, Suite 401
North York, ON M3B 3K4

cushmanwakefield.com

©2025 Cushman & Wakefield. All rights reserved. The information contained in this communication is strictly confidential. This information has been obtained from sources believed to be reliable but has not been verified. NO WARRANTY OR REPRESENTATION, EXPRESS OR IMPLIED, IS MADE AS TO THE CONDITION OF THE PROPERTY (OR PROPERTIES) REFERENCED HEREIN OR AS TO THE ACCURACY OR COMPLETENESS OF THE INFORMATION CONTAINED HEREIN, AND SAME IS SUBMITTED SUBJECT TO ERRORS, OMISSIONS, CHANGE OF PRICE, RENTAL OR OTHER CONDITIONS, WITHDRAWAL WITHOUT NOTICE, AND TO ANY SPECIAL LISTING CONDITIONS IMPOSED BY THE PROPERTY OWNER(S). ANY PROJECTIONS, OPINIONS OR ESTIMATES ARE SUBJECT TO UNCERTAINTY AND DO NOT SIGNIFY CURRENT OR FUTURE PROPERTY PERFORMANCE.