



TRANSWESTERN

# Governors Lakes 100

3091 GOVERNORS LAKE DRIVE - BUILDING 100 | PEACHTREE CORNERS, GA 30071

Governors  
Lakes



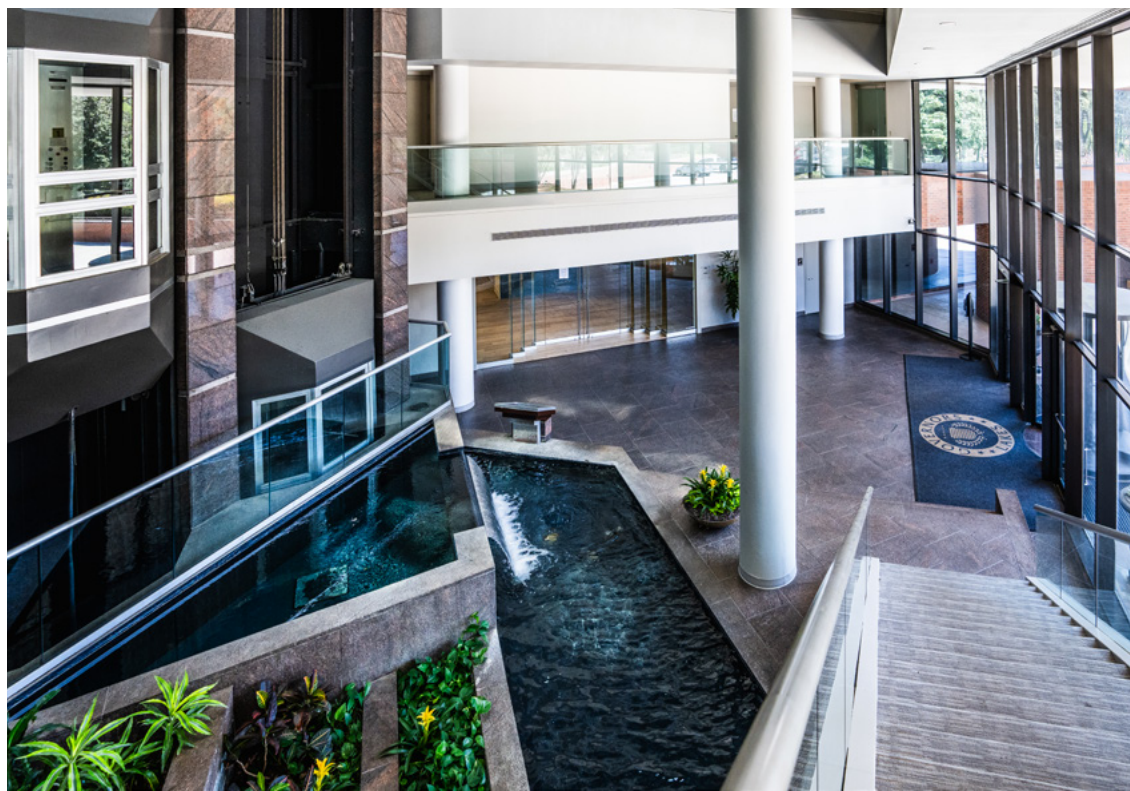

## PROPERTY HIGHLIGHTS

- Enhanced Landscaping
- Revitalization of Lobbies and Restrooms
- Direct Interstate Access Via GA-141
- Excellent Signage Visibility
- 3.6/1,000 SF Parking Ratio
- 25+ Walkable Restaurants







## PEACHTREE CORRIDOR CONNECTIVITY

- Direct connection to the Interstate System via GA-141
- Only 2 street lights to Hartsfield-Jackson Atlanta International Airport
- Over \$3 Billion in recent interstate improvements, with \$1 Billion more in progress
- Strategically located near multiple major office hubs, with access to a thriving community of professionals
- Multi-use trail system encircling Peachtree Corners and running directly through Technology Park underway



**1 THE FORUM PEACHTREE CORNERS**  
DRIVE TIME: 13-15 MIN



**3 VILLAGE AT PEACHTREE CORNERS**  
DRIVE TIME: 12-14 MIN



**4 PEACHTREE CORNERS MARKETPLACE**  
DRIVE TIME: 8-10 MIN



**2 PEACHTREE CORNERS TOWN CENTER**  
DRIVE TIME: 12-14 MIN



**5 PEACHTREE SQUARE SHOPPING CENTER**  
DRIVE TIME: 8-10 MIN



Governors  
Lakes

NEARBY AMENITIES





**Greg Frankum**

Executive Managing Director

404.842.6565

[greg.frankum@transwestern.com](mailto:greg.frankum@transwestern.com)

**Matt Spickard**

Senior Managing Director

404.842.6566

[matt.spickard@transwestern.com](mailto:matt.spickard@transwestern.com)

**Ansley Chenault**

Brokerage Associate

404.266.4952

[ansley.chenault@transwestern.com](mailto:ansley.chenault@transwestern.com)

**Governors  
Lakes**

3091 GOVERNORS LAKE DRIVE

BUILDING 100

PEACHTREE CORNERS, GA 30071