



CLARION PARTNERS

For Lease

Pacific Coast Corporate Park, Phase II
4179 70th Ave E
Fife, WA 98424

402,342 Square Feet Available



BUILDING HIGHLIGHTS

- 402,342 SF Available
- 10,044 SF Office
- 30' Clear Height
- ESFR Sprinkler System
- 86 Dock High Doors
- 4 Ramped Doors
- 54 Trailer Stalls
- Fenced Loading Area
- Available October 1, 2023
- Call Brokers for Rates

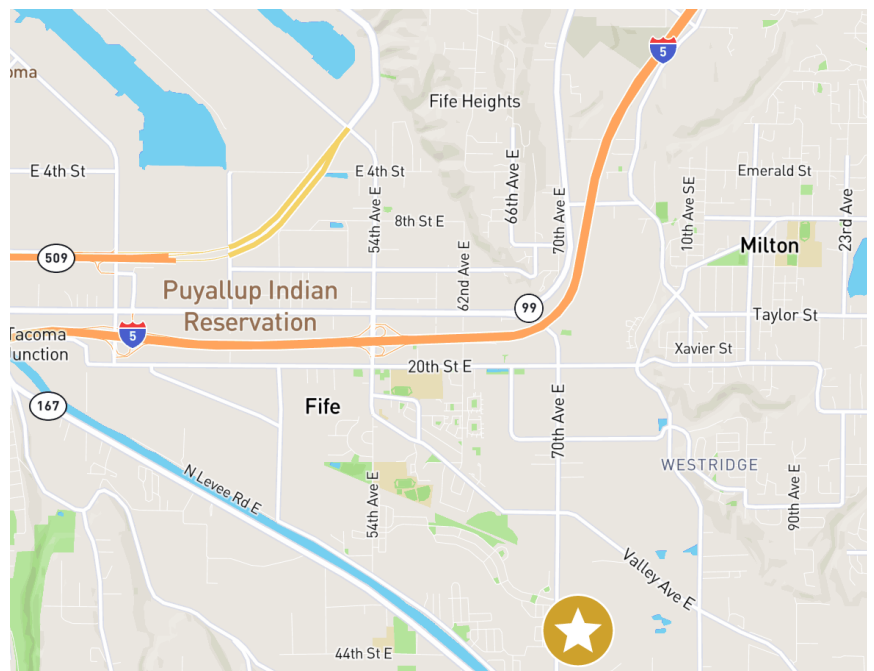

This information contained herein was obtained from sources deemed reliable and is believed to be true. It has not been verified and as such, cannot be warranted nor form any part of any future contract.



CLARION PARTNERS

Pacific Coast Corporate Park. Phase II

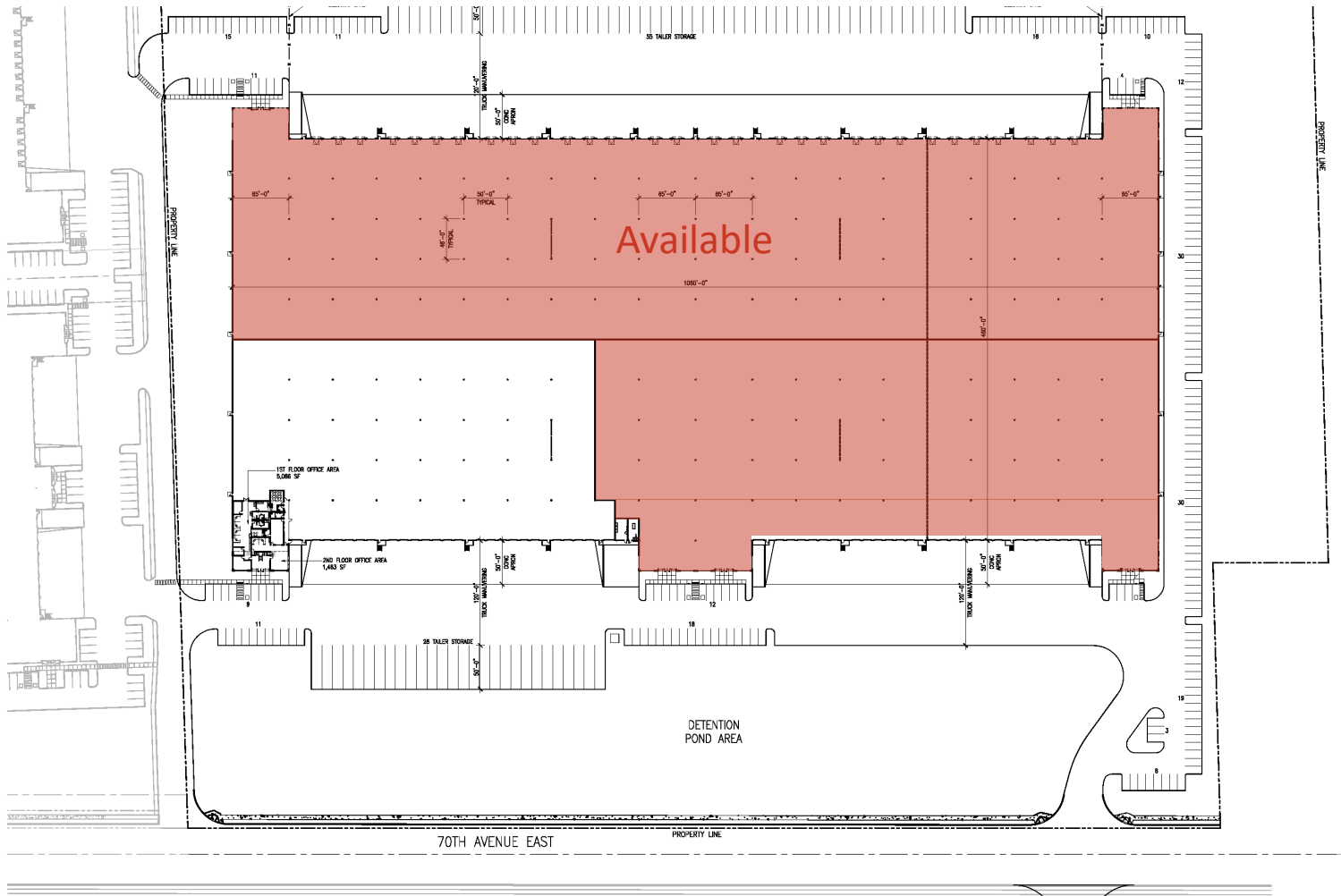

Pacific Coast Corporate Park is a Class A, double-loaded industrial building with proximity to the Port of Tacoma and convenient access to I-5 and SR-167. PCCP features abundant trailer parking, generous truck maneuvering and multiple access points.



CLARION PARTNERS

www.clarionpartners.com

For more information on this opportunity, please contact

CBRE

Andrew Stark

206.310.9044

andrew.stark@cbre.com

Andrew Hitchcock

206.790.2211

andrew.hitchcock@cbre.com

Zac Snedeker

425.444.0133

zac.snedeker@cbre.com