

For sublease

4,673 SF available
2400 Market Street
Philadelphia, PA 19103

- Rare office opportunity at 2400 Market St.
- Turn-key, thoughtfully designed space with high-end furniture and open ceilings
- Term thru: February 28, 2027



Suite highlights

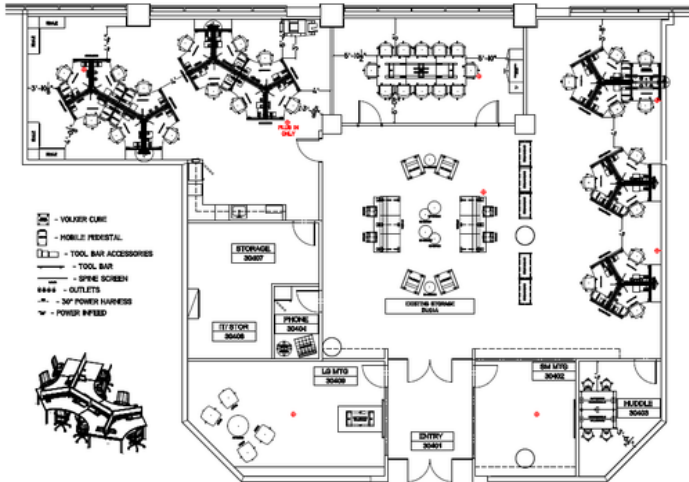

- 2 office/huddle rooms
- 1 12-person conference room
- 23 workstations
- Phone room
- Reception area w/ soft seating
- Kitchenette
- Large storage closet

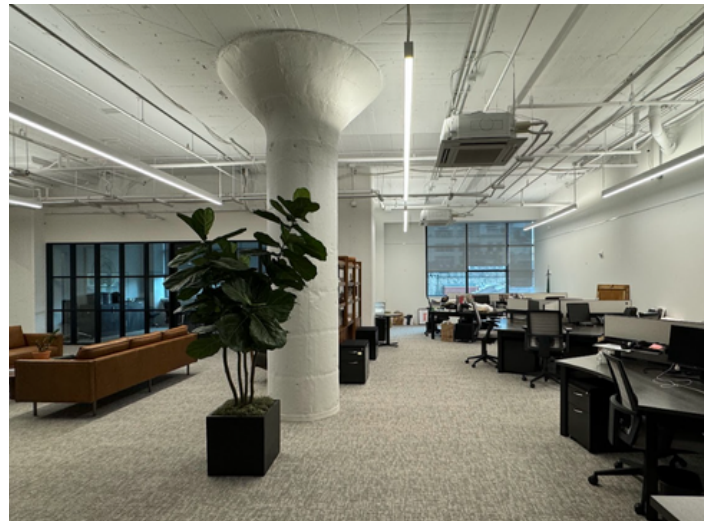



Join a trophy office building situated
between Philadelphia's central business
district and University City.



Walk Score

94



Transit Score

100



Bike Score

96

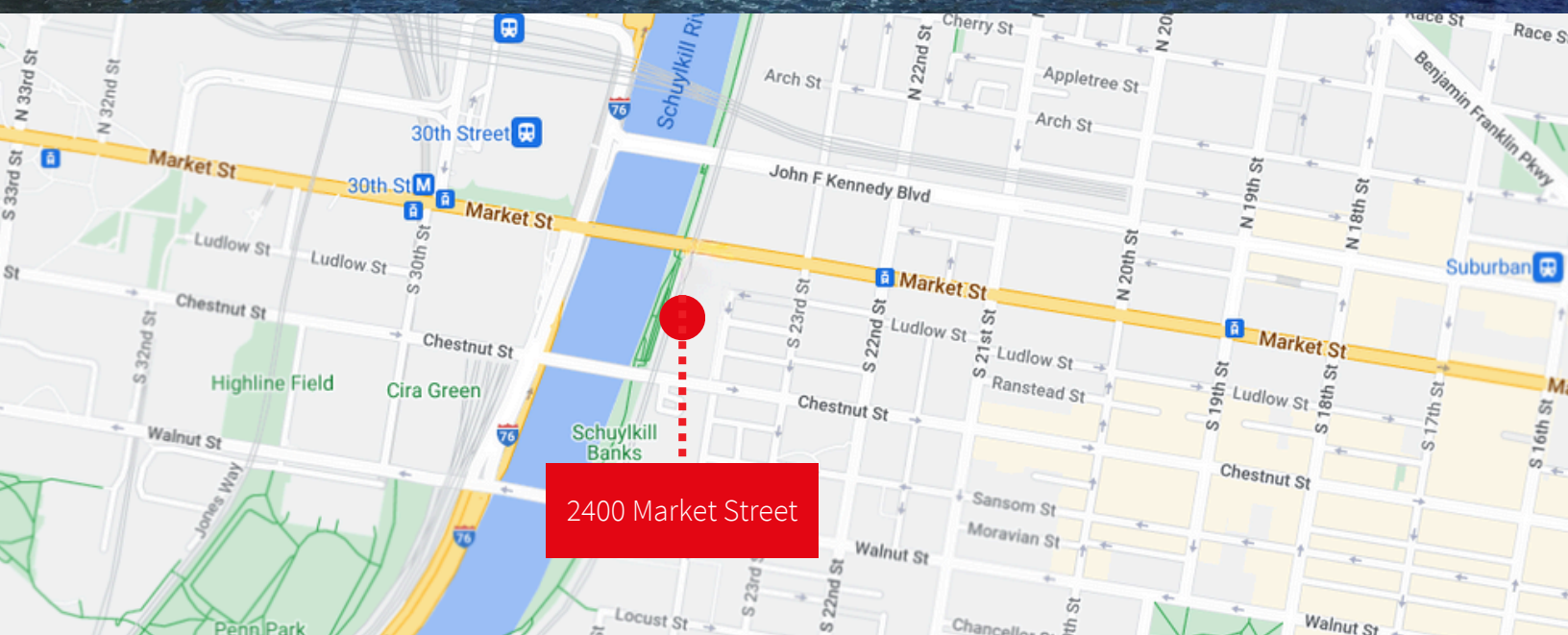

2400 Market Street

For more information, please contact:

Eric Berkowitz
Senior Associate
Eric.Berkowitz@jll.com
+1 610 416 2226

Alex Breitmayer
Managing Director
Alex.Breitmayer@jll.com
+1 267 303 6755

Jones Lang LaSalle Brokerage, Inc.
1700 Market St., Suite 2400
Philadelphia, PA 19103
T +1 215 988 5500

Although information has been obtained from sources deemed reliable, neither Owner nor JLL makes any guarantees, warranties or representations, express or implied, as to the completeness or accuracy as to the information contained herein. Any projections, opinions, assumptions or estimates used are for example only. There may be differences between projected and actual results, and those differences may be material. The Property may be withdrawn without notice. Neither Owner nor JLL accepts any liability for any loss or damage suffered by any party resulting from reliance on this information. If the recipient of this information has signed a confidentiality agreement regarding this matter, this information is subject to the terms of that agreement. ©2024. Jones Lang LaSalle IP, Inc. All rights reserved.