

FOR SALE | OFFICE CONDO



**2401 CONGRESS STREET
PORTLAND, ME 04102**

PROPERTY HIGHLIGHTS

- Opportunity for owner/user to purchase an office condo in prime business location.
- Immediately off of I-95 Exit 46, 1.4 miles to Portland International Jetport and 1.7 miles to The Maine Mall.
- Join businesses like Unum, BerryDunn, Apex Racket & Fitness, Dunkin' and many more.
- Excellent pylon and building signage with visibility on Congress Street.
- Ample on-site parking



**THE BOULOS
COMPANY**
COMMERCIAL REAL ESTATE

PROPERTY DETAILS

OWNER American National Red Cross

UNIT SIZE 5,661± SF

ASSESSOR'S REFERENCE 239A-A-4

BOOK/PAGE 20398/193

ZONING IM - Industrial Moderate

YEAR BUILT 1987

NO. OF STORIES One (1)

EXISTING LAYOUT Thirteen (13) private offices, kitchenette, conference room, private men's and women's restrooms and exterior conference room.

HEAT SOURCE Natural gas

UTILITIES Municipal water and sewer

PARKING Ample on-site

SALE PRICE Contact brokers

FOR SALE | OFFICE CONDO

2401 CONGRESS STREET, PORTLAND, ME 04102



FLOOR PLAN

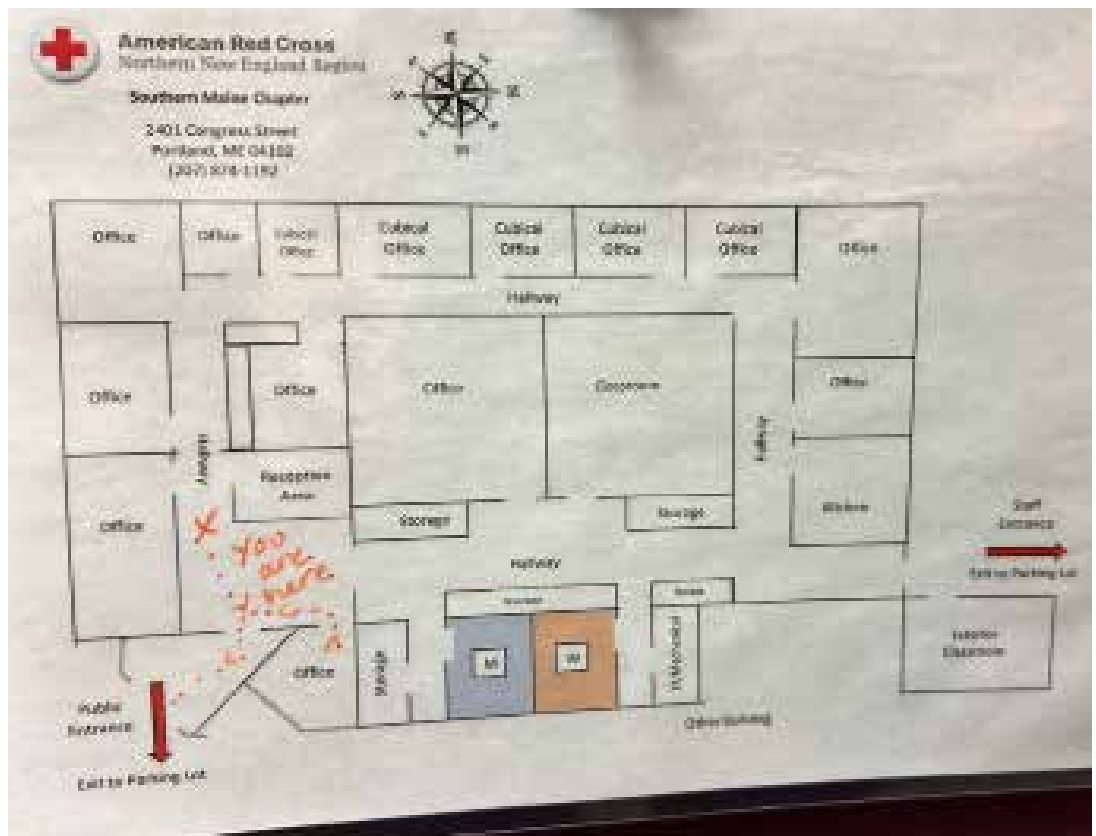

FOR SALE | OFFICE CONDO

2401 CONGRESS STREET, PORTLAND, ME 04102



CONTACT US



DEREK MILLER
Partner, Broker
+1 207.553.1721 D
+1 207.240.0032 C
dmiller@boulos.com



SASHA PHILLIPS
Associate Broker
+1 207.553.1733 D
+1 860.387.3408 C
sPhillips@boulos.com

©2024 The Boulos Company, Inc. All rights reserved. This information has been obtained from sources believed reliable, but has not been verified for accuracy or completeness. You should conduct a careful, independent investigation of the property and verify all information. Any reliance on this information is solely at your own risk. The Boulos Company and The Boulos Company logo are service marks of The Boulos Company, Inc. All other marks displayed on this document are the property of their respective owners. Photos herein are the property of their respective owners. Use of these images without the express written consent of the owner is prohibited.