



PatelGroup

FOR LEASE

508 NW Main St, Grain Valley, MO 64029

Fully Furnished Restaurant / Bar Location

- Total indoor Sq. Ft. - 2,843
- 2,600 Sq. Ft. of additional outdoor patio space
- Prime location
- Minutes away from I-70
- Great Investment or Owner Occupant Opportunity
- Nearby tenants include Grain Valley Historical Society,
- OG Body Art Co., and Bank of Grain Valley



For more information, contact:

Nilesh Patel | 816-309-7604 | patelgroup@kw.com



PatelGroup

Features

508 NW Main St, Grain Valley, MO 64029

- High-visibility location
- Adaptable interior layout
- Second floor entertainment space and outdoor patio allowing for multiple opportunities



kw PLATINUM PARTNERS
KELLERWILLIAMS. REALTY

For more information, contact:

Nilesh Patel | 816-309-7604 | patelgroup@kw.com



PatelGroup

Pictures

508 NW Main St, Grain Valley, MO 64029

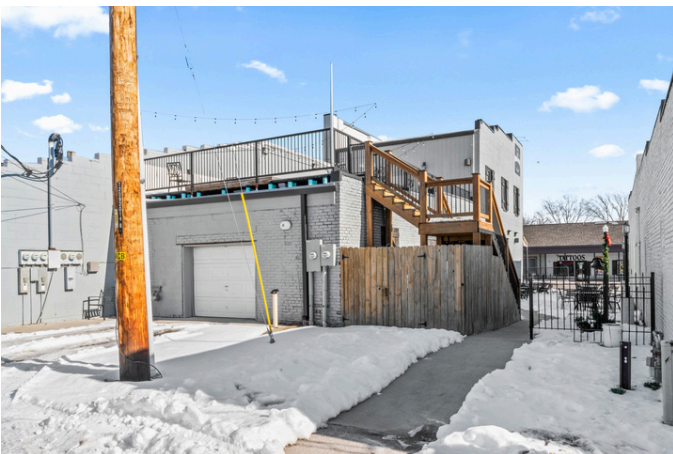

For more information, contact:
Nilesh Patel | 816-309-7604 | patelgroup@kw.com

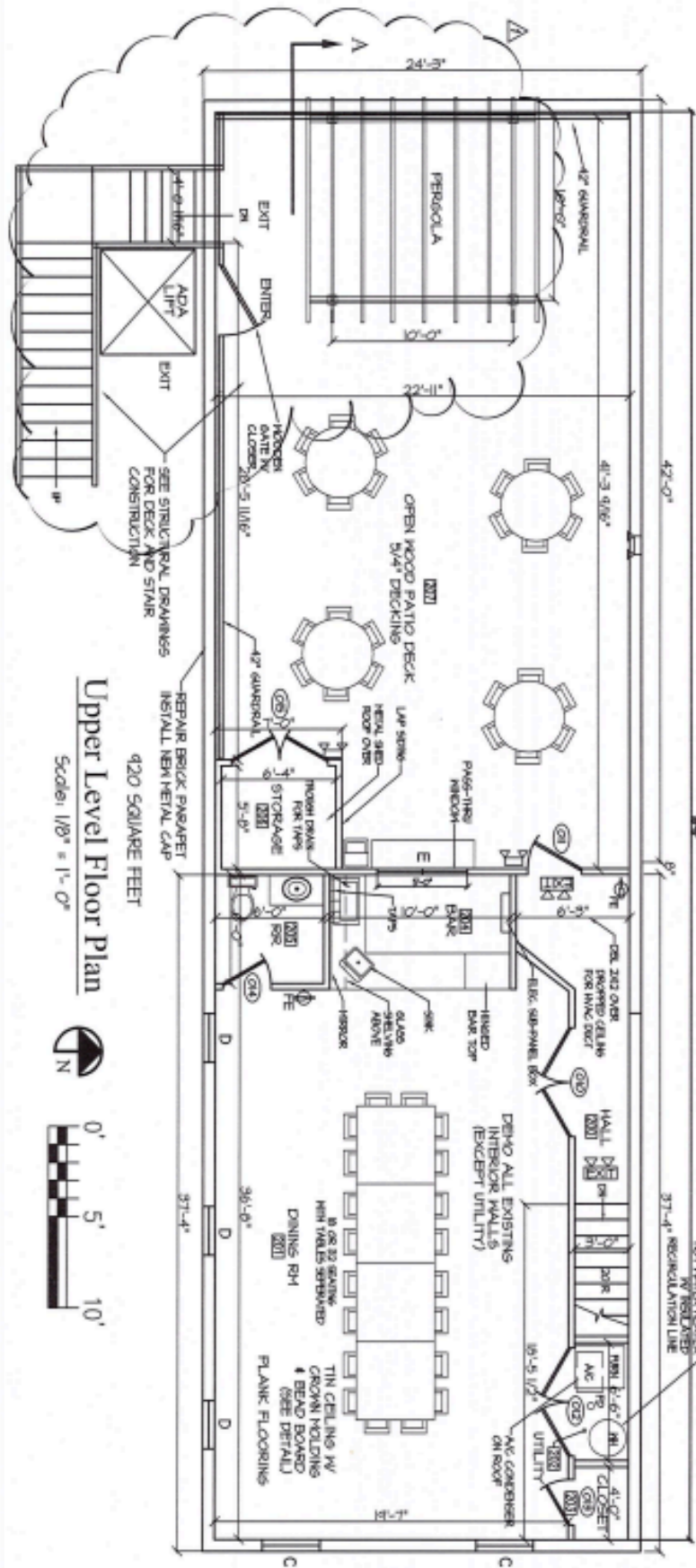

Upper Level Floor Plan
 Scale: 1/8" = 1'-0"



For more information, contact:
 Nilesh Patel | 816-309-7604 | patelgroup@kw.com



PatelGroup

Aerial View

508 NW Main St, Grain Valley, MO 64029

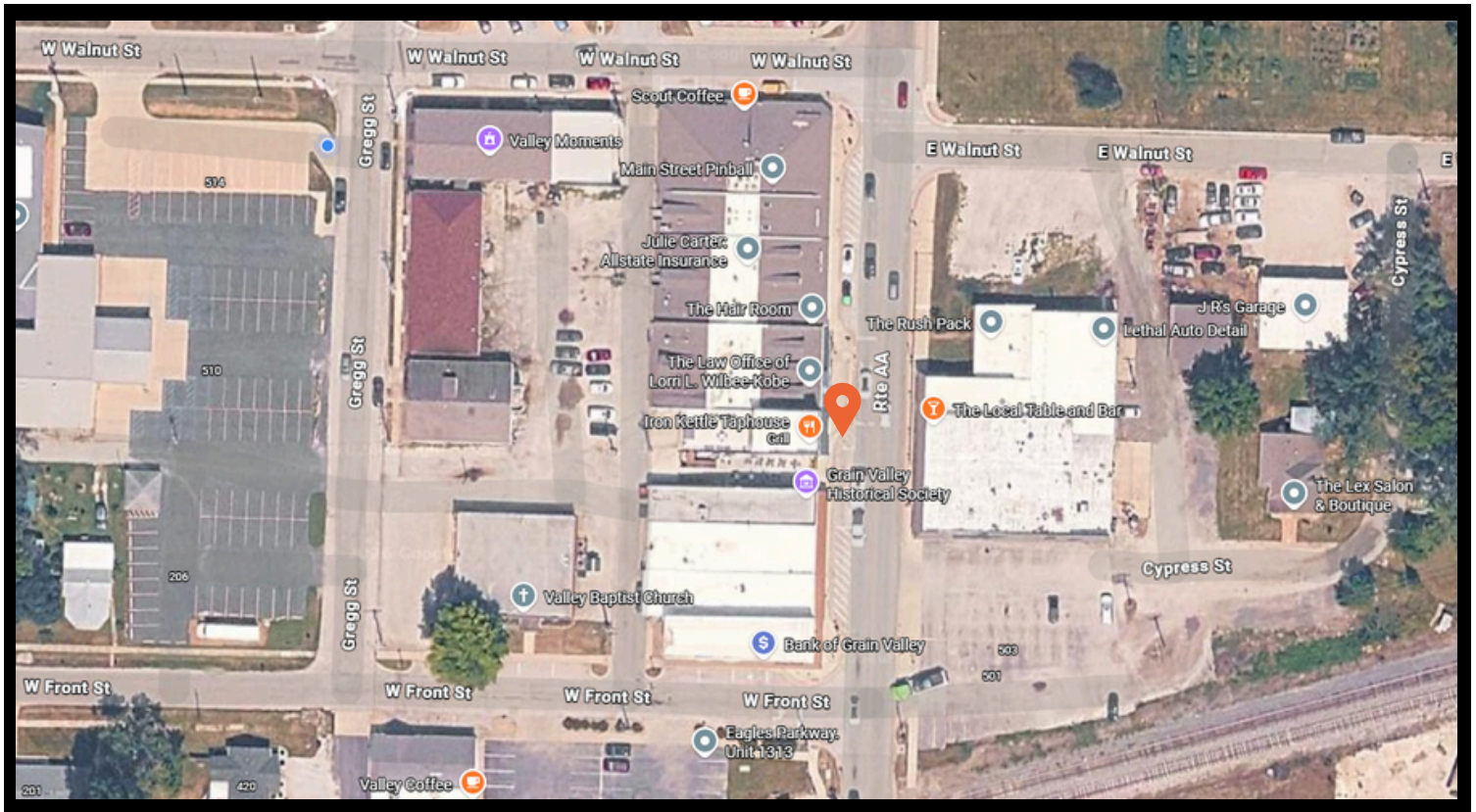

For more information, contact:
Nilesh Patel | 816-309-7604 | patelgroup@kw.com



PatelGroup

Demographics

508 NW Main St, Grain Valley, MO 64029

Demographics

† Margin of error is at least 10 percent of the total value. Take care with this statistic.

Age

35.8

Median age

a little less than the figure in the Kansas City, MO-KS Metro Area: 37.8
about 90 percent of the figure in Missouri: 38.9

Population by age range

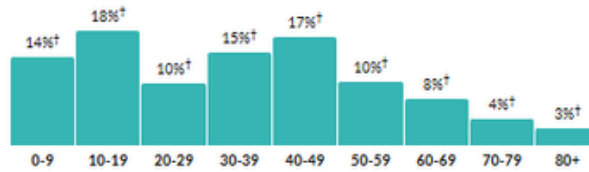

Show data / Embed

Population by age category

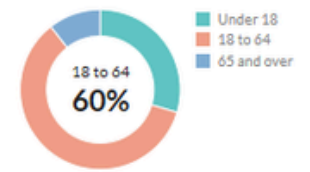

Show data / Embed

† Margin of error is at least 10 percent of the total value. Take care with this statistic.

Sex

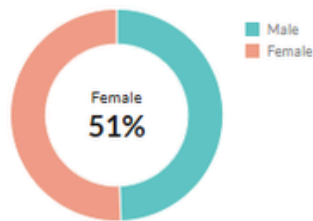

Show data / Embed

Race & Ethnicity



* Hispanic includes respondents of any race. Other categories are non-Hispanic.

Show data / Embed

Economics

† Margin of error is at least 10 percent of the total value. Take care with this statistic.

Income

\$38,038

Per capita income

about 90 percent of the amount in the Kansas City, MO-KS Metro Area: \$44,205
about the same as the amount in Missouri: \$38,497

\$87,266

Median household income

about 10 percent higher than the amount in the Kansas City, MO-KS Metro Area: \$81,927
about 25 percent higher than the amount in Missouri: \$68,920

Household income

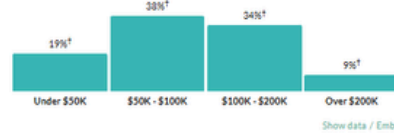

Show data / Embed

† Margin of error is at least 10 percent of the total value. Take care with this statistic.

Poverty

6.3%

Persons below poverty line

about three-fifths of the rate in the Kansas City, MO-KS Metro Area: 10%
about half the rate in Missouri: 12.6%

Children (Under 18)

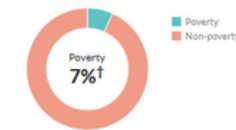

Show data / Embed

Seniors (65 and over)

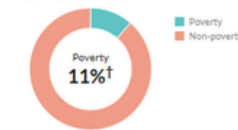

Show data / Embed

† Margin of error is at least 10 percent of the total value. Take care with this statistic.

Transportation to work

25.2 minutes

Mean travel time to work

about 10 percent higher than the figure in the Kansas City, MO-KS Metro Area: 23.3
about 10 percent higher than the figure in Missouri: 23.7

Means of transportation to work

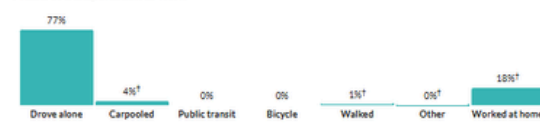

* Universe: Workers 16 years and over

Show data / Embed

For more information, contact:

Nilesh Patel | 816-309-7604 | patelgroup@kw.com

