



Philadelphia Two Liberty Place

PRODUCTS | SUITES | OFFICES | ACCESS | VIRTUAL

50 South 16th Street, Suite 1700
Philadelphia, PA 19102

This office is in the center of it all. The newly-renovated building features a conference center and an on-site gym. Enjoy direct access to The Shops at Liberty Place, the Westin Hotel, and condo living.

55K

Rentable Sqft

15

Conference Rooms

142

Offices



INCLUDED SERVICES

Dedicated On-Site Staff	Wellness Room
Daily Breakfast & Snacks	Unlimited Color Printing
Craft Coffee & Tea	Fast, Secure Wi-Fi
Mail & Packaging	Office Supplies
Community Events	Professional-Grade Cleaning
Weekly Happy Hours	24/7 Access

BUILDING DETAILS

Renovated Lobby	Laundry Service
Dining Options	Event Space
Retail Options	Concierge Services
Fitness Center	24/7 Security
Conference Center	Service Animals Only
Westin Hotel	

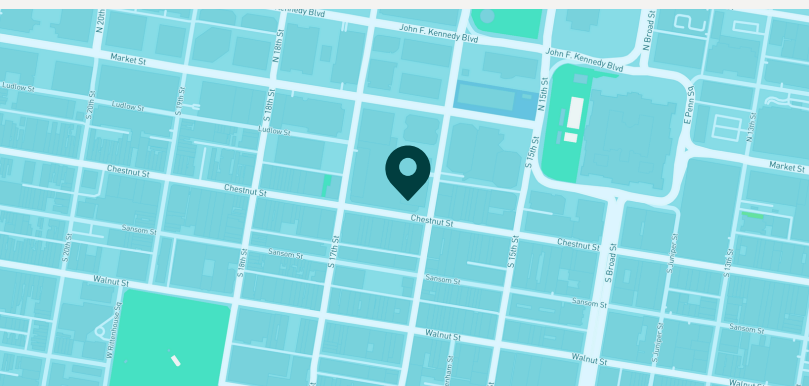

TRANSIT

SEPTA to 30th Street	1.3 miles
Chestnut St & 16th St	1 block
Indego bike station	0.3 miles
Philadelphia International Airport	9.9 miles
Parking (See back for details)	Nearby

LEGEND

- Access Office
- Small Office (1-2)
- Medium Office (3-4)
- Large Office (5-8)
- XLarge Office (9+)
- Executive Office

MEETING SPACES

Phone Booths	16
Focus Rooms	2
Conference Rooms	15

PARKING INFO

No allotted parking spaces, but garage onsite under the building via Parkway Liberty Place garage:

- Located at 44 S 16th Street
- 24/7 access
- Early Bird: \$30 - Mon-Fri - In after 5:00 AM, before 9:00 AM - Out after 3:00 PM, before 7:00 PM
- 1hr - \$20
- 12hrs - \$44
- 24hrs - \$50

17TH FLOOR

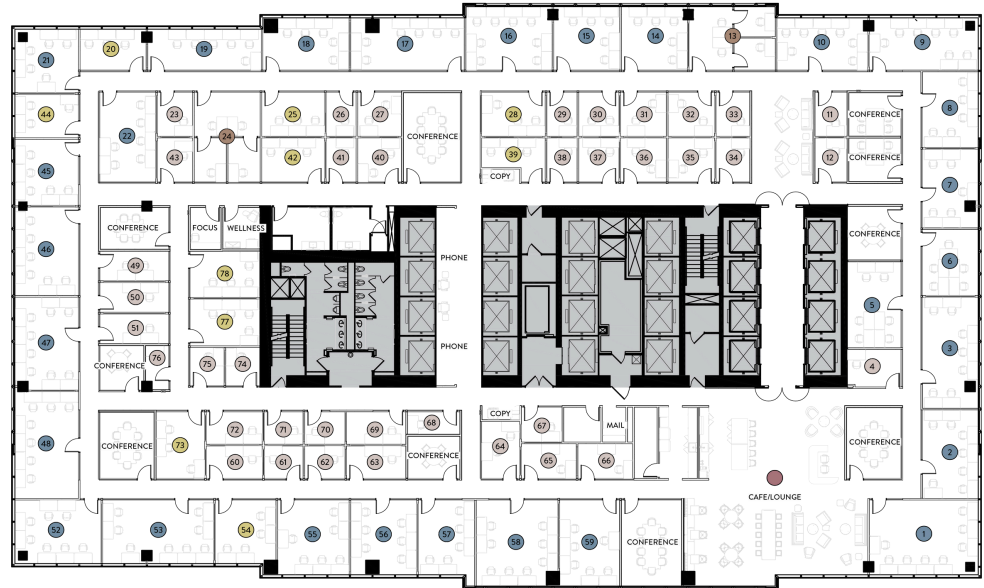

18TH FLOOR

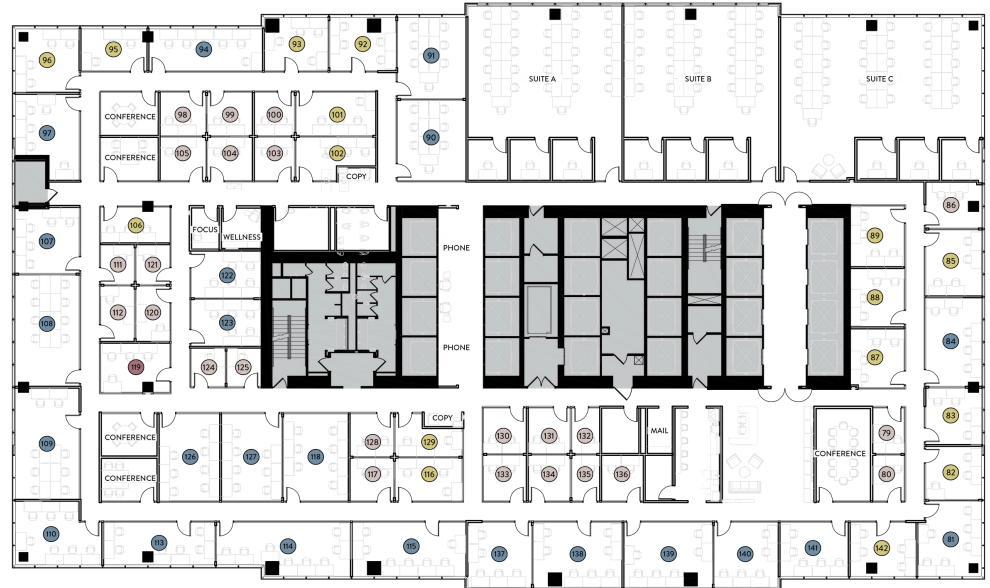

Cafe



Private office



Conference room