

203 SUTTER AVENUE

CORNER OF SUTTER AVENUE & THOMAS S. BOYLAND STREET | BROWNSVILLE



AVAILABLE

LEASED

AVAILABLE



203 SUTTER AVENUE

CORNER OF SUTTER AVENUE & THOMAS S. BOYLAND STREET | BROWNSVILLE

PROPERTY DETAILS

SIZE:: 4,970 SF Ground Floor

FRONTAGE: 48'

CEILING HEIGHT: 13'

POSSESSION: Arranged

TRANSPORTATION: B7, B12, B14, 3, L

HIGHLIGHTS

- All uses considered
- New development
- High foot traffic area in dense residential neighborhood
- Neighboring tenants include:
C-Town Supermarket, McDonald's, VIM, Taco Bell, USPS, Planet Fitness, Dollar Tree, Brownsville Public Library

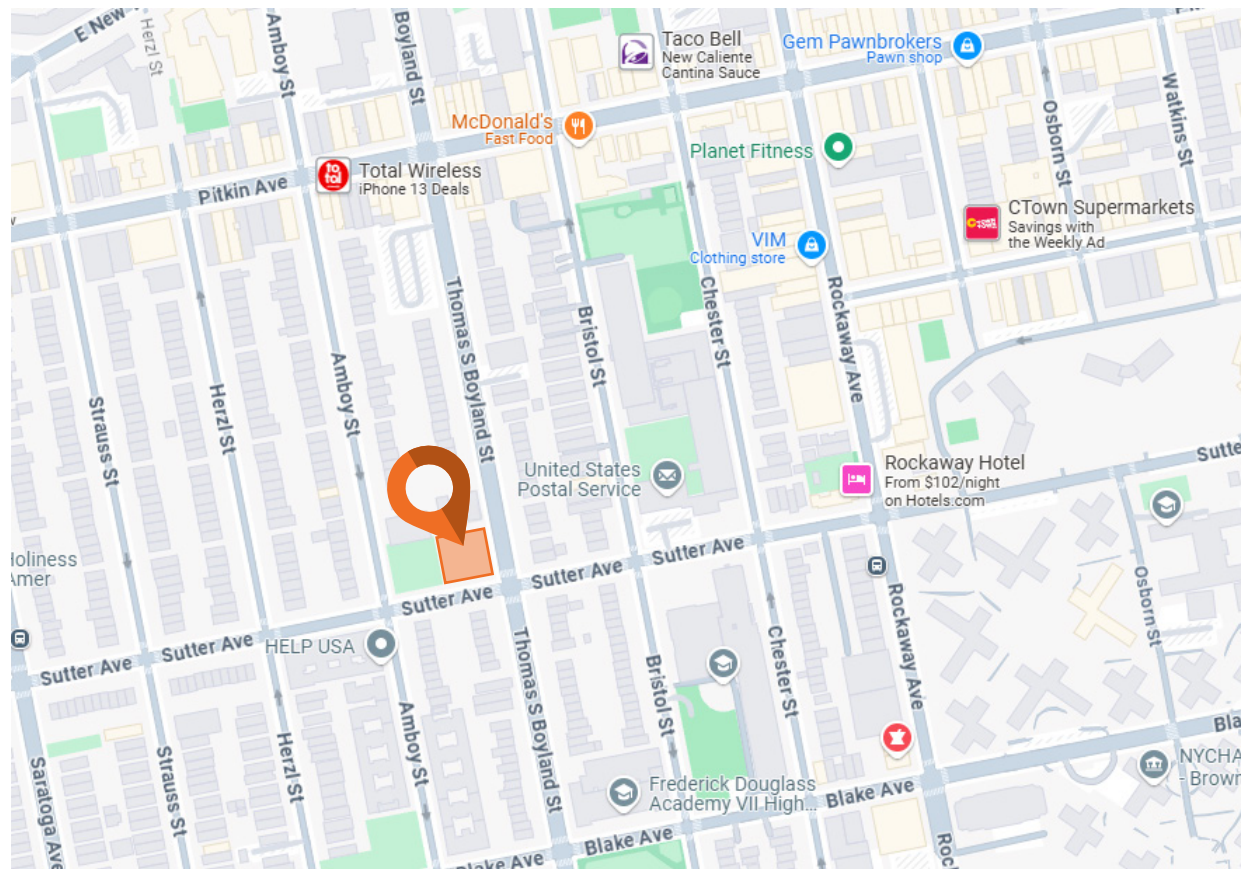

203 SUTTER AVENUE

CORNER OF SUTTER AVENUE & THOMAS S. BOYLAND STREET | BROWNSVILLE

FLOOR PLANS: GROUND FLOOR



203 SUTTER AVENUE

CORNER OF SUTTER AVENUE & THOMAS S. BOYLAND STREET | BROWNSVILLE

FLOOR PLANS:

GROUND FLOOR (DIVISION SCENARIO)

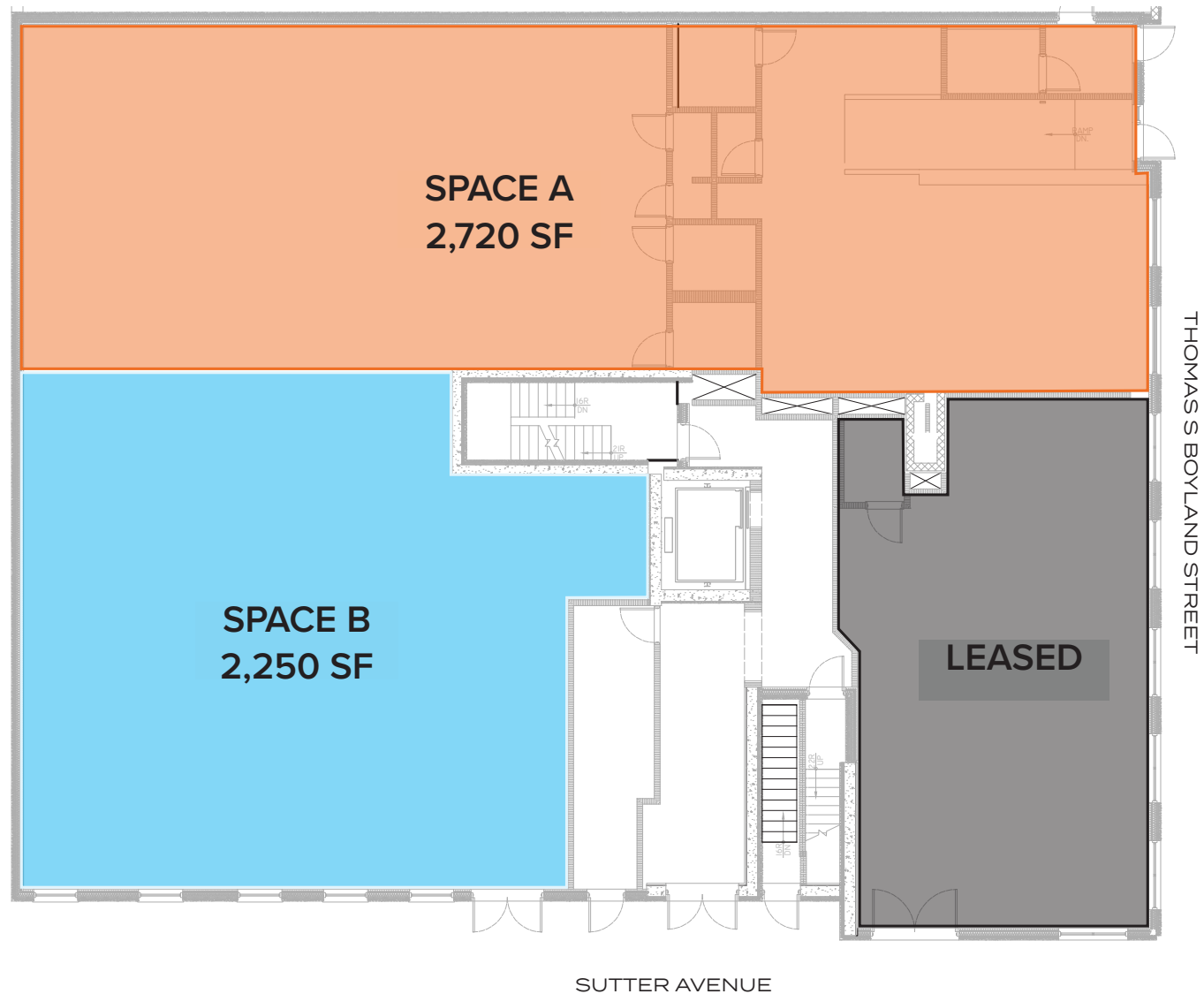

203 SUTTER AVENUE

CORNER OF SUTTER AVENUE & THOMAS S. BOYLAND STREET | BROWNSVILLE

FOR MORE INFORMATION,
PLEASE CONTACT:

ELI YADID

917.770.9173 | EYadid@ksrny.com

JORDAN SOLEIMANI

516.732.3697 | JSoleimani@ksrny.com



All information supplied in this marketing presentation and/or flyer is from sources deemed reliable and is furnished subject to errors, omissions, modifications, removal of listings from sale/lease and to any listing condition. Any square footage, dimensions, floor plans and/or technical data set forth are approximations and are subject to further elaboration/confirmation.