

LEGEND

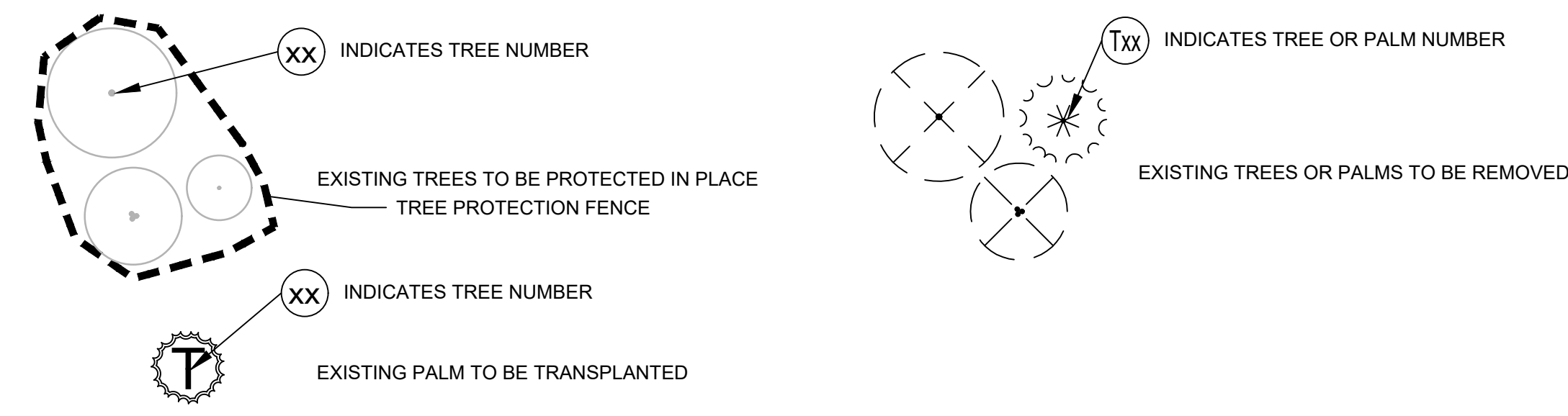

SEE SHEET L0.01 FOR
TREE INVENTORY TABLE

SEE SHEET L0.01 FOR TREE
PROTECTION DETAILS

Scale 1" = 30'

EVERGREEN
DESIGN GROUP
(800) 680-6630
2255 Glades Road, Suite 224A
Boca Raton, FL 33431
www.EvergreenDesignGroup.com
LC #26000612

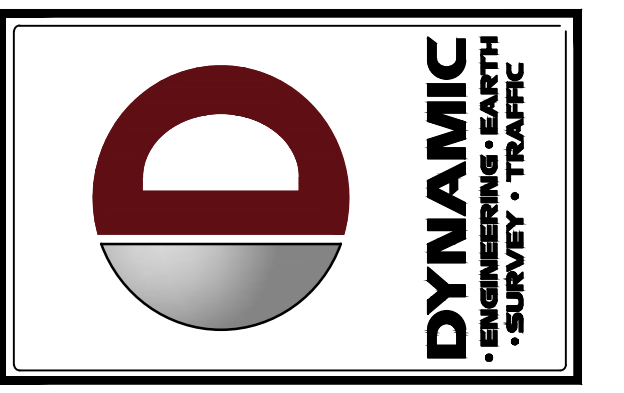

REV	DATE	COMMENTS
3	07/29/20	AGENCY COMMENTS
2	07/15/20	AGENCY COMMENTS
1	06/07/20	AGENCY COMMENTS

PROJECT: **PALM BEACH CHRISTIAN MINISTRIES, INC.**
PALM BEACH CHRISTIAN MINISTRIES, INC.
TRACT 7
S. HAVERHILL ROAD & NAUTICA ISLES BOULEVARD
CITY OF GREENACRES
PALM BEACH COUNTY, FLORIDA 33463

DYNAMIC ENGINEERING
LAND DEVELOPMENT CONSULTING • PERMITTING
GEO TECHNICAL • ENVIRONMENTAL
TRAFFIC • SURVEY • PLANNING & ZONING
100 NE 5th Avenue, Suite B2
Delray Beach, FL 33483
T: 561.921.8570
Offices conveniently located at:
Lakeland, FL • 1.752.974.0199
Coral Gables, FL • 1.752.974.0199
Newport News, VA • 1.973.755.2200
Tampa Bay, FL • 1.752.974.0199
Hollywood, FL • 1.752.974.0199
Aventura, FL • 1.920.344.1700
Miami Beach, FL • 1.305.399.4400
Jupiter Inlet, FL • 1.920.446.2646
Delray Beach, FL • 1.561.921.8570
Florida Certificate of Authorization No. 32535
www.dynamicce.com

Kenneth
D Bates
LA66667
0
2020.09.03
7 16:54:42
-06'00'
STATE OF FLORIDA
Professional Engineer
No. 6666710
Exp. 09/03/2024

811 PROTECT YOURSELF
ALL STATES REQUIRE NOTIFICATION OF
EXCAVATORS, DESIGNERS, OR ANY PERSON
PREPARING TO DISTURB THE EARTH'S
SURFACE, AHEAD OF ANY DIG.
FOR STATE SPECIFIC DIRECT PHONE NUMBERS VISIT:
WWW.CALL811.COM

TITLE:
**TREE DISPOSITION
PLAN**

SCALE: (H) DATE: 03/26/2020
(V)
PROJECT No: 3346-99-001

SHEET No: **L0.00** Rev. #:

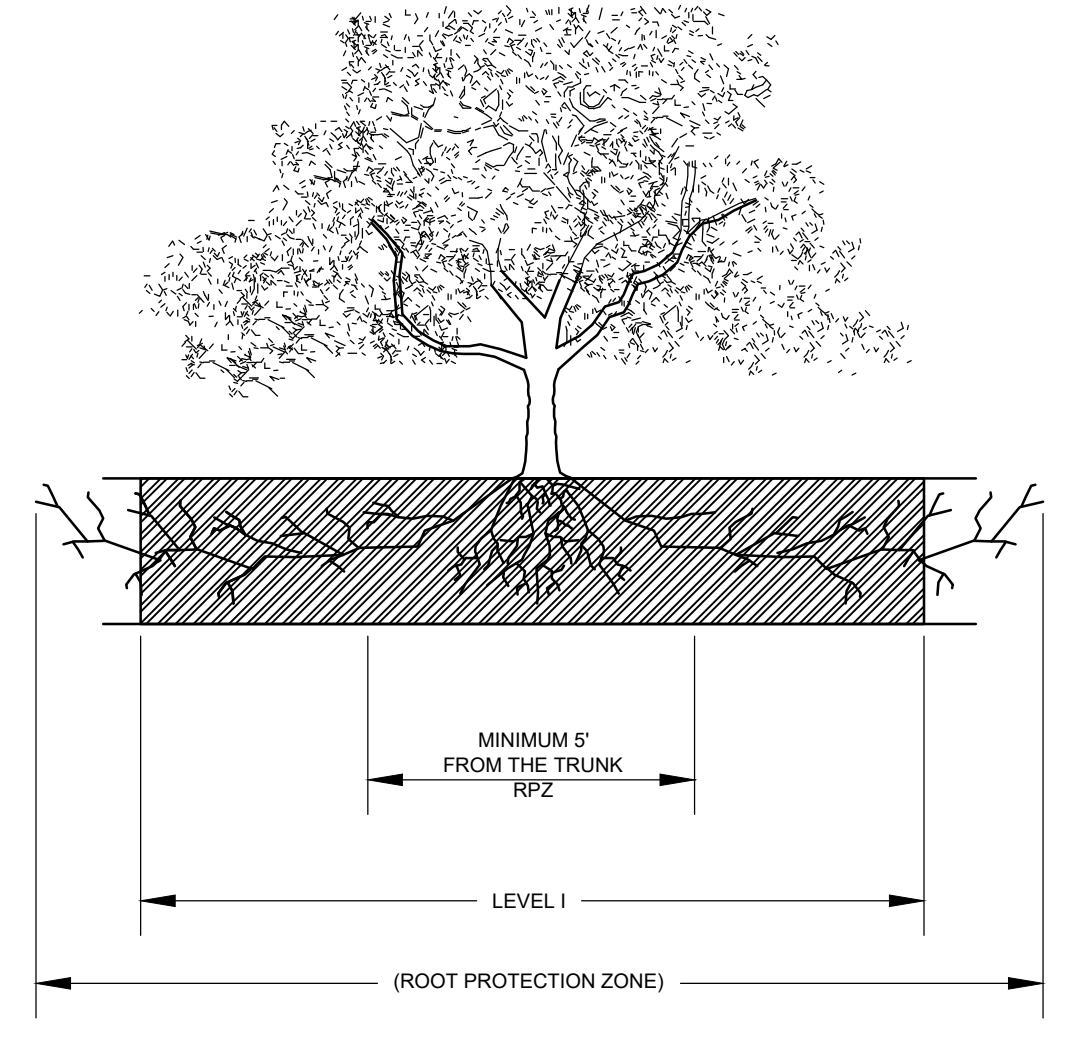

A TREE PROTECTION FENCE - ELEVATION
SCALE: NOT TO SCALE

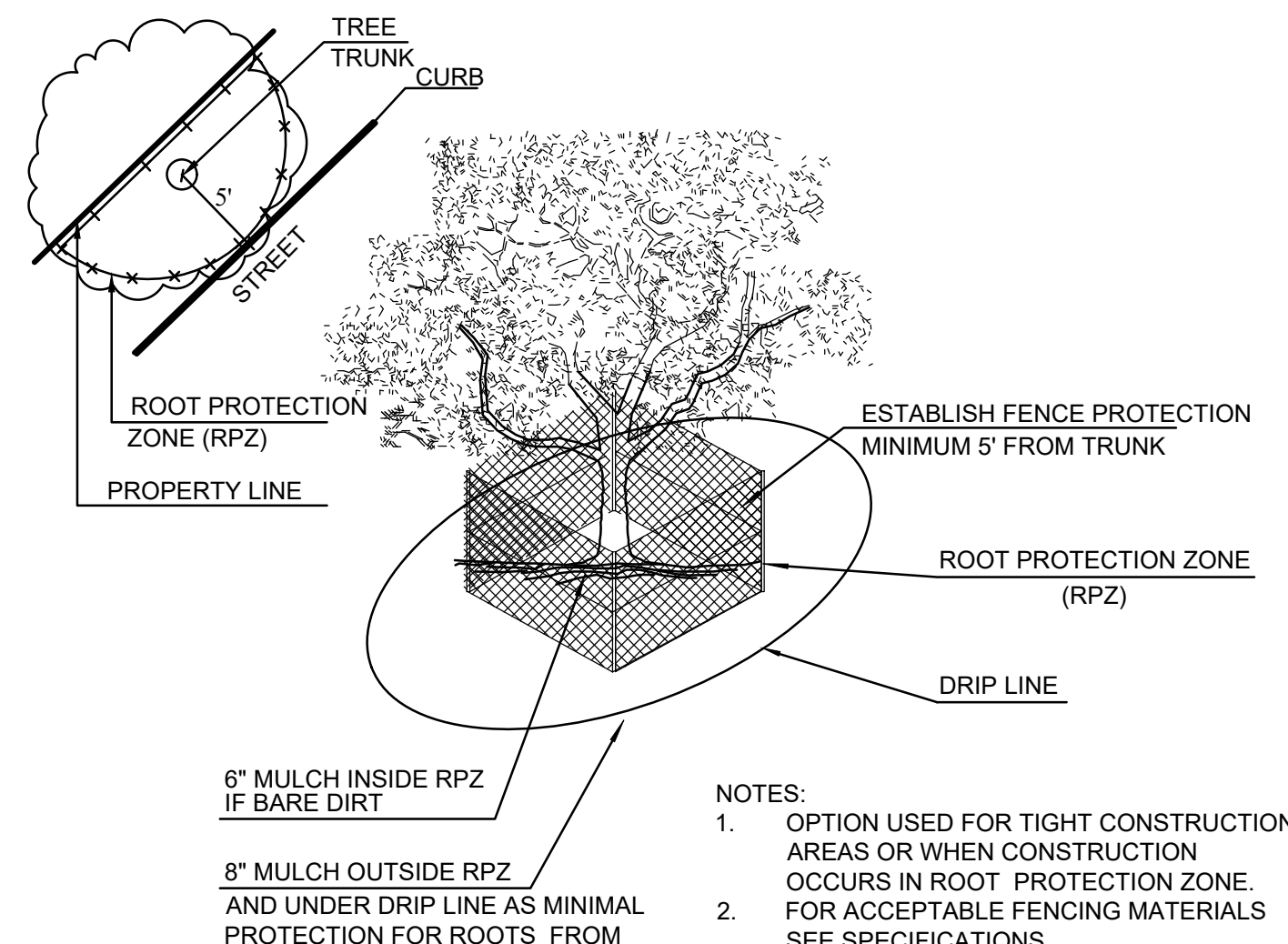

C TREE PROTECTION FENCE - LEVEL 2
SCALE: NOT TO SCALE

TREES THAT ARE MARKED TO BE PRESERVED ON A SITE PLAN AND FOR WHICH UTILITIES MUST PASS THROUGH THEIR ROOT PROTECTION ZONES MAY REQUIRE TUNNELING AS OPPOSED TO OPEN TRENCHES. THE DECISION TO TUNNEL WILL BE DETERMINED ON A CASE BY CASE BASIS BY THE ENGINEER.

TUNNELS SHALL BE DUG THROUGH THE ROOT PROTECTION ZONE IN ORDER TO MINIMIZE ROOT DAMAGE.

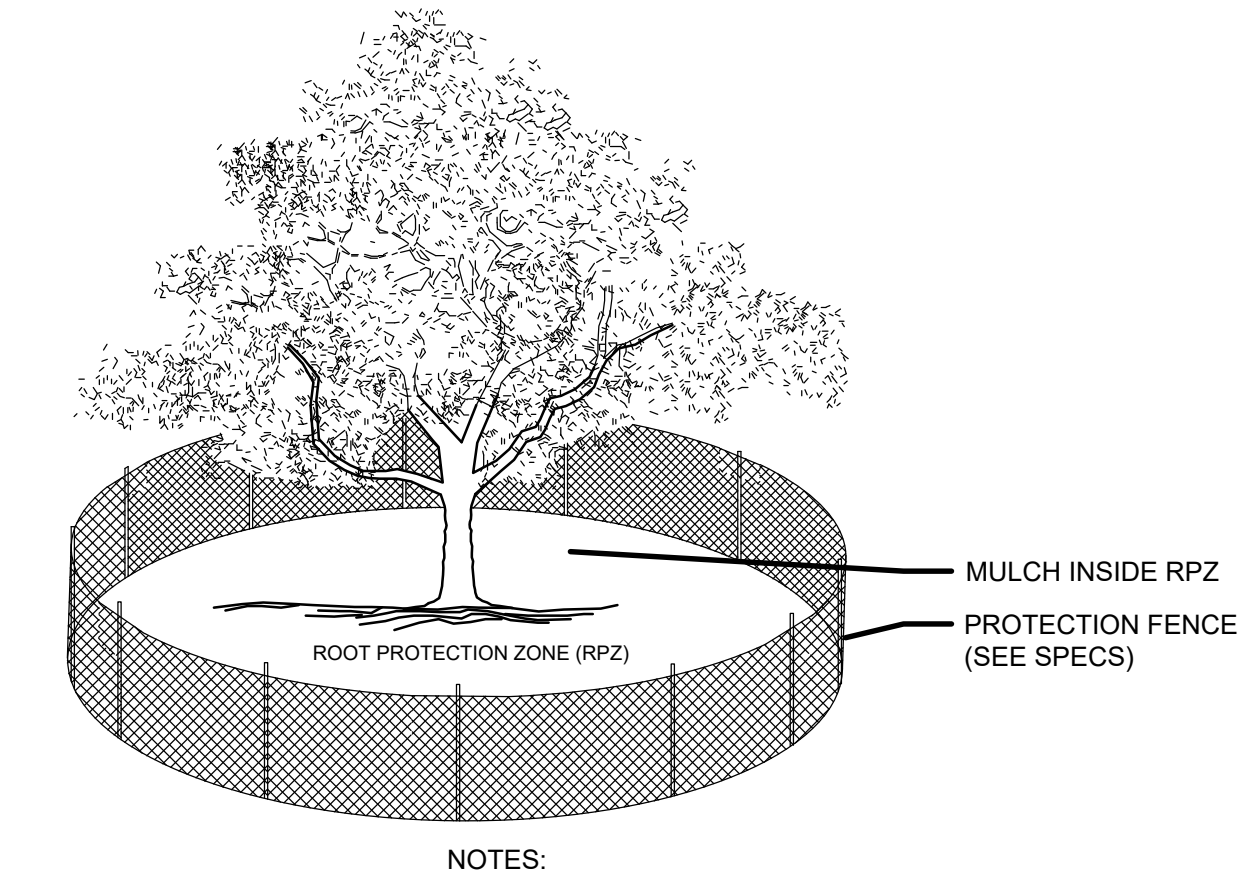

B TREE PROTECTION FENCE
SCALE: NOT TO SCALE

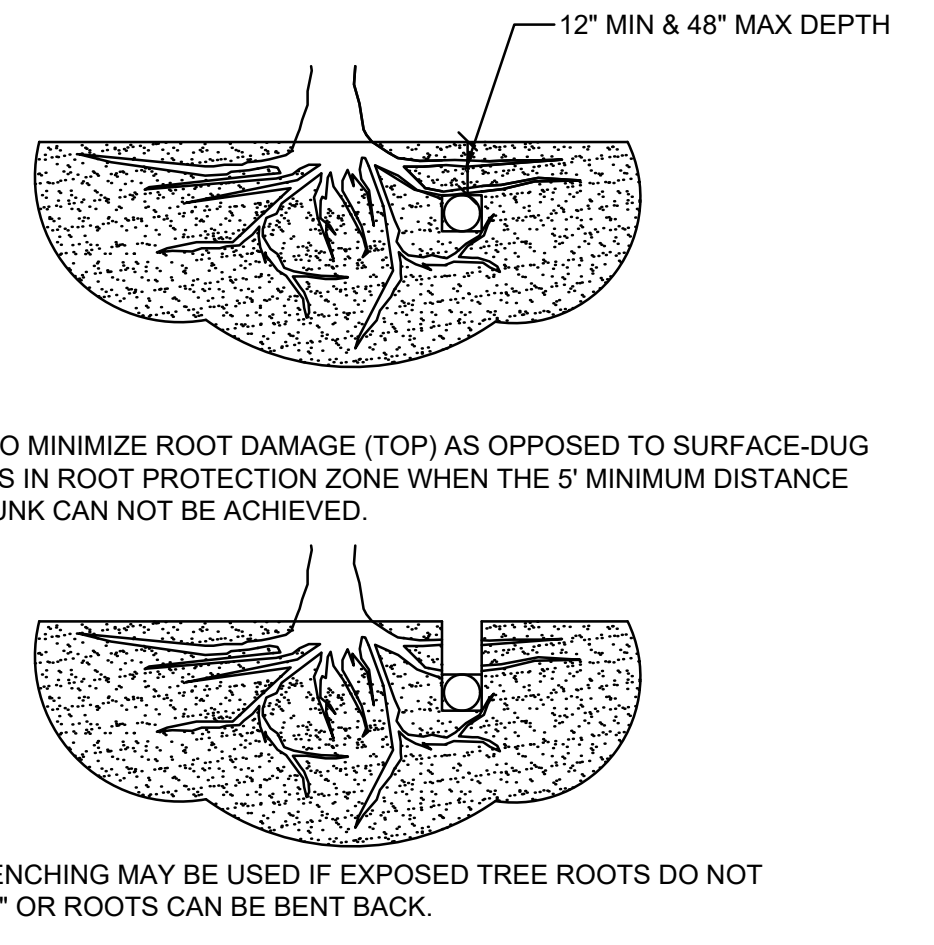

D BORING THROUGH ROOT PROTECTION ZONE
SCALE: NOT TO SCALE

TREE PROTECTION SPECIFICATIONS

- MATERIALS**
- FABRIC: 4 FOOT HIGH ORANGE PLASTIC FENCING AS SHOWN ON THE PLANS AND SHALL BE WOVEN WITH 2 INCH MESH OPENINGS SUCH THAT IN A VERTICAL DIMENSION OF 23 INCHES ALONG THE DIAGONALS OF THE OPENINGS THERE SHALL BE AT LEAST 7 MESHES.
 - POSTS: POSTS SHALL BE A MINIMUM OF 72 INCHES LONG AND STEEL "T" SHAPED WITH A MINIMUM WEIGHT OF 13 POUNDS PER LINEAR FOOT.
 - TIE WIRE: WIRE FOR ATTACHING THE FABRIC TO THE T-POSTS SHALL BE NOT LESS THAN NO. 12 GAUGE GALVANIZED WIRE.
 - USED MATERIALS: PREVIOUSLY-USED MATERIALS, MEETING THE ABOVE REQUIREMENTS AND WHEN APPROVED BY THE OWNER, MAY BE USED.
- CONSTRUCTION METHODS**
- ALL TREES AND SHRUBS SHOWN TO REMAIN WITHIN THE PROXIMITY OF THE CONSTRUCTION SITE SHALL BE PROTECTED PRIOR TO BEGINNING ANY DEVELOPMENT ACTIVITY.
 - EMPLOY THE SERVICES OF AN ISA (INTERNATIONAL SOCIETY OF ARBORICULTURE) CERTIFIED ARBORIST AND OBTAIN ALL REQUIRED PERMITS TO PRUNE THE EXISTING TREES FOR CLEANING, RAISING AND THINNING, AS MAY BE REQUIRED.
 - PROTECTIVE FENCING SHALL BE ERECTED OUTSIDE THE CRITICAL ROOT ZONE (CRZ, EQUAL TO 1' FROM THE TRUNK FOR EVERY 1" OF DBH) AT LOCATIONS SHOWN IN THE PLANS OR AS DIRECTED BY THE LANDSCAPE CONSULTANT AND/OR CITY ARBORIST, AND IN ACCORDANCE WITH THE DETAILS SHOWN ON THE PLANS. FENCING SHALL BE MAINTAINED AND REPAIRED BY THE CONTRACTOR DURING SITE CONSTRUCTION. TREES IN CLOSE PROXIMITY SHALL BE FENCED TOGETHER, RATHER THAN INDIVIDUALLY.
 - PROTECTIVE FENCE LOCATIONS IN CLOSE PROXIMITY TO STREET INTERSECTIONS OR DRIVES SHALL ADHERE TO THE APPLICABLE JURISDICTION'S SIGHT DISTANCE CRITERIA.
 - THE PROTECTIVE FENCING SHALL BE ERECTED BEFORE SITE WORK COMMENCES AND SHALL REMAIN IN PLACE DURING THE ENTIRE CONSTRUCTION PHASE.
 - THE INSTALLATION POSTS SHALL BE PLACED EVERY 6 FEET ON CENTER AND EMBEDDED TO 18 INCHES DEEP. MESH FABRIC SHALL BE ATTACHED TO THE INSTALLATION POSTS BY THE USE OF SUFFICIENT WIRE TIES TO SECURELY FASTEN THE FABRIC TO THE T-POSTS TO HOLD THE FABRIC IN A STABLE AND UPRIGHT POSITION.

- WITHIN THE CRZ:
 - DO NOT CLEAR, FILL OR GRADE IN THE CRZ OF ANY TREE.
 - DO NOT STORE, STOCKPILE OR DUMP ANY JOB MATERIAL, SOIL OR RUBBISH UNDER THE SPREAD OF THE TREE BRANCHES.
 - DO NOT PARK OR STORE ANY EQUIPMENT OR SUPPLIES UNDER THE TREE CANOPY.
 - DO NOT SET UP ANY CONSTRUCTION OPERATIONS UNDER THE TREE CANOPY (SUCH AS PIPE CUTTING AND THREADING, MORTAR MIXING, PAINTING OR LUMBER CUTTING).
 - DO NOT NAIL OR ATTACH TEMPORARY SIGNS, METERS, SWITCHES, WIRES, BRACING OR ANY OTHER ITEM TO THE TREES.
 - DO NOT PERMIT RUNOFF FROM WASTE MATERIALS INCLUDING SOLVENTS, CONCRETE WASHOUTS, ASPHALT TACK COATS (MC-30 OIL), ETC., TO ENTER THE CRZ. BARRIERS ARE TO BE PROVIDED TO PREVENT SUCH RUNOFF SUBSTANCES FROM ENTERING THE CRZ WHENEVER POSSIBLE, INCLUDING IN AN AREA WHERE RAIN OR SURFACE WATER COULD CARRY SUCH MATERIALS TO THE ROOT SYSTEM OF THE TREE.
- ROUTE UNDERGROUND UTILITIES TO AVOID THE CRZ. IF DIGGING IS UNAVOIDABLE, BORE UNDER THE ROOTS, OR HAND DIG TO AVOID SEVERING THEM.
- WHERE EXCAVATION IN THE VICINITY OF TREES MUST OCCUR, SUCH AS FOR IRRIGATION INSTALLATION, PROCEED WITH CAUTION, AND USING HAND TOOLS ONLY.
- THE CONTRACTOR SHALL NOT CUT ROOTS LARGER THAN ONE INCH IN DIAMETER WHEN EXCAVATION OCCURS NEAR EXISTING TREES. ALL ROOTS LARGER THAN ONE INCH IN DIAMETER ARE TO BE CUT CLEANLY, FOR OAKS ONLY, ALL WOUNDS SHALL BE PAINTED WITH WOUND SEALER WITHIN 30 MINUTES.
- REMOVE ALL TREES, SHRUBS OR BUSHES TO BE CLEARED FROM PROTECTED ROOT ZONE AREAS BY HAND.
- TREES DAMAGED OR KILLED DUE TO CONTRACTOR'S NEGLIGENCE DURING CONSTRUCTION SHALL BE MITIGATED AT THE CONTRACTOR'S EXPENSE AND TO THE PROJECT OWNER'S AND LOCAL JURISDICTION'S SATISFACTION.
- ANY TREE REMOVAL SHALL BE APPROVED BY THE OWNER AND LOCAL JURISDICTION PRIOR TO ITS REMOVAL, AND THE CONTRACTOR SHALL HAVE ALL REQUIRED PERMITS FOR SUCH ACTIVITIES.
- COVER EXPOSED ROOTS AT THE END OF EACH DAY WITH SOIL, MULCH OR WET BURLAP.
- IN CRITICAL ROOT ZONE AREAS THAT CANNOT BE PROTECTED DURING CONSTRUCTION AND WHERE HEAVY TRAFFIC IS ANTICIPATED, COVER THE SOIL WITH EIGHT INCHES OF ORGANIC MULCH TO MINIMIZE SOIL COMPACTION. THIS EIGHT INCH DEPTH OF MULCH SHALL BE MAINTAINED THROUGHOUT CONSTRUCTION.
- WATER ALL TREES IMPACTED BY CONSTRUCTION ACTIVITIES, DEEPLY ONCE A WEEK DURING PERIODS OF HOT DRY WEATHER. SPRAY TREE CROWNS WITH WATER PERIODICALLY TO REDUCE DUST ACCUMULATION ON THE LEAVES.
- WHEN INSTALLING CONCRETE ADJACENT TO THE ROOT ZONE OF A TREE, USE A PLASTIC VAPOR BARRIER BEHIND THE CONCRETE TO PROHIBIT LEACHING OF LIME INTO THE SOIL.
- CONTRACTOR SHALL REMOVE AND DISPOSE OF ALL TREE PROTECTION FENCING WHEN ALL THREATS TO THE EXISTING TREES FROM CONSTRUCTION-RELATED ACTIVITIES HAVE BEEN REMOVED.

TREE INVENTORY (10" DBH AND GREATER)

TREE NO.	COMMON NAME	DBH (in inches)	DISPOSITION	CREDIT (No. of Trees)
1001	PINE	14	REMOVE	
1002	PINE	11	REMOVE	
1003	PINE	16	REMOVE	
1004	PINE	10	REMOVE	
1005	PINE	13	REMOVE	
1006	PINE	12	REMOVE	
1007	PINE	16	REMOVE	
1008	PINE	11	REMOVE	
1009	PINE	5	REMOVE	
1010	PINE	7	REMOVE	
1011	PINE	13	REMOVE	
1012	PINE	14	REMOVE	
1013	PINE	12	REMOVE	
1014	PINE	17	REMOVE	
1015	PINE	18	REMOVE	
1016	PINE	20	REMOVE	
1017	QUEEN PALM	13' HT	REMOVE	
1018	QUEEN PALM	10' HT	REMOVE	
1019	PINE	18	REMOVE	
1020	QUEEN PALM	10' HT	REMOVE	
1021	QUEEN PALM	8' HT	REMOVE	
1022	PINE	14	REMOVE	
1023	PINE	9	REMOVE	
1024	PINE	11	REMOVE	
1025	UNKNOWN	20	REMOVE	
1026	PINE	13	REMOVE	
1027	PINE	14	REMOVE	
1028	PINE	25	REMOVE	
1029	COCONUT PALM	8' HT	REMOVE	
1030	PINE	13	REMOVE	
1031	PINE	13	REMOVE	
1032	PINE	14	REMOVE	
1033	PINE	6	REMOVE	
1034	PINE	13	REMOVE	
1035	PINE	14	REMOVE	
1036	PINE	13	REMOVE	
1037	PINE	16	REMAIN	3
1038	PINE	18	REMAIN	3
1039	FIGUS	9	REMOVE	
1040	CABBAGE PALM	14' HT	REMAIN	0.33
1041	CABBAGE PALM	17' HT	REMAIN	0.33
1042	CABBAGE PALM	22' HT	REMAIN	0.34
1043	PINE	13	REMOVE	
1044	PINE	18	REMOVE	
1045	QUEEN PALM	14' HT	REMOVE	
1046	UNKNOWN	17	REMOVE	
1047	QUEEN PALM	14' HT	REMOVE	
1048	QUEEN PALM	16' HT	REMOVE	
1049	UNKNOWN	25	REMOVE	
1050	UNKNOWN	20	REMOVE	
1051	UNKNOWN	23	REMOVE	
1052	UNKNOWN	30	REMOVE	
1053	PINE	19	REMOVE	
1054	PINE	14	REMOVE	
1055	PINE	13	REMOVE	
1056	PINE	14	REMOVE	
1057	PINE	7	REMOVE	
1058	PINE	13	REMOVE	
1059	PINE	11	REMOVE	
1060	PINE	9	REMOVE	

TREE NO.	COMMON NAME	DBH (in inches)	DISPOSITION	CREDIT (No. of Trees)
1061	CABBAGE PALM	14	REMOVE	
1062	PINE	22	REMOVE	
1063	CABBAGE PALM	13	REMAIN	0.33
1064	PINE	18	REMAIN	3
1065	CABBAGE PALM	14	REMAIN	0.33
1066	PINE	17	REMOVE	
1067	PINE	14	REMOVE	
1068	PINE	16	REMOVE	
1069	CABBAGE PALM	13	REMOVE	
1070	PINE	26	REMOVE	
1071	CABBAGE PALM	21' HT	REMOVE	
1072	CABBAGE PALM	12' HT	REMOVE	
1073	PINE	16	REMOVE	
1074	PINE	18	REMOVE	
1075	PINE	15	REMOVE	
1076	PINE	20	REMOVE	
1077	PINE	15	REMOVE	
1078	PINE	14	REMOVE	
1079	PINE	18	REMOVE	
1080	PINE	16	REMOVE	
1081	PINE	15	REMOVE	
1082	PINE	17	REMAIN	3
1083	PINE	14	REMAIN	3
1084	PINE	17	REMOVE	
1085	PINE	13	REMOVE	
1086	PINE	18	REMOVE	
1087	PINE	13	REMAIN	3
1088	PINE	12	REMAIN	2
1089	COCONUT PALM	36' HT	REMOVE	
1090	MANGO	4	REMOVE	
1091	MANGO	7	REMOVE	
1092	MANGO	4	REMOVE	
1093	MANGO MT	8	REMOVE	
1094	COCONUT PALM	27' HT	REMOVE	
1095	COCONUT PALM	36' HT	REMOVE	
1096	PINE	13	REMOVE	
1097	PINE	25	REMOVE	
1098	OAK	7	REMAIN	1
1099	UNKNOWN MT	24	REMOVE	
1100	QUEEN PALM	16' HT	REMOVE	
1101	COCONUT PALM	13' HT	REMOVE	
1102	QUEEN PALM	20' HT	REMOVE	
1103	MANGO	4	REMOVE	
1104	OAK	10	REMOVE	
1105	COCONUT PALM	36' HT	REMAIN	0.34
1106	MANGO	14	REMOVE	
1107	QUEEN PALM	9	REMOVE	
1108	QUEEN PALM	9	REMOVE	
1109	PINE	8	REMAIN	2
1110	MAPLE	6	REMAIN	1
1111	CEDAR	9	REMAIN	2
1112	QUEEN PALM	10' HT	REMOVE	
			TOTAL TREE CREDITS	28

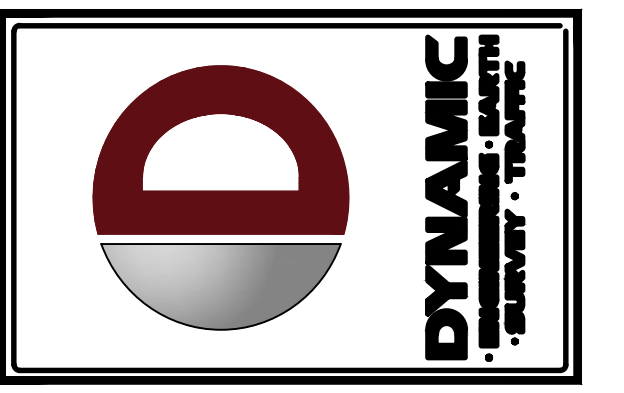

REV	DATE	COMMENTS	BY
3	07/29/20	AGENCY COMMENTS	KMK
2	07/15/20	AGENCY COMMENTS	KMK
1	06/07/20	AGENCY COMMENTS	KMK

PROJECT: PALM BEACH CHRISTIAN MINISTRIES, INC.
PALM BEACH CHRISTIAN PREPARATORY SCHOOL
TRACT 7
S. HAVERHILL ROAD & NAUTICA ISLES BOULEVARD
CITY OF GREENACRES
PALM BEACH COUNTY, FLORIDA 33465

DYNAMIC ENGINEERING
LAND DEVELOPMENT CONSULTING • PERMITTING
GEOTECHNICAL • ENVIRONMENTAL
TRAFFIC • SURVEY • PLANNING & ZONING

100 NE 5th Avenue, Suite B2
Delroy Beach, FL 33483
T: 561.921.8570
Offices conveniently located at:
Lake County, New Jersey • T: 732.974.9198
Capelet, New Jersey • T: 908.879.9299
Newark, New Jersey • T: 973.755.7200
Toms River, New Jersey • T: 732.974.9198
Hendersonville, North Carolina • T: 704.468.0274
Aurora, Florida • T: 973.484.9100
Naples, Florida • T: 239.789.4400
Jupiter, Florida • T: 561.446.3446
Delroy Beach, Florida • T: 561.921.8570

Florida Certificate of Authorization No. 32535
www.dynamicce.com

Kenneth D Bates
LA666710
2020.09.17 16:54:18
-0600'

811 PROTECT YOURSELF
CALL BEFORE YOU DIG
FOR STATE SPECIFIC DIRECT PHONE NUMBERS VISIT
WWW.CALL811.COM

TITLE:
**TREE DISPOSITION
SPECS & DETAILS**

SCALE (H)
DATE
03/26/2020

PROJECT NO:
3346-99-001

SHEET NO:
L0.01

**EVERGREEN
DESIGN GROUP**
(800) 680-6630
2255 Glades Road, Suite 324A
Boca Raton, FL 33431
www.EvergreenDesignGroup.com
LC #26000612

SEE SHEET L1.01 FOR
PLANT SCHEDULE

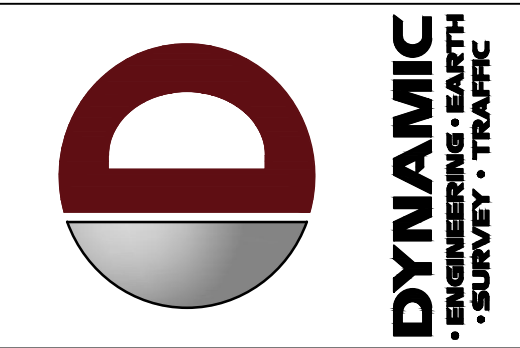

NO.	DATE	REVISION	BY
1	03/26/2020	ISSUED FOR PERMIT	KDB
2	07/15/20	AGENCY COMMENTS	KDB
3	07/29/20	AGENCY COMMENTS	KDB

PROJECT: **PALM BEACH CHRISTIAN MINISTRIES INC.**
PALM BEACH CHRISTIAN MINISTRIES INC.
TRACT 7
S. HAVERHILL ROAD & NAUTICA ISLES BOULEVARD
CITY OF GREENACRES
PALM BEACH COUNTY, FLORIDA 33463

DYNAMIC ENGINEERING
LAND DEVELOPMENT CONSULTING • PERMITTING
GEOTECHNICAL • ENVIRONMENTAL
TRAFFIC • SURVEY • PLANNING & ZONING
100 NE 5th Avenue, Suite B2
Delray Beach, FL 33483
T: 561.921.8570
Offices conveniently located at:
Lakeland, FL • 888.222.8570
Coral Gables, FL • 305.444.8570
Miami, FL • 305.444.8570
Orlando, FL • 407.444.8570
Tampa, FL • 813.444.8570
Fort Lauderdale, FL • 954.444.8570
West Palm Beach, FL • 561.444.8570
www.dynamiceng.com

Kenneth D Bates
LA6666710
2020.09.17 16:53:36
06/00'

811 PROTECT YOURSELF
ALL STATES REQUIRE NOTIFICATION OF
ENGINEERS, DESIGNERS, OR ANY PERSON
PREPARING TO EXCAVATE THE EARTH'S
SURFACE, UNLESS IN AN EMERGENCY.
FOR STATE SPECIFIC DIRECT PHONE NUMBERS VISIT:
WWW.CALL811.COM

TITLE: **LANDSCAPE PLAN**

SCALE: (H)
(V) 03/26/2020
PROJECT No:
3346-99-001

SHEET No: **L1.00** Rev. #:

Scale 1" = 30'

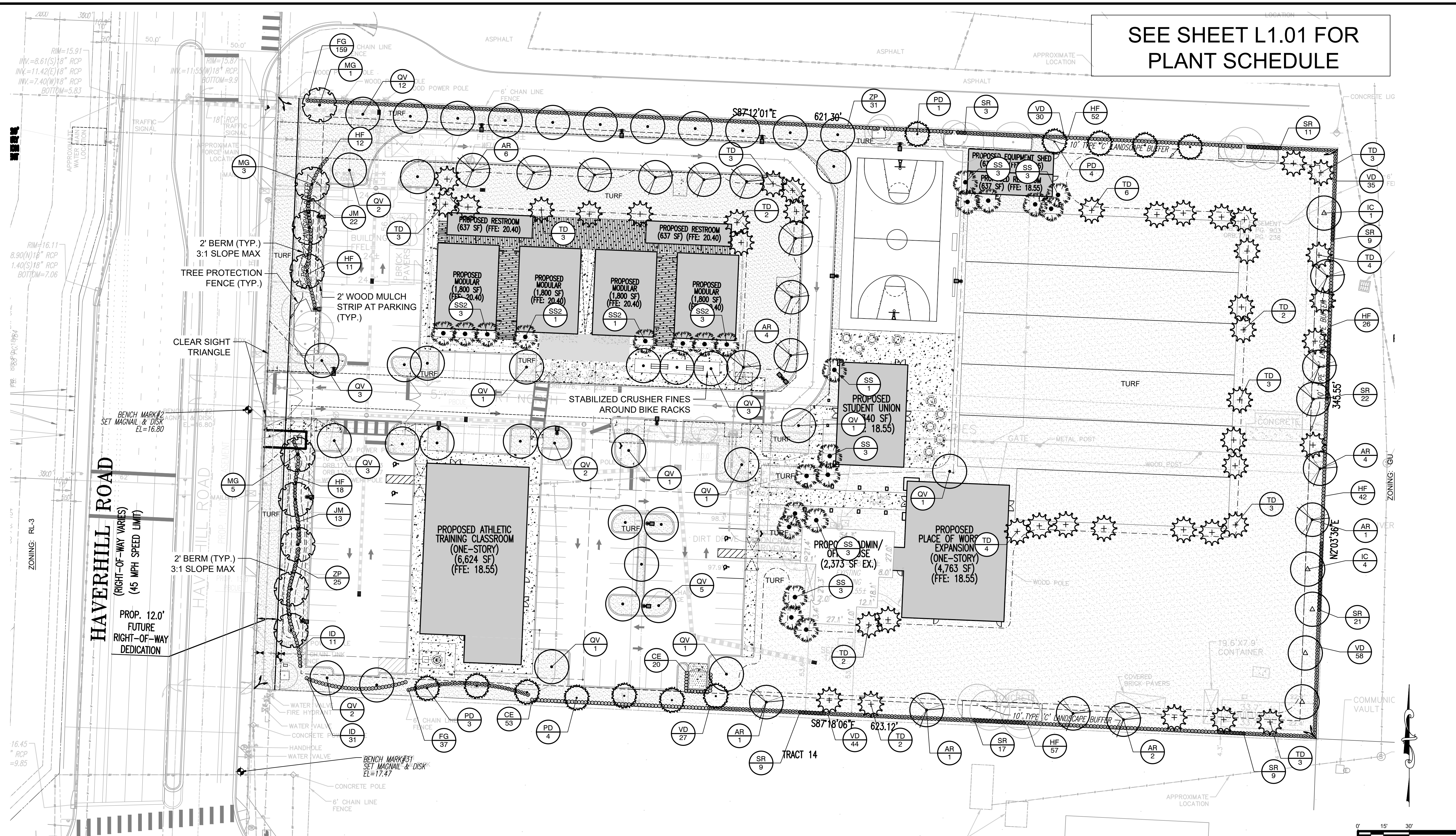

IRRIGATION CONCEPT

1. AN AUTOMATIC IRRIGATION SYSTEM SHALL BE INSTALLED AND OPERATIONAL BY THE TIME OF FINAL INSPECTION. THE ENTIRE IRRIGATION SYSTEM SHALL BE INSTALLED BY A LICENSED AND QUALIFIED IRRIGATION CONTRACTOR.
2. THE IRRIGATION SYSTEM WILL OPERATE ON THE LOWEST QUALITY WATER AVAILABLE, AND THE SYSTEM WILL HAVE APPROPRIATE BACKFLOW PREVENTION DEVICES INSTALLED TO PREVENT CONTAMINATION OF ANY POTABLE SOURCE, IF APPLICABLE.
3. ALL NON-TURF PLANTED AREAS SHALL BE DRIP IRRIGATED. SODDED AND SEEDING AREAS SHALL BE IRRIGATED WITH SPRAY OR ROTOR HEADS AT 100% HEAD-TO-HEAD COVERAGE.
4. ALL PLANTS SHARING SIMILAR HYDROZONE CHARACTERISTICS SHALL BE PLACED ON A VALVE DEDICATED TO PROVIDE THE NECESSARY WATER REQUIREMENTS SPECIFIC TO THAT HYDROZONE.
5. THE IRRIGATION SYSTEM SHALL BE DESIGNED AND INSTALLED, TO THE MAXIMUM EXTENT POSSIBLE, TO CONSERVE WATER BY USING THE FOLLOWING DEVICES AND SYSTEMS: MATCHED PRECIPITATION RATE TECHNOLOGY ON ROTOR AND SPRAY HEADS (WHEREVER POSSIBLE), RAIN SENSORS, AND MULTI-PROGRAM COMPUTERIZED IRRIGATION CONTROLLERS FEATURING SENSORY INPUT CAPABILITIES.

ROOT BARRIERS

THE CONTRACTOR SHALL INSTALL ROOT BARRIERS NEAR ALL NEWLY-PLANTED TREES THAT ARE LOCATED WITHIN FIVE (5) FEET OF PAVING OR CURBS. ROOT BARRIERS SHALL BE "CENTURY" OR "DEEP-ROOT" 24" DEEP PANELS (OR EQUAL). BARRIERS SHALL BE LOCATED IMMEDIATELY ADJACENT TO HARDSCAPE. INSTALL PANELS PER MANUFACTURER'S RECOMMENDATIONS. UNDER NO CIRCUMSTANCES SHALL THE CONTRACTOR USE ROOT BARRIERS OF A TYPE THAT COMPLETELY ENCIRCLE THE ROOTBALL.

MULCHES

AFTER ALL PLANTING IS COMPLETE, CONTRACTOR SHALL INSTALL 3" THICK LAYER OF 1-1/2" SHREDDED WOOD MULCH, NATURAL (UNDYED) IN ALL PLANTING AREAS (EXCEPT FOR TURF AND SEEDING AREAS). CONTRACTOR SHALL SUBMIT SAMPLES OF ALL MULCHES TO LANDSCAPE ARCHITECT AND OWNER FOR APPROVAL PRIOR TO CONSTRUCTION. ABSOLUTELY NO EXPOSED GROUND SHALL BE LEFT SHOWING ANYWHERE ON THE PROJECT AFTER MULCH HAS BEEN INSTALLED (SUBJECT TO THE CONDITIONS AND REQUIREMENTS OF THE "GENERAL GRADING AND PLANTING NOTES" AND SPECIFICATIONS).

LANDSCAPE CALCULATIONS

PROJECT AREA:	215,329 SF
VEHICULAR USE AREA:	74,767.8 SF
REQUIRED TREE SPECIES MIX:	5 SPECIES
PROVIDED TREE SPECIES MIX:	7 SPECIES
PROVIDED NATIVE TREE SPECIES:	94%
PROVIDED HARDWOOD SPECIES:	84%
PROVIDED PALM SPECIES:	16%
INTERIOR LANDSCAPE	
LANDSCAPE AREA REQUIRED:	7,477 SF (10% OF TOTAL VUA)
LANDSCAPE AREA PROVIDED:	8,404 SF
TREES REQUIRED:	75 TREES (1 PER 100 SF OF REQUIRED LANDSCAPE)
TREES PROVIDED:	96 TREES, 24 PALM TREES (3-1), 1 TREE CREDIT EXISTING TO REMAIN
DUMPSTER ENCLOSURE SCREENING REQUIRED:	24"x18" HEDGE @ 24" O.C.
DUMPSTER ENCLOSURE SCREENING PROVIDED:	HEDGE AS REQUIRED
BUILDING PERIMETER LANDSCAPE	
LANDSCAPE AREA REQUIRED:	374-748 SF (5-10% OF REQUIRED LSA)
LANDSCAPE PROVIDED:	1575 SF

PERIMETER BUFFER LANDSCAPE

NORTH (621.3 LF):	TREES REQUIRED: 21 TREES (1 PER 30 LF)	TREES PROVIDED: 18 TREES, 7.66 TREE CREDIT EXIST. TO REMAIN PROVIDED
EAST (345.5 LF):	TREES REQUIRED: 12 TREES (1 PER 30 LF)	TREES PROVIDED: 15 TREES
SOUTH (623.12 LF):	TREES REQUIRED: 21 TREES (1 PER 30 LF)	TREES PROVIDED: 18 TREES, 11.34 TREE CREDIT EXIST. TO REMAIN PROVIDED
WEST (346.63 LF):	TREES REQUIRED: 12 TREES (1 PER 25 LF)	TREES PROVIDED: 9 TREES, 5 TREE CREDIT EXIST. TO REMAIN PROVIDED

PLANTING SPECIFICATIONS

GENERAL

- QUALIFICATIONS OF LANDSCAPE CONTRACTOR
 - ALL LANDSCAPE WORK SHOWN ON THESE PLANS SHALL BE PERFORMED BY A SINGLE FIRM SPECIALIZING IN LANDSCAPE PLANTING.
 - A LIST OF SUCCESSFULLY COMPLETED PROJECTS OF THIS TYPE, SIZE AND NATURE MAY BE REQUESTED BY THE OWNER FOR FURTHER QUALIFICATION MEASURES.
 - THE LANDSCAPE CONTRACTOR SHALL HOLD A VALID CONTRACTORS LICENSE ISSUED BY THE APPROPRIATE LOCAL JURISDICTION.
- SCOPE OF WORK
 - WORK COVERED BY THESE SECTIONS INCLUDES THE FURNISHING AND PAYMENT OF ALL MATERIALS, LABOR, SERVICES, EQUIPMENT, LICENSES, TAXES AND ANY OTHER ITEMS THAT ARE NECESSARY FOR THE EXECUTION, INSTALLATION AND COMPLETION OF ALL WORK SPECIFIED HEREIN AND /OR SHOWN ON THE LANDSCAPE PLANS, NOTES, AND DETAILS.
 - ALL WORK SHALL BE PERFORMED IN ACCORDANCE WITH ALL APPLICABLE LAWS, CODES AND REGULATIONS REQUIRED BY AUTHORITIES HAVING JURISDICTION OVER SUCH WORK, INCLUDING ALL INSPECTIONS AND PERMITS REQUIRED BY FEDERAL, STATE AND LOCAL AUTHORITIES IN SUPPLY, TRANSPORTATION AND INSTALLATION OF MATERIALS.
 - THE LANDSCAPE CONTRACTOR SHALL VERIFY THE LOCATION OF ALL UNDERGROUND UTILITY LINES (WATER, SEWER, ELECTRICAL, TELEPHONE, GAS, CABLE, TELEVISION, ETC.) PRIOR TO THE START OF ANY WORK.

PRODUCTS

- ALL MANUFACTURED PRODUCTS SHALL BE NEW.
- CONTAINER AND BALLED-AND-BURLAPPED PLANTS
 - ALL PLANT MATERIAL SHALL BE FLORIDA NO. 1 OR BETTER ACCORDING TO GRADES AND STANDARDS FOR NURSERY PLANTS, CURRENT EDITION AT TIME OF INSTALLATION.
 - FURNISH NURSERY-GROWN PLANTS COMPLYING WITH ANSI Z60.1-2014. PROVIDE WELL-SHAPED, FULLY BRANCHED, HEALTHY, VIGOROUS STOCK FREE OF DISEASE, INSECTS, EGGS, LARVAE, AND DEFECTS SUCH AS KNOTS, SUN SCALD, INJURIES, ABRASIONS, AND DISFIGUREMENT. ALL PLANTS WITHIN A SPECIES SHALL HAVE SIMILAR SIZE, AND SHALL BE OF A FORM TYPICAL FOR THE SPECIES. ALL TREES SHALL BE OBTAINED FROM SOURCES WITHIN 200 MILES OF THE PROJECT SITE, AND WITH SIMILAR CLIMATIC CONDITIONS.
 - ROOT SYSTEMS SHALL BE HEALTHY, DENSELY BRANCHED ROOT SYSTEMS, NON-POT-BOUND, FREE FROM ENCRUSTING AND/OR GIRDLING ROOTS, AND FREE FROM ANY OTHER ROOT DEFECTS (SUCH AS J-SHAPED ROOTS).
 - ANY PLANT DEEMED UNACCEPTABLE BY THE LANDSCAPE ARCHITECT OR OWNER SHALL BE IMMEDIATELY REMOVED FROM THE SITE AND SHALL BE REPLACED WITH AN ACCEPTABLE PLANT OF LIKE TYPE AND SIZE AT THE CONTRACTOR'S OWN EXPENSE. TREES WITH UNHEALTHY LEAVES, EVEN IF DETERMINED TO STILL BE ALIVE, SHALL NOT BE ACCEPTED. THE LANDSCAPE ARCHITECT AND OWNER SHALL BE THE SOLE JUDGES AS TO THE ACCEPTABILITY OF PLANT MATERIAL.
 - ALL TREES SHALL BE STANDARD IN FORM, UNLESS OTHERWISE SPECIFIED. TREES WITH CENTRAL LEADERS WILL NOT BE ACCEPTED IF LEADER DAMAGED OR REMOVED. PRUNE ALL DAMAGED TWIGS AFTER PLANTING.
 - CALIPER MEASUREMENTS FOR STANDARD (SINGLE TRUNK) TREES SHALL BE AS FOLLOWS: SIX INCHES ABOVE THE ROOT FLARE FOR TREES UP TO AND INCLUDING FOUR INCHES IN CALIPER, AND TWELVE INCHES ABOVE THE ROOT FLARE FOR TREES EXCEEDING FOUR INCHES IN CALIPER.
 - MULTI-TRUNK TREES SHALL BE MEASURED BY THEIR OVERALL HEIGHT, MEASURED FROM THE TOP OF THE ROOT BALL.
 - ANY TREE OR SHRUB SHOWN TO HAVE EXCESS SOIL PLACED ON TOP OF THE ROOT BALL, SO THAT THE ROOT FLARE HAS BEEN COMPLETELY COVERED, SHALL BE REJECTED.
- SOD: PROVIDE WELL-ROOTED SOD OF THE VARIETY NOTED ON THE PLANS. SOD SHALL BE CUT FROM HEALTHY, MATURE TURF WITH SOIL THICKNESS OF 3/4" TO 1". EACH PALLET OF SOD SHALL BE ACCOMPANIED BY A CERTIFICATE FROM SUPPLIER STATING THE COMPOSITION OF THE SOD.
- TOPSOIL: SANDY TO CLAY LOAM TOPSOIL, FREE OF STONES LARGER THAN 1/2" INCH, FOREIGN MATTER, PLANTS, ROOTS, AND SEEDS.
- COMPOST: WELL-COMPOSTED, STABLE, AND WEEF-FREE ORGANIC MATTER, pH RANGE OF 5.5 TO 8; MOISTURE CONTENT 35 TO 55 PERCENT BY WEIGHT; 100 PERCENT PASSING THROUGH 3/4-INCH SIEVE; SOLUBLE SALT CONTENT OF 5 TO 10 DECIGRAMS PER LITER, NOT EXCEEDING 0.5 PERCENT INERT CONTAMINANTS AND FREE OF SUBSTANCES TOXIC TO PLANTINGS. NO MANURE OR ANIMAL-BASED PRODUCTS SHALL BE USED.
- PLANTING MIX FOR POTS: AN EQUAL PART MIXTURE OF TOPSOIL, SAND AND COMPOST. INCORPORATE "GELSCAPE", AS MADE BY AMRECO, INC., (800) 832-8788, AT THE RATE OF 3 LB. PER CUBIC YARD OF PLANTING MIX.
- FERTILIZER: GRANULAR FERTILIZER CONSISTING OF NITROGEN, PHOSPHORUS, POTASSIUM, AND OTHER NUTRIENTS IN PROPORTIONS, AMOUNTS, AND RELEASE RATES RECOMMENDED IN A SOIL REPORT FROM A QUALIFIED SOIL-TESTING AGENCY (SEE BELOW).
- PALM MAINTENANCE SPECS: AS MANUFACTURED BY THE LUTZ CORP. (800) 203-7740, OR APPROVED EQUAL.
- MULCH: SIZE AND TYPE AS NOTED ON PLANS, FREE FROM DELETERIOUS MATERIALS AND SUITABLE AS A TOP DRESSING OF TREES AND SHRUBS.
- TREE STAKING AND GUYING
 - STAKES: 6' LONG GREEN METAL T-POSTS.
 - GUY AND TIE WIRE: ASTM A 641, CLASS 1, GALVANIZED-STEEL WIRE, 2-STRAND, TWISTED, 0.106 INCH DIAMETER.
 - STRAP CHAINING GUARD: REINFORCED NYLON OR CANVAS AT LEAST 1-1/2 INCH WIDE, WITH GROMMETS TO PROTECT TREE TRUNKS FROM DAMAGE.
- PRE-EMERGENT HERBICIDES: ANY GRANULAR, NON-STAINING PRE-EMERGENT HERBICIDE THAT IS LABELED FOR THE SPECIFIC ORNAMENTALS OR TURF ON WHICH IT IS TO BE UTILIZED. PRE-EMERGENT HERBICIDES SHALL BE APPLIED PER THE MANUFACTURER'S LABELED RATES.

METHODS

- SOIL PREPARATION
 - BEFORE STARTING WORK, THE LANDSCAPE CONTRACTOR SHALL VERIFY THAT THE GRADE OF ALL LANDSCAPE AREAS ARE WITHIN +/-0.1" OF FINISH GRADE. THE CONTRACTOR SHALL NOTIFY THE OWNER IMMEDIATELY SHOULD ANY DISCREPANCIES EXIST.
 - SOIL TESTING
 - AFTER FINISH GRADES HAVE BEEN ESTABLISHED, CONTRACTOR SHALL HAVE SOIL SAMPLES FROM THE PROJECT'S LANDSCAPE AREAS TESTED BY AN ESTABLISHED SOIL TESTING LABORATORY. EACH SAMPLE SUBMITTED TO THE LAB SHALL CONTAIN NO LESS THAN ONE QUART OF SOIL, TAKEN FROM BETWEEN THE SOIL SURFACE AND 6" DEPTH. IF NO SAMPLE LOCATIONS ARE INDICATED ON THE PLANS, THE CONTRACTOR SHALL TAKE A MINIMUM OF THREE SAMPLES FROM VARIOUS REPRESENTATIVE LOCATIONS FOR TESTING.
 - THE CONTRACTOR SHALL HAVE THE SOIL TESTING LABORATORY PROVIDE RESULTS FOR THE FOLLOWING: SOIL TEXTURAL CLASS, GENERAL SOIL FERTILITY, pH, ORGANIC MATTER CONTENT, SALT (CEC) LINE, CATIONIC ADSORPTION RATIO (SAR) AND BORON CONTENT.
 - THE CONTRACTOR SHALL ALSO SUBMIT THE PROJECT'S PLANT LIST TO THE LABORATORY ALONG WITH THE SOIL SAMPLES.
 - THE SOIL REPORT PRODUCED BY THE LABORATORY SHALL CONTAIN RECOMMENDATIONS FOR THE FOLLOWING (AS APPROPRIATE): SEPARATE SOIL PREPARATION AND BACKFILL MIX RECOMMENDATIONS FOR GENERAL ORNAMENTAL PLANTS, XERIC PLANTS, TURF, AND NATIVE SEED, AS WELL AS PRE-PLANT FERTILIZER APPLICATIONS AND RECOMMENDATIONS FOR ANY OTHER SOIL RELATED ISSUES. THE REPORT SHALL ALSO PROVIDE A FERTILIZER PROGRAM FOR THE ESTABLISHMENT PERIOD AND FOR LONG-TERM MAINTENANCE.
 - THE CONTRACTOR SHALL INSTALL SOIL AMENDMENTS AND FERTILIZERS PER THE SOILS REPORT RECOMMENDATIONS, ANY CHANGE IN COST DUE TO THE SOIL REPORT RECOMMENDATIONS, EITHER INCREASE OR DECREASE, SHALL BE SUBMITTED TO THE OWNER WITH THE REPORT.
 - FOR BIDDING PURPOSES ONLY, THE SOIL PREPARATION SHALL CONSIST OF THE FOLLOWING:
 - TURF: INCORPORATE THE FOLLOWING AMENDMENTS INTO THE TOP 6" OF SOIL BY MEANS OF ROTOTILLING AFTER CROSS-RIPPING:
 - NITROGEN STABILIZED ORGANIC AMENDMENT - 4 CU. YDS. PER 1,000 S.F.
 - PREPLANT TURF FERTILIZER (10-20-10 OR SIMILAR, SLOW RELEASE, ORGANIC) - 15 LBS PER 1,000 S.F.
 - "CLAY BUSTER" OR EQUAL - USE MANUFACTURER'S RECOMMENDED RATE
 - TREES, SHRUBS, AND PERENNIALS: INCORPORATE THE FOLLOWING AMENDMENTS INTO THE TOP 6" OF SOIL BY MEANS OF ROTOTILLING AFTER CROSS-RIPPING:
 - NITROGEN STABILIZED ORGANIC AMENDMENT - 4 CU. YDS. PER 1,000 S.F.
 - 12-12-12 FERTILIZER (OR SIMILAR, ORGANIC, SLOW RELEASE) - 10 LBS. PER CU. YD.
 - "CLAY BUSTER" OR EQUAL - USE MANUFACTURER'S RECOMMENDED RATE
- IN THE CONTEXT OF THESE PLANS, NOTES, AND SPECIFICATIONS, "FINISH GRADE" REFERS TO THE FINAL ELEVATION OF THE SOIL SURFACE (NOT TOP OF MULCH) AS INDICATED ON THE GRADING PLANS.
 - BEFORE STARTING WORK, THE LANDSCAPE CONTRACTOR SHALL VERIFY THAT THE ROUGH GRADES OF ALL LANDSCAPE AREAS ARE WITHIN +/-0.1" OF FINISH GRADE. SEE SPECIFICATIONS FOR MORE DETAILED INSTRUCTION ON TURF AREA AND PLANTING BED PREPARATION.
 - CONSTRUCT AND MAINTAIN FINISH GRADES AS SHOWN ON GRADING PLANS, AND CONSTRUCT AND MAINTAIN SLOPES AS RECOMMENDED BY THE GEOTECHNICAL REPORT. ALL LANDSCAPE AREAS SHALL HAVE POSITIVE DRAINAGE AWAY FROM STRUCTURES AT THE MINIMUM SLOPE SPECIFIED IN THE REPORT AND ON THE GRADING PLANS, AND AREAS OF POTENTIAL PONDING SHALL BE REGRADED TO BLEND IN WITH THE SURROUNDING GRADES AND ELIMINATE PONDING POTENTIAL.
 - THE LANDSCAPE CONTRACTOR SHALL DETERMINE WHETHER OR NOT THE EXPORT OF ANY SOIL WILL BE NEEDED, TAKING INTO ACCOUNT THE ROUGH GRADE PROVIDED, THE AMOUNT OF SOIL AMENDMENTS TO BE ADDED (BASED ON A SOIL TEST, PER SPECIFICATIONS), AND THE FINISH GRADES TO BE ESTABLISHED.
 - ENSURE THAT THE FINISH GRADE IN SHRUB AREAS IMMEDIATELY ADJACENT TO WALKS AND OTHER WALKING SURFACES, AFTER INSTALLING SOIL AMENDMENTS, IS 3" BELOW THE ADJACENT FINISH SURFACE, IN ORDER TO ALLOW FOR PROPER MULCH DEPTH. TAPER THE SOIL SURFACE TO MEET FINISH GRADE, AS SPECIFIED ON THE GRADING PLANS, AT APPROXIMATELY 18" AWAY FROM THE WALKS.
 - ENSURE THAT THE FINISH GRADE IN TURF AREAS IMMEDIATELY ADJACENT TO WALKS AND OTHER WALKING SURFACES, AFTER INSTALLING SOIL AMENDMENTS, IS 1" BELOW THE FINISH SURFACE OF THE WALKS. TAPER THE SOIL SURFACE TO MEET FINISH GRADE, AS SPECIFIED ON THE GRADING PLANS, AT APPROXIMATELY 18" AWAY FROM THE WALKS.
 - SHOULD ANY CONFLICTS AND/OR DISCREPANCIES ARISE BETWEEN THE GRADING PLANS, GEOTECHNICAL REPORT, THESE NOTES AND PLANS, AND ACTUAL CONDITIONS, THE CONTRACTOR SHALL IMMEDIATELY BRING SUCH ITEMS TO THE ATTENTION OF THE LANDSCAPE ARCHITECT, GENERAL CONTRACTOR, AND OWNER.
 - ONCE SOIL PREPARATION IS COMPLETE, THE LANDSCAPE CONTRACTOR SHALL ENSURE THAT THERE ARE NO DEBRIS, TRASH, OR STONES LARGER THAN 1" REMAINING IN THE TOP 6" OF SOIL.

PLANT SCHEDULE

TREES	CODE	QTY	BOTANICAL NAME	COMMON NAME	CONT	CAL	SIZE	SPR
	AR	19	ACER RUBRUM NATIVE	RED MAPLE	CONT.	2" DBH MIN.	12' HT MIN, 5' CLEAR	5' SPR
	IC	5	ILEX CASSINE NATIVE	DAHOON HOLLY	CONT.	2" DBH MIN.	12' HT MIN, 5' CLEAR	5' SPR
	MG	9	MAGNOLIA GRANDIFLORA	SOUTHERN MAGNOLIA	CONT.	2" DBH MIN.	12' HT MIN	5' SPR
	PD	12	PINUS ELLIOTTI DENSA NATIVE	SLASH PINE	CONT.	2" DBH MIN.	12' HT MIN, 5' CLEAR	5' SPR
	QV	39	QUERCUS VIRGINIANA NATIVE	SOUTHERN LIVE OAK	CONT.	2" DBH MIN.	12' HT MIN, 5' CLEAR	5' SPR
	SS	16	SABAL PALMETTO NATIVE	CABBAGE PALMETTO	B & B	SLICK	12'-18' CT VARIES	
	SS2	8	SABAL PALMETTO NATIVE	CABBAGE PALMETTO	B & B	SLICK	20' - 24' CT	
	TD	42	TAXODIUM DISTICHUM NATIVE	BALD CYPRESS	CONT.	2" DBH MIN.	12' HT MIN, 5' CLEAR	5' SPR
SHRUBS	CODE	QTY	BOTANICAL NAME	COMMON NAME	CONT	SPACING	SIZE	
	CE	73	CONOCARPUS ERECTUS	BUTTONWOOD	3 GAL	24" OC	24" HT X 18" SPR	
	FG	196	FICUS MICROCARPA 'GREEN ISLAND'	GREEN ISLAND FICUS	3 GAL	24" OC	24" HT X 18" SPR	
	HF	218	HAMELIA PATENS	FIREBUSH	3 GAL	24" OC	24" HT X 18" SPR	
	ID	42	ILEX VOMITORIA 'SCHILLINGS DWARF'	DWARF SCHILLINGS HOLLY	3 GAL	24" OC	24" HT X 18" SPR	
	JM	35	JASMINUM MULTIFLORUM	DOWNEY JASMINE	3 GAL	24" OC	24" HT X 18" SPR	
	SR	101	SERENOA REPENS	SAW PALMETTO	3 GAL	24" OC	24" HT X 18" SPR	
	VD	194	VIBURNUM OBOVATUM 'DENSA'	VIBURNUM	3 GAL	24" OC	24" HT X 18" SPR	
	ZP	56	ZAMIA PUMILA	COONTIE	3 GAL	24" OC	24" HT X 18" SPR	
GROUND COVERS	CODE	QTY	BOTANICAL NAME	COMMON NAME	CONT	SIZE	SPACING	
	PA	113,661 SF	PASPALUM NOTATUM 'ARGENTINE'	BAHIA GRASS	SOD			
	WM	455 SF	WOOD MUGH CLEAR ZONE	MULCH AT 3" DEPTH	MULCH			

GENERAL GRADING AND PLANTING NOTES

- ALL PLANT MATERIAL SHALL BE FLORIDA NO. 1 OR BETTER ACCORDING TO GRADES AND STANDARDS FOR NURSERY PLANTS, CURRENT EDITION AT TIME OF INSTALLATION.
- BY SUBMITTING A PROPOSAL FOR THE LANDSCAPE PLANTING SCOPE OF WORK, THE CONTRACTOR CONFIRMS THAT HE HAS READ, AND WILL COMPLY WITH, THE ASSOCIATED NOTES, SPECIFICATIONS, AND DETAILS WITH THIS PROJECT.
- THE GENERAL CONTRACTOR IS RESPONSIBLE FOR REMOVING ALL EXISTING VEGETATION (EXCEPT WHERE NOTED TO REMAIN).
- IN THE CONTEXT OF THESE PLANS, NOTES, AND SPECIFICATIONS, "FINISH GRADE" REFERS TO THE FINAL ELEVATION OF THE SOIL SURFACE (NOT TOP OF MULCH) AS INDICATED ON THE GRADING PLANS.
 - BEFORE STARTING WORK, THE LANDSCAPE CONTRACTOR SHALL VERIFY THAT THE ROUGH GRADES OF ALL LANDSCAPE AREAS ARE WITHIN +/-0.1" OF FINISH GRADE. SEE SPECIFICATIONS FOR MORE DETAILED INSTRUCTION ON TURF AREA AND PLANTING BED PREPARATION.
 - CONSTRUCT AND MAINTAIN FINISH GRADES AS SHOWN ON GRADING PLANS, AND CONSTRUCT AND MAINTAIN SLOPES AS RECOMMENDED BY THE GEOTECHNICAL REPORT. ALL LANDSCAPE AREAS SHALL HAVE POSITIVE DRAINAGE AWAY FROM STRUCTURES AT THE MINIMUM SLOPE SPECIFIED IN THE REPORT AND ON THE GRADING PLANS, AND AREAS OF POTENTIAL PONDING SHALL BE REGRADED TO BLEND IN WITH THE SURROUNDING GRADES AND ELIMINATE PONDING POTENTIAL.
 - THE LANDSCAPE CONTRACTOR SHALL DETERMINE WHETHER OR NOT THE EXPORT OF ANY SOIL WILL BE NEEDED, TAKING INTO ACCOUNT THE ROUGH GRADE PROVIDED, THE AMOUNT OF SOIL AMENDMENTS TO BE ADDED (BASED ON A SOIL TEST, PER SPECIFICATIONS), AND THE FINISH GRADES TO BE ESTABLISHED.
 - ENSURE THAT THE FINISH GRADE IN SHRUB AREAS IMMEDIATELY ADJACENT TO WALKS AND OTHER WALKING SURFACES, AFTER INSTALLING SOIL AMENDMENTS, IS 3" BELOW THE ADJACENT FINISH SURFACE, IN ORDER TO ALLOW FOR PROPER MULCH DEPTH. TAPER THE SOIL SURFACE TO MEET FINISH GRADE, AS SPECIFIED ON THE GRADING PLANS, AT APPROXIMATELY 18" AWAY FROM THE WALKS.
 - ENSURE THAT THE FINISH GRADE IN TURF AREAS IMMEDIATELY ADJACENT TO WALKS AND OTHER WALKING SURFACES, AFTER INSTALLING SOIL AMENDMENTS, IS 1" BELOW THE FINISH SURFACE OF THE WALKS. TAPER THE SOIL SURFACE TO MEET FINISH GRADE, AS SPECIFIED ON THE GRADING PLANS, AT APPROXIMATELY 18" AWAY FROM THE WALKS.
 - SHOULD ANY CONFLICTS AND/OR DISCREPANCIES ARISE BETWEEN THE GRADING PLANS, GEOTECHNICAL REPORT, THESE NOTES AND PLANS, AND ACTUAL CONDITIONS, THE CONTRACTOR SHALL IMMEDIATELY BRING SUCH ITEMS TO THE ATTENTION OF THE LANDSCAPE ARCHITECT, GENERAL CONTRACTOR, AND OWNER.
- ALL PLANT LOCATIONS ARE DIAGRAMMATIC. ACTUAL LOCATIONS SHALL BE VERIFIED WITH THE LANDSCAPE ARCHITECT PRIOR TO PLANTING. AREAS OF POTENTIAL PONDING SHALL ENSURE THAT ALL REQUIREMENTS OF THE PERMITTING AUTHORITY ARE MET (I.E., MINIMUM PLANT QUANTITIES, PLANTING METHODS, TREE PROTECTION METHODS, ETC.).
 - THE LANDSCAPE CONTRACTOR IS RESPONSIBLE FOR DETERMINING PLANT QUANTITIES, PLANT QUANTITIES SHOWN ON LEGENDS AND CALLOUTS ARE FOR GENERAL INFORMATION ONLY. IN THE EVENT OF A DISCREPANCY BETWEEN THE PLAN AND THE PLANT LEGEND, THE PLANT QUANTITIES AS SHOWN ON THE PLAN FOR INDIVIDUAL SYMBOLS OR CALLOUT (FOR GROUNDCOVER PATTERNS) SHALL TAKE PRECEDENCE.
 - NO SUBSTITUTIONS OF PLANT MATERIALS SHALL BE ALLOWED WITHOUT THE WRITTEN PERMISSION OF THE LANDSCAPE ARCHITECT. IF SOME OF THE PLANTS ARE NOT AVAILABLE, THE LANDSCAPE CONTRACTOR SHALL NOTIFY THE LANDSCAPE ARCHITECT IN WRITING (VIA PROPER CHANNELS).
 - THE CONTRACTOR SHALL, AT A MINIMUM, PROVIDE REPRESENTATIVE PHOTOS OF ALL PLANTS PROPOSED FOR THE PROJECT. THE CONTRACTOR SHALL ALLOW THE LANDSCAPE ARCHITECT AND THE OWNER/OWNER'S REPRESENTATIVE TO INSPECT AND APPROVE OR REJECT ALL PLANTS DELIVERED TO THE JOBSITE. REFER TO SPECIFICATIONS FOR ADDITIONAL REQUIREMENTS FOR SUBMITTALS.
- THE CONTRACTOR SHALL MAINTAIN THE LANDSCAPE IN A HEALTHY CONDITION FOR 90 DAYS AFTER ACCEPTANCE BY THE OWNER. REFER TO SPECIFICATIONS FOR CONDITIONS OF ACCEPTANCE FOR THE START OF THE MAINTENANCE PERIOD, AND FOR FINAL ACCEPTANCE AT THE END OF THE MAINTENANCE PERIOD.
- SEE SPECIFICATIONS AND DETAILS FOR FURTHER REQUIREMENTS.

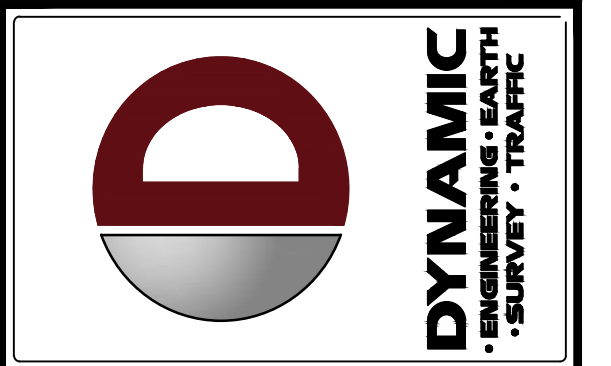

NO	DATE	REVISION	BY
1	07/29/20	AGENCY COMMENTS	
2	07/29/20	AGENCY COMMENTS	
3	07/29/20	AGENCY COMMENTS	

PROJECT: **PALM BEACH CHRISTIAN MISTRIES, INC.**
 TRACT 7
 S. HAVERHILL ROAD & NAUTICA ISLES BOULEVARD
 CITY OF GREENACRES
 PALM BEACH COUNTY, FLORIDA 33463

DESIGNED BY: _____
 CHECKED BY: _____
 DRAWN BY: _____

DYNAMIC ENGINEERING
 LAND DEVELOPMENT CONSULTING • PERMITTING
 GEOTECHNICAL • ENVIRONMENTAL
 TRAFFIC • SURVEY • PLANNING & ZONING

100 NE 5th Avenue, Suite B2
 Delray Beach, FL 33483
 T: 561.921.8570
 Offices conveniently located at:
 Lake County, New Jersey • 1.732.974.0119
 Chester, New Jersey • 1.908.879.0709
 Newark, New Jersey • 1.973.755.2000
 Torrance, New Jersey • 1.732.974.0119
 Henderson, Pennsylvania • 1.202.465.0010
 Apex, Texas • 1.972.842.0700
 New York, Texas • 2.361.799.6400
 Austin, Texas • 1.512.446.5446
 Disney World, Florida • 1.561.921.8070

Florida Certificate of Authorization No. 32335
www.dynamiccec.com

Kenneth D Bates
 0666672
 020009
 7165222
 -06'00"

SEAL OF THE STATE OF FLORIDA

811 PROTECT YOURSELF
 ALL STATES REQUIRE NOTIFICATION OF EXCAVATIONS, REDESIGNERS, OR ANY PERSON PREPARING TO DISTURB THE EARTH'S SURFACE. CALL 811 AT LEAST 48 HOURS BEFORE ANY EXCAVATION.
 FOR STATE SPECIFIC DIRECT PHONE NUMBERS VISIT: WWW.CALL811.COM

TITLE: **LANDSCAPE SPECS & NOTES**

SCALE: (H) (V)
 DATE: 03/26/2020
 PROJECT No: 3346-99-001
 SHEET No: **L1.01** Rev. #:

EVERGREEN DESIGN GROUP
 (800) 680-6630
 2255 Glades Road, Suite 324A
 Boca Raton, FL 33433
www.EvergreenDesignGroup.com
 LC #26000612

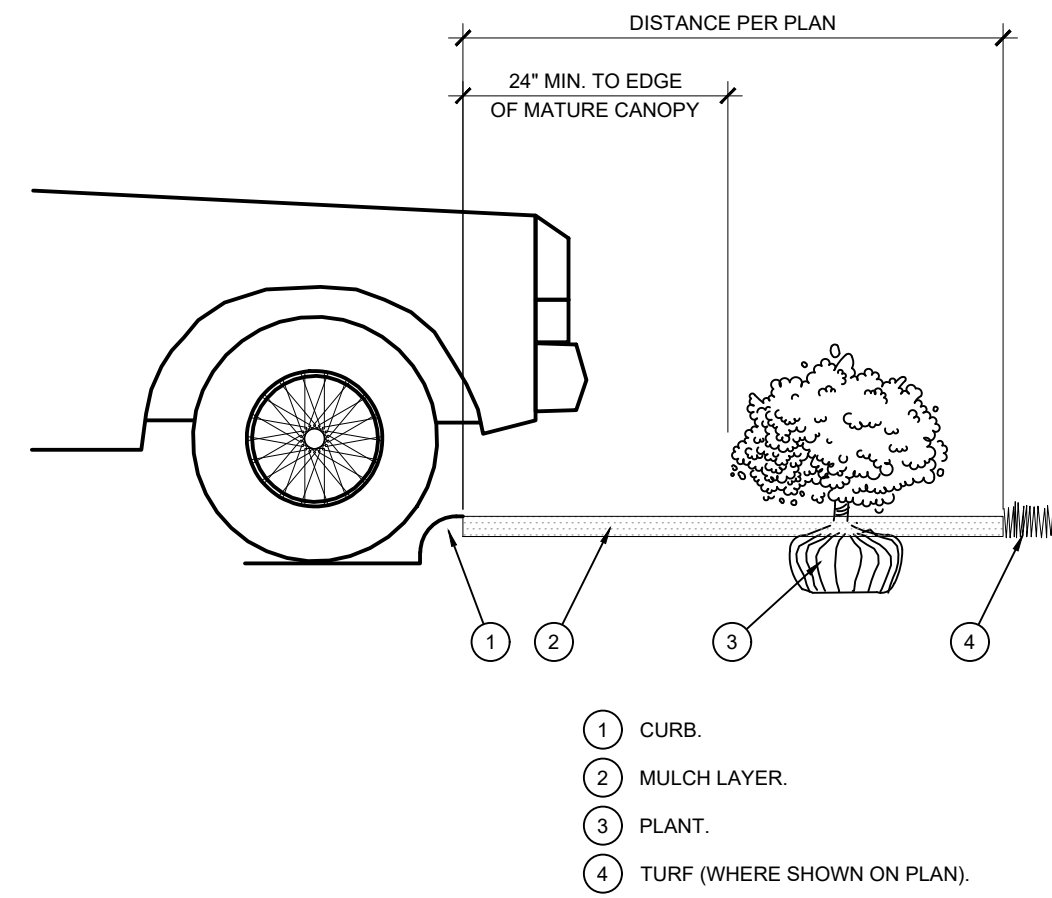

E PLANTING AT PARKING AREA
SCALE: NOT TO SCALE

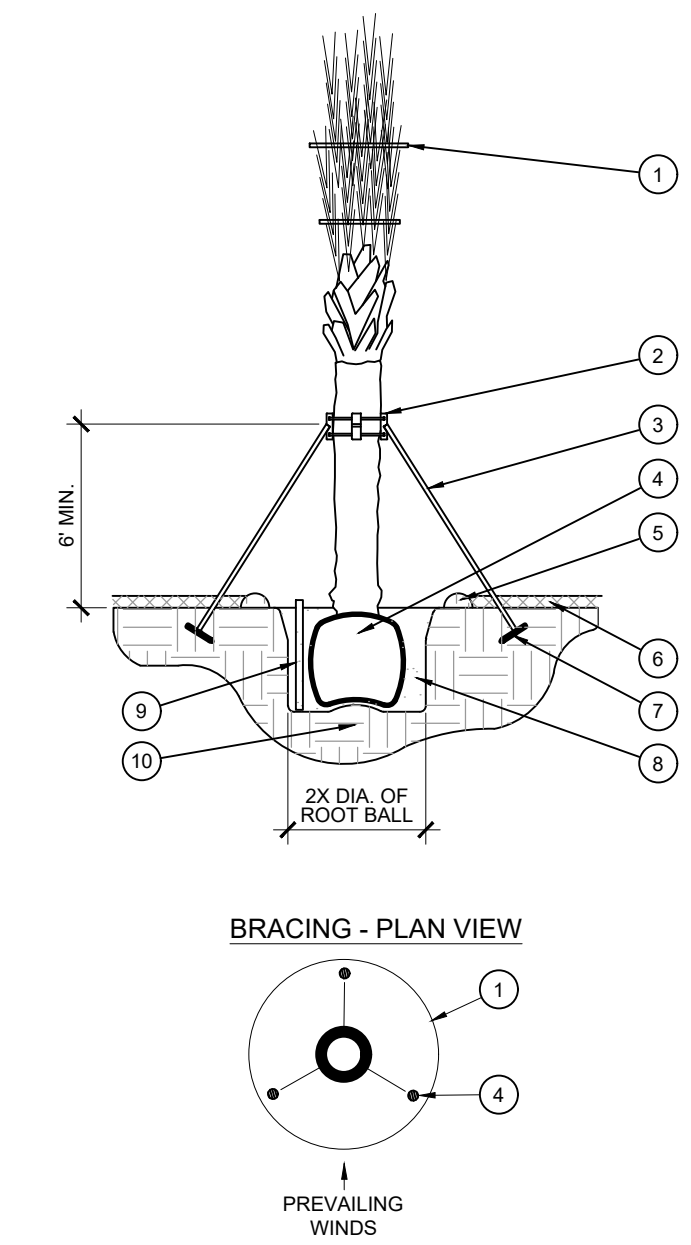

C PALM PLANTING
SCALE: NOT TO SCALE

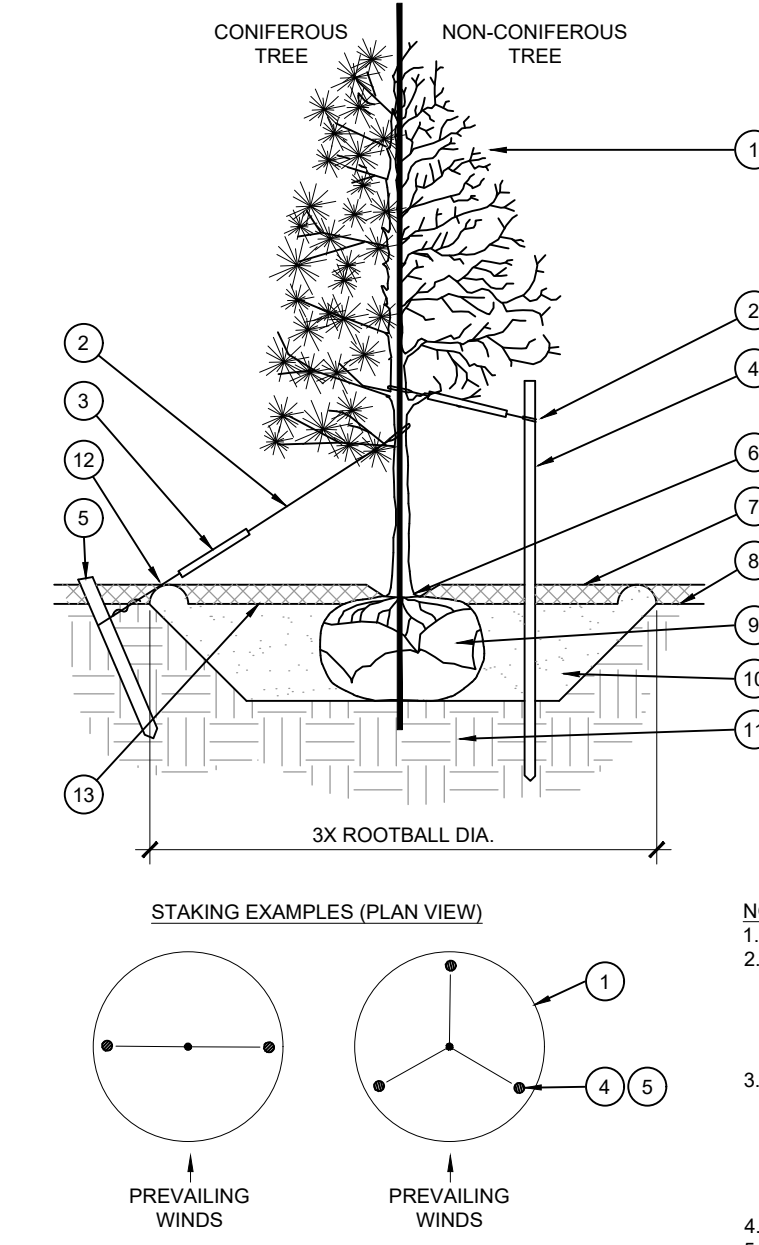

A TREE PLANTING
SCALE: NOT TO SCALE

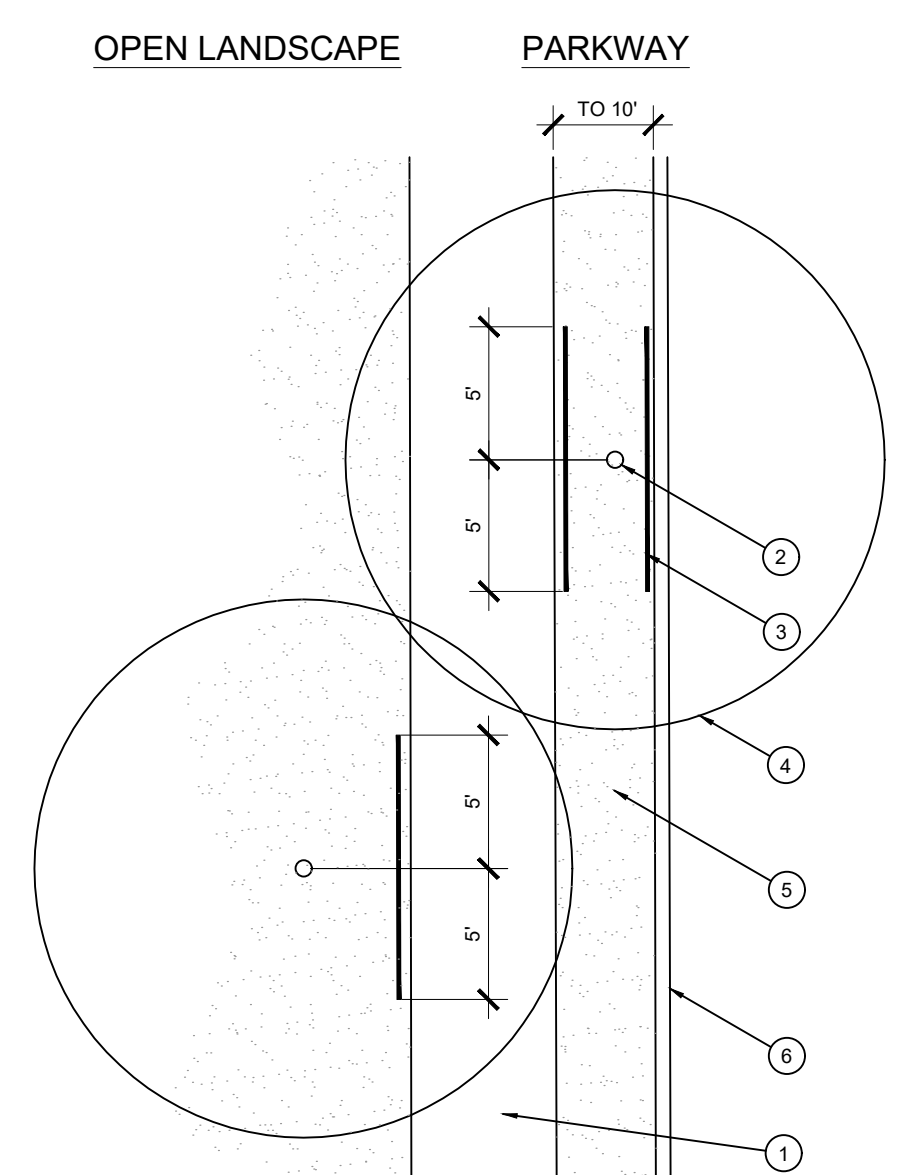

F ROOT BARRIER - PLAN VIEW
SCALE: NOT TO SCALE

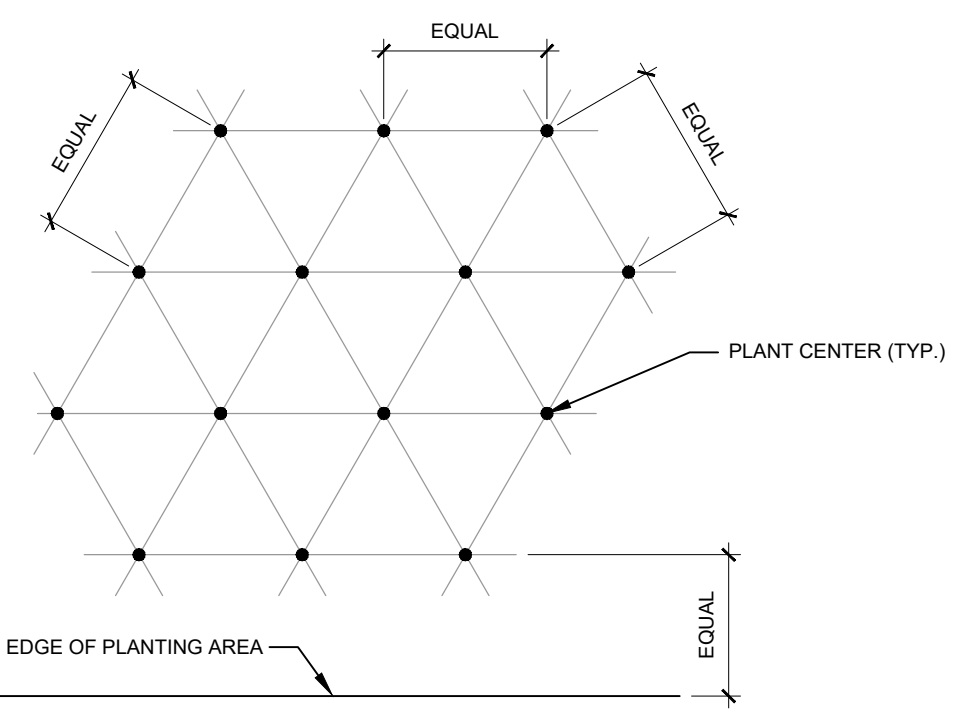

D PLANT SPACING
SCALE: NTS

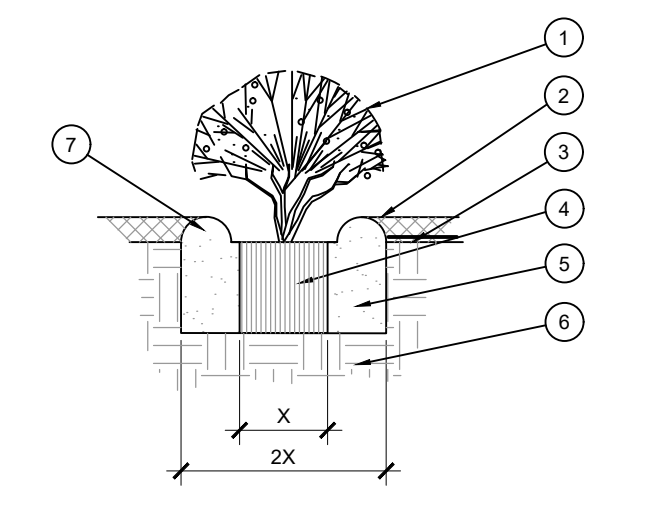

B SHRUB AND PERENNIAL PLANTING
SCALE: NTS

NOTE: ALL PLANTS SHALL BE PLANTED AT EQUAL TRIANGULAR SPACING (EXCEPT WHERE SHOWN ON PLANS AS INFORMAL GROUPINGS). REFER TO PLANT LEGEND FOR SPACING DISTANCE BETWEEN PLANTS.

1) STEP 1: DETERMINE TOTAL PLANTS FOR THE AREA WITH THE FOLLOWING FORMULA:
TOTAL AREA / AREA DIVIDER = TOTAL PLANTS

PLANT SPACING	AREA DIVIDER	PLANT SPACING	AREA DIVIDER
6"	0.22	18"	1.95
8"	0.39	24"	3.46
10"	0.60	30"	5.41
12"	0.87	36"	7.79
15"	1.35		

2) STEP 2: SUBTRACT THE ROW (S) OF PLANTS THAT WOULD OCCUR AT THE EDGE OF THE PLANTED AREA WITH THE FOLLOWING FORMULA: TOTAL PERIMETER LENGTH / PLANT SPACING = TOTAL PLANT SUBTRACTION

EXAMPLE: PLANTS AT 18" O.C. IN 100 SF PLANTING AREA, 40 LF PERIMETER
STEP 1: 100 SF/1.95 = 51 PLANTS
STEP 2: 51 PLANTS - (40 LF / 1.95 = 21 PLANTS) = 30 PLANTS TOTAL

- 1 TREE CANOPY.
 - 2 CRINCH-TIES (24" BOX/2" CAL. TREES AND SMALLER) OR 12 GAUGE GALVANIZED WIRE WITH NYLON TREE STRAPS AT TREE AND STAKE (36" BOX/2.5" CAL. TREES AND LARGER). SECURE TIES OR STRAPS TO TRUNK JUST ABOVE LOWEST MAJOR BRANCHES.
 - 3 24" X 3/4" P.V.C. MARKERS OVER WIRES.
 - 4 GREEN STEEL T-POSTS. EXTEND POSTS 12" MIN. INTO UNDISTURBED SOIL.
 - 5 PRESSURE-TREATED WOOD DEADMAN, TWO PER TREE (MIN.). BURY OUTSIDE OF PLANTING PIT AND 18" MIN. INTO UNDISTURBED SOIL.
 - 6 TRUNK FLARE.
 - 7 MULCH, TYPE AND DEPTH PER PLANS. DO NOT PLACE MULCH WITHIN 6" OF TRUNK.
 - 8 FINISH GRADE.
 - 9 ROOT BALL.
 - 10 BACKFILL. AMEND AND FERTILIZE ONLY AS RECOMMENDED IN SOIL FERTILITY ANALYSIS.
 - 11 UNDISTURBED NATIVE SOIL.
 - 12 4" HIGH EARTHEN WATERING BASIN.
 - 13 FINISH GRADE.
- NOTES:
- 1 SCARIFY SIDES OF PLANTING PIT PRIOR TO SETTING TREE.
 - 2 REMOVE EXCESS SOIL APPLIED ON TOP OF THE ROOTBALL THAT COVERS THE ROOT FLARE. THE PLANTING HOLE DEPTH SHALL BE SUCH THAT THE ROOTBALL RESTS ON UNDISTURBED SOIL, AND THE ROOT FLARE IS 2"-4" ABOVE FINISH GRADE.
 - 3 FOR BAB TREES: CUT OFF BOTTOM 1/3 OF WIRE BASKET BEFORE PLACING TREE IN HOLE. CUT OFF AND REMOVE REMAINDER OF BASKET AFTER TREE IS SET IN HOLE. REMOVE ALL NYLON TIES, TWINE, ROPE, AND OTHER PACKING MATERIAL. REMOVE AS MUCH BURLAP FROM AROUND ROOTBALL AS IS PRACTICAL.
 - 4 REMOVE ALL NURSERY STAKES AFTER PLANTING.
 - 5 FOR TREES 36" BOX/2.5" CAL. AND LARGER, USE THREE STAKES OR DEADMEN (AS APPROPRIATE), SPACED EVENLY AROUND TREE.
 - 6 STAKING SHALL BE TIGHT ENOUGH TO PREVENT TRUNK FROM BENDING, BUT LOOSE ENOUGH TO ALLOW SOME TRUNK MOVEMENT IN WIND.

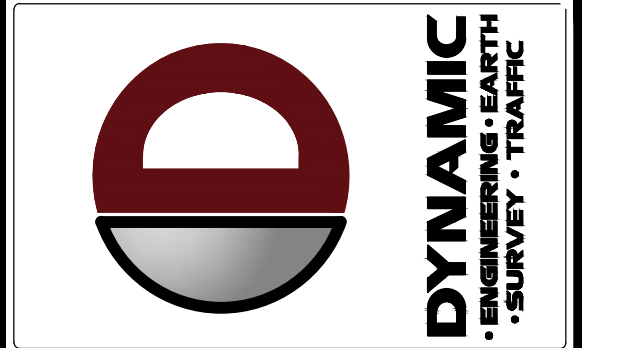

NO.	DATE	BY	COMMENTS
3	07/29/20	KAK	AGENCY COMMENTS
2	07/15/20	KAK	AGENCY COMMENTS
1	06/01/20	KAK	AGENCY COMMENTS

PROJECT: PALM BEACH CHRISTIAN MINISTRIES, INC.
PALM BEACH CHRISTIAN PREPARATORY SCHOOL
TRACT 7
S. HAVERHILL ROAD & NAUTICA ISLES BOULEVARD
CITY OF GREENACRES
PALM BEACH COUNTY, FLORIDA 33463

DYNAMIC ENGINEERING
LAND DEVELOPMENT CONSULTING • PERMITTING
GEOTECHNICAL • ENVIRONMENTAL
TRAFFIC • SURVEY • PLANNING & ZONING

100 NE 5th Avenue, Suite B2
Delray Beach, FL 33483
T: 561.921.8570

Offices conveniently located at:
Lakeland, FL • 888.888.8888
Orlando, FL • 407.921.8570
Tampa, FL • 813.921.8570
Fort Lauderdale, FL • 954.921.8570
Miami, FL • 305.921.8570
Jacksonville, FL • 904.921.8570
Delray Beach, FL • 561.921.8570

Florida Certificate of Authorization No. 32535
www.dynamicce.com

Kenneth D Bates
LA6666710
2020.09.17
7 16:51:55
-06'00"

811 PROTECT YOURSELF
ALL STATES REQUIRE NOTIFICATION OF EXCAVATORS, DESIGNERS, OR ANY PERSON PREPARING TO DISTURB THE EARTH'S SURFACE, UNLESS IN AN EMERGENCY.
FOR STATE SPECIFIC DIRECT PHONE NUMBERS VISIT: WWW.CALL811.COM

TITLE: **LANDSCAPE DETAILS**

SCALE: (H) DATE: 03/26/2020
(V)
PROJECT No: 3346-99-001

SHEET No: **L1.02** Rev. #:

EVERGREEN DESIGN GROUP
(800) 680-6630
2255 Glades Road, Suite 324A
Boca Raton, FL 33431
www.EvergreenDesignGroup.com
LC #26000612