

Publix #1244 - Snow Hill Village

5958 Snow Hill Road
Ooltewah, TN 37363
Lat 35.090, Long -85.064

FOR LEASE



1,419 - 3,773 SF & 4 OPS AVAILABLE

PROPERTY HIGHLIGHTS

- Publix-Anchored Center Located in Ooltewah, TN, Which is Projected for an Impressive Job Growth of Approximately 46 Percent Over the Next 10 Years
- Strategically Positioned as the Only Grocery-Anchored Center on the West Side of Interstate-75
- Located One Exit North of VW Assembly Plant (over 2,000 employees) and Amazon Distribution Center (2,500 employees)
- Four Outparcels Available for Ground Lease
- Combined Traffic Counts: 62,389 VPD

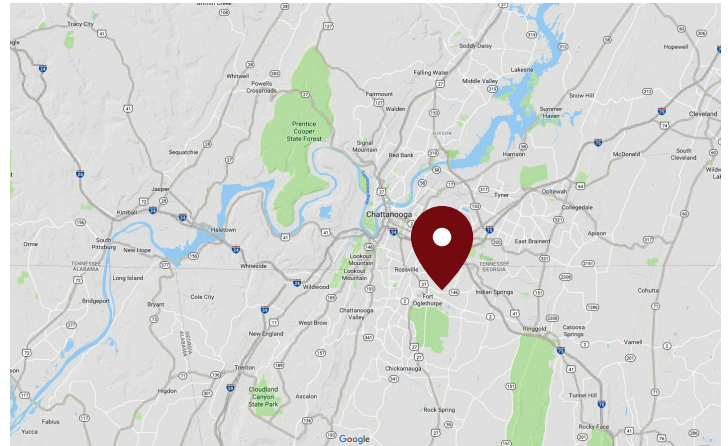

DEMOGRAPHICS	1 Mile	3 Miles	5 Miles
Total Population	1,178	23,374	51,325
Daytime Population	3,344	21,697	50,951
Total Households	448	8,092	18,130
Avg. HH Income	\$271,249	\$98,827	\$99,060

Data provided by Placer Labs Inc. (www.placer.ai) & Esri

Melody Holley

Office: 770.541.0881 | Cell: 678.414.8989 | mholley@crossmanco.com
6400 Powers Ferry Road, Suite 300, Atlanta, GA

Licensed Real Estate Broker. No warranty expressed or implied has been made to the accuracy of the information provided herein, no liability assumed for error or omission.



www.crossmanco.com

Publix #1244 - Snow Hill Village

5958 Snow Hill Road
Ooltewah, TN 37363
Lat 35.090, Long -85.064

SITE PLAN

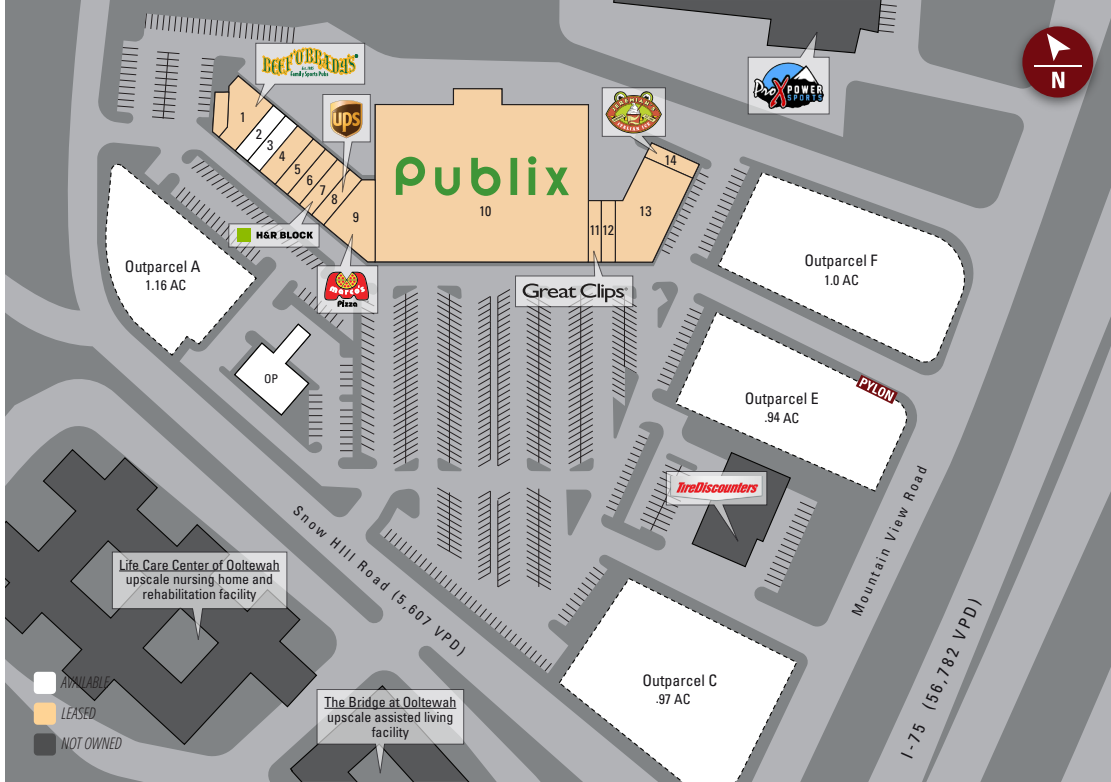

Suite	Tenant	Size
10	Publix	54,340
1	Beef O' Brady's	3,548
2	AVAILABLE	1,643
3	AVAILABLE	1,419
4	Dr. Hammontree	2,760
5	Edward D. Jones & Co.	1,218
6	Ooltewah Vision Center	1,377
7	H&R Block	1,332
8	UPS Store	1,193
9	Marco's Pizza	2,355
11	Great Clips	1,301
12	Unique Nails	1,290
13	Snow Hill Wine & Spirits	7,008
14	Jeremiah's Italian Ice	1,551
OP A	AVAILABLE	1.16 Acres
OP B	AVAILABLE	3,773
OP C	AVAILABLE	0.97 Acres
OP E	AVAILABLE	0.94 Acres
OP F	AVAILABLE	1.0 Acres

TOTAL 82,335



Melody Holley

Office: 770.541.0881 | Cell: 678.414.8989 | mholley@crossmanco.com
6400 Powers Ferry Road, Suite 300, Atlanta, GA

Licensed Real Estate Broker. No warranty expressed or implied has been made to the accuracy of the information provided herein, no liability assumed for error or omission.



www.crossmanco.com

Publix #1244 - Snow Hill Village

5958 Snow Hill Road
Ooltewah, TN 37363
Lat 35.090, Long -85.064

FOOT TRAFFIC OVERVIEW

EST. # OF CUSTOMERS ANNUALLY

 **178,600**

EST. # OF VISITS ANNUALLY

 **1.1 Million**

AVG. VISITS / CUSTOMER

 **6.24**

AVG. LENGTH-OF-STAY / VISIT

 **49 MIN**

TOP 3 DAYS



Friday	177,503
Sunday	177,094
Saturday	170,100

OF VISITS

TOP 3 HOURS



5-6 PM	211,633
4-5 PM	198,214
6-7 PM	195,896

OF VISITS

Data provided by Placer Labs Inc. (www.placer.ai) April 1, 2021 - March 31, 2022

SITE VISIT DENSITY

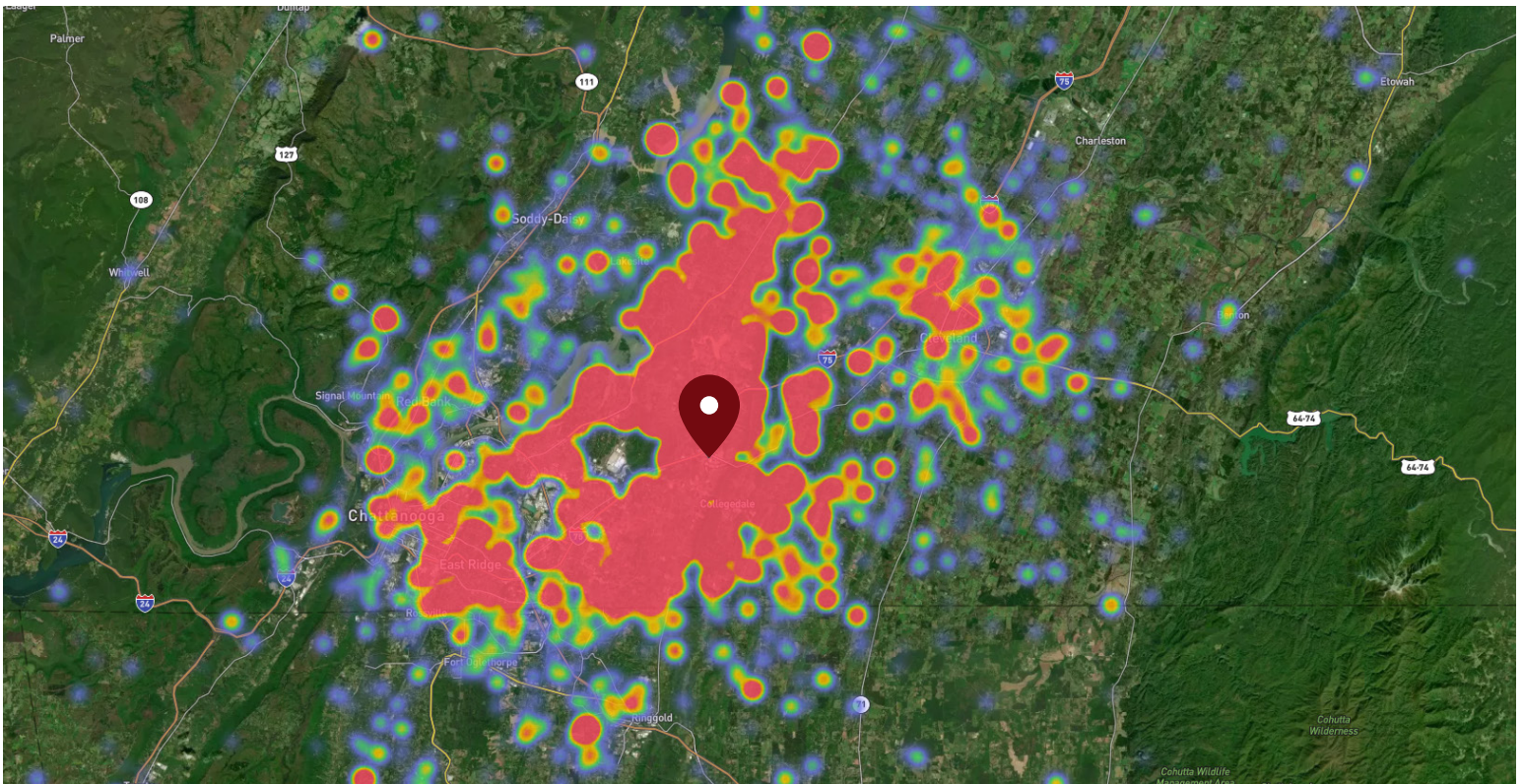

Red, orange, and yellow colors represent the location of 60% of site visitors

Data provided by Placer Labs Inc. (www.placer.ai)

Melody Holley

Office: **770.541.0881** | Cell: **678.414.8989** | mholley@crossmanco.com
6400 Powers Ferry Road, Suite 300, Atlanta, GA

Licensed Real Estate Broker. No warranty expressed or implied has been made to the accuracy of the information provided herein, no liability assumed for error or omission.



Crossman & Company

www.crossmanco.com