

DATE: 10/11/21 by: [Signature] City Engineer

PERMIT NO. ENG2021-10838

ADDRESS: 5326 INTERNATIONAL DR Orlando FL

CONTRACTOR: JON LITTON

NOTE: Permit issuance does not grant permission to violate applicable codes. Keep this plan on-site at all times.

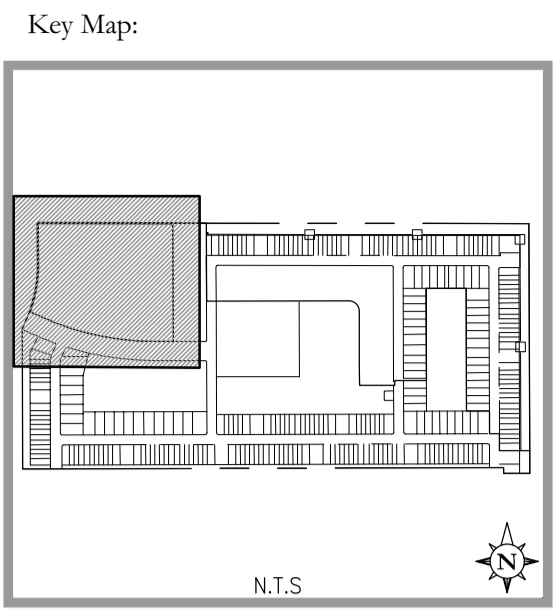
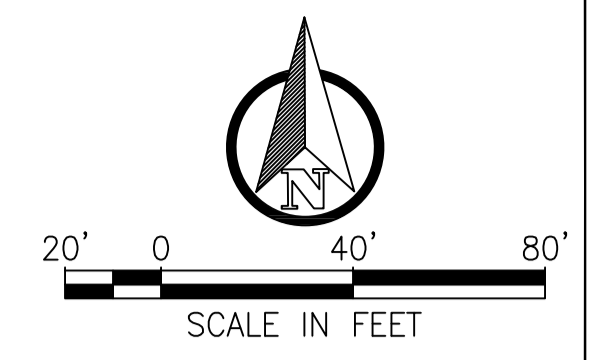

Consultant:

05/08/2021	REV PER CITY OF ORLANDO
04/07/21/2021	REV PER CITY OF ORLANDO
03/06/03/2021	REV PER CITY OF ORLANDO
02/05/18/2021	REV PER OUC
01/05/06/2021	REV PER OCU
00/03/29/2021	SUBMIT TO CITY, OUC, & OCU
NO. DATE:	DISCUSSIONS
SUBMISSIONS/REVISIONS	
VERTICAL DATUM:	NAVD 88
JOB NO.:	19-060
DESIGNED BY:	DM
DRAWN BY:	DM
CHECKED BY:	DAL
APPROVED BY:	DAL
SCALE IN FEET:	1" = 50'

INTERNATIONAL DRIVE RESORT COMMUNITY - PHASE 2

Jurisdiction: CITY OF ORLANDO, FL

GRADING & DRAINAGE PLAN

Sheet No.: C4.00

Seal:

Darin A Lockwood
DATE: August 20, 2021

Darin A Lockwood
Digitally signed by Darin A Lockwood
DN: cn=Darin A Lockwood, o=Poulos & Bennett, ou=Professional Engineer, email=Darin.A.Lockwood@poulosandbennett.com, c=US



Poulos & Bennett, LLC
2602 E. Livingston St., Orlando, FL 32803
Tel. 407.487.2594 www.poulosandbennett.com
Eng. Bus. No. 28567

Z:\2019\19-060 LENNAR - INTERNATIONAL DRIVE CAD\FINAL\CITY PHASE 2\19060-PH2-GDP

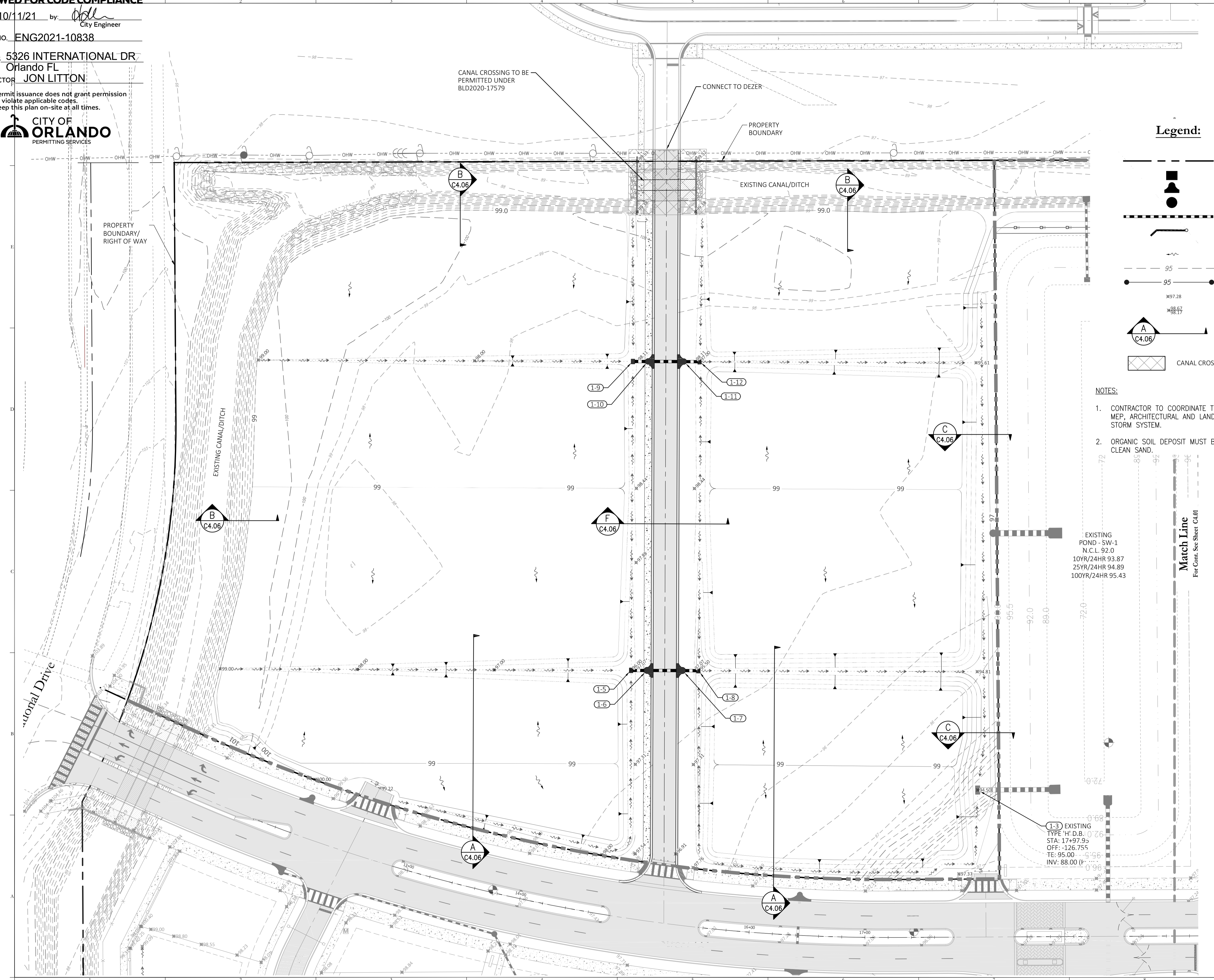

Legend:

- PROPERTY LINE
- PROPOSED D.B.I. STRUCTURES
- PROPOSED CURB INLET STRUCTURES
- PROPOSED MANHOLE STRUCTURES
- PROPOSED STORMWATER RCP PIPES
- PROPOSED STORMWATER PVC PIPES AND CLEANOUTS
- FLOW ARROW
- EXISTING GRADING CONTOURS
- PROPOSED GRADING CONTOURS
- PROPOSED GRADING SPOTS
- PROPOSED TOP OF CURB
- PROPOSED BOTTOM OF CURB
- GRADING SECTION
- CANAL CROSSING TO BE PERMITTED UNDER BLD2020-1759

NOTES:

- CONTRACTOR TO COORDINATE THE LOCATION OF THE A/C PADS WITH MEP, ARCHITECTURAL AND LANDSCAPE PLANS TO AVOID CONFLICT WITH STORM SYSTEM.
- ORGANIC SOIL DEPOSIT MUST BE EXCAVATED AND REPLACED WITH CLEAN SAND.

EXISTING POND - SW-1
N.C.L. 92.0
10YR/24HR 93.87
25YR/24HR 94.89
100YR/24HR 95.43

Match Line
For Cont. See Sheet C4.01

1-3 EXISTING TYPE 'H' D.B. STA: 17+97.9 OFF: -126.755 TE: 95.00 INV: 88.00