

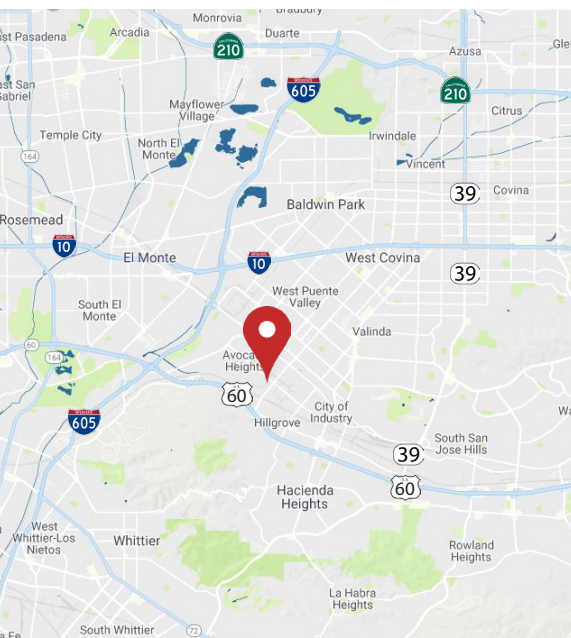

WESTERN INDUSTRY WAREHOUSE/MANUFACTURING BUILDING

14438

DON JULIAN ROAD
INDUSTRY | CA



FOR LEASE 62,680 SF

INDUSTRIAL BUILDING



± 62,680
AVAILABLE SF



± 14,500
OFFICE SF



4
DOCK HIGH
DOOR



24'
CLEAR HEIGHT

FEATURES:

- Extensive Well Designed Office Build-out
- Office 13,985 SF
- Fully Secure Building
- Zoning: M1
- Two GL Doors
- Lot Size: 235,224 Sf (5.40 AC)
- Parking: 77 Spaces (Ratio:1.2:1)
- Clear Height: 24'
- Power: 800A | 277-480V 3P-4W

FOR MORE INFORMATION PLEASE CONTACT:

NATHAN LARA
562.692.5983
njlara@daumcre.com | BRE #01923385

RUDY LARA | SIOR
714.273.6515
rlara@daumcre.com | BRE #00833860

ANDREW LARA
310.538.6744
alara@daumcre.com | BRE #01820297

Although all information is furnished regarding for sale, rental or financing is from sources deemed reliable, such information has not been verified and no express representation is made nor is any to be implied as to the accuracy thereof, and it is submitted subject to errors, omissions, changes of price, rental or other conditions, prior sale, lease or financing, or withdrawal without notice. All maps courtesy of Google Maps, Bing, and Google Earth. D/AQ Corp. # 01129558

DAUM
COMMERCIAL REAL ESTATE SERVICES

LARA TEAM
www.lara-team.com

14438

DON JULIAN ROAD
INDUSTRY | CA



SUBJECT PROPERTY

17.8 MILES FROM
DTLA

60

S 6th Ave.

Don Julian Rd.

FOR MORE INFORMATION PLEASE CONTACT:

NATHAN LARA
562.692.5983
jlara@daumcre.com
BRE #01923385

RUDY LARA | SIOR
714.273.6515
rlara@daumcre.com
BRE #00833860

ANDREW LARA
310.538.6744
alara@daumcre.com
BRE #01820297

Although all information is furnished regarding for sale, rental or financing is from sources deemed reliable, such information has not been verified and no express representation is made nor is any to be implied as to the accuracy thereof, and it is submitted subject to errors, omissions, changes of price, rental or other conditions, prior sale, lease or financing, or withdrawal without notice. All maps courtesy of Google Maps, Bing, and Google Earth. D/AQ Corp. # 01129558

DAUM
COMMERCIAL REAL ESTATE SERVICES

LARA TEAM
www.lara-team.com



14438 DON JULIAN ROAD INDUSTRY | CA

SITE PLAN

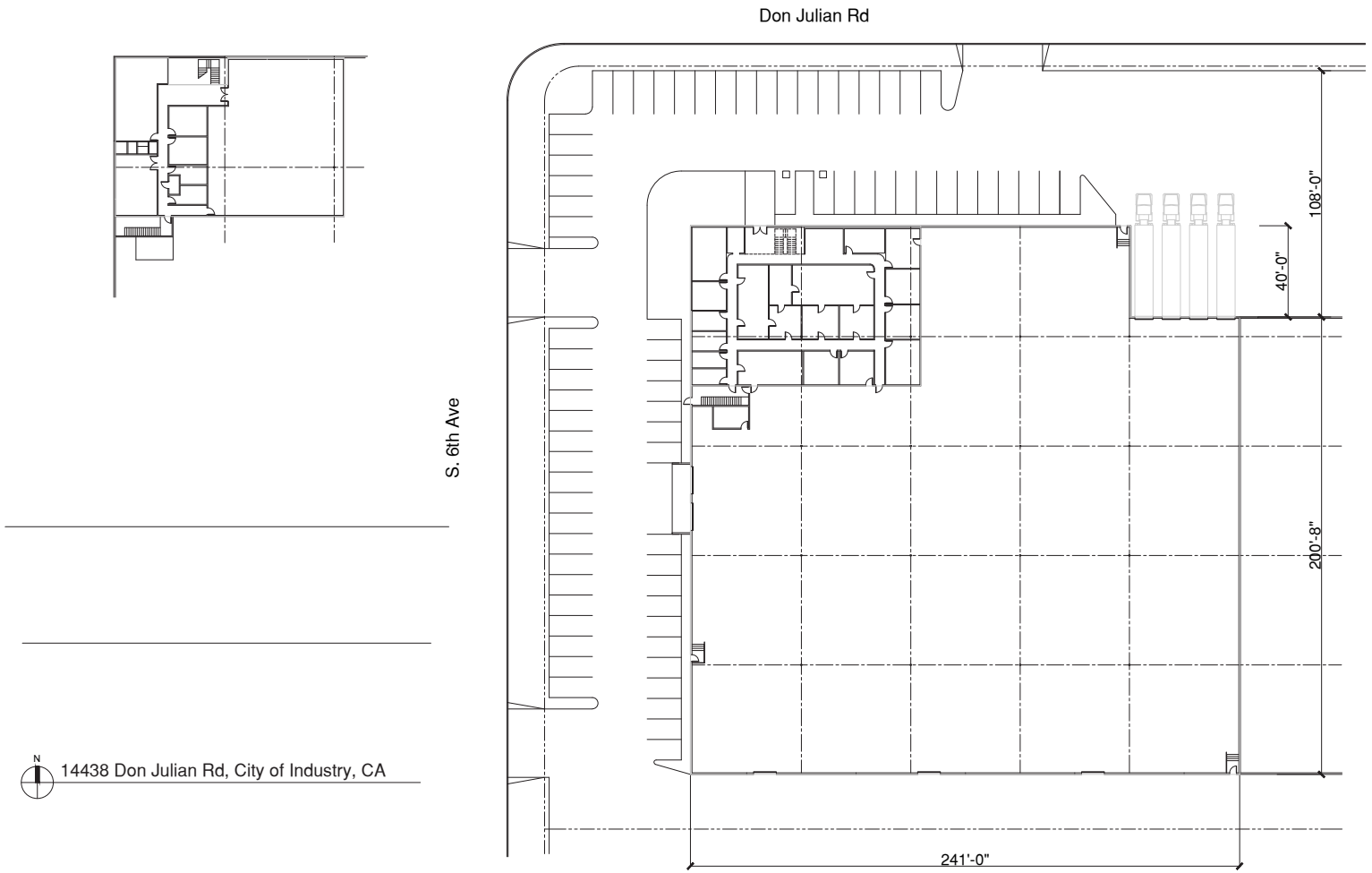

N 14438 Don Julian Rd, City of Industry, CA

FOR MORE INFORMATION PLEASE CONTACT:

NATHAN LARA
562.692.5983
jlara@daumcre.com
BRE #01923385

RUDY LARA | SIOR
714.273.6515
rlara@daumcre.com
BRE #00833860

ANDREW LARA
310.538.6744
alara@daumcre.com
BRE #01820297

Although all information is furnished regarding for sale, rental or financing is from sources deemed reliable, such information has not been verified and no express representation is made nor is any to be implied as to the accuracy thereof, and it is submitted subject to errors, omissions, changes of price, rental or other conditions, prior sale, lease or financing, or withdrawal without notice. All maps courtesy of Google Maps, Bing, and Google Earth. D/AQ Corp. # 01129558

