

APPALACHIAN COMMUNITY BANK

"COMMUNITY ROOM"

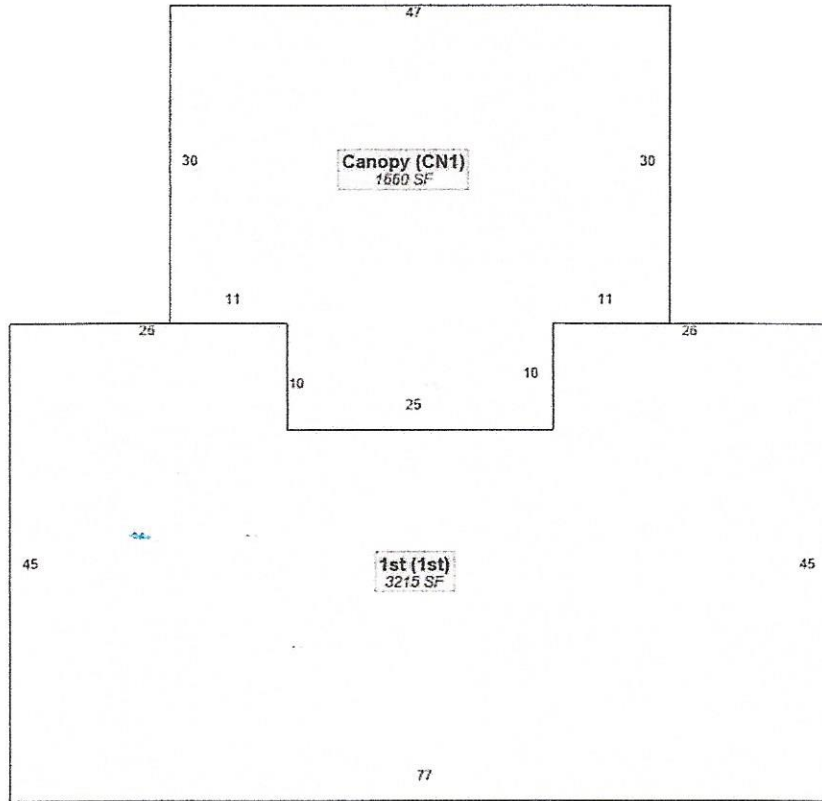

No data available for the following modules: Rural Land, Conservation Use Rural Land, Residential Improvement Information, Mobile Homes, Prebill Mobile Homes, Permits.

The Fannin County Assessor makes every effort to produce the most accurate information possible. No warranties, expressed or implied are provided for the data herein, its use or interpretation. The assessment information is from the last certified tax roll. All other data is subject to change.

Last Data Upload: 6/29/2017 3:10:44 PM



Developed by  
The Schneider  
Corporation