

CONCEPT PLANS FOR KEYSTONE EMPLOYMENT & ECONOMIC PLAN

POTTSTOWN BOROUGH & WEST POTTS GROVE TOWNSHIP - MONTGOMERY COUNTY - PENNSYLVANIA

PREPARED FOR: POTTSTOWN AREA INDUSTRIAL DEVELOPMENT
152 EAST HIGH STREET
SUITE 360, POTTSTOWN PA 19464

PREPARED BY: BURSICH ASSOCIATES, INC.
2129 EAST HIGH STREET
POTTSTOWN, PENNSYLVANIA 19464

JUNE 19, 2017

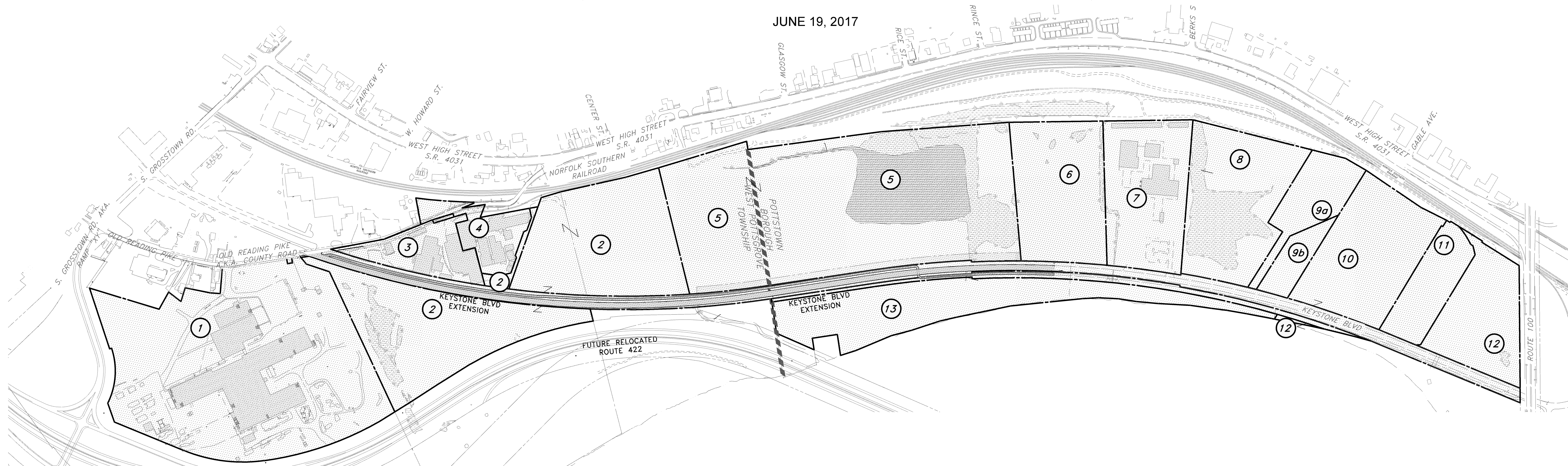

PROPERTY OWNERS

- 1 N/L 400 OLD READING PIKE INC.
PARCEL 640003826007
BLOCK 27 UNIT 1
DB 5391 PG 1121
- 2 N/L WEST POTTS GROVE INDUSTRIAL COMMONS LLC
BLOCK 27 UNIT 2
PARCEL 640003841001
DB 5677 PG 2740
- 3 N/L VARI CORP
BLOCK 27 UNIT 5
PARCEL 640003835007
DB 5606 PG 2827
- 4 N/L NORMAN W. & NANCY M. BARCLAY
BLOCK 27 UNIT 4
PARCEL 640003838004
DB 4859 PG 1850
- 5 N/L WEST POTTS GROVE INDUSTRIAL COMMONS, LLC
BLOCK 27 UNIT 29
PARCEL 640003840803
DB 5677 PG 2740
- 5 N/L POTTSTOWN INDUSTRIAL INVESTMENTS, LLC
BLOCK 58 UNIT 2; BLOCK 27 UNIT 34
PARCELS 160015352004 & 640002368016
DB 5677 PG 2743
- 6 N/L LANKFORD ACQUISITIONS COMPANY LP
BLOCK 58 UNIT 5
PARCEL 160015356009
DB 5960 PG 01743
- 7 N/L LANKFORD ACQUISITIONS COMPANY LP
BLOCK 58 UNIT 27
PARCEL 160015356018
DB 5870 PG 2375
- 8 N/L SMKOZ, LLC
BLOCK 58 UNIT 28
PARCEL 160015360014
DB 5698 PG 2947
- 9a N/L WELKIE AND MAACK, LLC
BLOCK 58 UNIT 29
PARCEL 160015360023 DB 5552 PG 1763
- 10 N/L THOMAS R. BIANCHINI AND MAXINE A. BIANCHINI
BLOCK 58 UNIT 7
PARCEL 160015364001
DB 4079 PG 470
- 11 N/L CONSTANTINE II LP
BLOCK 58 UNIT 8
PARCEL 160015368006
DB 5404 PG 1183
- 12 N/L CONSTANTINE II LP
BLOCK 58 UNIT 9
PARCEL 160015372002
DB 5404 PG 1186
- 13 N/L POTTSTOWN BOROUGH
BLOCK 58 UNIT 20
PARCEL 160015865004
DB 5318 PG 01600



SHEET LIST		
SHEET NUMBER	DRAWING NUMBER	SHEET TITLE
01	CO137360	TITLE SHEET
02	LO237360	CONCEPTUAL ROAD EXTENSION ALIGNMENT PLAN
03	LO337360	CONCEPTUAL ROAD EXTENSION ALIGNMENT PLAN
04	LO437360	CONCEPTUAL ROAD EXTENSION ALIGNMENT PLAN
05	LO537360	CONCEPTUAL ROAD EXTENSION ALIGNMENT PLAN
06	EF237360	EXISTING FEATURES & SITE ANALYSIS PLAN
07	EF337360	EXISTING FEATURES & SITE ANALYSIS PLAN
08	EF437360	EXISTING FEATURES & SITE ANALYSIS PLAN
09	EF537360	EXISTING FEATURES & SITE ANALYSIS PLAN
10	GR237360	CONCEPTUAL ROAD EXTENSION & SITE GRADING PLAN
11	GR337360	CONCEPTUAL ROAD EXTENSION & SITE GRADING PLAN
12	GR437360	CONCEPTUAL ROAD EXTENSION & SITE GRADING PLAN
13	GR537360	CONCEPTUAL ROAD EXTENSION & SITE GRADING PLAN
14	PR137360	PROFILE - KEYSTONE BOULEVARD EXTENSION
15	PR237360	PROFILE - KEYSTONE BOULEVARD EXTENSION
16	PR337360	PROFILE - KEYSTONE BOULEVARD EXTENSION
17	PR437360	PROFILE - KEYSTONE BOULEVARD EXTENSION



Stop - Call Before You Dig!
Pennsylvania Act 181 (2007) requires notification by excavators, designers, or any person preparing to disturb the earth's surface anywhere in the commonwealth
Pennsylvania One Call System, Inc.
811 or 1-800-242-1776

- REFERENCE DOCUMENTS:**
- ENVIRONMENTAL OVERVIEW FOR KEYSTONE EMPLOYMENT AND ECONOMIC PLAN (KEEP), PREPARED BY A.D. MARBLE, CONSHOHOCKEN, PA DATED AUGUST 2016.
 - ELECTRONIC AUTOCADD FILES OF PROGRESS DRAWINGS FOR SR 0422, SECTIONS M01 AND M02, PROVIDED BY JACOBS ENGINEERING GROUP, INC., PHILADELPHIA, PA, IN APRIL, 2016.

MANAGER SE	DESIGN KK	CHKD. BY	BURSICH Sharing your Vision		CLIENT POTTSTOWN AREA INDUSTRIAL DEVELOPMENT 152 EAST HIGH STREET SUITE 360 POTTSTOWN, PA 19464	SUBJECT KEYSTONE EMPLOYMENT AND ECONOMIC PLAN POTTSTOWN BOROUGH & WEST POTTS GROVE TOWNSHIP MONTGOMERY COUNTY, PENNSYLVANIA	JOB NO. 137360-01
DRAFT AK	FILE POT-01	DATE 6/19/17	Corporate Headquarters 2129 East High Street Pottstown, PA 19464 610-323-4040				SHEET NO. 01 OF 17
NOTES	SCALE	SCALE	Southampton Office 706 Lakeside Drive Southampton, PA 18966 215-364-2520				DWG. NO. CO137360
NO.	REVISION	DATE	BY				