



**FOR LEASE**

# Lincoln Business Park

Indianapolis, IN

## 7 Industrial buildings located on the East side of Indianapolis

### Property Highlights:

- Docks + drive-in loading
- Excellent interstate access
- Property under new ownership + management
- Multiple units & SF available

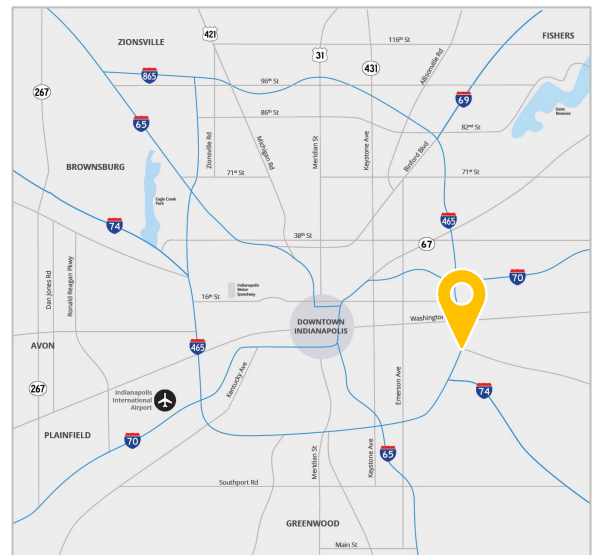

**Tony Hupp**  
+1 317 713 2116  
tony.hupp@colliers.com

**Ryan Kelly**  
+1 317 713 2118  
ryan.kelly@colliers.com

# Available Suite

1436 Sadlier Circle E

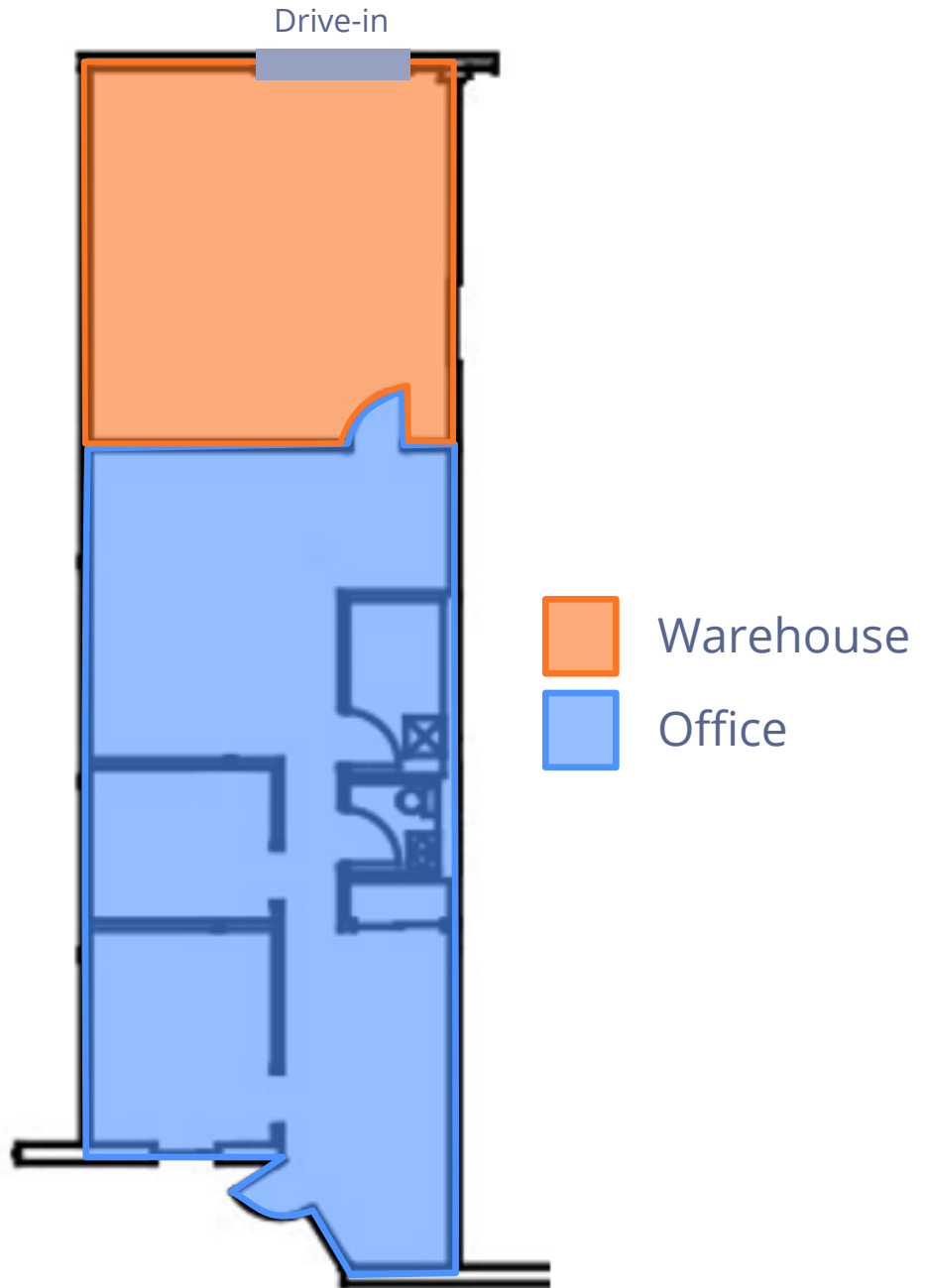

## LEASE AVAILABILITY

Suite	Available SF	Office SF	Clear Height	Docks	Drive-ins	Rate PSF	Features
1436	1,200	± 800	14'	0	1	\$11.00 IG	• Available

# Available Suite

1432 Sadlier Circle E

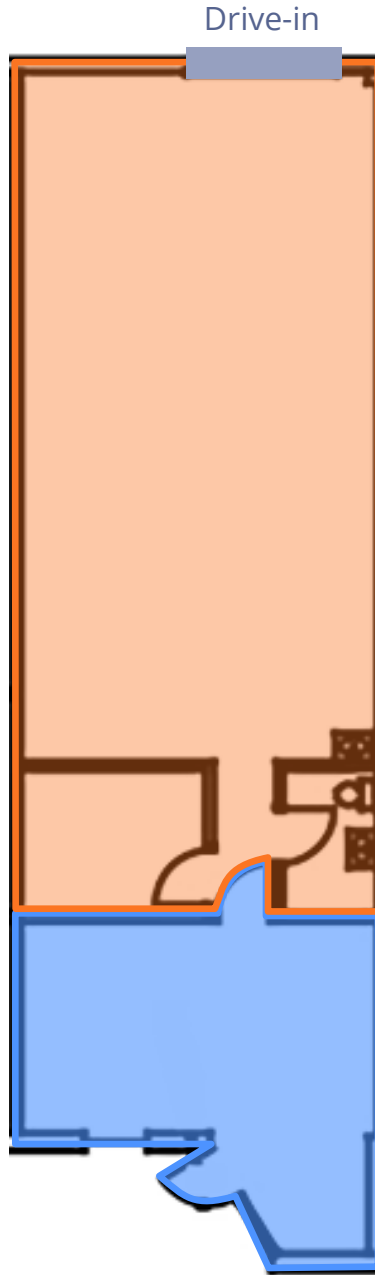

- Warehouse
- Office

## LEASE AVAILABILITY

Suite	Available SF	Office SF	Clear Height	Docks	Drive-ins	Rate PSF	Features
1432	1,200	± 500	14'	0	1	\$11.00 IG	• Available in 30 days

# Available Suite

1418 Sadlier Circle E

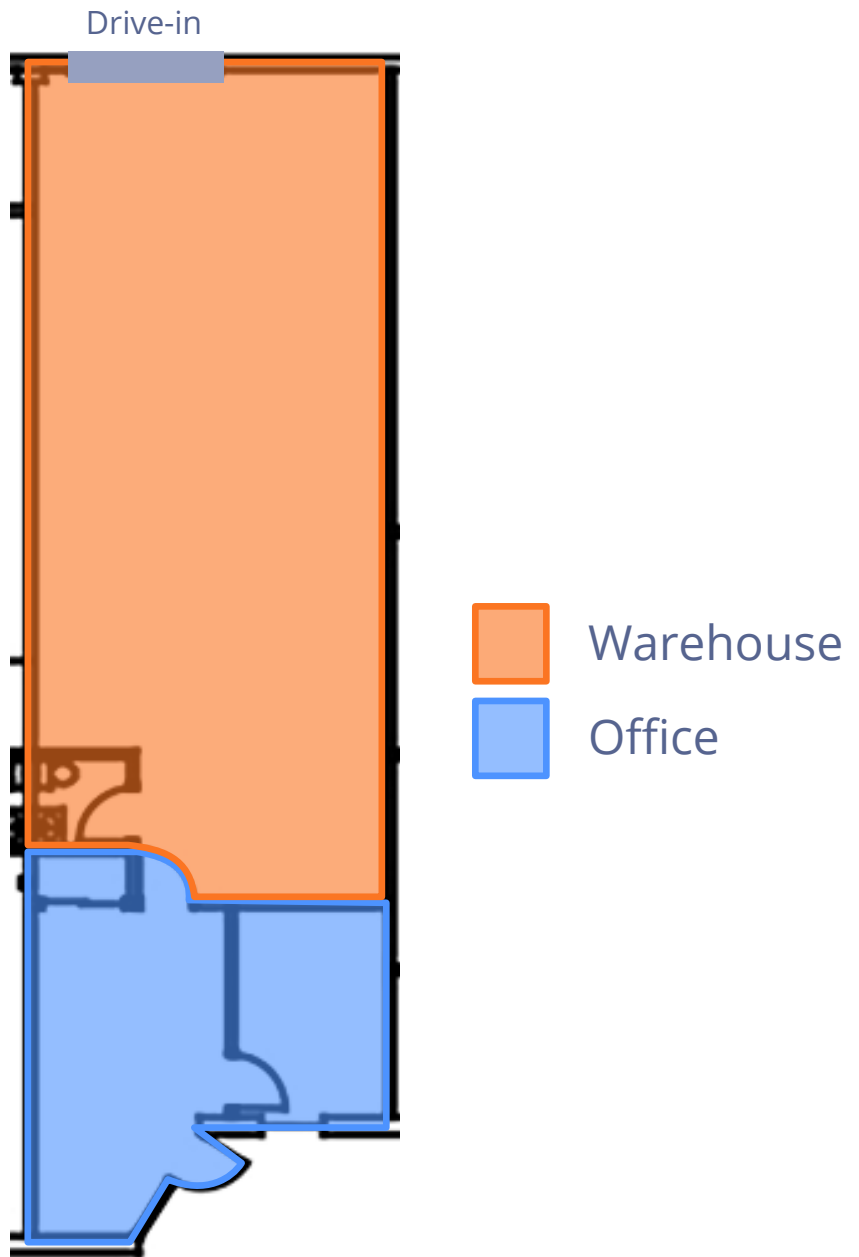

## LEASE AVAILABILITY

Suite	Available SF	Office SF	Clear Height	Docks	Drive-ins	Rate PSF	Features
1418	1,200	± 300	14'	0	1	\$11.00 IG	• Available

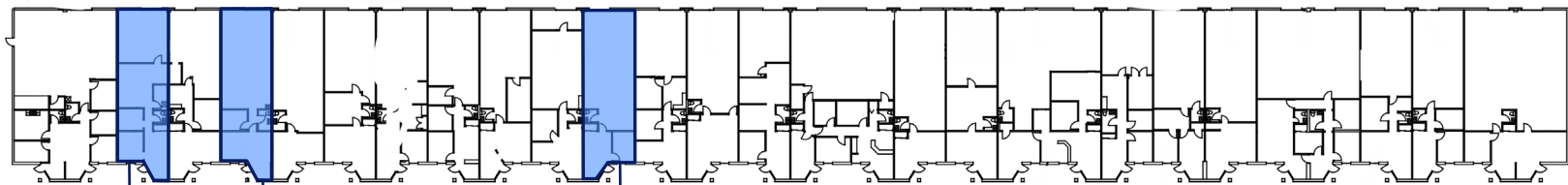

Suite 1436

Suite 1432

Suite 1418

### Lease Availability

Suite	Available SF	Office SF	Clear Height	Docks	Drive-ins	Rate PSF	Comments
1418	1,200	± 300	14'	0	1	\$11.00 IG	• Available
1432	1,200	± 500	14'	0	1	\$11.00 IG	• Available in 30 days
1436	1,200	± 800	14'	0	1	\$11.00 IG	• Available

# Why Indiana



## INDIANAPOLIS INT'L AIRPORT

- 2<sup>nd</sup> largest FedEx air hub worldwide
- Serves as FedEx's national aircraft maintenance operations
- 8<sup>th</sup> largest cargo airport in U.S
- 11<sup>th</sup> year named "Best Airport in North America"



## INDIANA AIRPORTS — LOGISTICS NETWORK

- Commercial/Freight users have 5 airports to access
- GCIA – a key economic driver in NW Indiana, awarded \$6M federal grant to expand/upgrade its air cargo infrastructure



- IND** Indianapolis Int'l Airport
- EW** Evansville Regional Airport
- FWA** Fort Wayne Int'l Airport
- GCIA** Gary/Chicago Int'l Airport
- SBN** South Bend Int'l Airport



## INDIANA ROADS — UNRIVALED CONNECTIVITY

- 8 interstates intersect the state making Indiana #1 in U.S. in pass-thru highways
- I-65 and I-70, both considered major NAFTA logistic corridors & part of the IFDC network (*Inland Freight Distribution Cluster*)
- 40+ major cities & 75% of U.S. population within 1-day drive
- 5<sup>th</sup> busiest state for commercial freight traffic



## INDIANA RAIL — A STRONG TRACK RECORD

- 3 Class 1 systems pass thru — CSXT, Canadian National, Norfolk Southern, plus 39 Class II & Class III railroads
- 4<sup>th</sup> in U.S. in number of railroads operating — 7<sup>th</sup> in carloads handled — 10<sup>th</sup> in millions of tons handled
- Indiana's freight traffic flow forecast to increase 60% by 2040
- Extensive transloading capabilities via privately-owned Indiana Rail Road Co., a 500-mile railroad logistics provider with national rail network access via Chicago/Indy gateways

“Over the last decade, Indiana has ranked as a Top-10 performer in landing corporate facility investment projects in the nation.”

– Site Selection Magazine

\*sources: Forbes Magazine, Site Selection Magazine, Business Facilities



## INDIANA PORTS — UNMATCHED ACCESS TO BIG INDUSTRY

- 3 international maritime ports provide global access to the world's most productive industrial & agricultural regions
- Bringing \$7.8B per year to Indiana's economy, handling over 25M tons of cargo yearly

- NW** Burns Harbor
- SE** Jeffersonville
- SW** Mt Vernon

**Tony Hupp**  
+1 317 713 2116  
tony.hupp@colliers.com

**Ryan Kelly**  
+1 317 713 2118  
ryan.kelly@colliers.com

**1<sup>st</sup>**  
in U.S. for manufacturing output

**1<sup>st</sup>**  
best state to start a business

**2<sup>nd</sup>**  
# Manufacturing Jobs (% of workforce)

**3<sup>rd</sup>**  
leading state in biotechnology exports