

NORTHWOOD COMMONS PROFESSIONAL OFFICES

2454 N McMullen Booth Rd., Clearwater, FL 33759

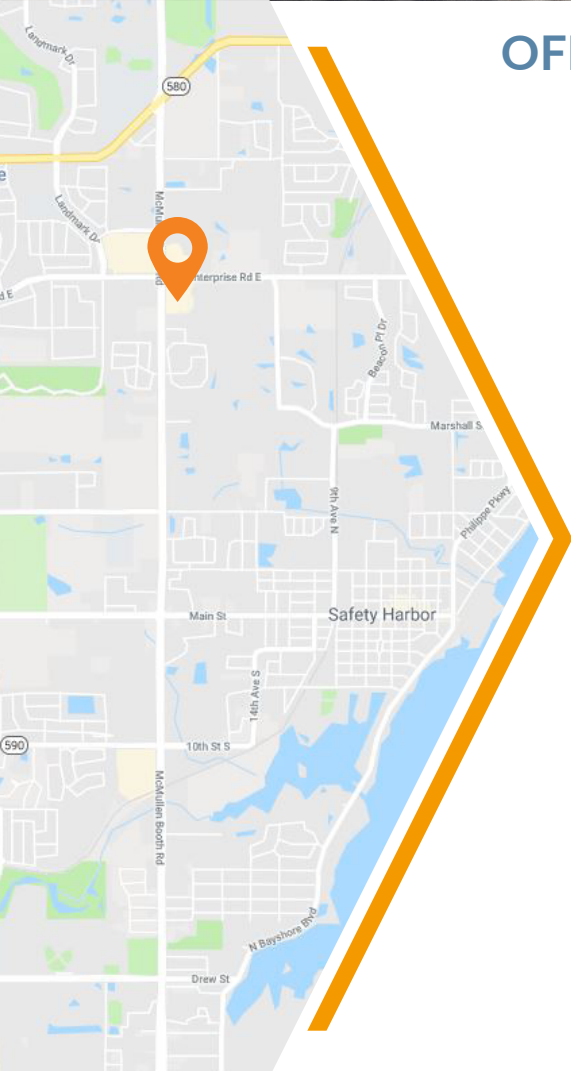

OFFICE SPACE AVAILABLE AT CLEARWATER'S MOST DESIRABLE INTERSECTION



- » 1,125 SF office available on 2nd floor
- » SEC McMullen Booth Road and Enterprise Road
- » Strategically located between SR 60 and SR 580
- » Two-story office building with natural creek views
- » Within close proximity to Bay Area airports
- » Parking Ratio: 4.3/1,000 SF
- » 24/7 access
- » Located in Countryside, near retail shops, services and restaurants
- » Convenient lunch break and after hours accessibility
- » Minutes from Mease Countryside Hospital

Leasing Contact: Wanda De Boer | Managing Director - Retail Services
(Cell) 813-690-3020 | (Office) 813-269-0702 | wdeboer@rpm-realty.com



NORTHWOOD COMMONS PROFESSIONAL OFFICES

2454 N McMullen Booth Rd., Clearwater, FL 33759

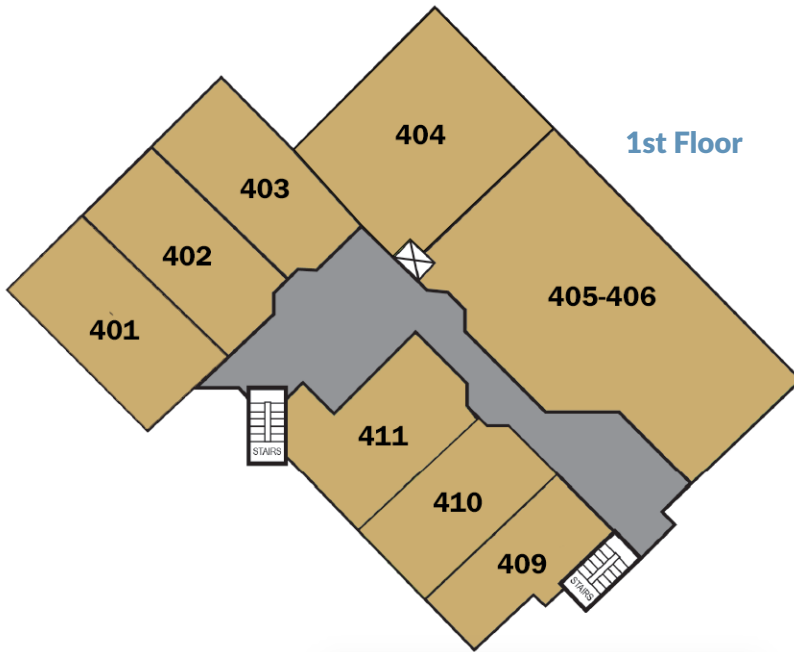

| SUITE | TENANT - 1st Floor |
|-------|-------------------------------|
| 401 | Martin Psychological Services |
| 402 | Ghaly Injury Law |
| 403 | R-Salon |
| 404 | VitalCaring |
| 409 | NES Water Metering |
| 410 | Cigna |
| 411 | JMC Brands |

| SUITE | TENANT - 2nd Floor |
|---------|---------------------------|
| 421/423 | Craig Duncan/State Farm |
| 424 | Clear Skin Dermatology |
| 429 | LightTree IT Services |
| 430 | 1,125 SF AVAILABLE |
| 431 | American Pension Services |

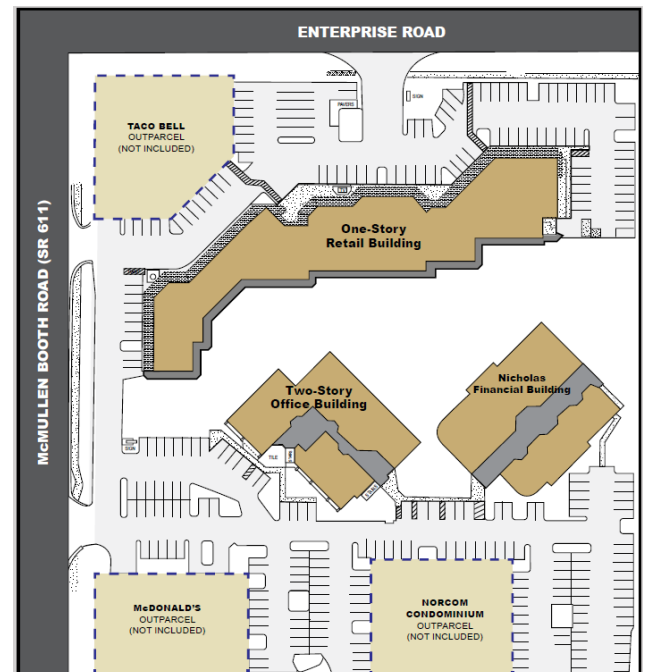

The information contained herein was obtained from sources believed reliable; however, RPM Realty Management, LLC makes no guarantees, warranties, or representations as to the completeness or accuracy thereof. The presentation of this property is submitted subject to errors, omissions, change of price or conditions prior to sale or lease, or withdrawal without notice.



NORTHWOOD COMMONS PROFESSIONAL OFFICES

2454 N McMullen Booth Rd., Clearwater, FL 33759

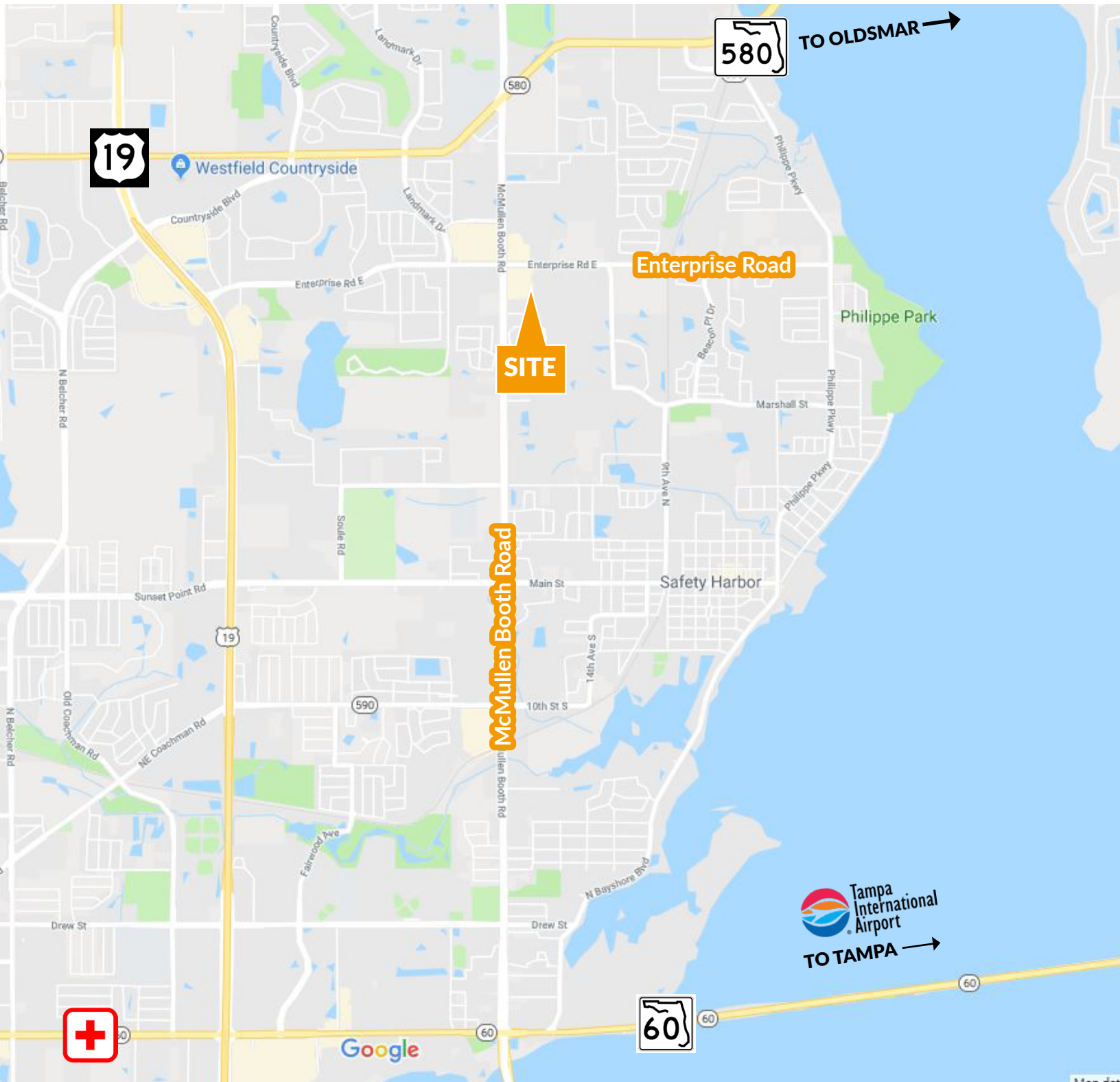

The information contained herein was obtained from sources believed reliable; however, RPM Realty Management, LLC makes no guarantees, warranties, or representations as to the completeness or accuracy thereof. The presentation of this property is submitted subject to errors, omissions, change of price or conditions prior to sale or lease, or withdrawal without notice.

