

INDUSTRIAL PROPERTY  
**FOR LEASE**

**635 LOWTHER ROAD**  
LEWISBERRY, PA 17339



**Daniel J. Alderman**  
dalderman@naicir.com | 717 761 5070

 1015 Mumma Road  
Lemoyne, PA 17043  
[circommercial.com](http://circommercial.com)

**NAICIR**

Information concerning this offering comes from sources deemed reliable, but no warranty is made as to the accuracy thereof, and it is submitted subject to errors, omissions, change of price or other conditions, prior sale or lease, or withdrawal without notice. All sizes approximate. PA License #RB024320A

# 635 LOWTHER ROAD

## PROPERTY DETAILS

# FOR LEASE

## \$11.00 SF/YR (NNN)

### OFFERING SUMMARY

Lease Rate	\$11.00 SF/yr (NNN)
Number of Units	1
Available SF	9,823 SF
Lot Size	6.13 Acres

### PROPERTY SUMMARY

Address	631-641 Lowther Road Lewisberry, PA 17339
Municipality	Fairview
County	York
Tax Parcel #	27-000-QG-0127-B0- 00000
Building Size	61,714 SF
Year Built	1972

### PROPERTY HIGHLIGHTS

- 9,823 SF flex space; 9,323 SF warehouse and 500 SF office
- Ample parking in front of building
- Great visibility with access to I-83
- Good mix of warehouse and office

### PROPERTY DESCRIPTION

Flex space suite for lease with dock, drive-in door, good parking, highway visibility, and access to I-83.

### LOCATION DESCRIPTION

Located in Fairview Township in York County.



### BUILDING INFORMATION

Construction	Masonry and metal
# of Floors	1
Restrooms	Two in each suite
HVAC	Gas and electric
Electrical Capacity	400 amps; 3 phase
Lighting	LED
Roof	Composition
Ceilings	12' - 14'11"
Ceiling Description	2x4 suspended acoustical tiles
Sprinklers	No
Walls	Block/drywall
Floor Type	Vinyl tile in office and paint over concrete in warehouse
Business ID Sign	Yes; visible to I-83

### UTILITIES & ZONING

Zoning	IB - Industrial Business
Zoning Description	Check zoning ordinance for a complete list of permitted uses.
Water & Sewer	Public

Daniel J. Alderman

dalderman@naicir.com | 717 761 5070

Information concerning this offering comes from sources deemed reliable, but no warranty is made as to the accuracy thereof, and it is submitted subject to errors, omissions, change of price or other conditions, prior sale or lease, or withdrawal without notice. All sizes approximate. PA License #RB024320A

1015 Mumma Road  
Lemoyne, PA 17043  
circommercial.com

# NAICIR

# 635 LOWTHER ROAD

## LEASE SPACES

# FOR LEASE

\$11.00 SF/YR (NNN)

### LEASE INFORMATION

<b>Lease Type:</b>	NNN	<b>Lease Term:</b>	36 months
<b>Total Space:</b>	9,823 SF	<b>Lease Rate:</b>	\$11.00 SF/yr

### AVAILABLE SPACES

SUITE	TENANT	SIZE (SF)	LEASE TYPE	LEASE RATE	DESCRIPTION
Suite 635A	Available	9,823 SF	NNN	\$11.00 SF/yr	Monthly payments - \$9,004.42 Annual rent - \$108,053.00 CAM - \$3.00/SF 1 dock and 1 drive-in door



**Daniel J. Alderman**  
dalderman@naicir.com | 717 761 5070

 1015 Mumma Road  
Lemoyne, PA 17043  
[circommercial.com](http://circommercial.com)

# NAICIR

Information concerning this offering comes from sources deemed reliable, but no warranty is made as to the accuracy thereof, and it is submitted subject to errors, omissions, change of price or other conditions, prior sale or lease, or withdrawal without notice. All sizes approximate. PA License #RB024320A

# 635 LOWTHER ROAD

## LEASE INFORMATION

# FOR LEASE

## \$11.00 SF/YR (NNN)

### LEASE INFORMATION

Monthly Payments	\$9,004.42
Annual Rent	\$108,053.00
Finish Allowance	As is
Lease Term	36 months
Options	Negotiable
Escalation	3% annually
Possession	Upon execution of lease contract
Building Hours	Negotiable
Security Deposit	Yes

### LANDLORD/TENANT RESPONSIBILITIES

Heat	T
Trash Removal	T
Insurance	T
Air Conditioning	T
HVAC Repairs	T
Interior Repairs	T
Water & Sewer	T
Supplies	T

Taxes	T
Electric	T
Janitorial	T
Structure Repairs	L
Parking Lot Maintenance	T
Light Bulbs	T
Plumbing Repairs	T
Roof Repairs	L

**Daniel J. Alderman**

dalderman@naicir.com | 717 761 5070

Information concerning this offering comes from sources deemed reliable, but no warranty is made as to the accuracy thereof, and it is submitted subject to errors, omissions, change of price or other conditions, prior sale or lease, or withdrawal without notice. All sizes approximate. PA License #RB024320A



1015 Mumma Road  
Lemoyne, PA 17043  
[circommercial.com](http://circommercial.com)

# NAICIR

# 631-641 LOWTHER ROAD

INTERIOR PHOTOS

# FOR LEASE

\$11 SF/YR (NNN)

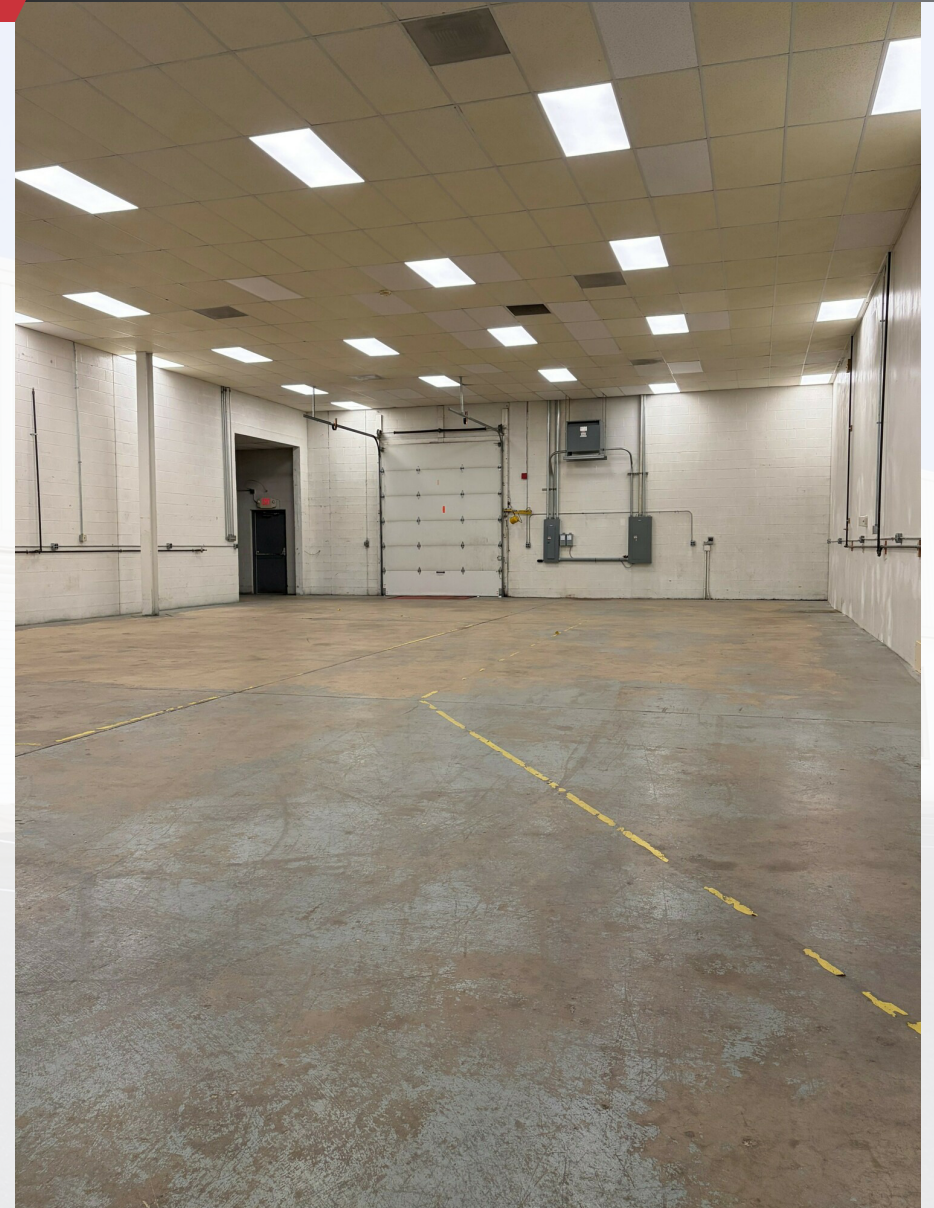

**Daniel J. Alderman**  
dalderman@naicir.com | 717 761 5070

Information concerning this offering comes from sources deemed reliable, but no warranty is made as to the accuracy thereof, and it is submitted subject to errors, omissions, change of price or other conditions, prior sale or lease, or withdrawal without notice. All sizes approximate. PA License #RB024320A

 1015 Mumma Road  
Lemoyne, PA 17043  
[circommercial.com](http://circommercial.com)

**NAICIR**

# 635 LOWTHER ROAD

FLOOR PLAN

# FOR LEASE

\$11.00 SF/YR (NNN)

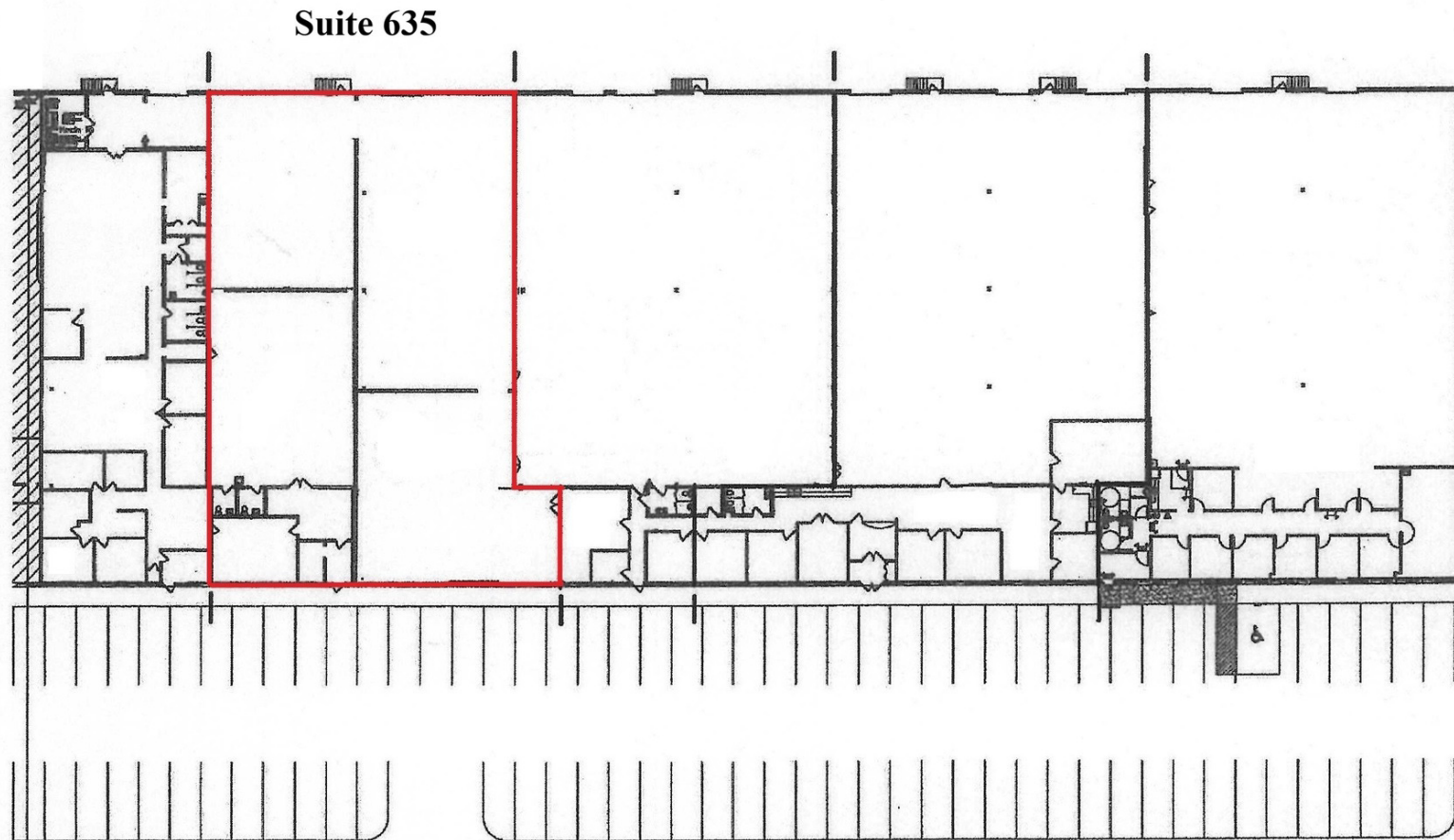

**Daniel J. Alderman**

dalderman@naicir.com | 717 761 5070



1015 Mumma Road  
Lemoyne, PA 17043  
circommercial.com

# NAICIR

Information concerning this offering comes from sources deemed reliable, but no warranty is made as to the accuracy thereof, and it is submitted subject to errors, omissions, change of price or other conditions, prior sale or lease, or withdrawal without notice. All sizes approximate. PA License #RB024320A

# 635 LOWTHER ROAD

LOCATION MAP

# FOR LEASE

\$11.00 SF/YR (NNN)



Daniel J. Alderman  
dalderman@naicir.com | 717 761 5070

Information concerning this offering comes from sources deemed reliable, but no warranty is made as to the accuracy thereof, and it is submitted subject to errors, omissions, change of price or other conditions, prior sale or lease, or withdrawal without notice. All sizes approximate. PA License #RB024320A

1015 Mumma Road  
Lemoyne, PA 17043  
circommercial.com



# 635 LOWTHER ROAD

## DEMOGRAPHICS

# FOR LEASE

## \$11.00 SF/YR (NNN)

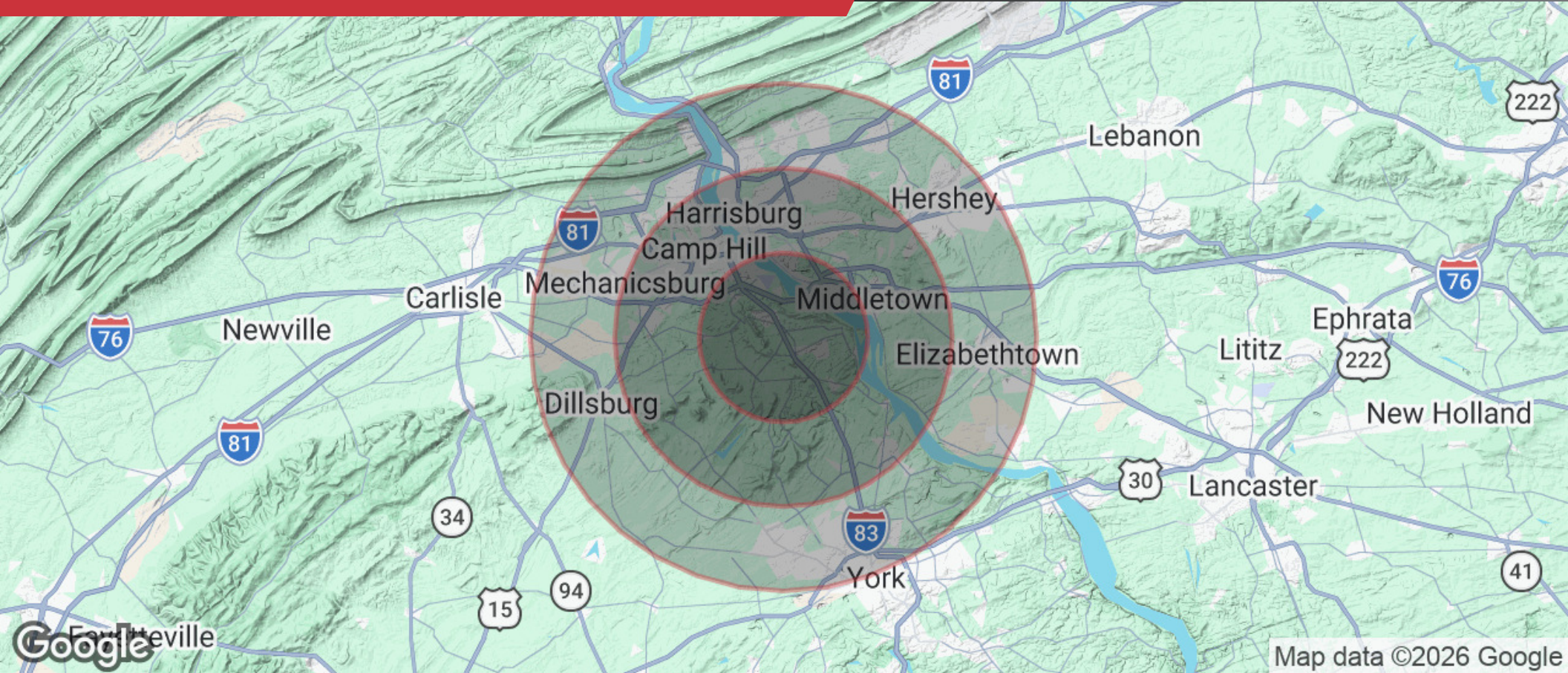

### POPULATION

5 MILES	10 MILES	15 MILES
48,002	345,488	632,176



### HOUSEHOLDS

5 MILES	10 MILES	15 MILES
19,490	138,232	252,337



### INCOME

5 MILES	10 MILES	15 MILES
\$107,316	\$103,036	\$106,784

Daniel J. Alderman

dalderman@naicir.com | 717 761 5070



1015 Mumma Road  
Lemoyne, PA 17043  
circommercial.com



Information concerning this offering comes from sources deemed reliable, but no warranty is made as to the accuracy thereof, and it is submitted subject to errors, omissions, change of price or other conditions, prior sale or lease, or withdrawal without notice. All sizes approximate. PA License #RB024320A