

FOR LEASE

+/- 39,114 SF

EXPANDABLE TO +/- 81,998 SF



940 COLUMBIA AVENUE, RIVERSIDE

Building Highlights

- > +/- 39,114 SF Industrial Warehouse Space
 - > Expandable to the Larger 81,998 SF Industrial Building
 - > +/- 8,100 SF two-story Office Space (4,165 1st Floor, 3,935 SF Mezzanine)
 - > Rare Crossdock Building in Presigious Hunter Park
 - > ESFR Fire Sprinkler System
 - > 28' Warehouse Clearance
 - > 6 DH Doors, 3 w/ Pit Levelers and 1/w Edge of Dock Levelers (unit A)
 - > 1 Drive in Grade Level Door
 - > Secured Concrete Truck Court
 - > 600 Amps of Power (separately metered)
 - > City of Riverside [Favorable Utility Rates](#)
 - > Easy Access to I-215, 60 and 91 Freeways
 - > High Profile Corporate Neighbors: Walmart, Nordstrom, Sabert Plastics, TM Cobb, Bourns, Cibarria & Evergreen
- * features to be independently verified*

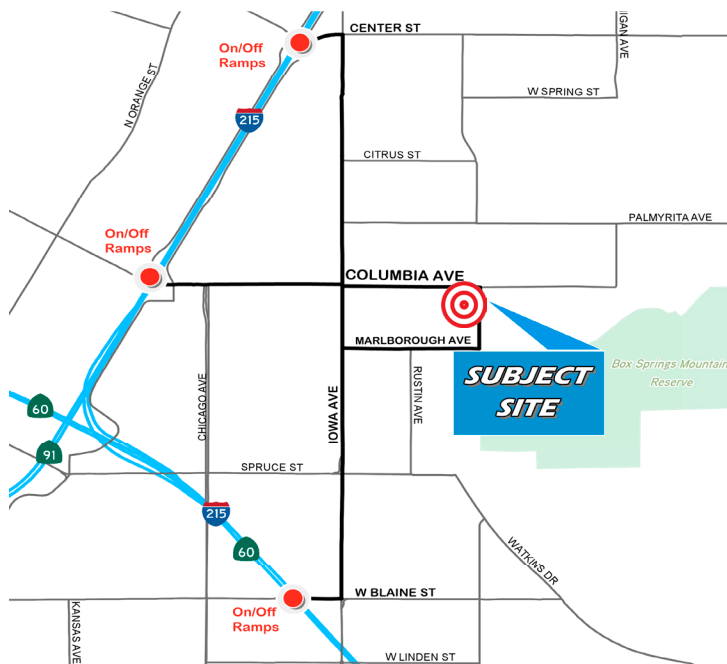

Listed by:

IAN DEVRIES, VICE CHAIRMAN
DRE # 01019686
949 724 5509
ian.devries@colliers.com

CHRIS DEVRIES, SIOR, EXECUTIVE VP
DRE # 01867314
949 724 5504
chris.devries@colliers.com

3 Park Plaza, Suite 1200 Irvine, CA 92614



940 COLUMBIA AVENUE, RIVERSIDE CA

+/- 39,114 SQUARE FEET FOR LEASE

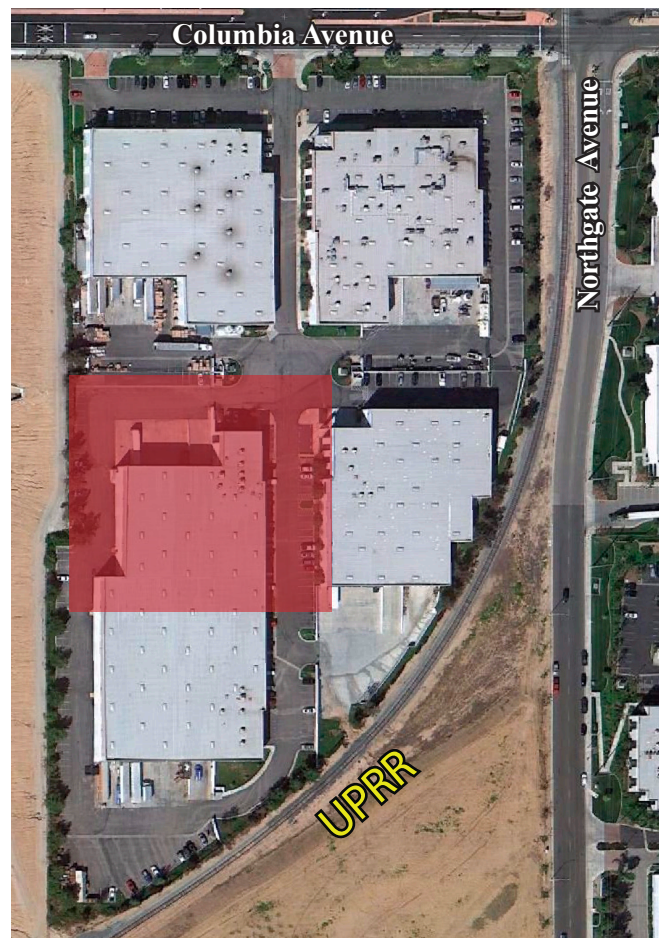
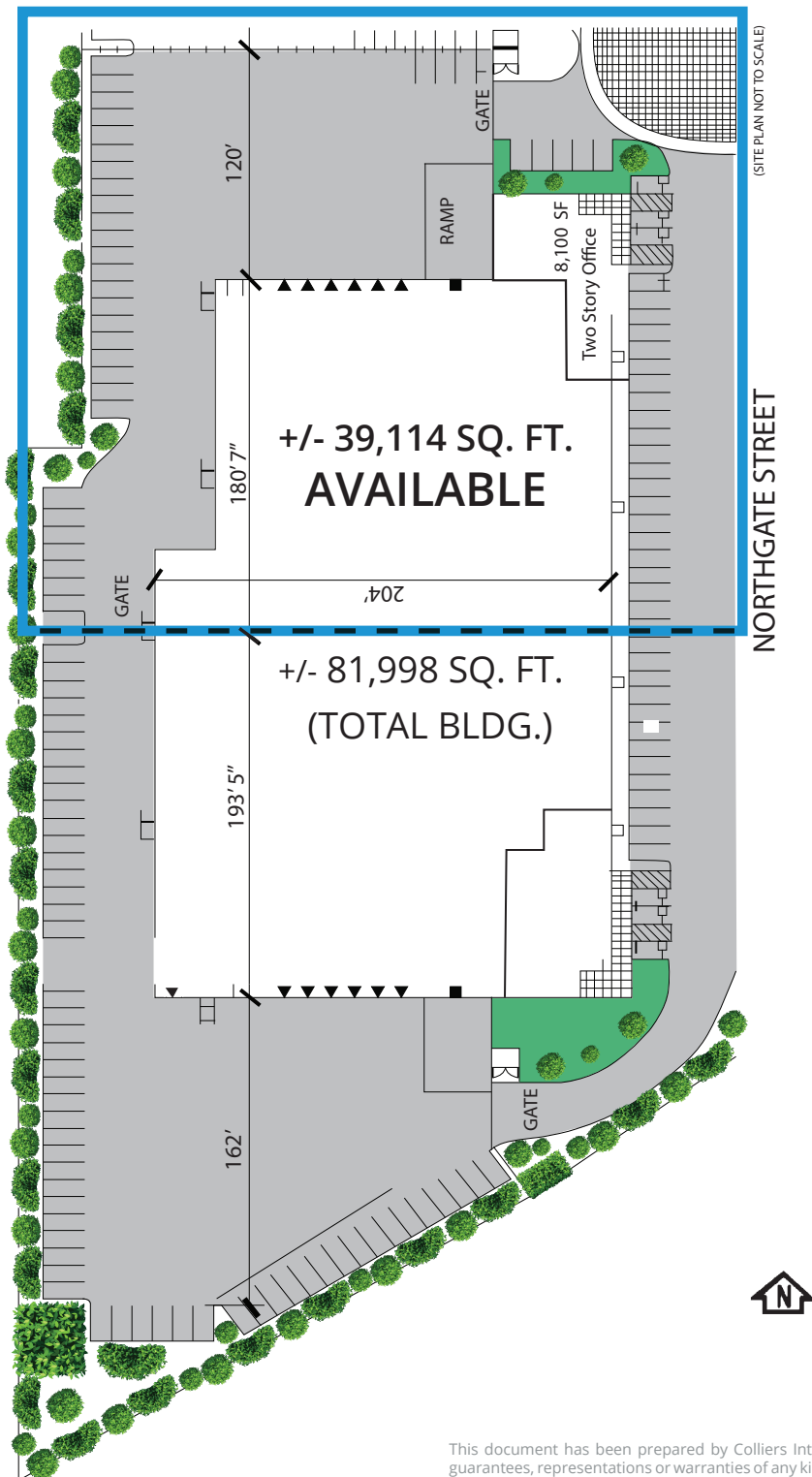

This document has been prepared by Colliers International for advertising and general information only. Colliers International makes no guarantees, representations or warranties of any kind, expressed or implied, regarding the information including, but not limited to, warranties of content, accuracy and reliability. Any interested party should undertake their own inquiries as to the accuracy of the information. Colliers International excludes unequivocally all inferred or implied terms, conditions and warranties arising out of this document and excludes all liability for loss and damages arising there from. This publication is the copyrighted property of Colliers International and/or its licensor(s). ©2025. All rights reserved.



3 Park Plaza, Suite 1200
Irvine, CA 92614

IAN DEVRIES, VICE CHAIRMAN
DRE # 01019686
949 724 5509
ian.devries@colliers.com

CHRIS DEVRIES, SIOR, EXECUTIVE VP
DRE # 01867314
949 724 5504
chris.devries@colliers.com

940 COLUMBIA AVENUE, RIVERSIDE CA

+/- 39,114 SQUARE FEET FOR LEASE

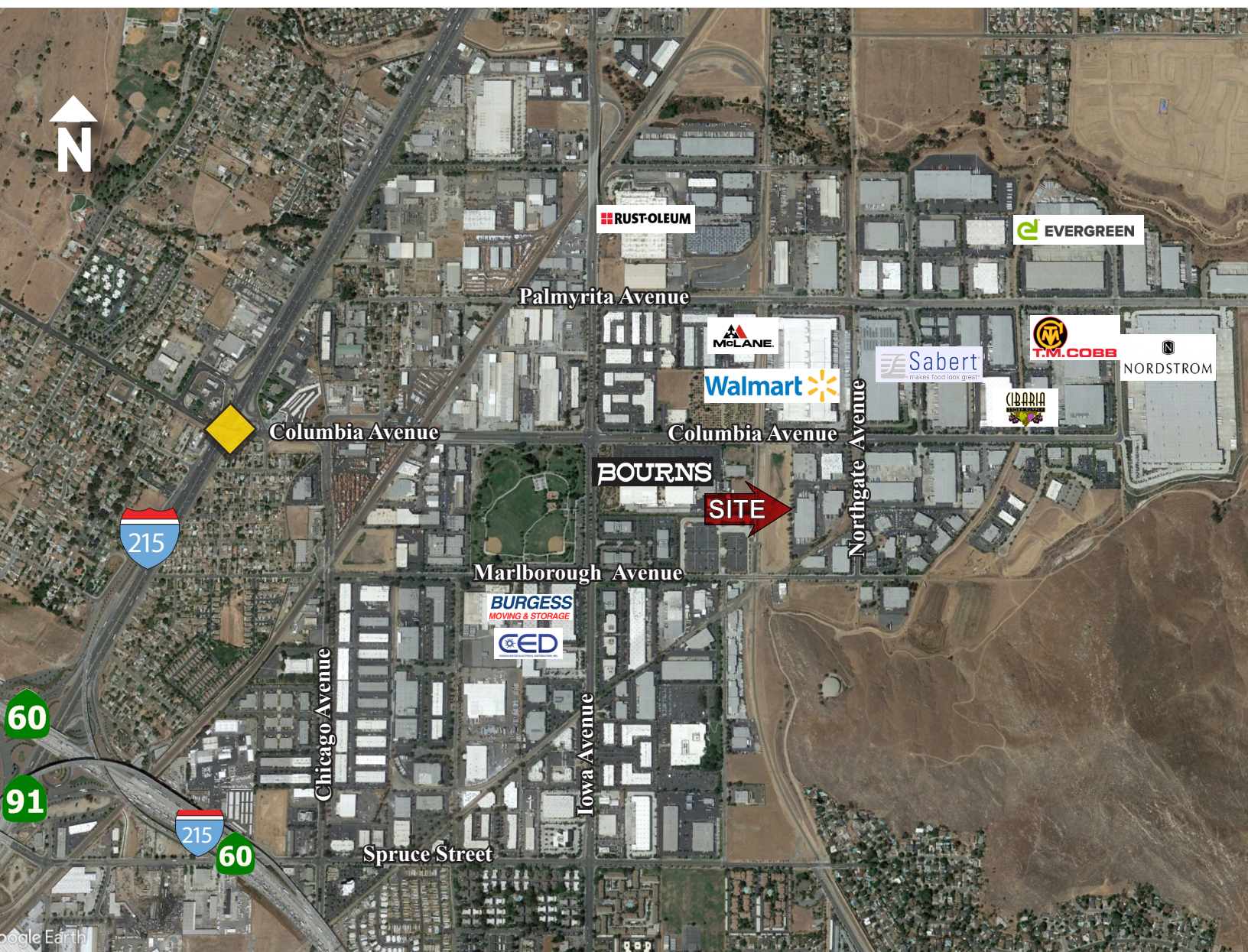

For Information,
Please Contact:

3 Park Plaza, Suite 1200 Irvine, CA
92614

IAN DEVRIES, VICE CHAIRMAN
DRE # 01019686
949 724 5509
ian.devries@colliers.com

CHRIS DEVRIES, SIOR, EXECUTIVE VP
DRE # 01867314
949 724 5504
chris.devries@colliers.com



This document has been prepared by Colliers International for advertising and general information only. Colliers International makes no guarantees, representations or warranties of any kind, expressed or implied, regarding the information including, but not limited to, warranties of content, accuracy and reliability. Any interested party should undertake their own inquiries as to the accuracy of the information. Colliers International excludes unequivocally all inferred or implied terms, conditions and warranties arising out of this document and excludes all liability for loss and damages arising there from. This publication is the copyrighted property of Colliers International and/or its licensor(s). ©2025. All rights reserved.

940 COLUMBIA AVENUE, RIVERSIDE CA

+/- 39,114 SQUARE FEET FOR LEASE

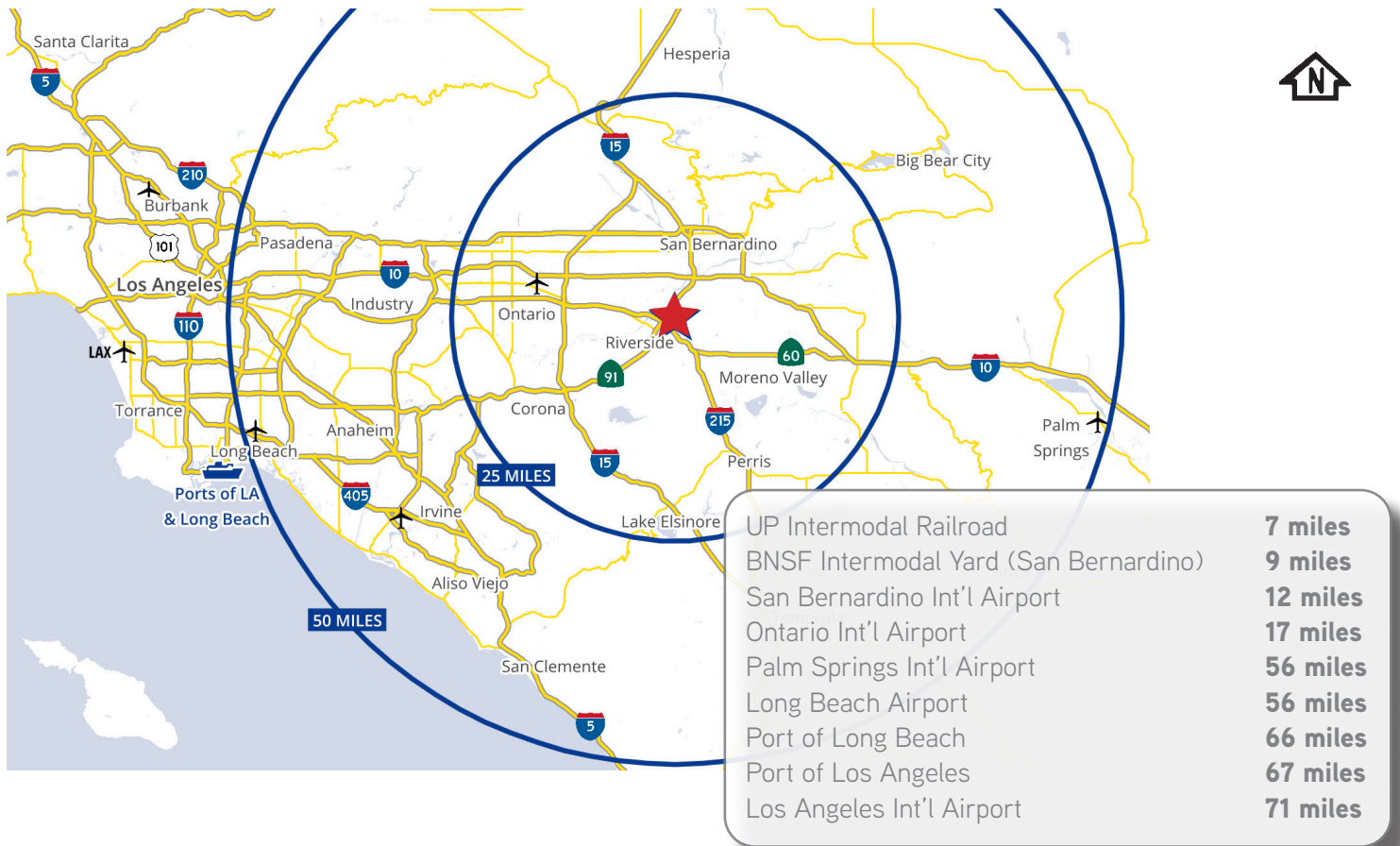

Listed by:

IAN DEVRIES

VICE CHAIRMAN

DRE # 01019686

949 724 5509

ian.devries@colliers.com

CHRIS DEVRIES, SIOR

EXECUTIVE VP

DRE # 01867314

949 724 5504

chris.devries@colliers.com

3 Park Plaza, Suite 1200
Irvine, CA 92614

