 **JLL** SEE A BRIGHTER WAY

Office Space for Sublease

455 Grand Union Boulevard, Somerville, MA
30,590 RSF Available Immediately

Class A Office Sublease

JLL is pleased to bring to market 30,590 RSF of class A office space at 455 Grand Union Boulevard. Located in the heart of Assembly Row, the space is easily accessible within a 2 minute walk of the MBTA Orange Line with excellent proximity to North Station and I 93. The immediate neighborhood is home to 50+ national brands and unique shops, 25+ dining options, 5 fitness studios and a boutique hotel.

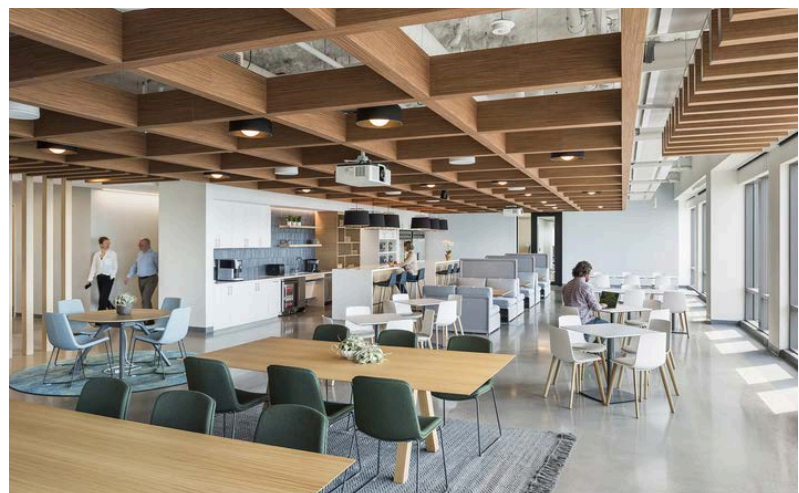
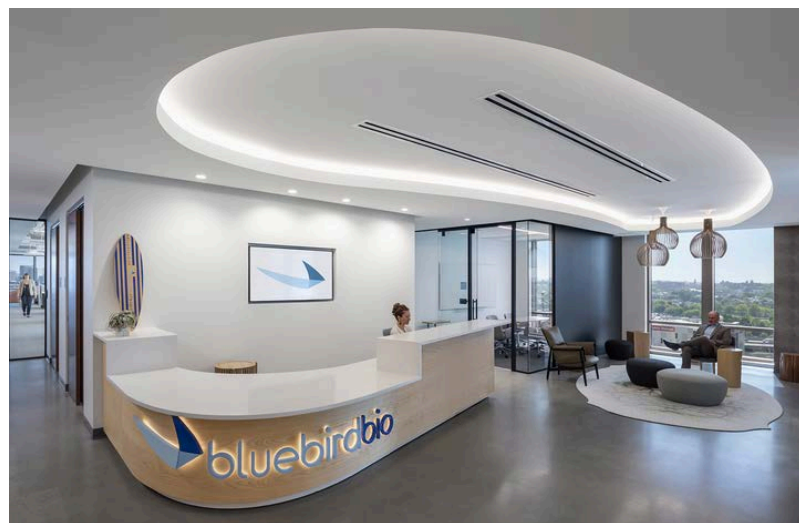

Floor	11th
--------------	------

Size	30,590 RSF
-------------	------------

Built	2021
--------------	------

Term	Through December 2032
-------------	-----------------------

Parking	2.0/1,000 s.f.
----------------	----------------

Floorplan

11th Floor: 30,590 RSF

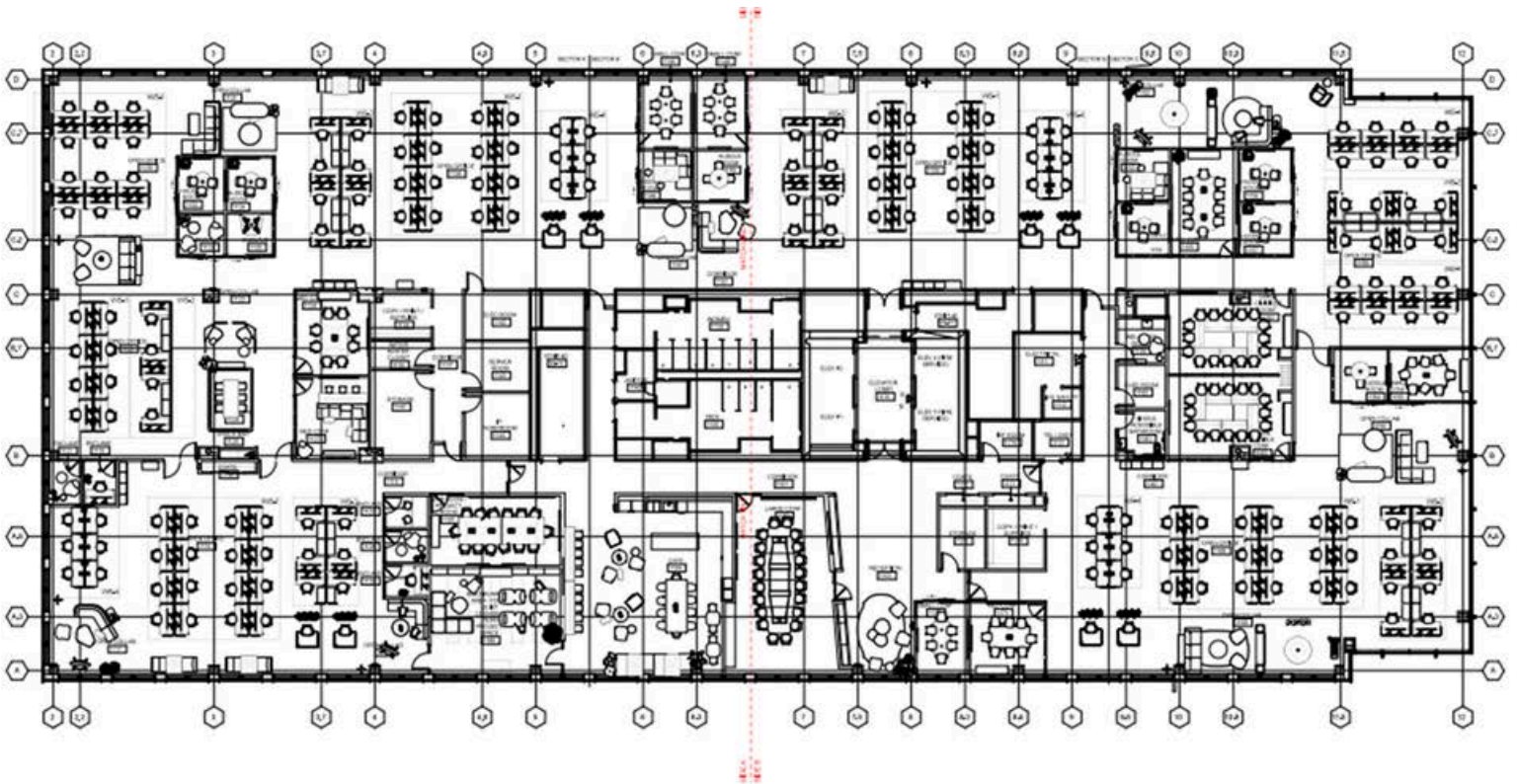



JLL

Tucker Hansen
Tucker.Hansen@jll.com
+1 617.316.6492

Bob Coughlin
Robert.Coughlin@jll.com
+1 617.316.6420