

# WATERMAN BUSINESS PARK

ELK GROVE, CA

LOTS AVAILABLE FOR SALE OR BUILD-TO-SUITS FOR LEASE



**SEAN MAHONEY, SIOR** | *Senior Managing Director* | 916.950.5750 | sean.mahoney@nrmk.com | CA RE License #01332661

**COLE CUMMINGS** | *Associate Director* | 916.569-2366 | cole.cummings@nrmk.com | CA RE License #02106833

**KEVIN JASPER, SIOR** | *Senior Managing Director* | 916.826.7276 | kevin.jasper@nrmk.com | CA RE License #01164925

**NEWMARK**

# WATERMAN BUSINESS PARK

ELK GROVE, CA

## PROPERTY HIGHLIGHTS

- Six (6) Parcels from ±0.84 AC to ±2.78 AC
- Office, Industrial, & Retail Uses Permitted
- Ideal for Building ±5,000 - ±30,000 SF Buildings
- Ample Parking or Storage Yard Potential
- High Visibility Location in a Fast Developing Area of Elk Grove

## CONCEPTUAL SITE PLAN

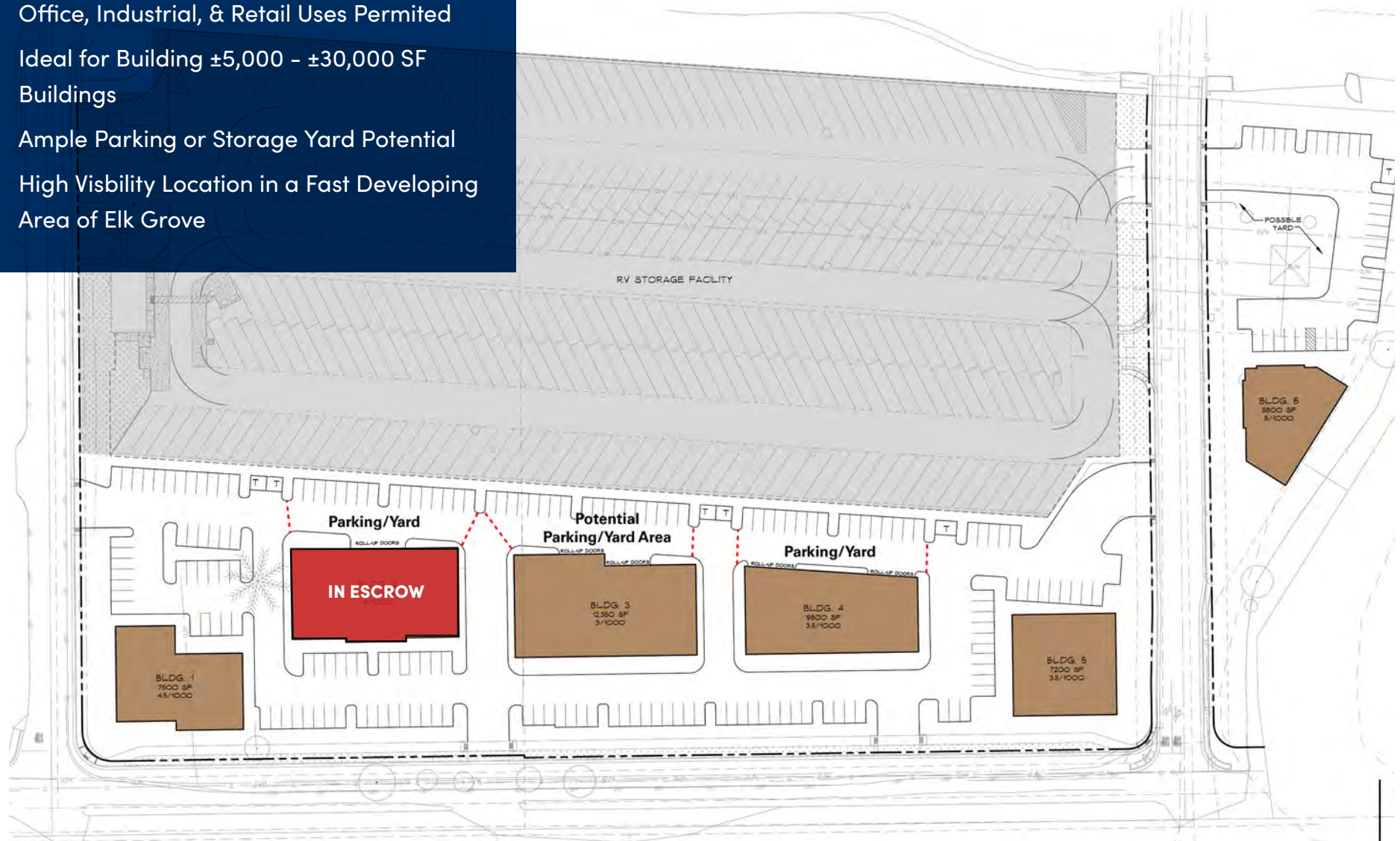

# WATERMAN BUSINESS PARK

ELK GROVE, CA

## SITE IMPROVEMENTS

- Curbs, Gutter and 7.5 foot wide sidewalk all along Waterman Road, plus improvements along Charolais Way and Wayne Heintz Street
- New, professionally designed landscaping to be installed along Waterman Road, Charolais Way and Wayne Heintz Street
- Concrete aprons to be installed at pre-determined ingress and egress locations along Waterman Road, Charolais Way and Wayne Heintz Street.
- New state-of-the-art signalized intersection to be installed at the corner of Waterman and Wayne Heintz Street
- ±22-foot road widening of Waterman Road with new asphalt and turn-in lanes into site. This well designed/engineered widening will allow for easy and safe access into the development
- High-end 8-foot wall (along the split face block, design enhancing pilasters & top cap) installed full length of the east parcel line
- Each parcel will be very near "finish grade" with approved/inspected compaction from front area of parcel all the way to the back wall
- Water connection stubbed to each parcel
- Sewer connection stubbed to each parcel
- SMUD connections stubbed to each parcel
- Cable/internet available to each parcel (Comcast & Frontier)
- New street lighting
- Manholes installed and drainage lines installed
- The latest model of new SMUD power poles installed along Waterman
- Environmental fees paid (Wetlands and Swainson Hawk mitigation fees paid)
- Historical/Cultural inspection cleared and fees paid
- Renderings of prospective new buildings already designed with a high-end look and a standard that will lead to a cohesive, aesthetically pleasing overall project
- An Association will be in place to ensure proper maintenance that will ensure the project remains looking top-notch
- Property values enhanced through these site improvements with the idea of maintaining and increasing value long term for buyers

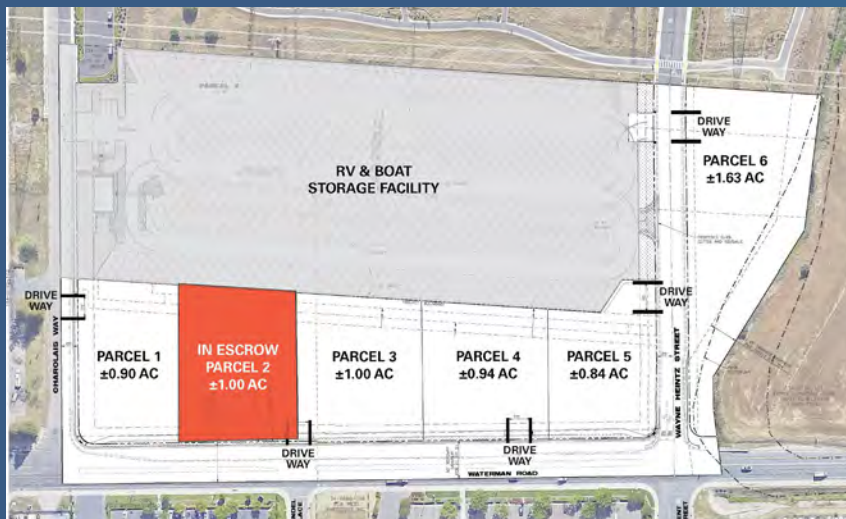

# WATERMAN BUSINESS PARK

ELK GROVE, CA

## PRICE LIST

| Parcel | Acreage | Price       | Price/SF |
|--------|---------|-------------|----------|
| 1      | ±0.90   | \$980,100   | \$25.00  |
| 2**    | ±1.00   |             |          |
| 3      | ±1.00   | \$958,320   | \$22.00  |
| 4      | ±0.94   | \$900,821   | \$22.00  |
| 5      | ±0.84   | \$987,941   | \$27.00  |
| 6      | ±1.63   | \$1,065,042 | \$15.00  |

\* Prices are subject to change at any time without notice.

\*\* Parcel in Escrow

## ZONING

MP Zoned land allows for but is not limited to:

- » Day Care
- » Medical
- » Kennels
- » Training Schools
- » Parking Facilities
- » Banks
- » Call Centers
- » Restaurants
- » Auto Rental
- » Research and Development
- » Wineries
- » Vet
- » Fitness Center

[Click HERE for Elk Grove Zoning Descriptions](#)



# WATERMAN BUSINESS PARK

ELK GROVE, CA

## NEARBY AMENITIES



# WATERMAN BUSINESS PARK

ELK GROVE, CA

## LOCATION MAP

| DISTANCE TO MAJOR CITIES |             |
|--------------------------|-------------|
| Stockton, CA             | 35 Miles    |
| San Francisco, CA        | 104 Miles   |
| Reno, NV                 | 147 Miles   |
| Fresno, CA               | 155 Miles   |
| Los Angeles, CA          | 377 Miles   |
| Las Vegas, NV            | 548 Miles   |
| Boise, ID                | 568 Miles   |
| Portland, OR             | 598 Miles   |
| Salt Lake City, UT       | 665 Miles   |
| Phoenix, AZ              | 748 Miles   |
| Seattle, WA              | 771 Miles   |
| Denver, CO               | 1,181 Miles |

| TRAFFIC COUNTS               |             |
|------------------------------|-------------|
| Waterman Rd @ Grant Line Rd  | 8,671 ADT   |
| Waterman Rd @ Elk Grove Blvd | 13,288 ADT  |
| Grant Line Rd @ Hwy 99       | 159,300 ADT |
| Elk Grove Blvd @ Hwy 99      | 189,000 ADT |

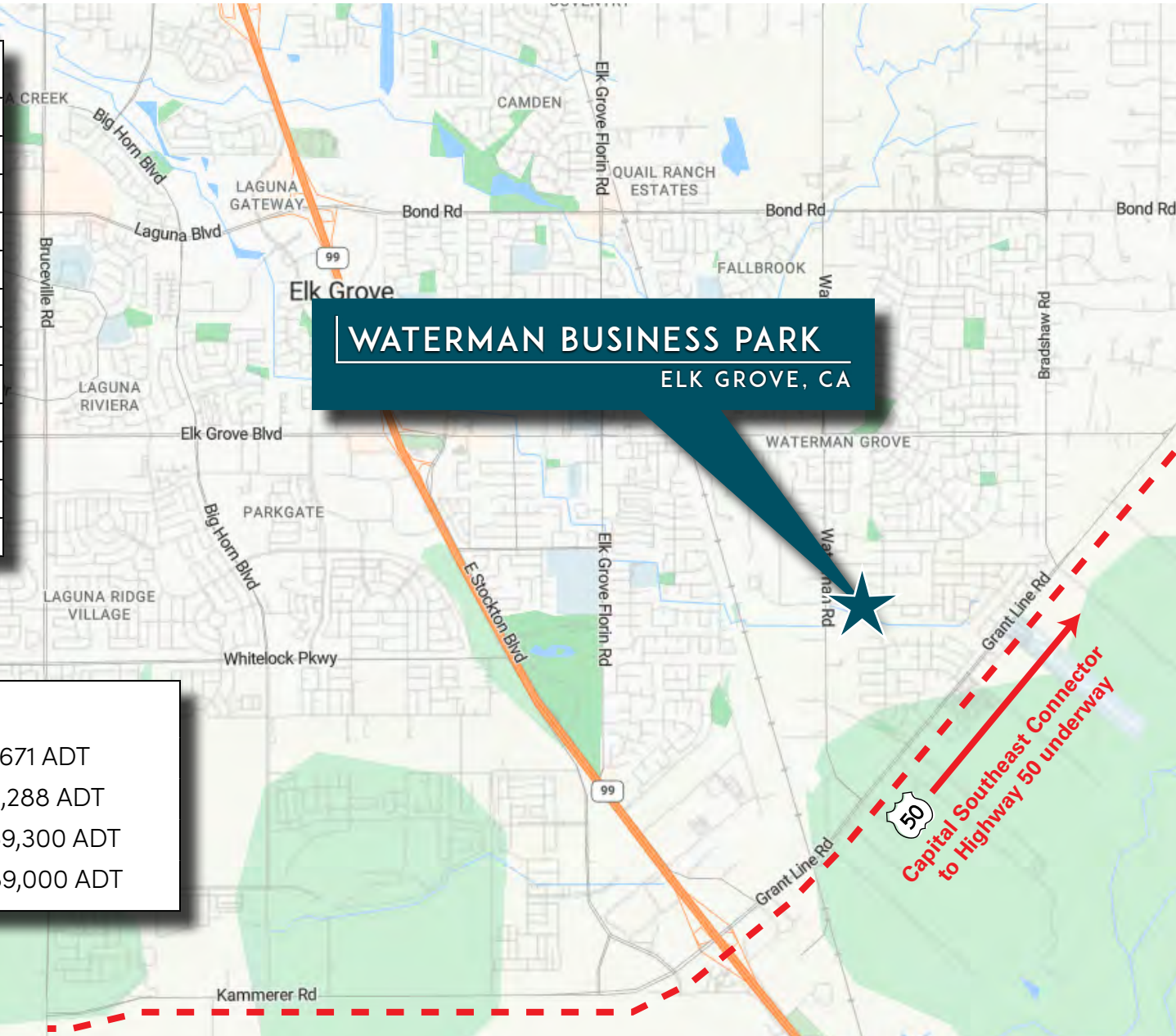



**SEAN MAHONEY, SIOR** | *Senior Managing Director* | 916.950.5750 | sean.mahoney@nmrk.com | CA RE License #01332661

**COLE CUMMINGS** | *Associate Director* | 916.569-2366 | cole.cummings@nmrk.com | CA RE License #02106833

**KEVIN JASPER, SIOR** | *Senior Managing Director* | 916.826.7276 | kevin.jasper@nmrk.com | CA RE License #01164925

980 NINTH STREET, SUITE 2500  
SACRAMENTO, CA 95814  
916.920.4400

**NEWMARK**

The distributor of this communication is performing acts for which a real estate license is required. The information contained herein has been obtained from sources deemed reliable but has not been verified and no guarantee, warranty or representation, either express or implied, is made with respect to such information. Terms of sale or lease and availability are subject to change or withdrawal without notice. 23-0586 • 03/26