



FOR SUBLEASE

**CARLSBAD
RESEARCH CENTER**
±1,280 SF Office Suite

5939 DARWIN COURT
SUITE 102
CARLSBAD, CA 92008

**Kidder
Mathews**



FOR SUBLEASE

Carlsbad Research Center

5939 DARWIN COURT, SUITE 102 | CARLSBAD, CA 92008



SUB LEASE HIGHLIGHTS

±1,280 SQUARE FOOT
Office Suite

**CARLSBAD RESEARCH
CENTER**

HIGH QUALITY
Office Improvements

10 PARKING STALLS

JIM BENSON
760.822.7428
jim.benson@kidder.com
LIC N° 01204845

KIDDER.COM

This information supplied herein is from sources we deem reliable. It is provided without any representation, warranty, or guarantee, expressed or implied as to its accuracy. Prospective Buyer or Tenant should conduct an independent investigation and verification of all matters deemed to be material, including, but not limited to, statements of income and expenses. Consult your attorney, accountant, or other professional advisor.



FOR SUBLEASE

Carlsbad Research Center

5939 DARWIN COURT, SUITE 102 | CARLSBAD, CA 92008

Suite 102

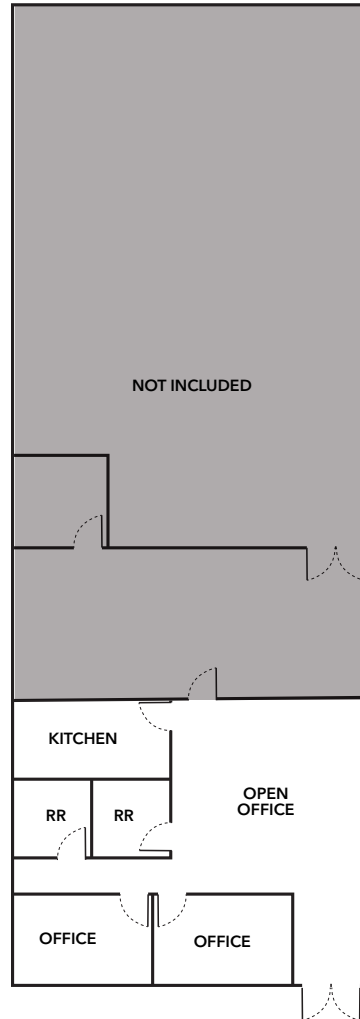

NOW

AVAILABLE

±1,280

SQUARE FOOTAGE

**\$2.20/SF
GROSS**

**UTILITIES INCLUDED IN RENT
DOES NOT INCLUDE JANITORIAL**

SUBLEASE

SUBLEASE EXPIRES 9/30/2026

JIM BENSON

760.822.7428

jim.benson@kidder.com

LIC N° 01204845

KIDDER.COM

This information supplied herein is from sources we deem reliable. It is provided without any representation, warranty, or guarantee, expressed or implied as to its accuracy. Prospective Buyer or Tenant should conduct an independent investigation and verification of all matters deemed to be material, including, but not limited to, statements of income and expenses. Consult your attorney, accountant, or other professional advisor.



FOR SUBLEASE

Carlsbad Research Center

5939 DARWIN COURT, SUITE 102 | CARLSBAD, CA 92008

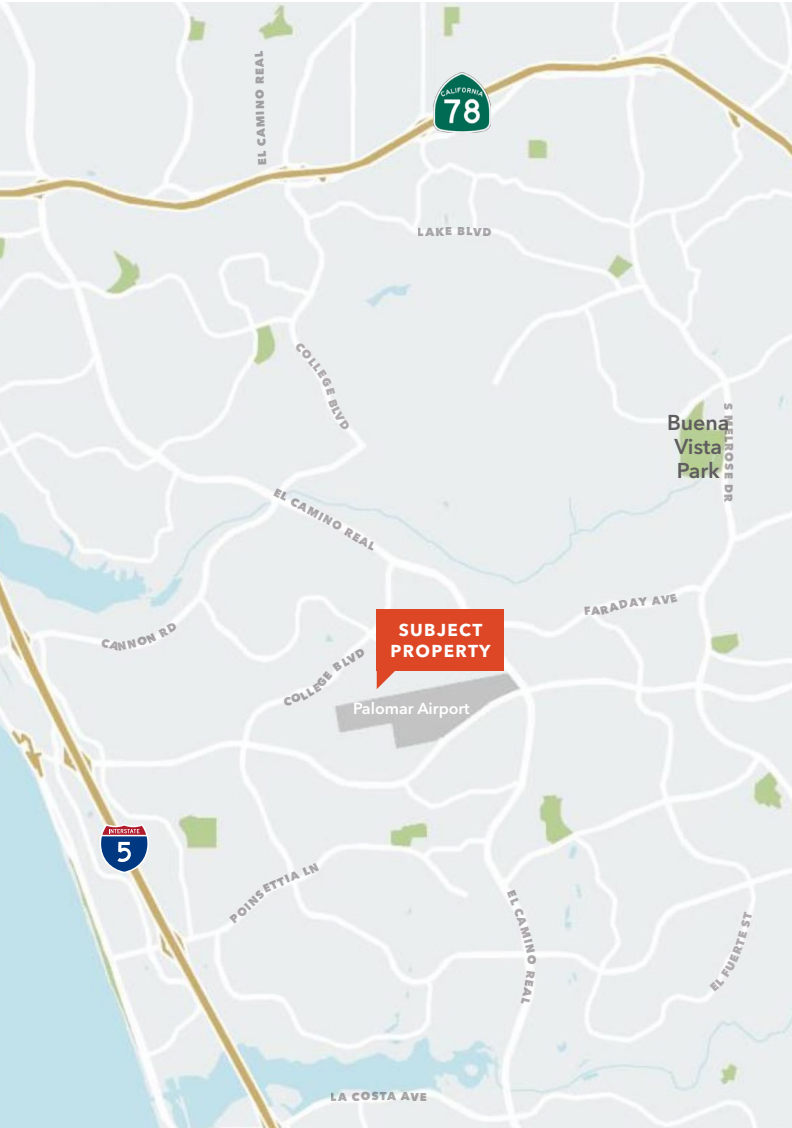

KIDDER.COM

This information supplied herein is from sources we deem reliable. It is provided without any representation, warranty, or guarantee, expressed or implied as to its accuracy. Prospective Buyer or Tenant should conduct an independent investigation and verification of all matters deemed to be material, including, but not limited to, statements of income and expenses. Consult your attorney, accountant, or other professional advisor.



FOR SUBLEASE

Carlsbad Research Center

5939 DARWIN COURT, SUITE 102 | CARLSBAD, CA 92008





**For leasing
information
contact**

JIM BENSON
760.822.7428
jim.benson@kidder.com
LIC N° 01204845

KIDDER.COM

This information supplied herein is from sources we deem reliable. It is provided without any representation, warranty, or guarantee, expressed or implied as to its accuracy. Prospective Buyer or Tenant should conduct an independent investigation and verification of all matters deemed to be material, including, but not limited to, statements of income and expenses. Consult your attorney, accountant, or other professional advisor.