

2845 W. 48th Place Chicago, IL



2743 W. 36th PL. • Chicago, Illinois 60632
773.254.0888 Phone • 773.254.0885 Fax
www.chicagoindustrialre.com

GREAT SPACES - 5,200SF , 21,000SF and 26,200SF

Property Specifications

Building Size: 153,410 SF
Space Available: 5,200, 21,000 & 26,200 SF
Site Size: 494,566 SF
Office: 500-1,500 SF
Parking: Street
Ceiling Heights: 14' - 16' Clear
Bay Size: Vary
Sprinklered: Wet System
Truck Level Docks: 2-5
Zoning: M2-3
Lease Rates: \$6.95 - \$8.95/gross

Comments

- Excellent facility for many types of users
- Clean space.
- Minutes to I55 expressway & close to downtown Chicago



Inexpensive Manufacturing - Warehouse Space!

Contact

Matt Rogatz
mattr@chicagoindustrialre.com
Cell - 773.719.4441

AVAILABLE SPACES

Space A: 21,000 SF 16' clear - **Leased**
Space E: 14,350 SF 18' clear - **Leased**
Space B: 1,200-7,500 SF 16' clear - **Leased**
Space C: 26,200 SF 13'9" clear
Space C-1: 21,000 SF 13'9" clear
Space C-2: 5,200 SF 13'9" clear
Space D: 7,000 SF 16'4" clear - **Leased**
Space E: 14,350 SF 18' clear - **Leased**
Space F: 10,000 SF 18' clear - **Leased**
Space G: 26,200 SF 18' clear - **Leased**

2845 W. 48th Place Chicago, IL



2743 W. 36th PL. • Chicago, Illinois 60632
773.254.0888 Phone • 773.254.0885 Fax
www.chicagoindustrialre.com

Space Divisions

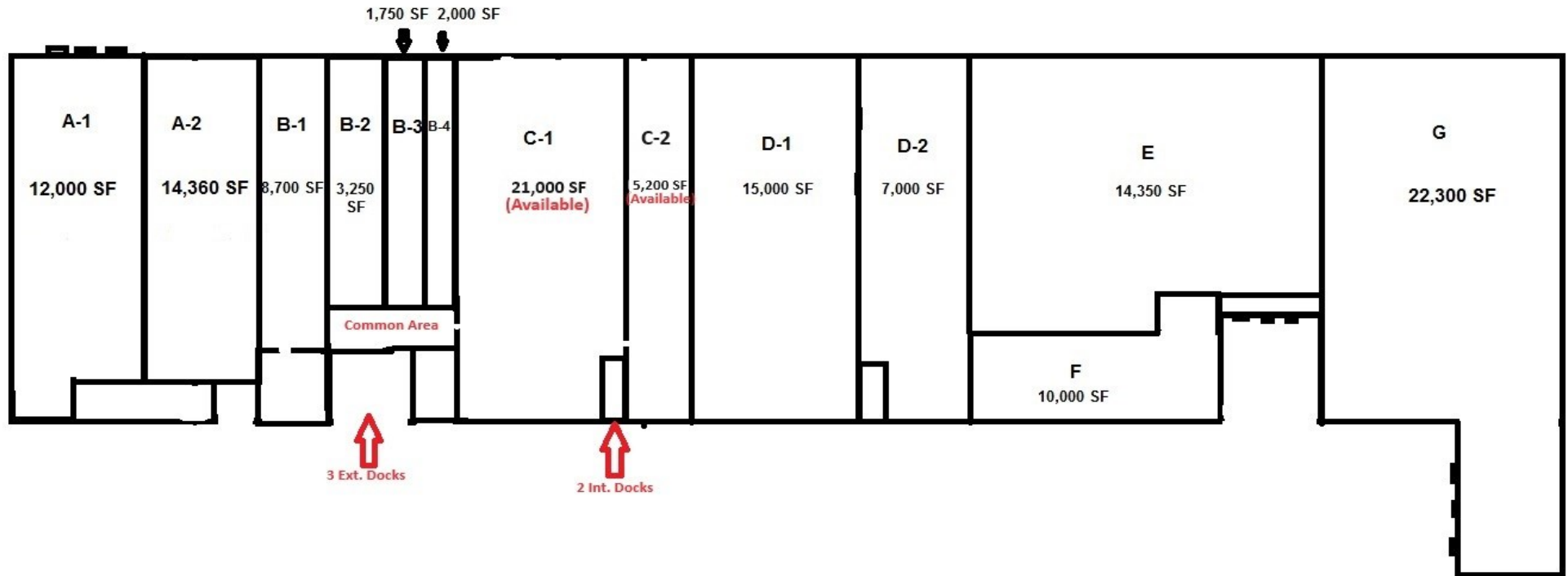

For Lease - Multi Tenant Manufacturing - Distribution Building

Contact

Matt Rogatz
Chicago Industrial Real Estate
773-719-4441 (cell)
www.chicagoindustrialre.com

Professional Affiliations...

